

DATE	
BY	
FINISHED SURVEY	
PLOTTED	
TEMPLATE	
NOTE BOOK	
AREAS CHECKED	
NO.	

DATE	
BY	
ORIGINAL SURVEY	
PLOTTED	
TEMPLATE	
NOTE BOOK	
AREAS CHECKED	
NO.	

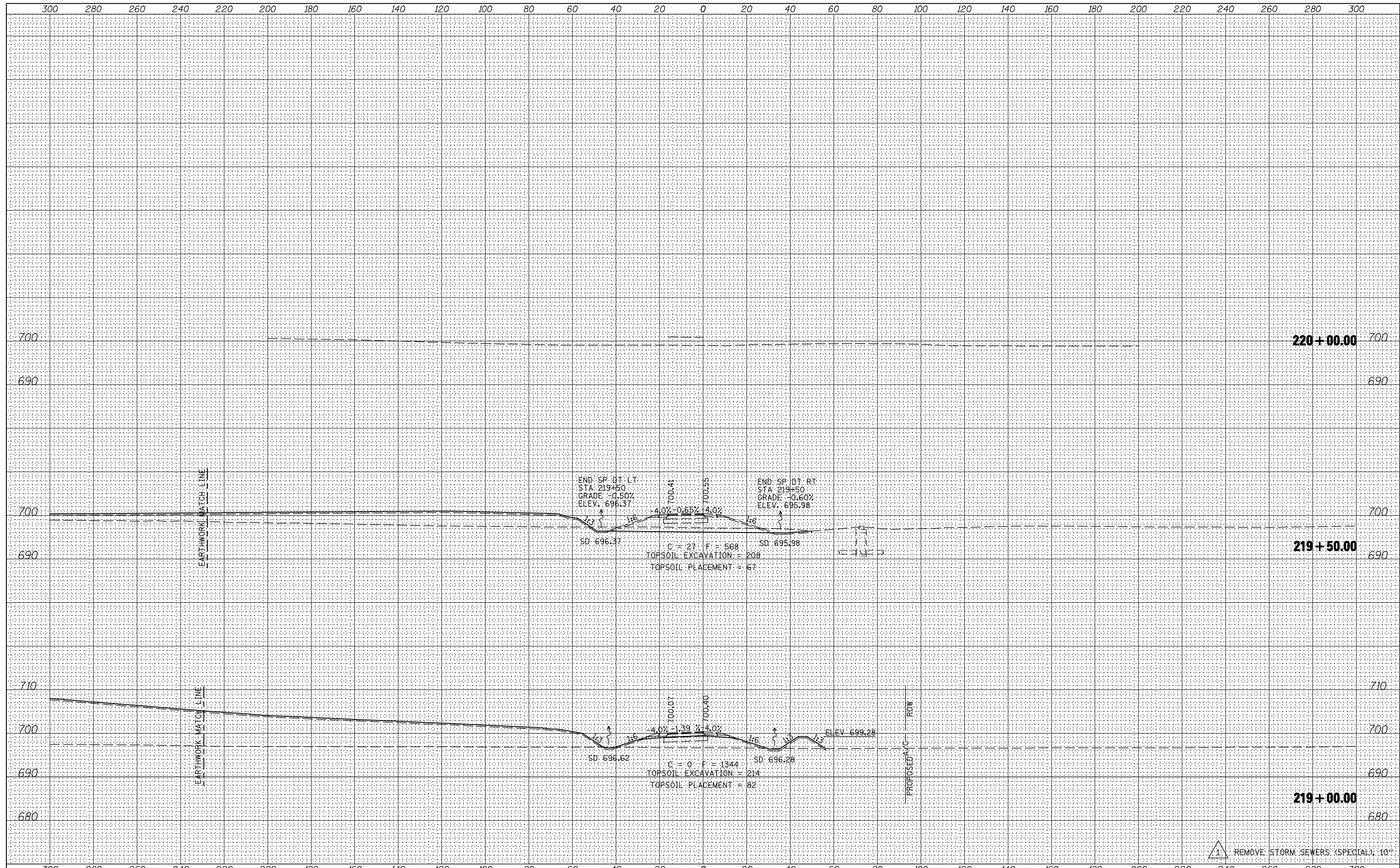

FILE NAME =	USER NAME = jdeen	DESIGNED - JRB	REVISED - 02/07/2013
vi\transportation\2891\grading plans\2891XSHEET_RAMPS.dgn		DRAWN - TJD	REVISED -
		CHECKED - AWM	REVISED -
XS_SHEET	PLOT DATE = 2/7/2013	DATE - 12-12-12	REVISED -

**STATE OF ILLINOIS
DEPARTMENT OF TRANSPORTATION**

**FAP ROUTE 407 (IL 336)
CROSS SECTIONS - RAMP D**

SCALE: 1"=20' H
1"=100' V SHEET 9 OF 9 SHEETS STA. 219+00.00 TO STA. 220+00.00

F.A.P. RTE.	SECTION	COUNTY	TOTAL SHEETS	SHEET NO.
407	(55-3)A	MCDONOUGH	671	662
			CONTRACT NO. 68A42	

REMOVE STORM SEWERS (SPECIAL) 10'