

FOR INDEX OF SHEETS, SEE SHEET NO.2

03-08-13 LETTING ITEM 093 STATE OF ILLINOIS

F.A.P. RTE.	SECTION	COUNTY	TOTAL SHEETS	SHEET NO.
669	(11R)W-1	PEORIA	33	1
ILLINOIS			CONTRACT NO. 68A71	

DEPARTMENT OF TRANSPORTATION  
DIVISION OF HIGHWAYS

# PROPOSED HIGHWAY PLANS

FAP ROUTE 669 (IL 116)  
SECTION (11R)W-1  
PROJECT HSIP-0669(033)  
SAFETY PROJECT  
PEORIA COUNTY

C-94-017-12

### HIGHWAY STANDARDS

- 482011-03 701301-04
- 542301-03 701306-03
- 542306-02 701311-03
- 542401-01 701326-04
- 701001-02 701901-02
- 701006-04 780001-03
- 701201-04 781001-03

### DISTRICT STANDARDS

- 406301 542016
- 540001 780001

### DESIGN DESIGNATION:

IL 116: 9635(22) PRINCIPAL ARTERIAL URBAN  
(CLASS II TRUCK ROUTE)3.17(HMA-20)

ADT(2011) = 10,000  
SU = 2.25%  
MU = 2.0%



FULL SIZE PLANS HAVE BEEN PREPARED USING STANDARD ENGINEERING SCALES. REDUCED SIZED PLANS WILL NOT CONFORM TO STANDARD SCALES. IN MAKING MEASUREMENTS ON REDUCED PLANS, THE ABOVE SCALES MAY BE USED.

PROJECT ENGINEER: C. MAUSHARD 309-671-3453  
PROJECT MANAGER: J. COUSIN III 309-671-3477  
CONTRACT NO. 68A71  
CATALOG NO. 034726-00D  
FIELD BOOK NUMBER 2918

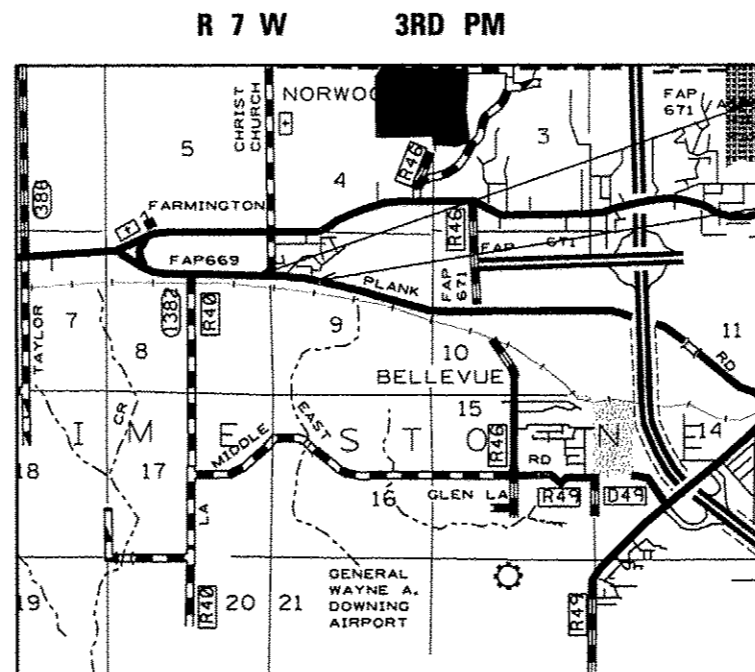

BEGIN IMPROVEMENT  
STA. 251+48

END IMPROVEMENT  
STA. 278+60

### PROJECT DESCRIPTION:

THIS PROJECT CONSIST OF THE CONSTRUCTION OF WIDENING FOR THE INSTALLATION OF A BIDIRECTIONAL TURN LANE ON IL 116 (W PLANK ROAD) FROM WEST OF STONE CHURCH ROAD (TR 204), TO EAST OF Tanager Drive (TR 204C), IN PEORIA COUNTY

GROSS LENGTH = 2712 FT. = 0.51 MILE  
NET LENGTH = 2712 FT. = 0.51 MILE

D-94-015-12

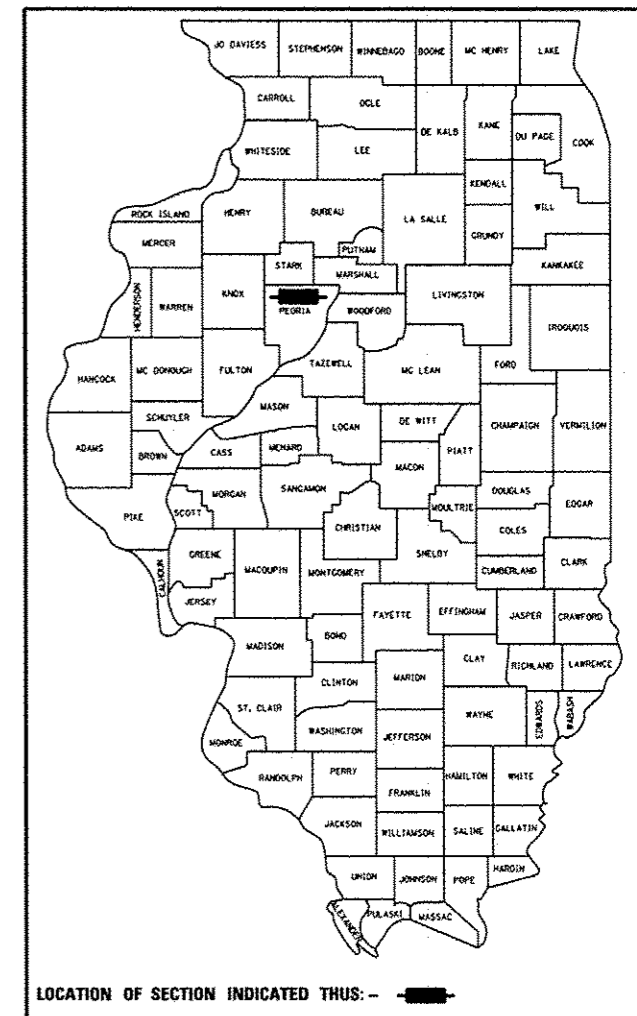

LOCATION OF SECTION INDICATED THUS: - [black rectangle] -

J.U.L.I.E.  
JOINT UTILITY LOCATION INFORMATION FOR EXCAVATION  
1-800-892-0123  
OR 811

STATE OF ILLINOIS  
DEPARTMENT OF TRANSPORTATION  
DIVISION OF HIGHWAYS

SUBMITTED NOV 14 20 12

[Signature]  
DEPUTY DIRECTOR OF HIGHWAYS, REGION ENGINEER

Feb 1 20 13  
Don B. Baranzoli PE, Inc.  
ENGINEER OF DESIGN AND ENVIRONMENT

Feb 1 20 13  
Chris Osman PE, Inc.  
DIRECTOR OF HIGHWAYS, CHIEF ENGINEER

PRINTED BY THE AUTHORITY  
OF THE STATE OF ILLINOIS

**INDEX OF SHEETS**

- 1. COVER SHEET
- 2-3. GENERAL NOTES/COMMITMENTS
- 4-7. SUMMARY OF QUANTITIES
- 8. TYPICAL SECTION
- 9-11. SCHEDULE OF QUANTITIES
- 12. LINE DIAGRAM
- 13. BENCHMARKS & RECOVERY TIES
- 14-15. EXISTING/REMOVAL PLAN VIEW
- 16-17. PROPOSED PLAN LAYOUT
- 18-19. EROSION CONTROL PLAN VIEW
- 20-24. DISTRICT STANDARDS
- 25-33. CROSS SECTIONS

**Status of Utilities**

Illinois American Water

Route	Offset	Location	Type of Utility	Type of Conflict	Disposition
IL 116	32' RT	255+00 to 275+00	12" Watermain	New ditch line	Relocate

**UTILITIES - LOCATIONS /INFORMATION ON PLANS**

The locations of existing water mains, gas mains, sewers, electric power lines, telephone lines and other utilities as shown on the plans are based on careful field investigation and the best information available, but they are not guaranteed. Unless elevations are shown — all utility locations shown on the cross sections are based on the approximate depth supplied by the utility company. It shall be the Contractor's responsibility to ascertain their exact location from the utility companies and by field inspection.

**PROPERTY OWNER ACCESS REQUIREMENTS**

Access must be maintained to all existing properties during construction per Article 107.09 unless arrangements are made in writing by the Contractor with the property owners with a copy to the Engineer for short-term closures.

**PLAN ELEVATIONS - U. S. G. S. MEAN SEA LEVEL DATUM**

- 1. All elevations shown on the plans are established from U. S. G. S. mean sea level datum.

**ENVIRONMENTAL REVIEWS**

Prior to the use of any proposed borrow areas, use areas (temporary access roads, detours, run-arounds, etc.) and/or waste areas, the Contractor shall file the required environmental resource request surveys according to Section 107.22 of the Standard Specifications. These surveys are required in order for the Department to conduct cultural and biological resource surveys for the proposed site.

Prior to any waste materials being removed from the construction site the required environmental resource surveys will need to be obtained and filed by the Contractor. Excess waste products removed from the construction site shall be disposed of as required in Section 202.03 of the Standard Specifications.

Any protruding metal bars shall be removed prior to the disposal of broken concrete at approved disposal sites.

The required environmental resource documentation shall include the following:

- \* BDE Form 2289 (Environmental Survey Request)
- \* A location map showing the size limits and location of the use area
- \* Signed property owner agreement form-D4 PI0100
- \* Color photographs depicting the use area
- \* Borrow Area Entry Agreement form-D4 PI0101

Please note that a minimum of two weeks shall be allowed for the District to obtain the required environmental clearances.

**PAVEMENT STATIONING NUMBERS & PLACEMENT**

The Contractor shall provide labor and materials required to imprint pavement station numbers in the finished surface of the pavement and/or overlay. The numbers shall be approximately 3/4 inch (20mm) wide, 5 inches (125 mm ) high and 5/8 inch (15 mm ) deep.

The pavement station numbers shall be installed as specified herein:

Interval - 200 feet (English stationing) or 100 meters (metric stationing)

Bottom of Numbers - 6 inches (150 mm ) from the inside edge of the pavement marking

Location:

- \* 2,3, & 5 Lane Pavements - right edge of pavement in direction of increasing stations
- \* Multi-Lane Divided Roadways - outside edge of pavement in both directions
- \* Ramps - along baseline edge of pavement

Position - stations shall be placed so they can be read from the adjacent shoulder

Format - English (Metric) pavement stations shall use this format "XXX (XX+X00)" where X represents the pavement station

This work will not be paid for separately, but will be considered included in the cost of the associated pavement and/or overlay pay items.

FILE NAME * D468A71-ehtrplan.dgn	USER NAME * adustinja	DESIGNED -	REVISED -	<b>STATE OF ILLINOIS DEPARTMENT OF TRANSPORTATION</b>	<b>GENERAL NOTES/COMMITMENTS</b>				F.A.P. RTE.	SECTION	COUNTY	TOTAL SHEETS	SHEET NO.
	PLOT SCALE * 200.0000 ' / in.	DRAWN -	REVISED -						669	(11R)W-1	PEORIA	33	2
PLOT DATE * 1/4/2012	CHECKED -	REVISED -	SCALE:		SHEET	OF	SHEETS	STA.	TO STA.	CONTRACT NO. 68A71			
	DATE -	REVISED -									ILLINOIS FED. AID PROJECT		

**POLYMERIZED BITUMINOUS MATERIALS (PRIME COAT) RATES**

Surface Type	Estimated Truck Application Rate	Residual Rate
Milled (HMA or PCC)	0.08 gal/sy (0.00034 ton/sy)	0.04 gal/sy
Existing Pavement	0.05 gal/sy (0.00022 ton/sy)	0.025 gal/sy
Fog Coat (between lifts)	0.05 gal/sy (0.00022 ton/sy)	0.025 gal/sy

Note: Estimated truck application rate is used for estimating quantities.

**HOT-MIX ASPHALT MIXTURE REQUIREMENTS**

Mixture Use(s):	POLYMER SURFACE COURSE 2"	BINDER COURSE 8.5"	HMA SHOULDER (SURFACE LIFT)	HMA SHOULDER (LOWER LIFTS)
RAP % (Max):	SBS OR SBR 70-22	PG 64-22	PG 64-22	PG 64-22
AC/PC:	10%	25%	15%	25%
Design Air Voids:	4.0% @ N=50	4.0% @ N=50	3.0% @ N=50	4.0% @ N=50
Mixture Composition: (Gradation Mixture)	IL 9.5 OR IL 12.5	IL 19.0	IL 9.5 OR 12.5	IL 19.0
Friction Aggregate	MIXTURE E	N/A	MIXTURE C	N/A

Notes: Individual lift thickness of each mix type will be no less than 3 times nominal maximum aggregate size and no more than 6 times nominal aggregate size.

**ORDERING LENGTH CONFIRMATION – DRAINAGE ITEMS**

The Contractor shall consult with the Engineer in regard to the exact length of the box/pipe culverts, storm sewers, and/or pipe drains required prior to ordering these items.

**ENGINEERS FIELD OFFICE**

Add the following sentence to the end of paragraph 670.02 (i) and 670.04 (e):  
All of the telephone lines provided shall have unpublished numbers.

**COMMITMENTS**

Commitments are not to be altered without the written approval of all parties to which the commitment was made.

No Commitments have been made for this project.

FILE NAME : D:\60471-shr-plan.dgn	USER NAME : kerdhor	DESIGNED -	REVISED -	<b>STATE OF ILLINOIS DEPARTMENT OF TRANSPORTATION</b>	<b>GENERAL NOTES/COMMITMENTS</b>	F.A.P. RTE. 669	SECTION 11R1W-1	COUNTY PEORIA	TOTAL SHEETS 33	SHEET NO. 3
	PLOT SCALE : 200.0000' / in.	CHECKED -	REVISED -			CONTRACT NO. 68A71				
	PLOT DATE : 12/12/2012	DATE -	REVISED -			ILLINOIS FED. AID PROJECT				
SCALE: SHEET OF SHEETS STA. TO STA.										

CODE NO.	ITEM	UNIT	TOTAL QUANTITY	CONST. CODE	
				90% FED.	10% STATE 0004 URBAN
20200100	EARTH EXCAVATION	CU YD	1514	1514	
20800150	TRENCH BACKFILL	CU YD	5	5	
21101615	TOPSOIL FURNISH & PLACE, 4"	SO YD	4856	4856	
* 25000210	SEEDING, CLASS 2A	ACRE	0.9	0.9	
* 25000400	NITROGEN FERTILIZER NUTRIENT	POUND	81	81	
* 25000500	PHOSPHORUS FERTILIZER NUTRIENT	POUND	81	81	
* 25000600	POTASSIUM FERTILIZER NUTRIENT	POUND	81	81	
28000250	TEMPORARY EROSION CONTROL SEEDING	LB	90	90	
* 25100115	MULCH, METHOD 2	ACRE	0.9	0.9	
28000305	TEMPORARY DITCH CHECKS	FOOT	117	117	
28000400	PERIMETER EROSION BARRIER	FOOT	50	50	
28000500	INLET AND PIPE PROTECTION	EACH	5	5	
35100700	AGGREGATE BASE COURSE, TYPE A 8"	SO YD	4092	4092	
40600215	POLYMERIZED BITUMINOUS MATERIALS (PRIME COAT)	TON	0.7	0.7	

\*SPECIALTY ITEM

CODE NO.	ITEM	UNIT	TOTAL QUANTITY	CONST. CODE
				PEORIA COUNTY 90% FED. 10% STATE 0004 URBAN
40603080	HOT - MIX ASPHALT BINDER COURSE, IL - 19.0, N50.	TON	1493	1493
40603560	POLYMERIZED HOT - MIX ASPHALT SURFACE COURSE, MIX "E", N50	TON	351	351
44004250	PAVED SHOULDER REMOVAL	SO YD	904	904
48101500	AGGREGATE SHOULDERS, TYPE B 6"	SO YD	904	904
48203039	HOT - MIX ASPHALT SHOULDERS, 10 1/2"	SO YD	904	904
50105220	PIPE CULVERT REMOVAL	FOOT	38	38
50800105	REINFORCEMENT BARS	POUND	65	65
54213663	PRECAST REINF. CONC. FLARED END SECTIONS 18"	EACH	1	1
54213669	PRECAST REINF. CONC. FLARED END SECTIONS 24"	EACH	1	1
54215550	METAL END SECTIONS 15"	EACH	2	2
54248510	CONCRETE COLLAR	CU YD	1.1	1.1
542A0223	PIPE CULVERTS, CLASS A, TYPE 1 18"	FOOT	12	12
542A5479	PIPE CULVERTS, CLASS A, TYPE 1 EQUIV. ROUND-SIZE 24"	FOOT	12	12
542D0220	PIPE CULVERTS, CLASS D, TYPE 1 15"	FOOT	34	34

HMA 2740

FILE NAME \*  
D:\68A71\shs-plan.dgn

USER NAME \* keithbr

DESIGNED -

REVISED -

DRAWN -

REVISED -

PLOT SCALE \* 100.0000' / in.

CHECKED -

REVISED -

PLOT DATE \* 12/12/2012

DATE -

REVISED -

STATE OF ILLINOIS  
DEPARTMENT OF TRANSPORTATION

SUMMARY OF QUANTITIES

F.A.P. RTE.	SECTION	COUNTY	TOTAL SHEETS	SHEET NO.
669	41RW-1	PEORIA	33	5
			CONTRACT NO. 68A71	
ILLINOIS FED. AID PROJECT				

CODE NO.	ITEM	UNIT	TOTAL QUANTITY	CONST. CODE	
				90% FED.	10% STATE 0004 URBAN
67000400	ENGINEER'S FIELD OFFICE, TYPE A	CAL MO	2	2	
67100100	MOBILIZATION	L SUM	1	1	
70100450	TRAFFIC CONTROL AND PROTECTION, STANDARD 701201	L SUM	1	1	
70100500	TRAFFIC CONTROL AND PROTECTION, STANDARD 701326	L SUM	1	1	
70103815	TRAFFIC CONTROL SURVEILLANCE	CAL DA	5	5	
70300210	TEMPORARY PAVEMENT MARKING - LETTERS AND SYMBOLS	SO FT	172	172	
70300220	TEMPORARY PAVEMENT MARKING - LINE 4"	FOOT	9943	9943	
70300250	TEMPORARY PAVEMENT MARKING - LINE 8"	FOOT	306	306	
70300260	TEMPORARY PAVEMENT MARKING - LINE 12"	FOOT	276	276	
70301000	WORK ZONE PAVEMENT MARKING REMOVAL	SO FT	994	994	
* 78005100	EPOXY PAVEMENT MARKING - LETTERS AND SYMBOLS	SO FT	172	172	
* 78005110	EPOXY PAVEMENT MARKING - LINE 4"	FOOT	9943	9943	
* 78005140	EPOXY PAVEMENT MARKING - LINE 8"	FOOT	306	306	
* 78005150	EPOXY PAVEMENT MARKING - LINE 12"	FOOT	276	276	

\*SPECIALTY ITEM

FILE NAME * D468A71rshsplan.dgn	USER NAME * kshbr	DESIGNED - DRAWN -	REVISED - REVISED -	<b>STATE OF ILLINOIS DEPARTMENT OF TRANSPORTATION</b>	<b>SUMMARY OF QUANTITIES</b>	F.A.P. RTE. 669	SECTION (11R1W-1)	COUNTY PEORIA	TOTAL SHEETS 33	SHEET NO. 6
PLOT SCALE * 100.0000' / 1"	CHECKED -	REVISED -	CONTRACT NO. 68A71							
PLOT DATE * 12/12/2012	DATE -	REVISED -	[ILLINOIS] FED. AID PROJECT							



- EXISTING
- ① P.C.C. PAVEMENT
  - ② 1" BITUMINOUS CONCRETE LEVELING BINDER
  - ③ 1.5" BITUMINOUS CONCRETE BINDER COURSE
  - ④ 1.5" BITUMINOUS CONCRETE SURFACE
  - ⑤ BITUMINOUS SHOULDER 8"
  - ⑥ AGGREGATE SHOULDER, TYPE B 6"
- PROPOSED
- ⑦ POLYMER HMA SURFACE COURSE, MIX E, N50, 2.0"
  - ⑧ HMA BINDER COURSE, IL-19.0, N50, 8.5"
  - ⑨ HMA SHOULDER, 10.5"
  - ⑩ AGGREGATE SHOULDER, TYPE B 6"
  - ⑪ AGGREGATE BASE COURSE TYPE A 8"

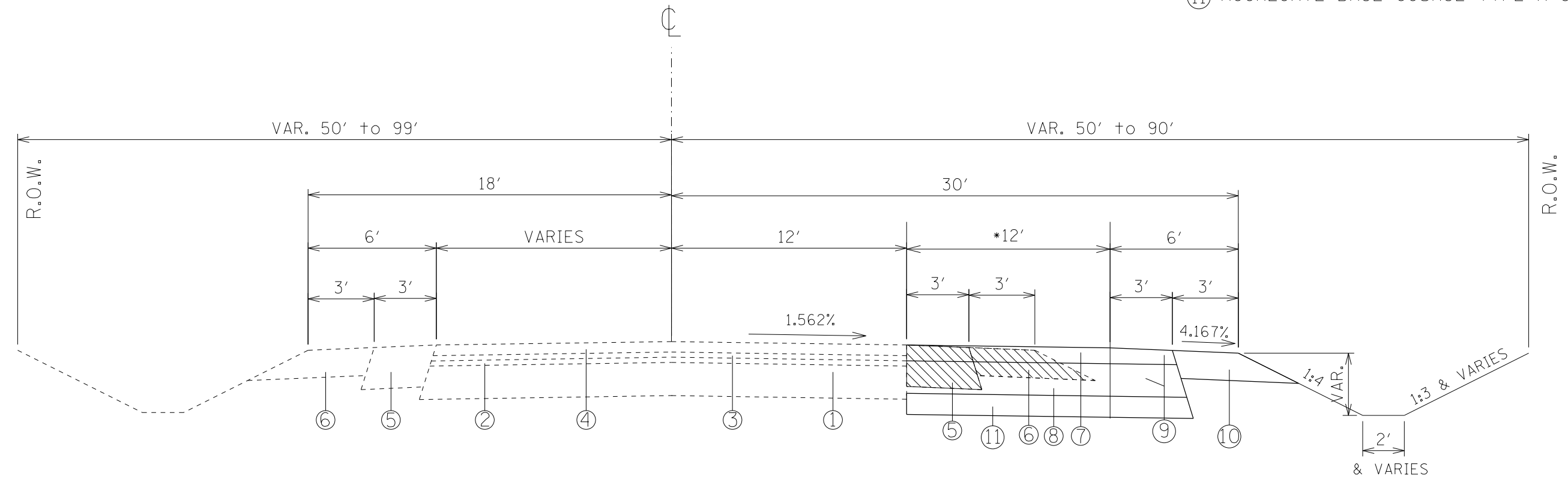

PROPOSED TYPICAL SECTION

ROUTE 116  
 \*251+48 - 256+28  
 256+28 - 273+80  
 \*273+80 - 278+60  
 \*VARIES 3'-12'

FILE NAME = D468A71-sht-plan.dgn	USER NAME = keithbr	DESIGNED -	REVISED -	<b>STATE OF ILLINOIS DEPARTMENT OF TRANSPORTATION</b>	<b>TYPICAL SECTION Not to Scale</b>			F.A.P. RTE.	SECTION	COUNTY	TOTAL SHEETS	SHEET NO.			
		DRAWN -	REVISED -		SCALE:	SHEET	OF	SHEETS	STA. 251+48	TO STA. 278+60	669	(11R)W-1	PEORIA	33	8
		PLOT SCALE = 200.0000' / in.	CHECKED -		REVISED -	CONTRACT NO. 68A71									
		PLOT DATE = 12/12/2012	DATE -		REVISED -	ILLINOIS FED. AID PROJECT									



EARTHWORK TABLE				
LOCATION	EARTH EXCAVATION	EARTH EX W/ SHRINKAGE 25%	EMBANKMENT	EXCESS EXCAVATION
	CU YD	CU YD	CU YD	CU YD
STA. 251+48 TO 256+00	136.9	102.7	94.5	8.2
STA. 256+00 TO 261+00	303.1	227.3	206.9	20.4
STA. 261+00 TO 267+00	396.1	297.1	141.1	156.0
STA. 267+00 TO 272+00	356.9	267.7	219.4	48.3
STA. 272+00 TO 278+60	321.0	240.8	226.6	14.2
TOTAL	1514	1136	889	247

TRENCH BACKFILL	
LOCATION	CU YD
STA. 254+44	4.1
STA. 261+04	0.2
STA. 261+28	0.3
TOTAL	5

SEEDING, CLASS 2A	
LOCATION	ACRE
STA. 251+48 TO 278+60	0.9
TOTAL	0.9

TEMP EROS CONTROL SEED	
LOCATION	POUND
STA. 251+48 TO 278+60	90
TOTAL	90

NITROGEN FERTILIZER NUTRIENT	
LOCATION	POUND
STA. 251+48 TO 278+60	81
TOTAL	81

TOPSOIL FURNISH & PLACE, 4"	
LOCATION	SQ YD
STA. 251+48 TO 256+00	705.6
STA. 256+00 TO 261+00	1048.5
STA. 261+00 TO 267+00	1030.5
STA. 267+00 TO 272+00	1064.7
STA. 272+00 TO 278+00	1381.5
TOTAL	5231

PHOSPHORUS FERTILIZER NUTRIENT	
LOCATION	POUND
STA. 251+48 TO 278+60	81
TOTAL	81

POTASSIUM FERTILIZER NUTRIENT	
LOCATION	POUND
STA. 251+48 TO 278+60	81
TOTAL	81

MULCH, METHOD 2	
LOCATION	ACRE
STA. 251+48 TO 278+60	0.9
TOTAL	0.9

TEMPORARY DITCH CHECK	
LOCATION	FOOT
STA. 251+48 TO 278+60	117
TOTAL	117

INLET AND PIPE PROTECTION	
LOCATION	EACH
STA. 254+31 TO 254+65	2
STA. 261+04	1
STA. 261+28	1
STA. 276+33	1
TOTAL	5

LOCATION	LENGTH FOOT	WIDTH FOOT	AREA SOYD	POLYMER BITUMINOUS MATERIALS (PRIME COAT)	POLYMER SURFACE COURSE 2"	HMA BINDER COURSE 8.5"
STA. 251+48 TO 256+28	480	12	400	0.09	44.80	190.40
STA. 256+28 TO 273+80	1752	12	2336.00	0.51	261.63	1111.94
STA. 273+80 TO 278+60	480	12	400	0.09	44.80	190.40
TOTAL			3136	0.7	351	1493

AGGREGATE BASE COURSE, TYPE A 8"	
LOCATION	SOYD
STA. 251+48 TO 256+28	440
STA. 256+28 TO 273+80	3212
STA. 273+80 TO 278+60	440
TOTAL	4092

PAVED SHOULDER REMOVAL	
LOCATION	SQ YD
STA. 251+48 TO 278+60	904.00
TOTAL	904

AGGREGATE SHOULDER TYPE B		
LOCATION	SQ YD	TON
STA. 251+48 TO 278+60	1258.80	430.5
TOTAL	1259	431

HMA SHOULDERS 10.5"	
LOCATION	SQ YD
STA. 251+48 TO 278+60	904.00
TOTAL	904

PIPE CULVERT REMOVAL	
LOCATION	FOOT
STA. 254+31 TO 254+65	33.6
STA. 261+04	3.5
TOTAL	38

METAL END SECTION 15"	
LOCATION	EACH
STA. 254+31	1
STA. 254+65	1
TOTAL	2

PIPE CULVERTS, CLASS D, TYPE 1 15"	
LOCATION	FOOT
STA. 254+31 TO 254+65	33.6
TOTAL	34

REINFORCEMENT BARS	
LOCATION	POUND
STA. 261+04	35
STA. 261+28	30
TOTAL	65

CONCRETE COLLAR	
LOCATION	CU YD
STA. 261+04	0.6
STA. 261+28	0.5
TOTAL	1.1

TRAFFIC CONTROL AND PROTECTION STANDARD 701201	
LOCATION	L. SUM
STA. 251+48 TO 278+60	1
TOTAL	1

PRECAST REINF. CONC. FLARED END SECTIONS 18"	
LOCATION	EACH
STA. 261+28	1
TOTAL	1

PIPE CULVERT, CLASS A, TYPE 1 18"	
LOCATION	FOOT
STA. 261+28	12
TOTAL	12

TRAFFIC CONTROL AND PROTECTION STANDARD 701326	
LOCATION	L. SUM
STA. 251+48 TO 278+60	1
TOTAL	1

PRECAST REINF. CONC. FLARED END SECTIONS 24"	
LOCATION	EACH
STA. 261+04	1
TOTAL	1

PIPE CULVERT, CLASS A, TYPE 1 EQUIV. ROUND-SIZE 24"	
LOCATION	FOOT
STA. 261+04	12
TOTAL	12

TRAFFIC CONTROL SURVEILLANCE	
LOCATION	CAL. DA.
STA. 251+48 TO 278+60	5
TOTAL	5

FILE NAME =  
D468A71-sht-plan.dgn

USER NAME = keithbr

DESIGNED -

REVISED -

DRAWN -

REVISED -

PLOT SCALE = 100.0000' / 1in.

CHECKED -

REVISED -

PLOT DATE = 12/12/2012

DATE -

REVISED -

**STATE OF ILLINOIS  
DEPARTMENT OF TRANSPORTATION**

**SCHEDULE OF QUANTITIES**

SCALE: SHEET OF SHEETS STA. TO STA.

F.A.P. RTE.	SECTION	COUNTY	TOTAL SHEETS	SHEET NO.
669	(IIR)W-1	PEORIA	33	10
			CONTRACT NO. 68A71	
ILLINOIS FED. AID PROJECT				

TEMPORARY & EPOXY PAVEMENT MARKING - LETTERS AND SYMBOLS (LT TURN ARROWS)	
LOCATION	SQ FT
STA. 258+18 TO 261+13	62.4
STA. 262+25 TO 265+92	46.8
STA. 266+92 TO 272+56	62.4
TOTAL	172

TEMPORARY & EPOXY PAVEMENT MARKING - LINE 12"	
FOR YELLOW DIAGONAL STRIPING IN MEDIAN	
LOCATION	FOOT
STA. 251+48 TO 258+18	121.5
STA. 273+39 TO 278+18	154.8
TOTAL	276

RAISED REFLECTIVE PAVEMENT MARKER	
LOCATION	EACH
STA. 251+48 to 278+60	42
TOTAL	42

TEMPORARY & EPOXY PAVEMENT MARKING - LINE 4"			
LOCATION (CENTER LINE)	FOOT	FOOT	FOOT
	YELLOW	WHITE	TOTAL
STA. 251+48 TO 261+13	2880.5	60	2940.5
STA. 262+25 TO 265+00	688.8		688.8
STA. 265+00 TO 266+92	244		244
STA. 266+92 TO 272+56	1428		1428
STA. 273+39 TO 278+60	1929.4		1929.4
SHOULDER STRIPING		2712	2712
TOTAL	7171	2772	9943

WORK ZONE PAVEMENT MARKING REMOVAL	
LOCATION	SQ FT
STA. 251+48 TO STA. 278+60	
RIGHT EOP	994.4
TOTAL	994

RAISED REFLECTIVE PAVEMENT MARKER REMOVAL	
LOCATION	EACH
STA. 251+48 to 278+60	34
TOTAL	34

TEMPORARY & EPOXY PAVEMENT MARKING - LINE 8"	
WHITE SOLID LINE FOR TURN LANE	
LOCATION	FOOT
STA. 258+07 TO 261+13	306
TOTAL	306

PAVEMENT MARKING REMOVAL	
LOCATION	SQ FT
STA. 251+48 TO STA. 278+60	
CENTERLINE	1808
RIGHT EOP	904
TOTAL	2712

REVTMENT MAT REMOVAL	
LOCATION	SQ YD
275+00 TO 276+88	489.56
TOTAL	490



Curve IL 116EXCL1

P.I. Station 272+90.82 N 1,466,283.3925 E 2,422,246.3946

Delta = 13° 39' 32.43" (RT)

Degree = 0° 27' 57.91"

Tangent = 1,472.2693

Length = 2,930.5800

Radius = 12,292.9766

External = 87.8493

Long Cord = 2,923.6453

Mid. Ord. = 87.2260

P.C. Station 258+18.55 N 1,466,299.9707 E 2,420,774.2187

P.T. Station 287+49.13 N 1,465,919.6391 E 2,423,673.0201

C.C. N 1,454,007.7735 E 2,420,635.7961

Back = S 89° 21' 17.35" E

Ahead = S 75° 41' 44.92" E

Chord Bear = S 82° 31' 31.13" E

BEGIN PROJECT

STA. 251+48

END PROJECT

STA. 256+28

FILE NAME =  
D468A71-sht-plan.dgn

USER NAME = keithbr

DESIGNED -

REVISED -

DRAWN -

REVISED -

PLOT SCALE = 200.0000' / in.

CHECKED -

REVISED -

PLOT DATE = 12/12/2012

DATE -

REVISED -

STATE OF ILLINOIS  
DEPARTMENT OF TRANSPORTATION

LINE DIAGRAM  
Not to Scale

SCALE: SHEET OF SHEETS STA. 251+10 TO STA. 278+50

F.A.P. RTE.	SECTION	COUNTY	TOTAL SHEETS	SHEET NO.
669	(11R)W-1	PEORIA	33	12
CONTRACT NO. 68A71				
ILLINOIS FED. AID PROJECT				

**BENCHMARK**

ELEVATION	DESCRIPTION
BM 176 702.48	Exist. chiseled $\square$ in center of concrete headwall, S.W. quadrant of T-intersection of IL-116 & Stone Church Road.

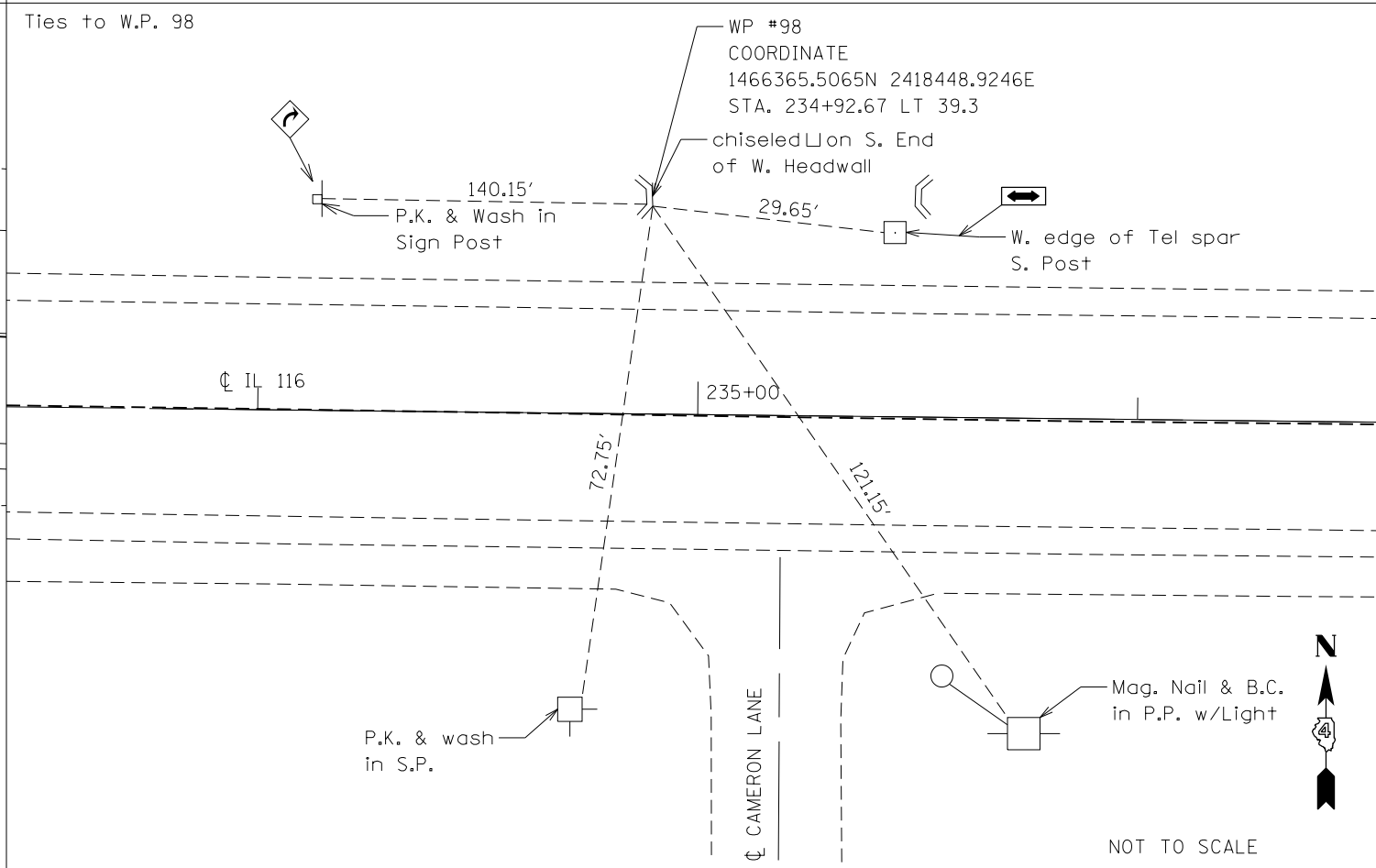
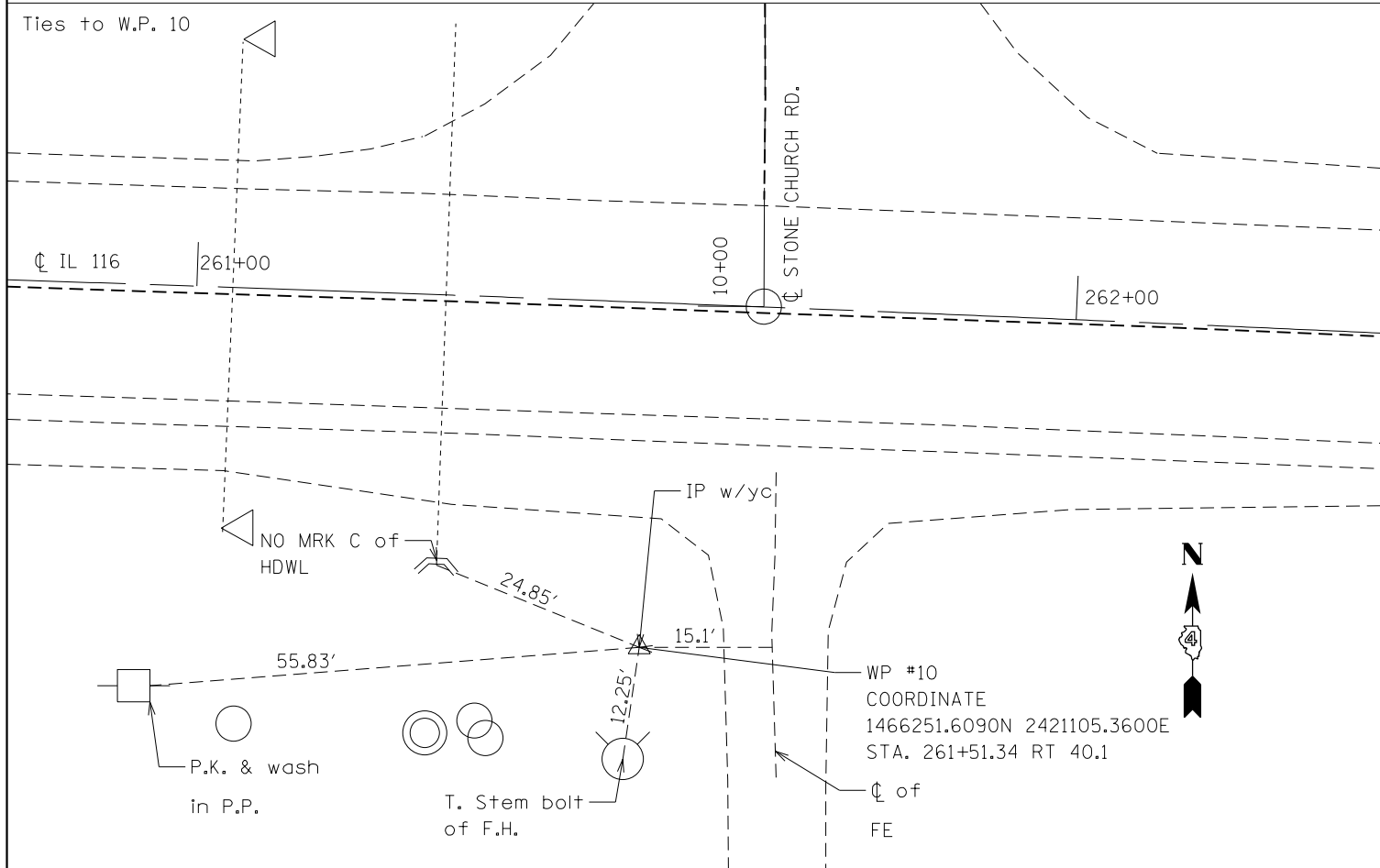

FILE NAME = D468A71-sht-plan.dgn	USER NAME = keathbr	DESIGNED -	REVISED -
		DRAWN -	REVISED -
	PLOT SCALE = 20.0000' / in.	CHECKED -	REVISED -
	PLOT DATE = 12/12/2012	DATE -	REVISED -

**STATE OF ILLINOIS  
DEPARTMENT OF TRANSPORTATION**

**BENCHMARKS & RECOVERY TIES**

SCALE: SHEET OF SHEETS STA. 250+00 TO STA. 265+00

F.A.P. RTE.	SECTION	COUNTY	TOTAL SHEETS	SHEET NO.
669	(11R)W-1	PEORIA	33	13
CONTRACT NO. 68A71				
ILLINOIS FED. AID PROJECT				

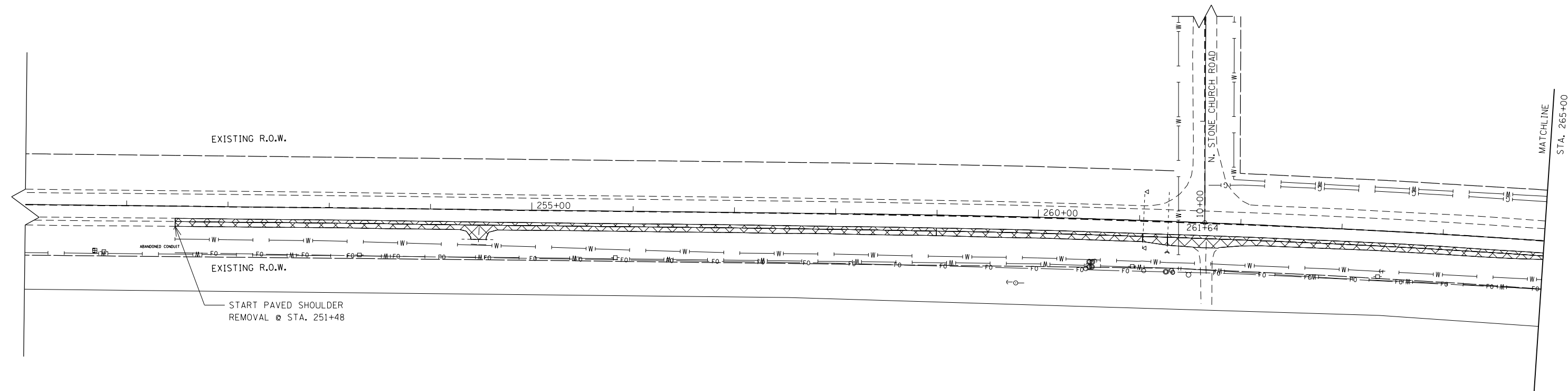

SYMBOLS

REMOVAL

GRAPHIC SCALE

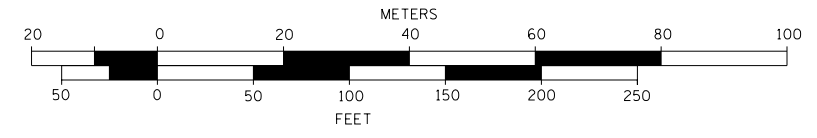

FILE NAME = D468A71-sht-pln.dgn	USER NAME = keithbr	DESIGNED -	REVISED -	<b>STATE OF ILLINOIS DEPARTMENT OF TRANSPORTATION</b>	<b>EXISTING/REMOVAL PLAN VIEW</b>				F.A.P. RTE. 669	SECTION (11R/W-1)	COUNTY PEORIA	TOTAL SHEETS 33	SHEET NO. 14
	PLOT SCALE = 100.0000' / in.	CHECKED -	REVISED -		SCALE:      SHEET      OF      SHEETS      STA. 250+00      TO      STA. 265+00				CONTRACT NO. 68A71				
	PLOT DATE = 12/12/2012	DATE -	REVISED -		ILLINOIS FED. AID PROJECT								

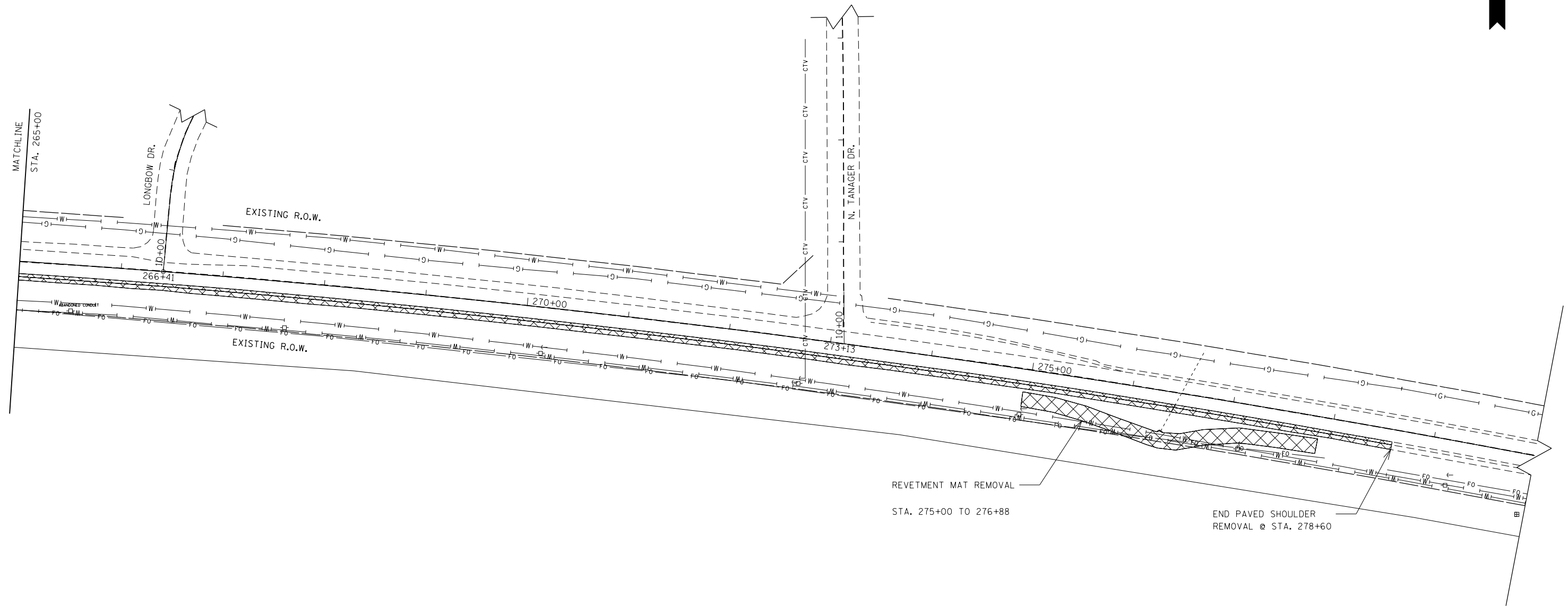

SYMBOLS

REMOVAL

GRAPHIC SCALE

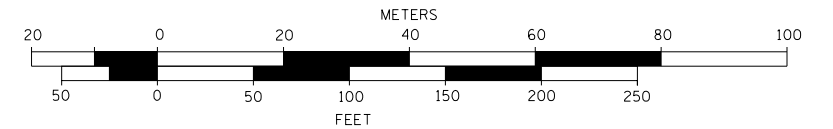

FILE NAME = D468A71-sht-plan.dgn	USER NAME = keithbr	DESIGNED -	REVISED -
		DRAWN -	REVISED -
	PLOT SCALE = 100.0000' / 1in.	CHECKED -	REVISED -
	PLOT DATE = 12/12/2012	DATE -	REVISED -

**STATE OF ILLINOIS  
DEPARTMENT OF TRANSPORTATION**

**EXISTING/REMOVAL PLAN VIEW**

SCALE: SHEET OF SHEETS STA. 265+00 TO STA. 280+00

F.A.P. RTE. 669	SECTION (11R/W-1)	COUNTY PEORIA	TOTAL SHEETS 33	SHEET NO. 15
CONTRACT NO. 68A71				
ILLINOIS FED. AID PROJECT				

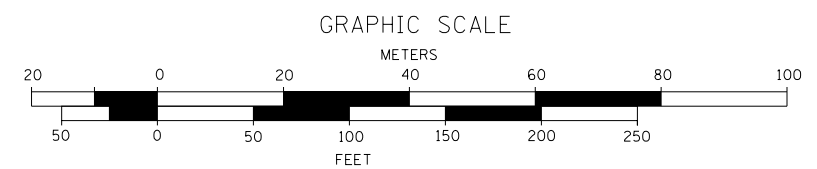
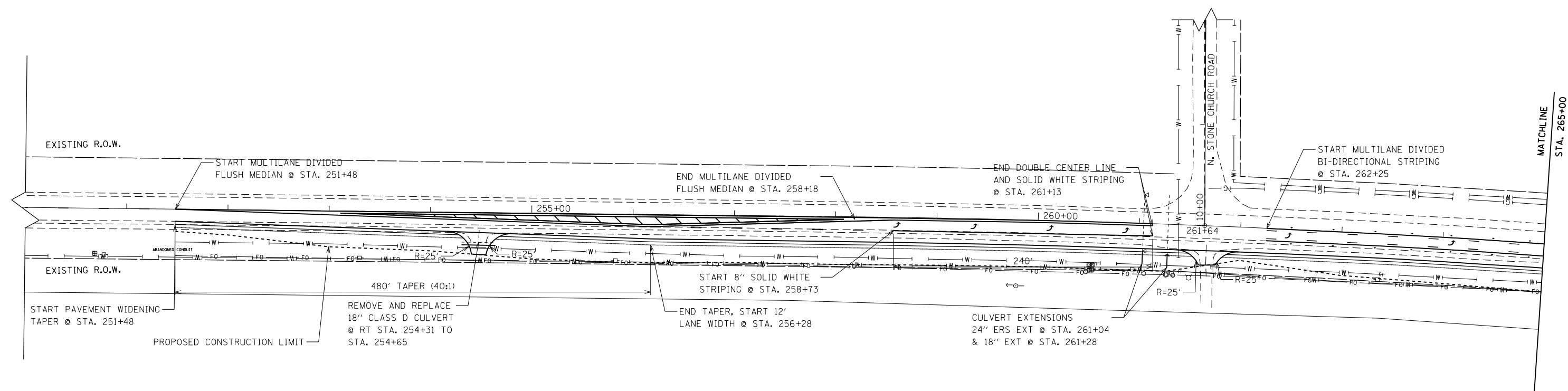

FILE NAME = D468A71-sht-plan.dgn	USER NAME = keithbr	DESIGNED -	REVISED -
		DRAWN -	REVISED -
	PLOT SCALE = 100.0000' / in.	CHECKED -	REVISED -
	PLOT DATE = 12/12/2012	DATE -	REVISED -

**STATE OF ILLINOIS  
DEPARTMENT OF TRANSPORTATION**

<b>PROPOSED PLAN VIEW</b>			
SCALE:	SHEET	OF SHEETS	STA. TO STA.

F.A.P. RTE. 669	SECTION (11R/W-1)	COUNTY PEORIA	TOTAL SHEETS 33	SHEET NO. 16
CONTRACT NO. 68A71				
ILLINOIS FED. AID PROJECT				



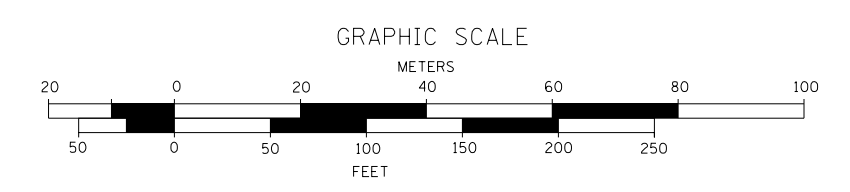
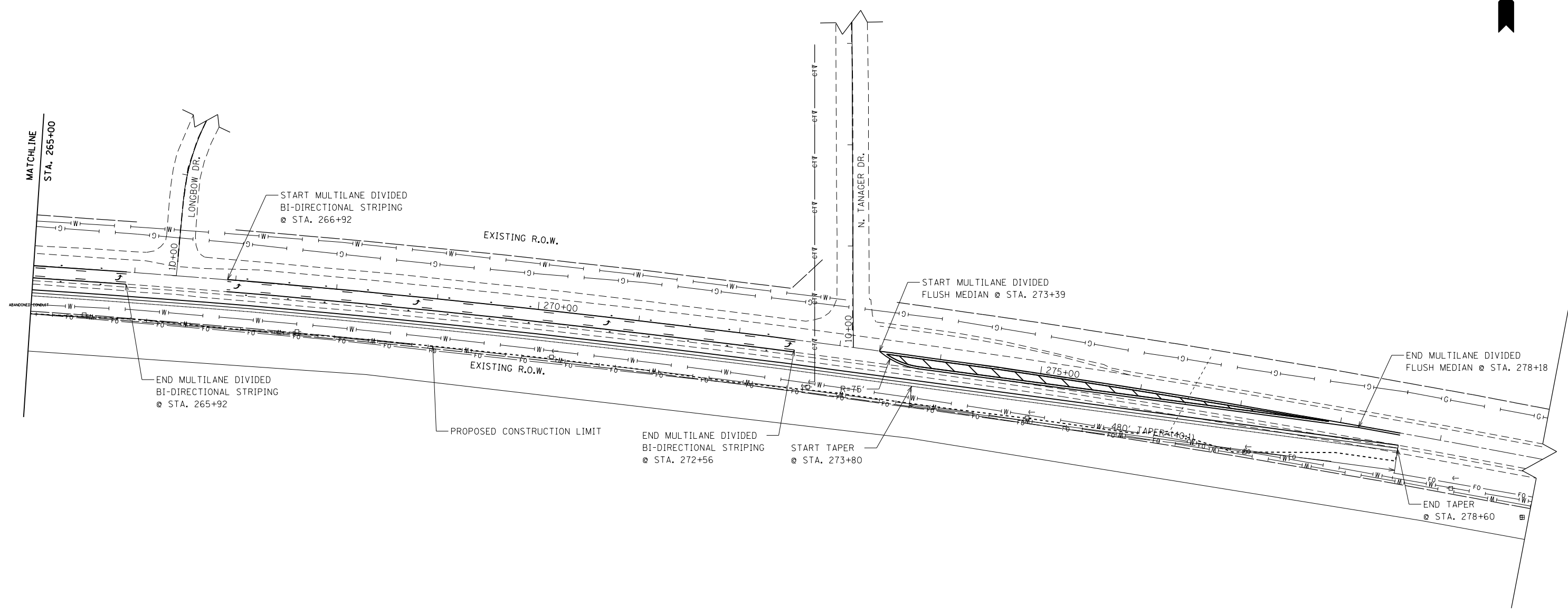

FILE NAME = D468A71-sht-plan.dgn	USER NAME = keithbr	DESIGNED -	REVISED -
		DRAWN -	REVISED -
	PLOT SCALE = 100.0000' / 1in.	CHECKED -	REVISED -
	PLOT DATE = 12/12/2012	DATE -	REVISED -



**STATE OF ILLINOIS  
DEPARTMENT OF TRANSPORTATION**

<b>PROPOSED PLAN VIEW</b>			
SCALE:	SHEET	OF SHEETS	STA. TO STA.

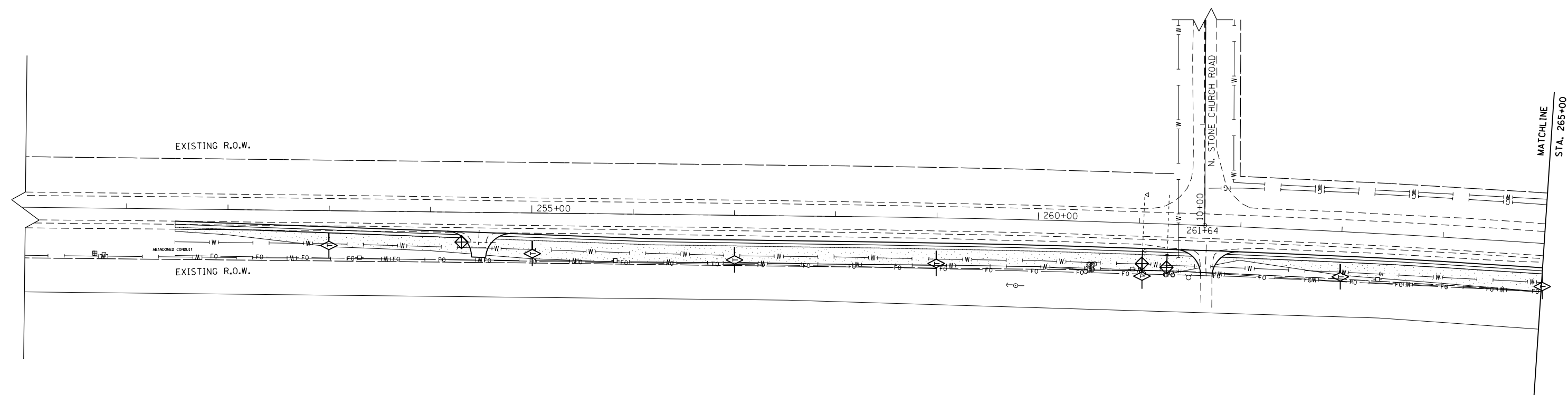
F.A.P. RTE. 669	SECTION (11R/W-1)	COUNTY PEORIA	TOTAL SHEETS 33	SHEET NO. 17
CONTRACT NO. 68A71				
ILLINOIS FED. AID PROJECT				

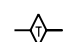

SYMBOLS

-  TEMPORARY DITCH CHECK
-  INLET AND PIPE PROTECTION
-  SEEDING, CLASS 2A

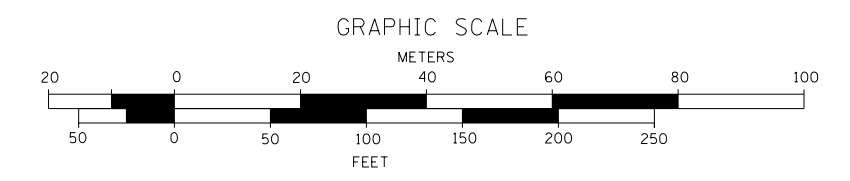

FILE NAME = D468A71-sht-plan.dgn	USER NAME = keithbr	DESIGNED -	REVISED -	<b>STATE OF ILLINOIS DEPARTMENT OF TRANSPORTATION</b>	<b>EROSION CONTROL PLAN VIEW</b>			F.A.P. RTE.	SECTION	COUNTY	TOTAL SHEETS	SHEET NO.	
	PLOT SCALE = 100.0000' / in.	CHECKED -	REVISED -					669	(11R)W-1	PEORIA	33	18	
PLOT DATE = 12/12/2012	DATE -	REVISED -	SCALE:		SHEET	OF	SHEETS	STA.	TO	STA.	CONTRACT NO. 68A71		
										ILLINOIS FED. AID PROJECT			

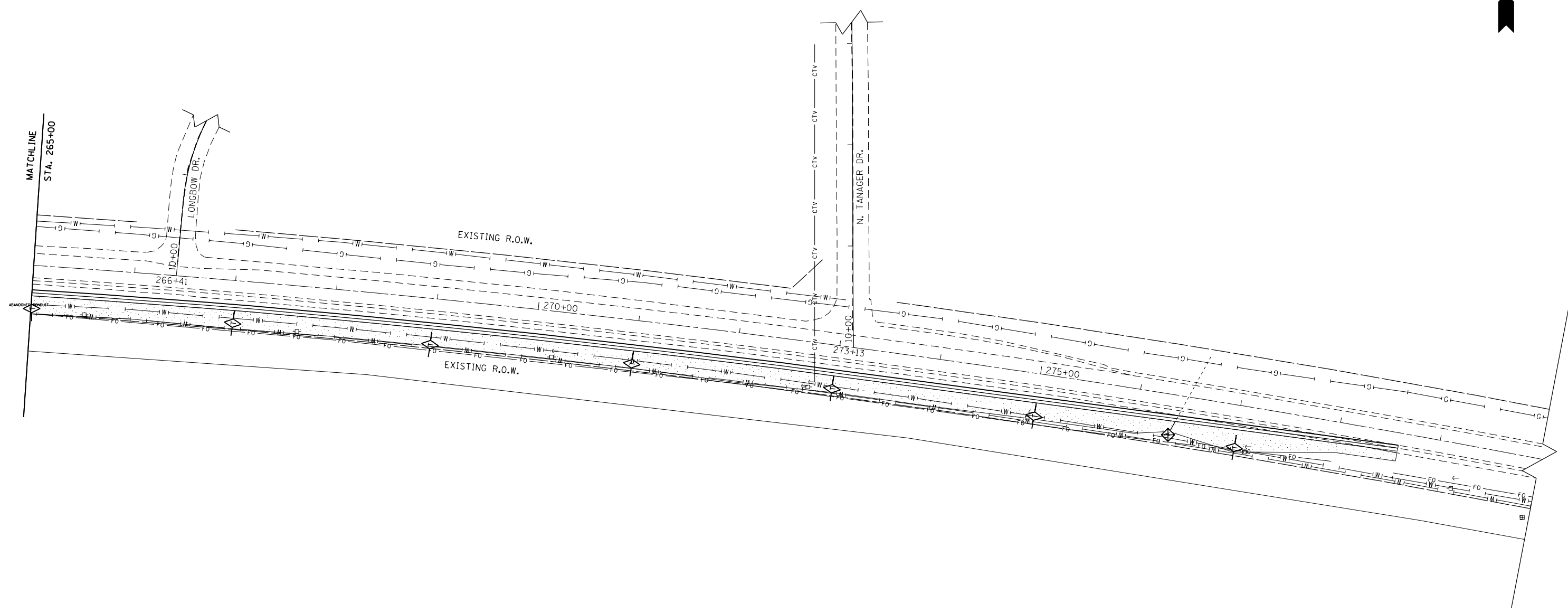

**SYMBOLS**

- TEMPORARY DITCH CHECK
- INLET AND PIPE PROTECTION
- SEEDING, CLASS 2A

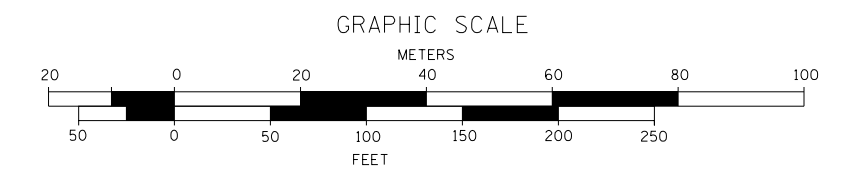

FILE NAME = D468A71-sht-plan.dgn	USER NAME = keithbr	DESIGNED -	REVISED -	<b>STATE OF ILLINOIS DEPARTMENT OF TRANSPORTATION</b>	<b>EROSION CONTROL PLAN VIEW</b>			F.A.P. RTE.	SECTION	COUNTY	TOTAL SHEETS	SHEET NO.
	PLOT SCALE = 100.0000' / in.	CHECKED -	REVISED -					669	(11R/W-1)	PEORIA	33	19
PLOT DATE = 12/12/2012	DATE -	REVISED -	REVISED -		SCALE: SHEET OF SHEETS STA. TO STA.			CONTRACT NO. 68A71				
							ILLINOIS FED. AID PROJECT					

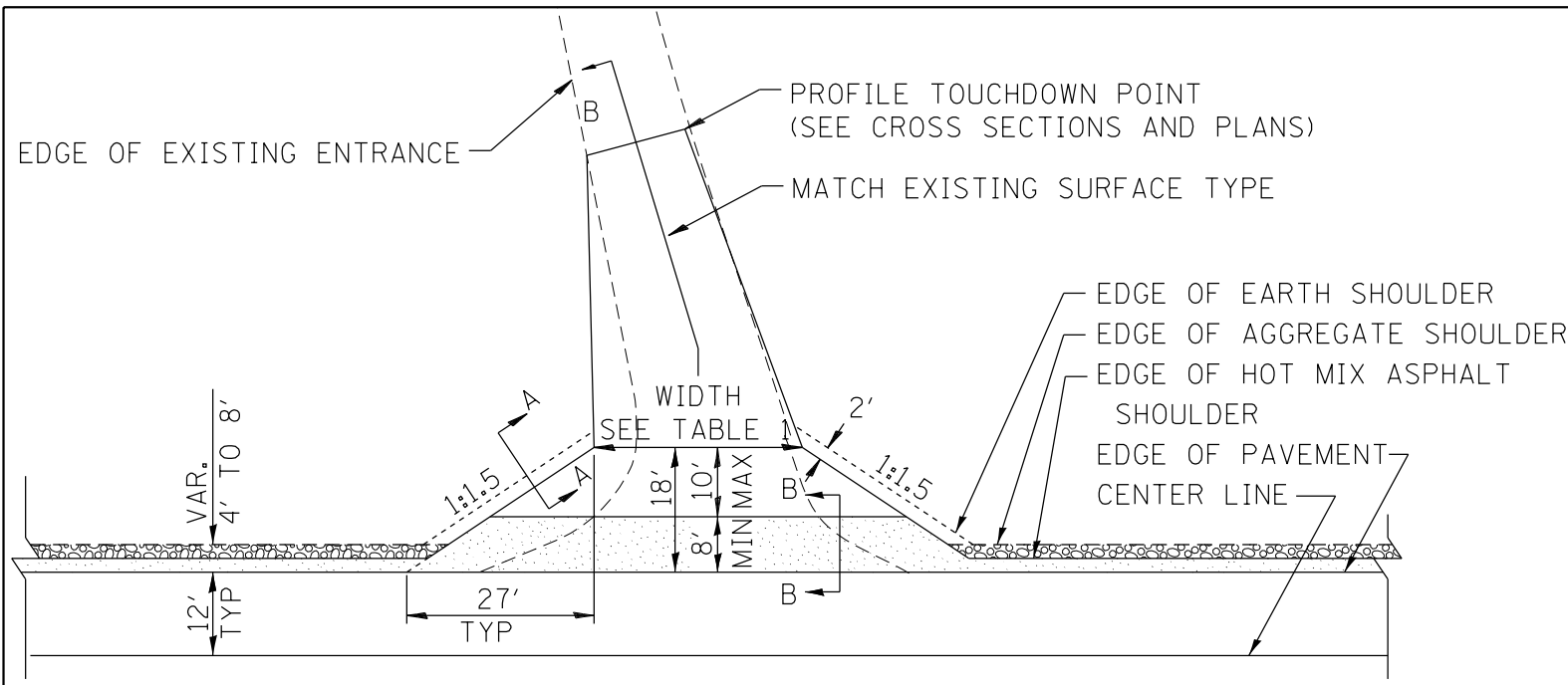

HOT MIX ASPHALT SHOULDER, 8"  
 AGGREGATE SHOULDER, TYPE B, 6"

**PLAN**

COMMERCIAL / FARM-RELATED ENTRANCE

TABLE 1					
RURAL ENTRANCE DESIGN					
ELEMENT	NON-COMMERCIAL		NON-COMMERCIAL W/ LARGE FARM EQUIPMENT	COMMERCIAL	
	12'(3.6m) Min.	24'(7.2m) Max.	20' (6.1m)Max.	30' (9.0m)Max.	
WIDTH (W)	12'(3.6m) Min.	24'(7.2m) Max.	20' (6.1m)Max.	30' (9.0m)Max.	14'(4.3m) Min., 24'(7.2m) Max., 24'(7.2m) Min., 35'(10.7m) Max.
FLARE	1:1.5				
MAX. GRADE (G)	12%		12%		10%

SURFACE TYPE			
INCIDENTAL HOT MIX ASPHALT SURFACING	6"	—	8"
AGGREGATE SURFACE COURSE	6"	8"	8"
PCC DRIVEWAY PAVEMENT	6"	—	7"

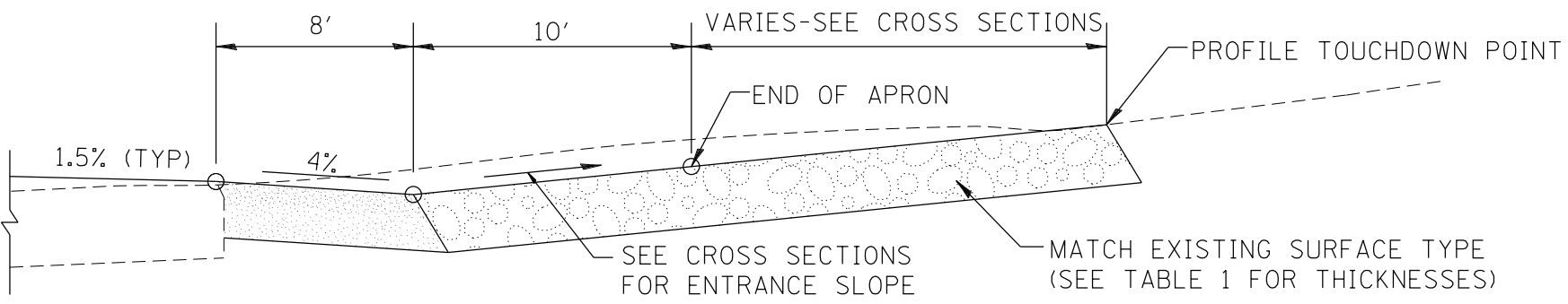

SECTION B-B  
RECONSTRUCTED RURAL ENTRANCE  
(EXISTING ENTRANCE HIGHER THAN APRON)

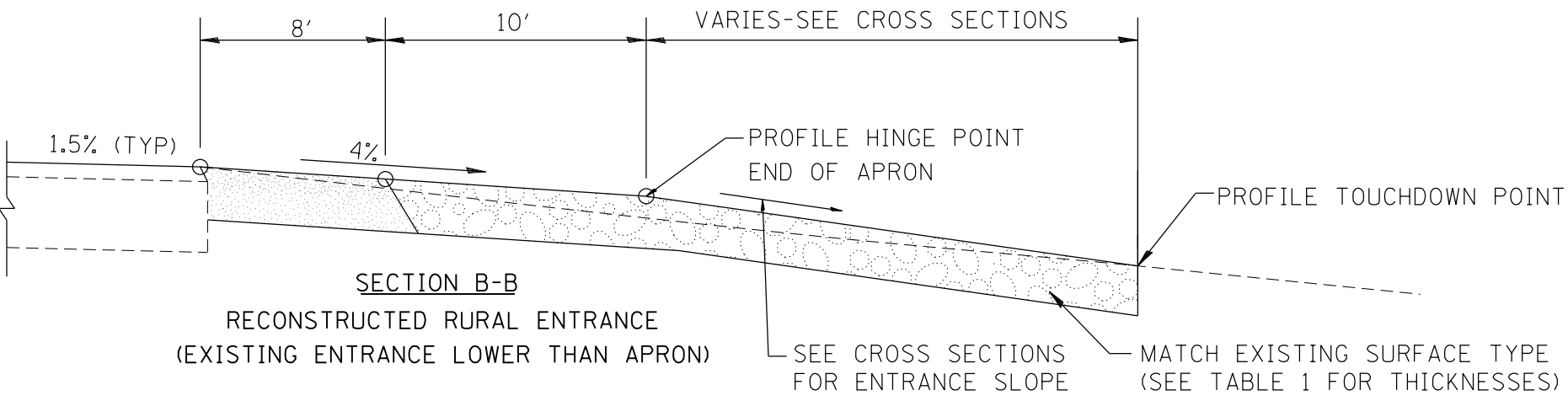

SECTION B-B  
RECONSTRUCTED RURAL ENTRANCE  
(EXISTING ENTRANCE LOWER THAN APRON)

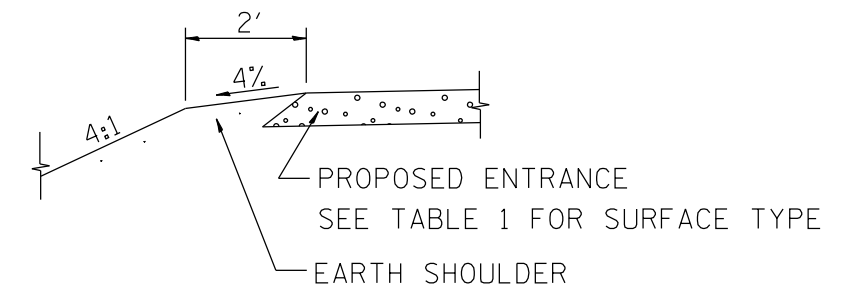

SECTION A-A  
SHOULDER TREATMENT FOR RURAL ENTRANCES

GENERAL NOTES

- ENTRANCES SHALL SLOPE AWAY FROM THE PAVEMENT AT A RATE EQUAL TO THE SHOULDER SLOPE FOR A MINIMUM DISTANCE OF 8'.
- A MINIMUM 8' PAVED SHOULDER SHALL BE CONSTRUCTED BETWEEN LOCATIONS WHERE THE RURAL ENTRANCE IS LESS THAN 50' FROM AN ADJACENT SIDEROAD, ENTRANCE OR MAILBOX TURNOUT.
- A TAPER RATE OF 5:1 IS DESIRABLE WHEN TRANSITING FROM THE RURAL ENTRANCE WIDTH SHOWN IN TABLE 1, TO THE EXISTING ENTRANCE WIDTH.

All dimensions are in inches (millimeters) unless otherwise noted.

01-01-97	RENUM. C-103.06, NEW REVISION BOX	T.P.	10-16-06	REVISED TO 2007 SPEC.	M.A.
07-01-97	REVISE DESIGNER NOTES	J.A.			
01-17-03	ADJUST DESIGN, CHANGE ENTRANCE	JATR			
09-15-05	RADIUS FOR FLARE	M.M.A.			

STATE OF ILLINOIS  
DEPARTMENT OF TRANSPORTATION

RURAL ENTRANCES FOR "3R" PROJECTS  
NOT TO SCALE  
SHT. 1 OF 2  
CADD STD. 406301-D4

F.A.P. RTE.	SECTION	COUNTY	TOTAL SHEETS	SHEET NO.
669	(11R)W-1	PEORIA	33	20
FED. ROAD DIST. NO.			ILLINOIS FED. AID PROJECT	
			CONTRACT NO. 68A71	

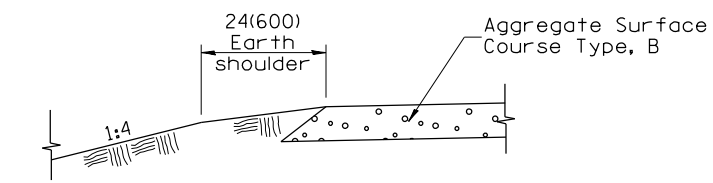

**SECTION A-A**  
SHOULDER TREATMENT FOR AGGREGATE ENTRANCES

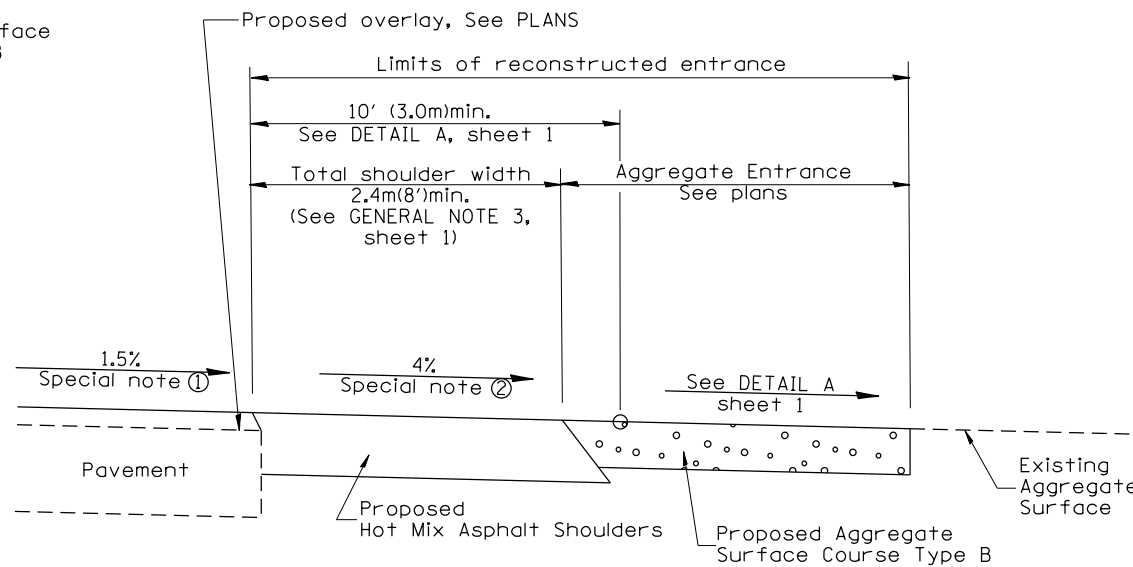

**SECTION B-B**  
RECONSTRUCTED AGGREGATE ENTRANCE

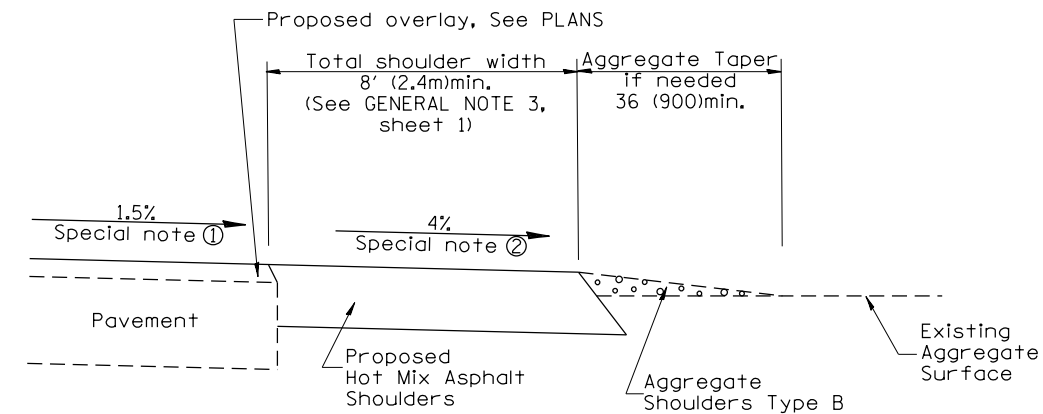

**SECTION B-B**  
EXISTING AGGREGATE ENTRANCE

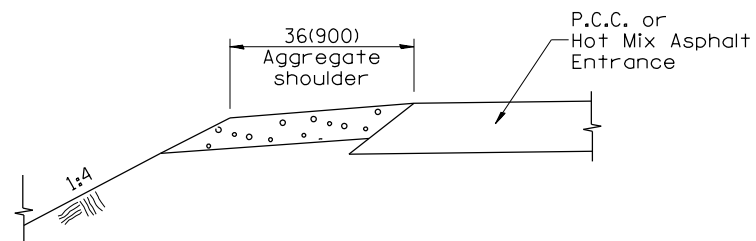

**SECTION C-C**  
SHOULDER TREATMENT FOR P.C.C. OR HOT MIX ASPHALT ENTRANCES

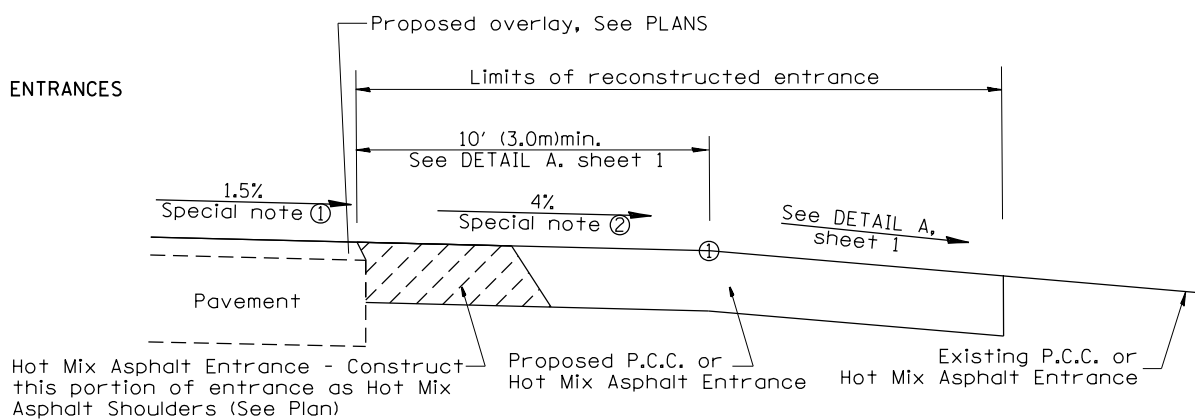

**SECTION D-D**  
RECONSTRUCTED P.C.C. OR HOT MIX ASPHALT ENTRANCE

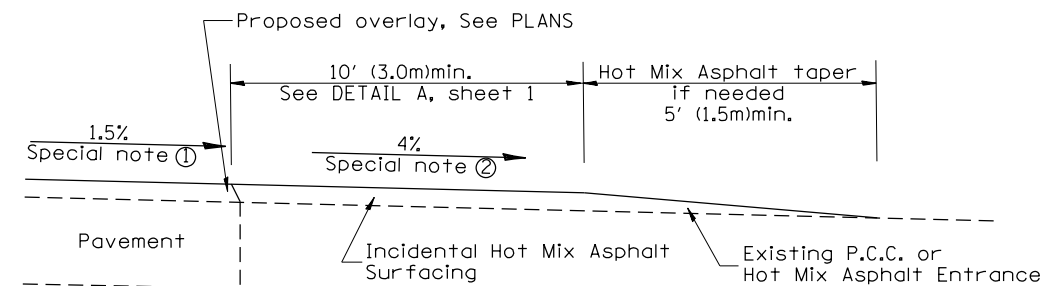

**SECTION D-D**  
EXISTING P.C.C. OR HOT MIX ASPHALT ENTRANCE

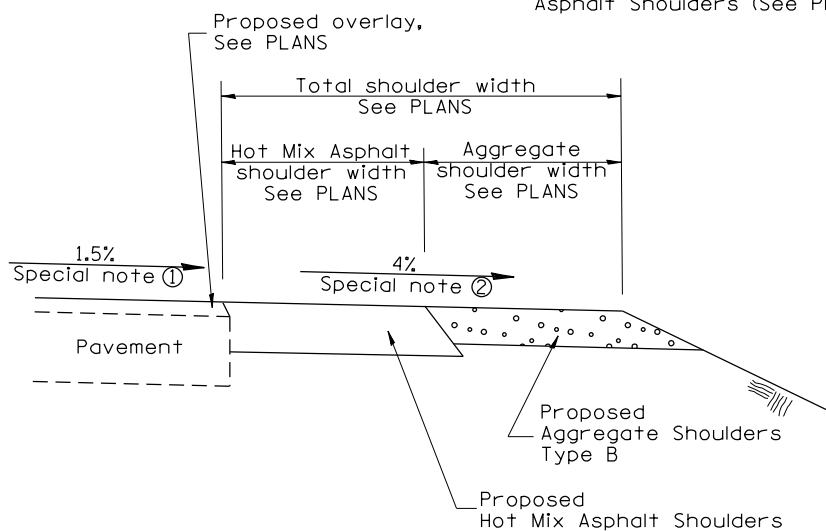

**SECTION E-E**  
MAINLINE SHOULDER TREATMENT

**SPECIAL NOTES**

- ① The mainline pavement cross-slope is 1.5% for tangent alignment. See PLANS for cross-slope on super-elevated horizontal curves.
- ② The shoulder slope shall control the entrance profile for a distance of 10' (3.0m) minimum from the pavement edge. The shoulder cross-slope is 4% for tangent alignment. Through super-elevated curves, the maximum pavement-shoulder breakover should not be greater than 10% for shoulders 6' (1.8m) and wider and 12% for shoulders 4' (1.2m) and less. Where 12' (366cm) paved shoulders are provided, the breakover should be at the edge of the paved shoulder rather than at the pavement edge.

All dimensions are in inches (millimeters) unless otherwise noted.

STATE OF ILLINOIS DEPARTMENT OF TRANSPORTATION				RURAL ENTRANCES FOR "3R" PROJECTS				F.A.P. RTE.	SECTION	COUNTY	TOTAL SHEETS	SHEET NO.
								669	(11R)W-1	PEORIA	33	21
NOT TO SCALE				SHT. 2 OF 2 CADD STD. 406301-D4				CONTRACT NO. 68A71				
								FED. ROAD DIST. NO. ILLINOIS FED. AID PROJECT				

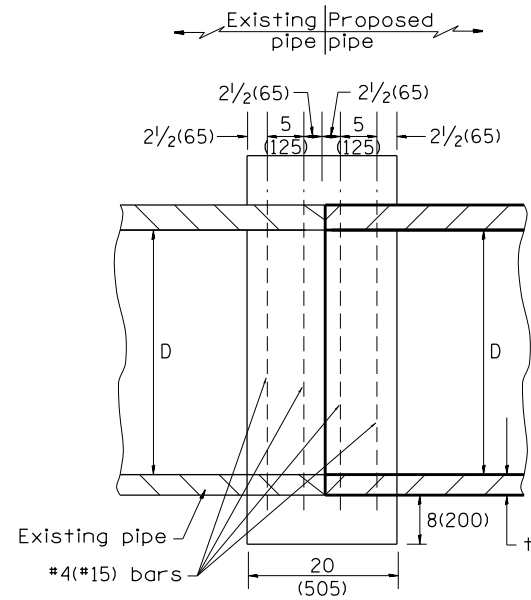

SECTION A - A

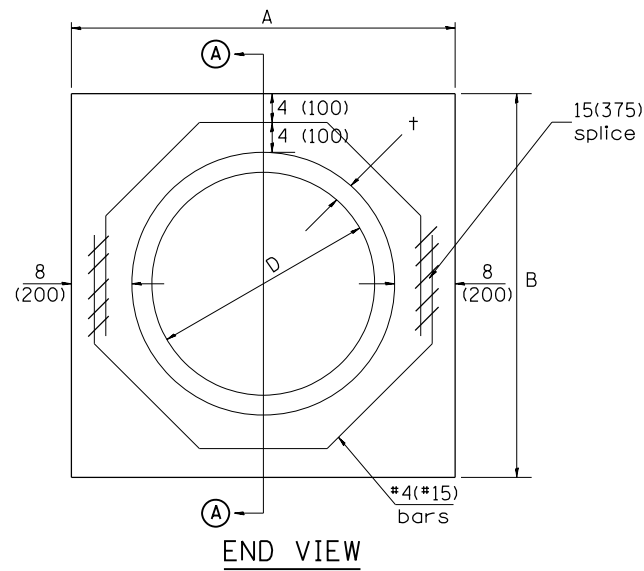

END VIEW

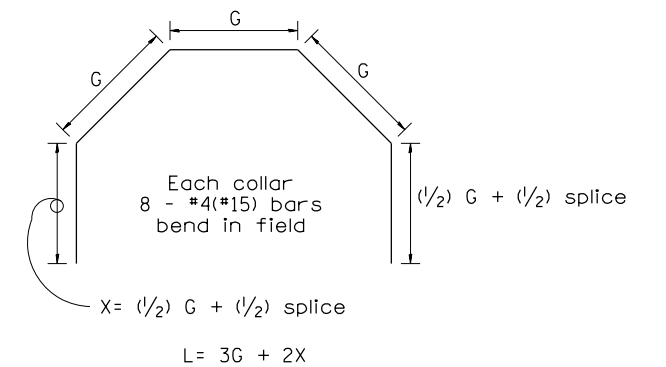

Each Collar									
					Reinforcement Bars				
D	t	A	B	CL. SI CONC.	G	X	L	Weight	
in (mm)	in (mm)	ft (m)	ft (m)	cu.yd. (m <sup>3</sup> )	in (mm)	in (mm)	ft (m)	lb (kg)	
12 (300)	2.00 (51)	2.67 (0.814)	2.67 (0.814)	0.4 (0.270)	9 <sup>15</sup> / <sub>16</sub> (253)	12 <sup>7</sup> / <sub>16</sub> (317)	4.57 (1.393)	24 (11)	
15 (375)	2.25 (57)	2.96 (0.902)	2.96 (0.902)	0.4 (0.315)	11 <sup>3</sup> / <sub>8</sub> (290)	13 <sup>3</sup> / <sub>16</sub> (335)	5.05 (1.541)	27 (12)	
18 (450)	2.50 (64)	3.25 (0.991)	3.25 (0.991)	0.5 (0.362)	12 <sup>13</sup> / <sub>16</sub> (327)	13 <sup>7</sup> / <sub>8</sub> (354)	5.54 (1.689)	30 (14)	
21 (525)	2.75 (70)	3.54 (1.079)	3.54 (1.079)	0.5 (0.411)	14 <sup>1</sup> / <sub>4</sub> (364)	14 <sup>5</sup> / <sub>8</sub> (372)	6.02 (1.836)	32 (15)	
24 (600)	3.00 (76)	3.83 (1.167)	3.84 (1.167)	0.6 (0.460)	15 <sup>11</sup> / <sub>16</sub> (401)	15 <sup>5</sup> / <sub>16</sub> (391)	6.51 (1.984)	35 (16)	
27 (675)	3.25 (83)	4.13 (1.259)	4.13 (1.259)	0.7 (0.516)	17 <sup>1</sup> / <sub>4</sub> (438)	16 <sup>1</sup> / <sub>16</sub> (409)	6.99 (2.131)	37 (17)	
30 (750)	3.50 (89)	4.42 (1.347)	4.42 (1.347)	0.7 (0.570)	18 <sup>11</sup> / <sub>16</sub> (475)	16 <sup>3</sup> / <sub>4</sub> (428)	7.48 (2.279)	40 (18)	
33 (825)	3.75 (95)	4.71 (1.436)	4.71 (1.436)	0.8 (0.624)	20 <sup>1</sup> / <sub>8</sub> (512)	17 <sup>1</sup> / <sub>2</sub> (446)	7.96 (2.426)	43 (19)	
36 (900)	4.00 (102)	5.00 (1.524)	5.00 (1.524)	0.9 (0.682)	21 <sup>9</sup> / <sub>16</sub> (549)	18 <sup>3</sup> / <sub>16</sub> (465)	8.44 (2.574)	45 (20)	
42 (1050)	4.50 (114)	5.58 (1.701)	5.58 (1.701)	1.0 (.800)	24 <sup>7</sup> / <sub>16</sub> (622)	19 <sup>3</sup> / <sub>4</sub> (501)	9.41 (2.869)	50 (23)	
48 (1200)	5.00 (127)	6.17 (1.881)	6.17 (1.881)	1.2 (0.930)	27 <sup>5</sup> / <sub>16</sub> (696)	21 <sup>3</sup> / <sub>16</sub> (538)	10.38 (3.164)	55 (25)	

GENERAL NOTES

1. THE COLLAR SHALL BE CONSTRUCTED ENTIRELY OF CLASS SI CONCRETE IN ACCORDANCE WITH THE APPLICABLE PORTIONS OF SECTION 503 OF THE STANDARD SPECIFICATIONS. REINFORCEMENT BARS SHALL CONFORM TO SECTION 508.
2. This work shall be paid for by the cubic yard (cubic meter) for CONCRETE COLLAR and by the pound (kg) for REINFORCEMENT BARS.

QUANTITIES	
CALC. BY: R. J. D.	2-2-98 DATE:
CHECKED BY: R. D. H.	2-6-98 DATE:

QUANTITY CALCULATIONS ARE ON FILE AT THE DISTRICT 4 OFFICE; BUREAU OF PROJECT IMPLEMENTATION; DOCUMENTATION SECTION

All dimensions are in inches (millimeters) unless otherwise noted.

01-01-97	RENUM. B-8.03, NEW REVISION BOX, REVISED	T.P.	09-01-00	CORRECT WEIGHT	J.A.	<b>STATE OF ILLINOIS DEPARTMENT OF TRANSPORTATION</b>	<b>PIPE CULVERT EXTENSION COLLAR (WITHOUT END SECTION)</b>	F.A.P. RTE.	SECTION	COUNTY	TOTAL SHEETS	SHEET NO.	
	TITLE BOX, ADDED QUANTITY CALCULATION BOX		10-16-06	REV. TO 2007 SPEC., CORRECT mm UNITS	M.A.			669	(11R)W-1	PEORIA	33	22	
04-01-97	CORRECT BAR	J.A.	2-15-11	ADDED GENERAL NOTE #2	R.D.			CONTRACT NO. 68A71					
02-10-98	REVISE QUANTITIES	J.A.						FED. ROAD DIST. NO. ILLINOIS FED. AID PROJECT					

NOT TO SCALE

CADD STD. 542016-D4

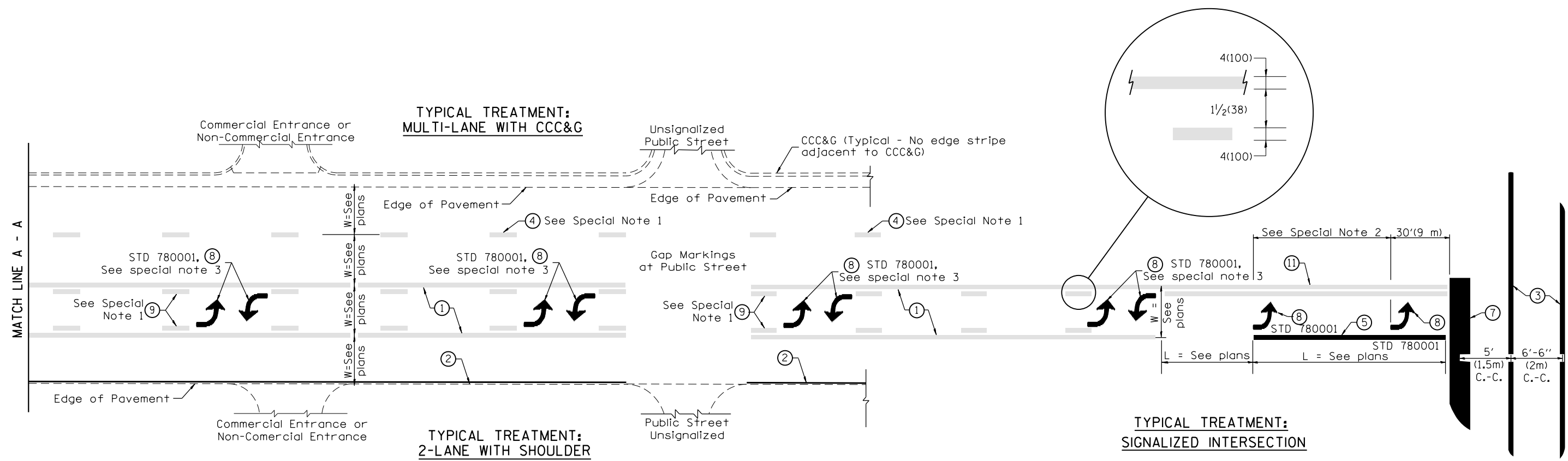

**FLUSH PAVED MEDIAN: TWO-WAY LEFT TURN LANE WITH ONE-WAY LEFT TURN LANE AT SIGNALIZED INTERSECTION**

**TYPICAL PAVEMENT MARKING LEGEND**

(Note: This is a District Standard Legend. Some elements may not apply to specific project.)

- ① 4(100) Solid (Yellow)
- ② 4(100) Solid (White)
- ③ 2-6(150) Crosswalk @ 6'-6" (2m)min C.-C. (White)  
2-8(200) Crosswalk @ 6'-6" (2m)min C.-C. (White) (When traffic signals are present.)
- ④ 6(150) Skip-Dash (White) (See Special Note 1)
- ⑤ 8(200) Solid (White)
- ⑥ 12(300) Diagonal (White) (Item ⑥ is shown on Std. 780001)
- ⑦ 24(600) Stop Bar (White)
- ⑧ Letters & Arrows (See Std. 780001 and Special Notes 2 & 3)
- ⑨ 4(100) Skip-Dash (Yellow) (See Special Note 1)
- ⑩ 12(300) Diagonal (Yellow) (See Table A) (See Table A)
- ⑪ 4(100) Double Solid (Yellow) (See Table A)

**SPECIAL NOTES**

1. Skip-Dash markings will be centered between both ends of city blocks and shall be placed in alignment transversely across the pavement.
2. The following shall apply to arrows located in one-way left turn lanes:
  - A. A minimum of two (2) arrows is required.
  - B. The maximum spacing between arrows is 80' (24 m).
  - C. Arrows shall be evenly spaced if three (3) or more are required.
3. The following shall apply to arrow pairs located in two-way left turn lanes:
  - A. A minimum of two (2) arrow pairs is required.
  - B. The maximum spacing between arrow pairs is 200' (61 m).
  - C. Arrow pairs shall be evenly spaced if three (3) or more are required.
  - D. The spacing between Bi Directional Left Turn Arrows is 33' (10 m).

**GENERAL NOTES**

1. Refer to State Standard 780001 for additional Pavement Markings including letters & arrows.
2. See Plans for Pavement Markings adjacent to curbed islands and medians, and through lane reductions.

01-01-97	RENUM. F-8.03, NEW REVISION BOX	T.P.	10-16-06	REVISED TO 2007 SPEC.	<b>STATE OF ILLINOIS DEPARTMENT OF TRANSPORTATION</b>	<b>TYPICAL PAVEMENT MARKINGS</b>	F.A.P. RTE.	SECTION	COUNTY	TOTAL SHEETS	SHEET NO.
02-07-97	ADD BI DIRECTIONAL DIMENSION	J.A.					669	(11R/W-1	PEORIA	33	23
10-97	CORRECT BI DIRECTIONAL DIMENSION	J.A.					SHT. 1 OF 2 CADD STD. 780001-D4				
08-02	ADD CROSSWALK DMNS. WITH T.S.	M.A.					CONTRACT NO. 68A71				
						NOT TO SCALE	ILLINOIS FED. AID PROJECT				

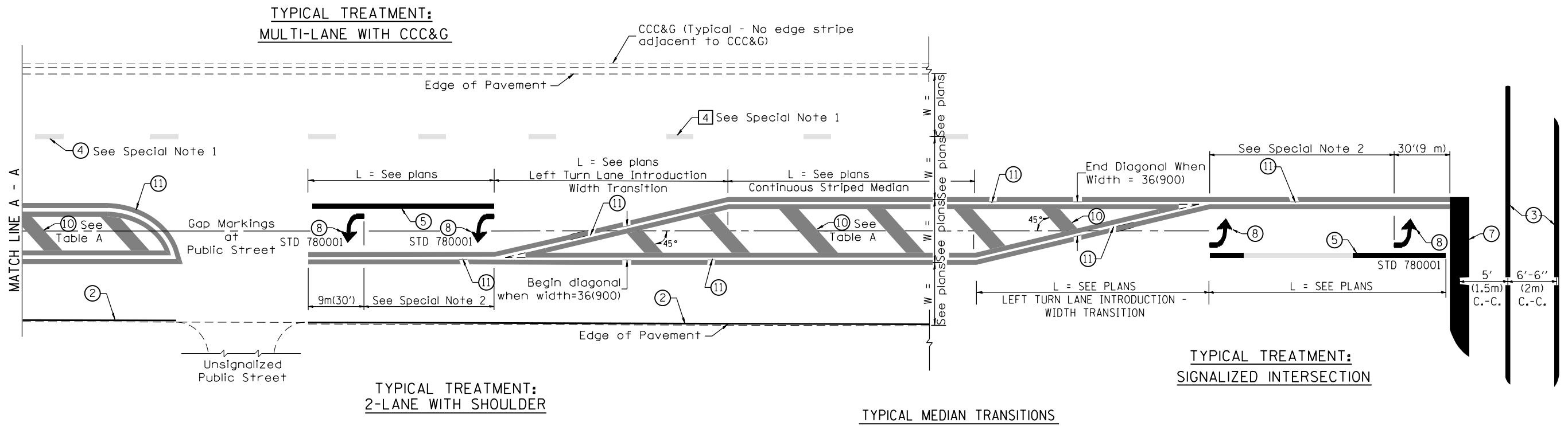

**FLUSH PAVED MEDIAN: RESTRICTED LEFT TURN LANE**

**TABLE A**  
RECOMMENDED SPACING BETWEEN DIAGONAL LINES

SPEED LIMIT RANGE	INTERSECTION CHANNELIZATION (Includes Width Transitions for Median and Left Turn Lane Introductions)	
	CONTINUOUS	
Less Than 30 mph (50 km/h)	50' (15m)	15' (5m)
30 - 45 mph (50 - 70 km/h)	75' (23m)	20' (6m)
Over 45 mph (70 km/h)	150' (46m)	30' (9m)

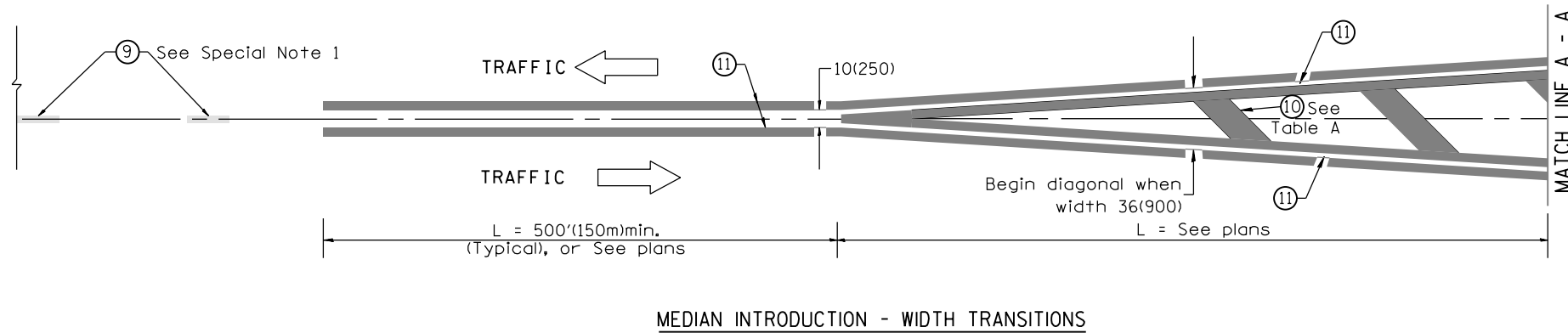

All dimensions are in inches (millimeters) unless otherwise noted.



DATE	
BY	
ORIGINAL SURVEY	
SURVEYED	
PLOTTED	
TEMPLATE	
AREAS	
CHECKED	
NO.	

DATE	
BY	
ORIGINAL SURVEY	
SURVEYED	
PLOTTED	
TEMPLATE	
AREAS	
CHECKED	
NO.	

UNLESS ELEVATIONS ARE SHOWN ----  
ALL UTILITY LOCATIONS SHOWN ON THE CROSS-SECTIONS  
ARE BASED ON THE APPROXIMATE DEPTH SUPPLIED BY  
THE UTILITY COMPANY

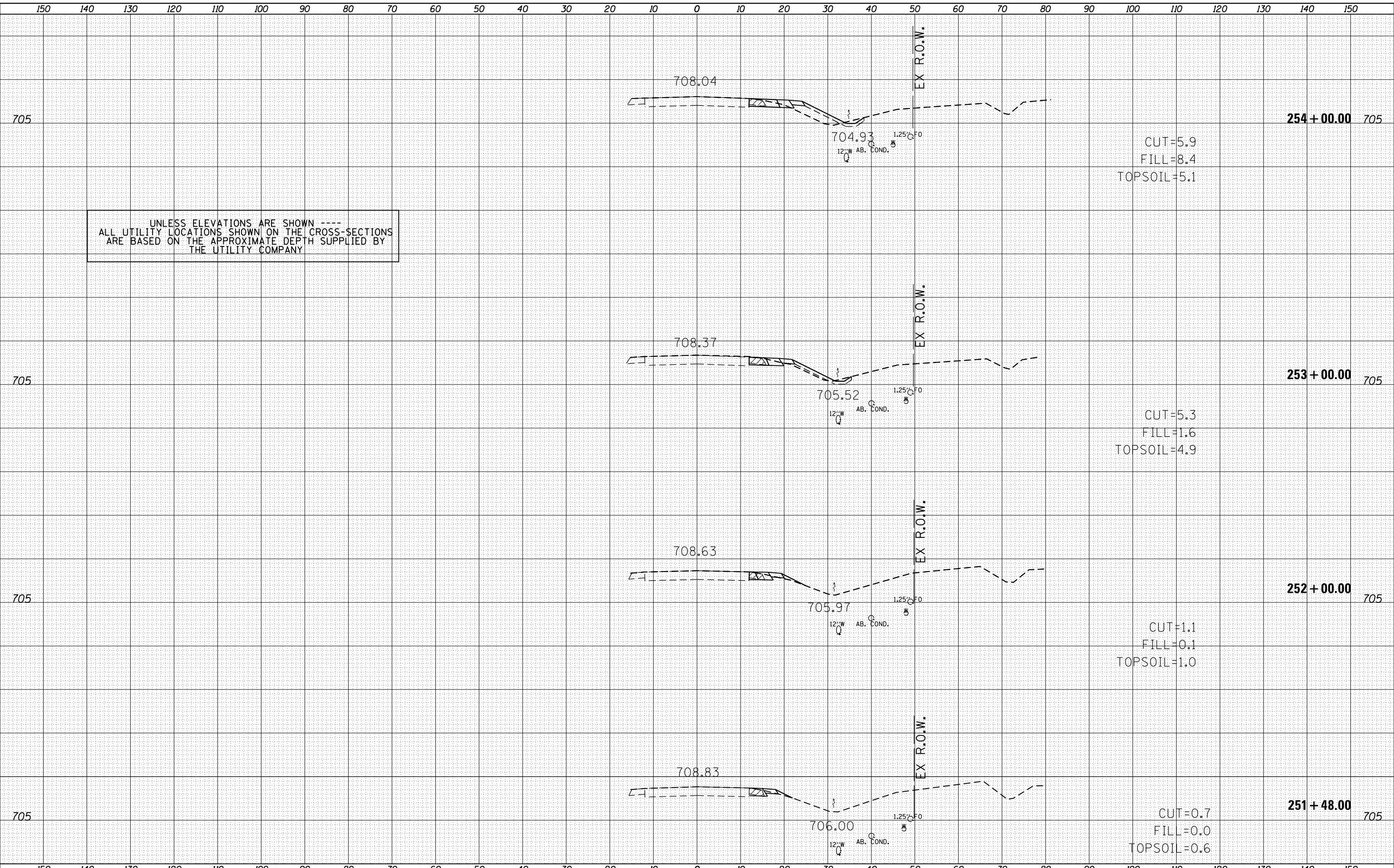

FILE NAME = D468A71-sht-plan.dgn	USER NAME = kesthbr	DESIGNED -	REVISD -	<b>STATE OF ILLINOIS</b> <b>DEPARTMENT OF TRANSPORTATION</b>	<b>CROSS SECTIONS IL 116</b> SCALE: SHEET OF SHEETS STA. 251+48.00 TO STA. 254+00.00	F. # AP RTE. 669	SECTION (11R/W-1)	COUNTY PEORIA	TOTAL SHEETS 33	SHEET NO. 25		
	PLOT SCALE = 20.0000' / in.	CHECKED -	REVISD -			CONTRACT NO. 68A71		ILLINOIS FED. AID PROJECT				
	PLOT DATE = 12/12/2012	DATE -	REVISD -									

DATE	
BY	
FINAL SURVEY	
NOTE BOOK	
NO.	
SURVEYED	
PLOTTED	
TEMPLATE	
AREAS	
CHECKED	

DATE	
BY	
ORIGINAL SURVEY	
NOTE BOOK	
NO.	
SURVEYED	
PLOTTED	
TEMPLATE	
AREAS	
CHECKED	

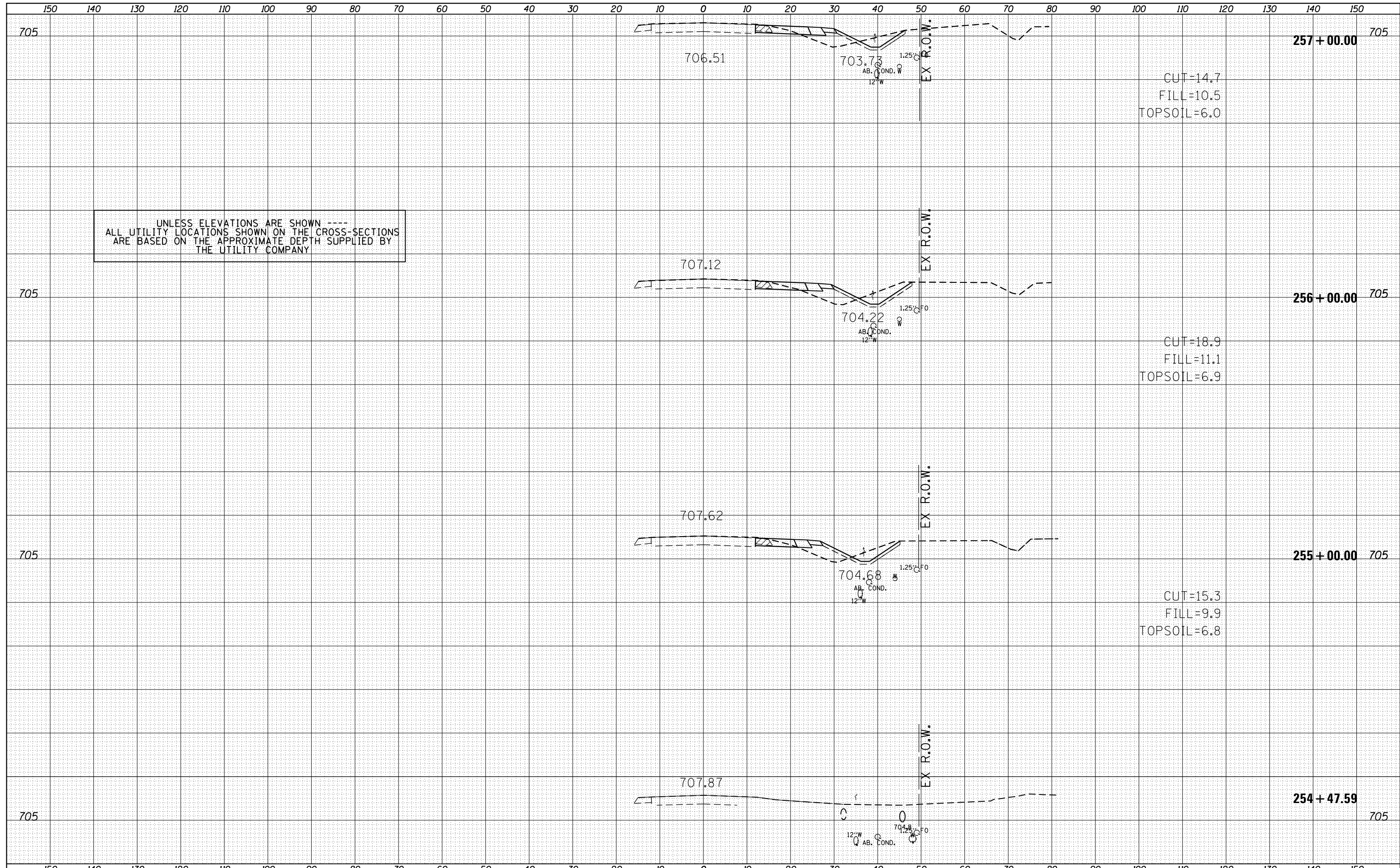

UNLESS ELEVATIONS ARE SHOWN ----  
 ALL UTILITY LOCATIONS SHOWN ON THE CROSS-SECTIONS  
 ARE BASED ON THE APPROXIMATE DEPTH SUPPLIED BY  
 THE UTILITY COMPANY

FILE NAME =  
 D468A71-sht-plan.dgn

USER NAME = keathbr	DESIGNED -	REVISED -
PLOT SCALE = 20.0000' / in.	DRAWN -	REVISED -
PLOT DATE = 12/12/2012	CHECKED -	REVISED -
	DATE -	REVISED -

**STATE OF ILLINOIS  
 DEPARTMENT OF TRANSPORTATION**

**CROSS SECTIONS IL 116**  
 SCALE: SHEET OF SHEETS STA. 254+47.59 TO STA. 257+00.00

F. A. R. P. RTE.	SECTION	COUNTY	TOTAL SHEETS	SHEET NO.
669	(11R)W-1	PEORIA	33	26
CONTRACT NO. 68A71			ILLINOIS FED. AID PROJECT	

DATE	
BY	
FINAL SURVEY	
NOTE BOOK	
NO.	
SURVEYED	
PLOTTED	
TEMPLATE	
AREAS	
CHECKED	

DATE	
BY	
ORIGINAL SURVEY	
NOTE BOOK	
NO.	
SURVEYED	
PLOTTED	
TEMPLATE	
AREAS	
CHECKED	

UNLESS ELEVATIONS ARE SHOWN ----  
ALL UTILITY LOCATIONS SHOWN ON THE CROSS-SECTIONS  
ARE BASED ON THE APPROXIMATE DEPTH SUPPLIED BY  
THE UTILITY COMPANY

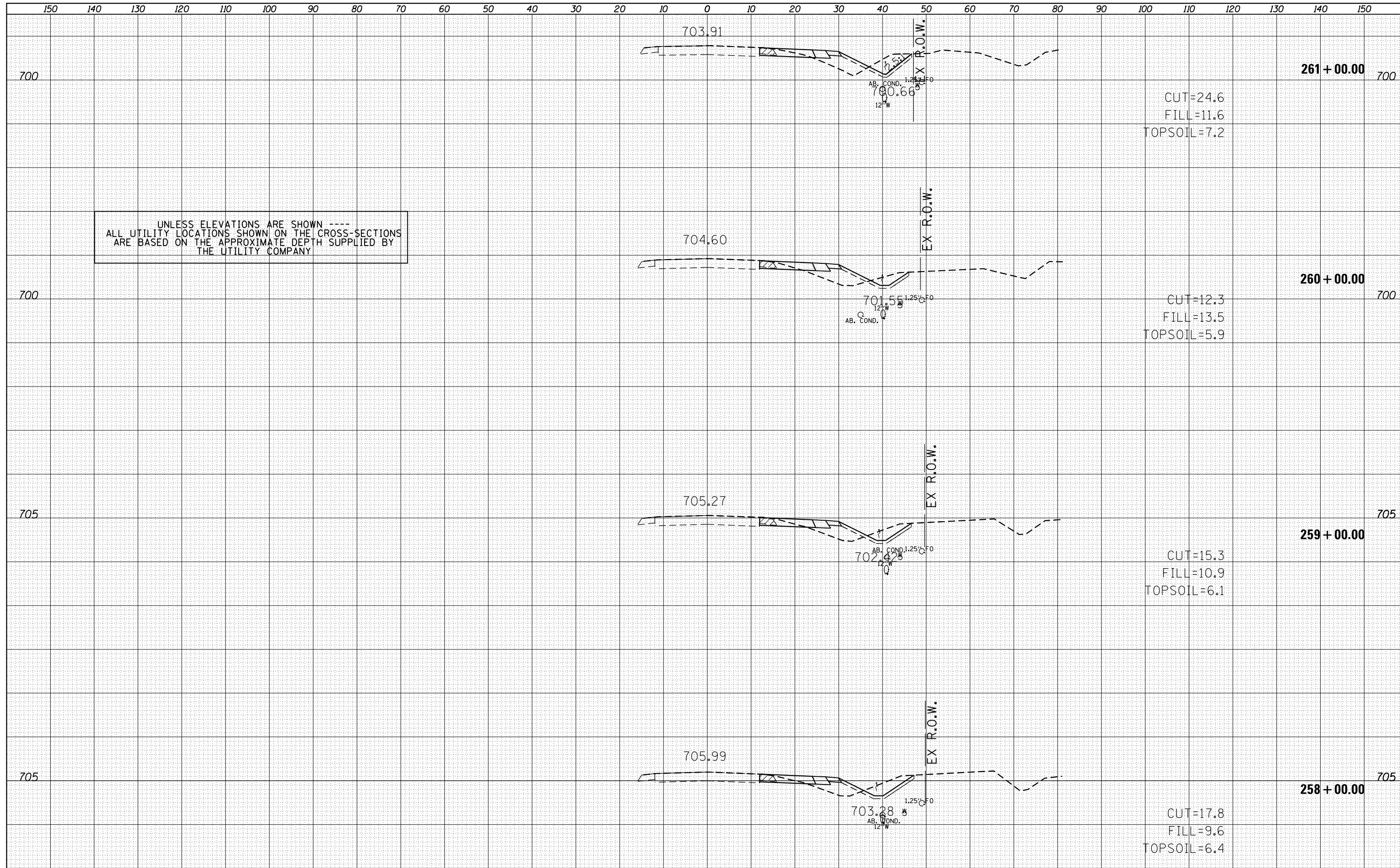

FILE NAME = D468A71-sht-plan.dgn	USER NAME = keathbr	DESIGNED -	REVISÉD -	<b>STATE OF ILLINOIS</b> <b>DEPARTMENT OF TRANSPORTATION</b>	<b>CROSS SECTIONS IL 116</b>	F. A. R. P. RTE. 669	SECTION 111R/W-1	COUNTY PEORIA	TOTAL SHEETS 33	SHEET NO. 27	
	PLOT SCALE = 20.0000' / in.	CHECKED -	REVISÉD -			SCALE:	SHEET OF SHEETS	STA. 258+00.00 TO STA. 261+00.00	CONTRACT NO. 68A71		
	PLOT DATE = 12/12/2012	DATE -	REVISÉD -			ILLINOIS FED. AID PROJECT					

DATE	
BY	
ORIGINAL SURVEY	
SURVEYED	
PLOTTED	
TEMPLATE	
AREAS	
CHECKED	
NO.	

DATE	
BY	
ORIGINAL SURVEY	
SURVEYED	
PLOTTED	
TEMPLATE	
AREAS	
CHECKED	
NO.	

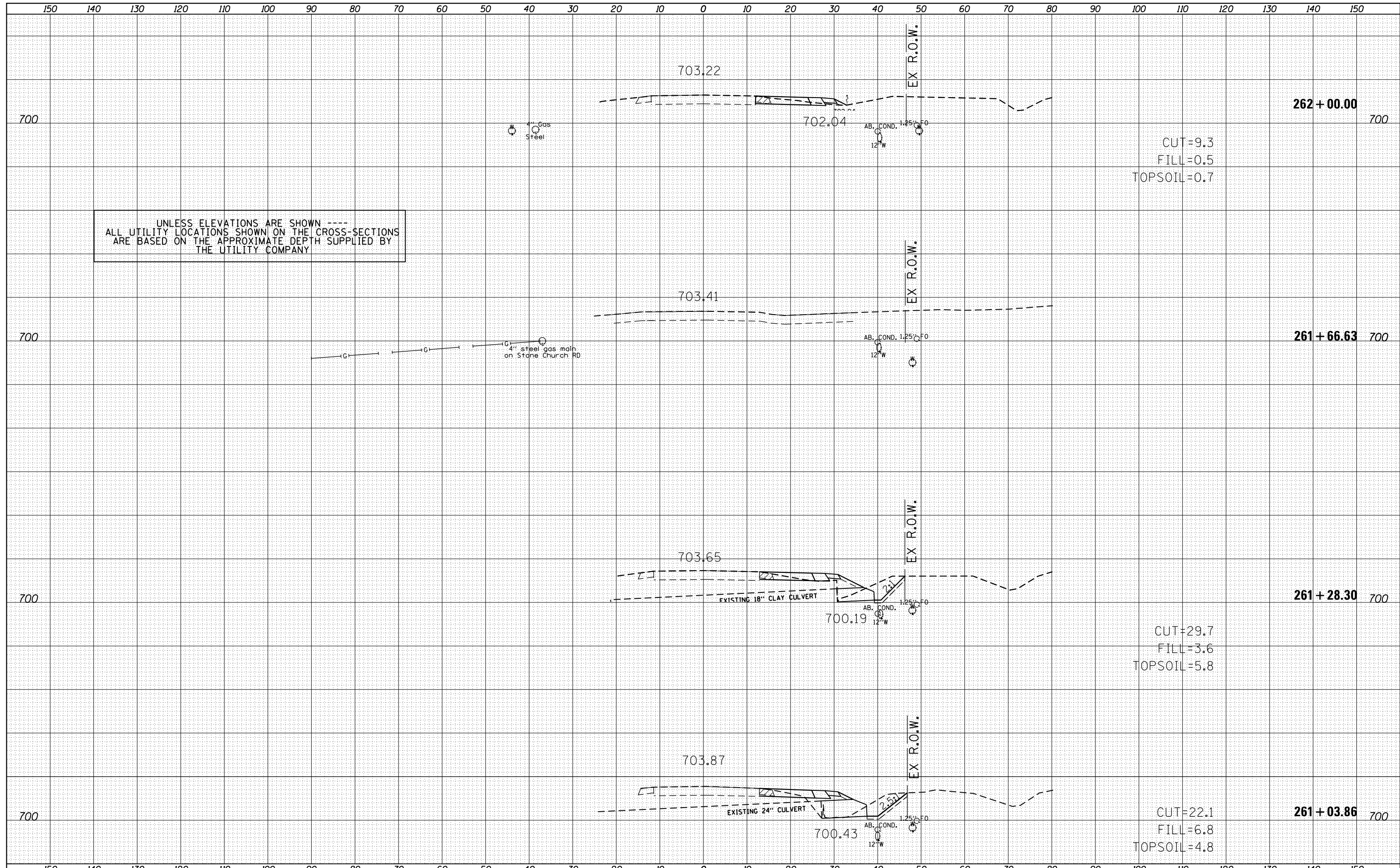

FILE NAME = D468A71-sht-plan.dgn	USER NAME = keathbr	DESIGNED -	REVISED -	<b>STATE OF ILLINOIS DEPARTMENT OF TRANSPORTATION</b>	<b>CROSS SECTIONS IL 116</b>			F.A.R.P. RTE. 669	SECTION 111R/W-1	COUNTY PEORIA	TOTAL SHEETS 33	SHEET NO. 28
	PLOT SCALE = 20.0000' / in.	CHECKED -	REVISED -		SCALE:	SHEET	OF	SHEETS	STA. 261+03.86	TO STA. 262+00.00	CONTRACT NO. 68A71	
	PLOT DATE = 12/12/2012	DATE -	REVISED -		ILLINOIS FED. AID PROJECT							









DATE	
BY	
FINAL SURVEY	
NO. _____	
SURVEYED	
PLOTTED	
TEMPLATE	
AREAS	
CHECKED	

DATE	
BY	
ORIGINAL SURVEY	
NO. _____	
SURVEYED	
PLOTTED	
TEMPLATE	
AREAS	
CHECKED	

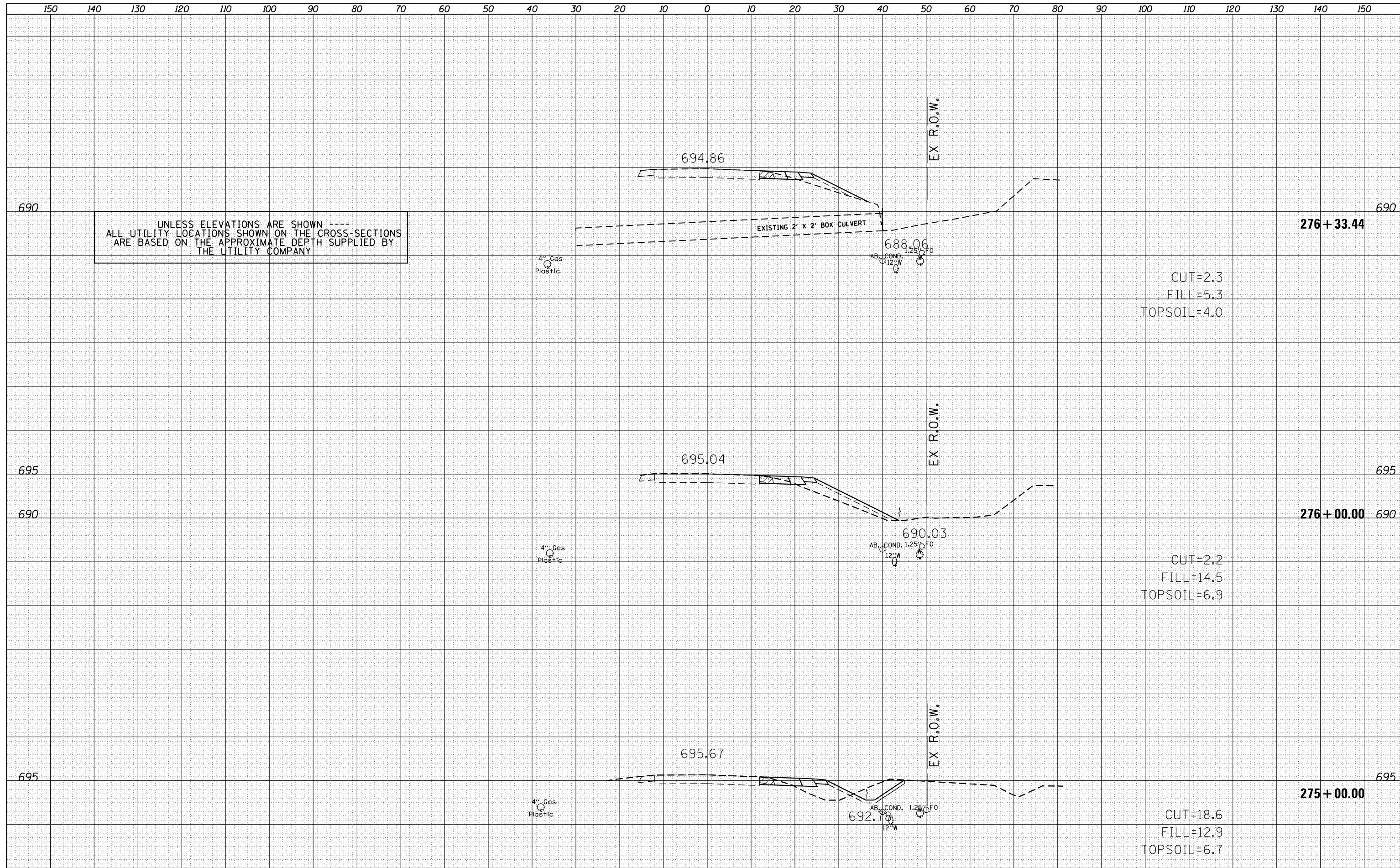

UNLESS ELEVATIONS ARE SHOWN ----  
 ALL UTILITY LOCATIONS SHOWN ON THE CROSS-SECTIONS  
 ARE BASED ON THE APPROXIMATE DEPTH SUPPLIED BY  
 THE UTILITY COMPANY

FILE NAME =  
 D468A71-sht-plan.dgn

USER NAME = kesthbr	DESIGNED -	REVISED -
PLOT SCALE = 20.0000' / in.	DRAWN -	REVISED -
PLOT DATE = 12/12/2012	CHECKED -	REVISED -
	DATE -	REVISED -

**STATE OF ILLINOIS  
 DEPARTMENT OF TRANSPORTATION**

**CROSS SECTIONS IL 116**  
 SCALE: SHEET OF SHEETS STA. 275+00.00 TO STA. 276+33.44

F. A. R. P. RTE. 669	SECTION (IIRW-1)	COUNTY PEORIA	TOTAL SHEETS 33	SHEET NO. 32
CONTRACT NO. 68A71			ILLINOIS FED. AID PROJECT	



