

F.A.I. RTE.	SECTION	COUNTY	TOTAL SHEETS	SHEET NO.
55	D6 PAINTING 2013	SANGAMON	26	1
		ILLINOIS	CONTRACT NO. 72F85	

STATE OF ILLINOIS
DEPARTMENT OF TRANSPORTATION
DIVISION OF HIGHWAYS

**PROPOSED
HIGHWAY PLANS**

FAI ROUTE 55 (I-55)
SECTION D6 PAINTING 2013
BRIDGE PAINTING
SANGAMON COUNTY

C-96-017-13

FOR INDEX OF SHEETS, SEE SHEET NO. 2

D-96-017-13

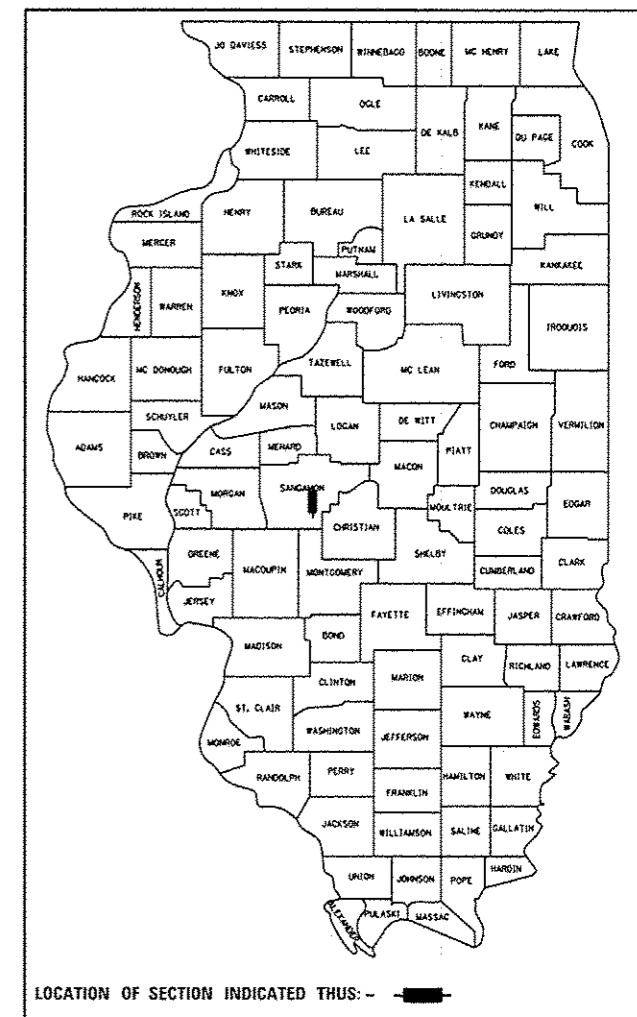

SN 084-0028

SN 084-0078

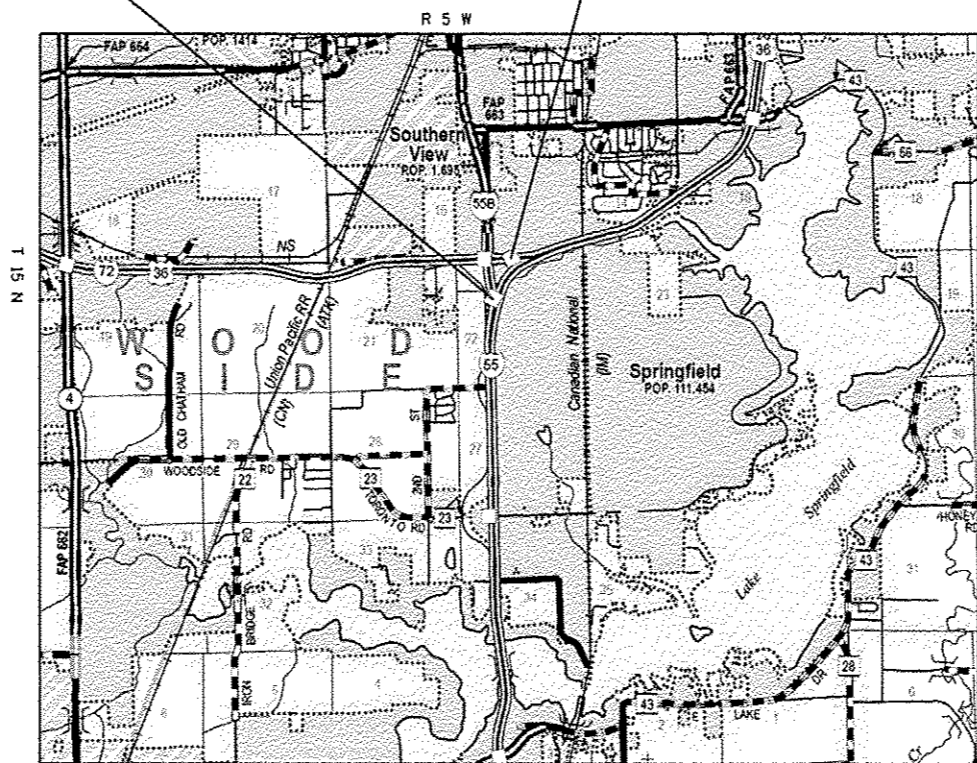

LOCATION MAP
NOT TO SCALE

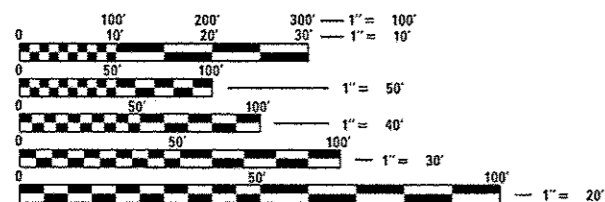

FULL SIZE PLANS HAVE BEEN PREPARED USING STANDARD ENGINEERING SCALES. REDUCED SIZED PLANS WILL NOT CONFORM TO STANDARD SCALES. IN MAKING MEASUREMENTS ON REDUCED PLANS, THE ABOVE SCALES MAY BE USED.

J.U.L.I.E.
JOINT UTILITY LOCATION INFORMATION FOR EXCAVATION
1-800-892-0123
OR 811

PROJECT ENGINEER - STEVE BERAN 217-785-9290
PROJECT MANAGER - DAVE COPENBARGER 217-785-5306

GROSS LENGTH = 630.00 FT. = 0.119 MILE
NET LENGTH = 630.00 FT. = 0.119 MILE

CONTRACT NO. 72F85

STATE OF ILLINOIS
DEPARTMENT OF TRANSPORTATION
DIVISION OF HIGHWAYS

SUBMITTED 12/26 20 12

Randy Ansell
DEPUTY DIRECTOR OF HIGHWAYS, REGION ENGINEER

Feb 1 20 13
John D. Baranzelli, P.E.
ENGINEER OF DESIGN AND ENVIRONMENT

Feb 1 20 13
Omer Osman, P.E.
DIRECTOR OF HIGHWAYS, CHIEF ENGINEER

PRINTED BY THE AUTHORITY
OF THE STATE OF ILLINOIS