

**EXISTING STRUCTURE:**  
 22- Spans (4 Units) Superstructure w/ 4 lane divided conc. deck, on steel girders. 4620' bk.-bk. w/ 40' clear between parapet curbs.  
 Missouri Approach: 8 span reinf. conc. deck on steel girders on deep water pile supported piers End to End = 1605'.  
 Main Spans: 3 span Cable Stay supported conc. deck on steel girders on pile supported conc. Pylons End to End = 1360'.  
 Illinois Approach: 11 spans 2 units reinf. conc deck on steel girders on pile supported piers End to End = 1655'.  
 Str. No. 060-0255

Traffic shall be maintained on structure according to Maintenance of Traffic Plans.

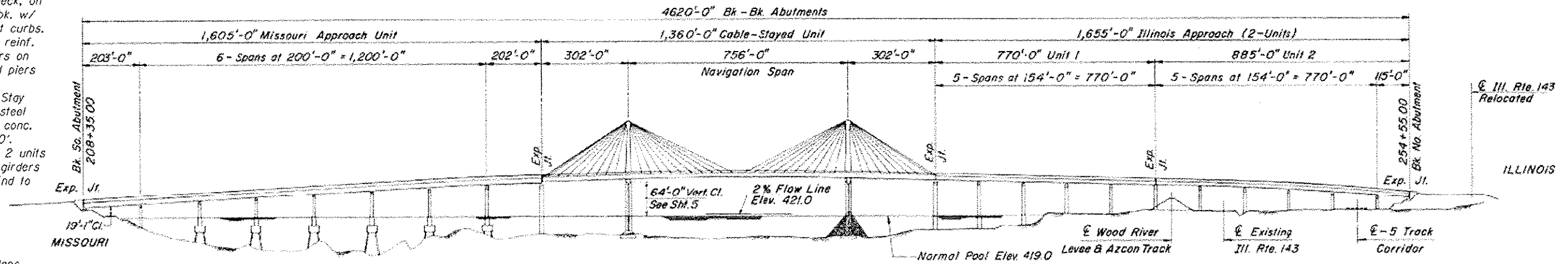

Note:  
 Utilizing U.S. Route 67 North as Plan North and  $\hat{C}$  of Roadway, all references to North, South, East or West are from this designated North. Any references to Left or Right are from  $\hat{C}$  U.S. Route 67.

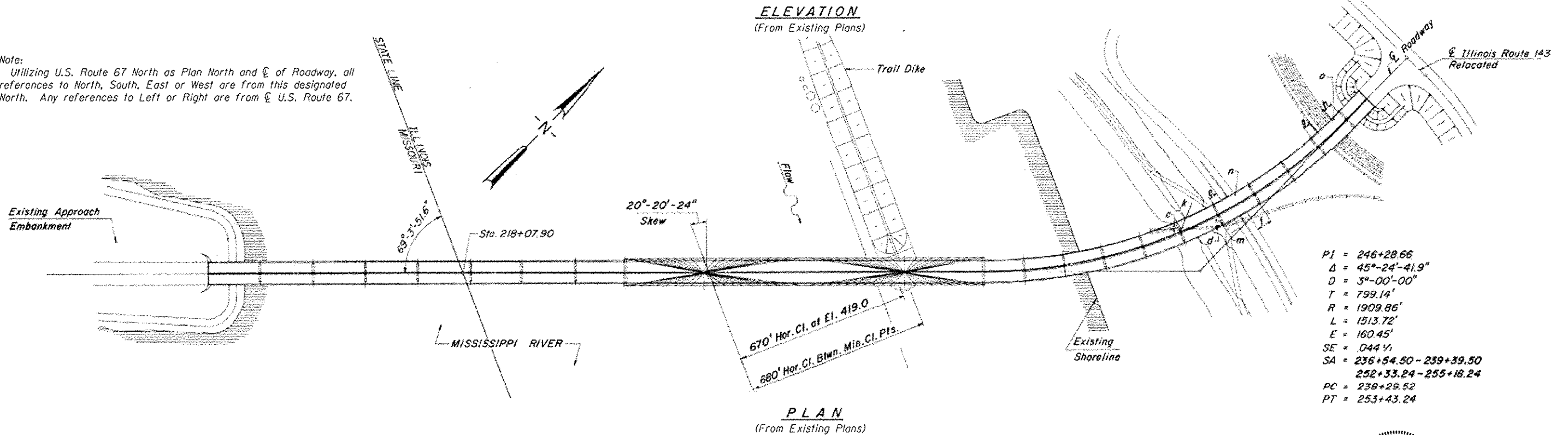

**DESIGN STRESSES**  
 FIELD UNITS (New Const.)  
 $f'_c$  = 3,500 psi  
 $f_y$  = 36,000 psi (AASHTO M270 Grade 36)

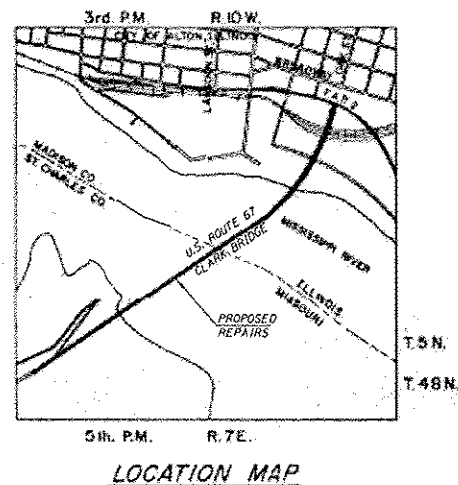

Michael N. Mendenhall  
 SIGNATURE  
 01-09-2013  
 DATE  
 LIC. EXP. DATE: 11-30-2014

**GENERAL PLAN & ELEVATION**  
**U.S.ROUTE 67 (F.A.P. 304) over MISSISSIPPI RIVER**  
**SECTION 100B-IDS-1**  
**MADISON COUNTY, ILLINOIS**  
**STATION 231+45.00**  
**STRUCTURE NO. 060-0255**

DESIGNED	EXAMINED	DATE	STATE OF ILLINOIS DEPARTMENT OF TRANSPORTATION	GENERAL PLAN & ELEVATION STRUCTURE NO. 060-0255		F.A.P. RTE. 304	SECTION 100B-IDS-1	COUNTY MADISON	TOTAL SHEETS 58	SHEET NO. 11
CHECKED	PASSED			SHEET NO. 01 OF 48 SHEETS		ILLINOIS FED. AID PROJECT		CONTRACT NO. 76E73		
DRAWN Rod										
CHECKED MNM										