



© Copyright Hanson Professional Services Inc. 2012

11/11/2008 10:00:02 8:47:45 AM
 I:\11\100000\WORK\AD\SHEETS\060-0255-76E7-3-Cable Wrapping\Repairs.rvt

REPAIRS LIST - CABLE WRAPPING

I.D.	Description	Pay Item	Units	Quantity
073	20' above Deck, Spots & Stabilizers	Cable Wrapping	L. SUM	1
-	-	-	-	-
-	-	-	-	-

Note:
 Cost of waterproofing sealant shall be included with "Cable Wrapping".
 Install cable wrap at the designated locations shown below, wrapping shall proceed from bottom toward the top providing a "Shingle" effect.
 Cable numbers shown in the repair list, have been appended with either an 'L' or 'R' for Left or Right of the C, with the exception of Cables S1 thru S4.

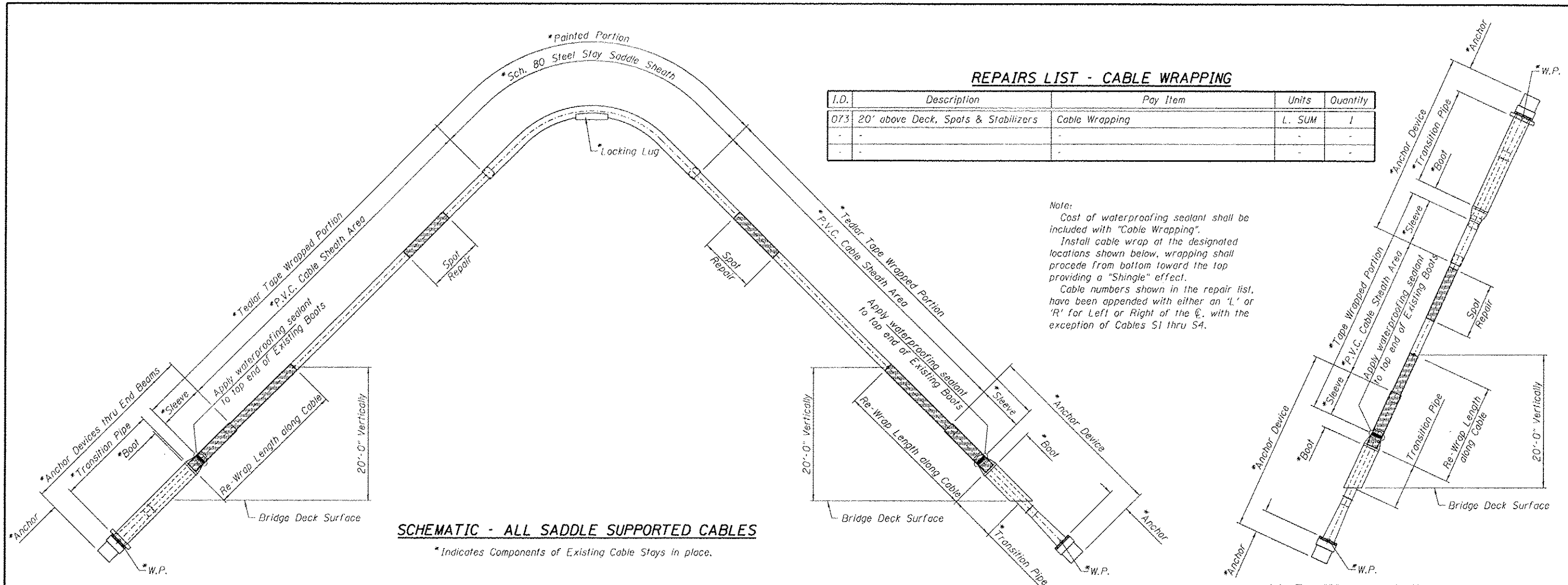

SCHMATIC - ALL SADDLE SUPPORTED CABLES

* Indicates Components of Existing Cable Stays in place.

SCHMATIC - CABLES S1 thru S4

GENERAL CABLE RE-WRAPPING - FROM END OF TRANSITION PIPES TO 20' ABOVE DECK MEASURED VERTICALLY

PIER 9 - CABLES (LEFT SIDE)

Cable Number	Transition Pipe O.D.	Cable O.D.	Replace Boot		Re-Wrap 20' Vert.
			Each	Foot	
28L	18"	8.625"	-	-	37.2
26L	18"	8.625"	-	-	36.7
24L	18"	8.625"	-	-	35.7
22L	18"	8.625"	-	-	32.8
20L	16"	7.125"	-	-	30.0
18L	16"	7.125"	-	-	27.3
16L	12.75"	7.125"	-	-	24.9
14L	12.75"	7.125"	-	-	22.8
12L	12.75"	5.563"	-	-	21.1
10L	12.75"	5.563"	-	-	20.0
S3	16"	7.125"	-	-	19.5
S4	16"	7.125"	-	-	19.5
11L	12.75"	5.563"	-	-	19.9
13L	12.75"	5.563"	-	-	21.0
15L	12.75"	7.125"	-	-	22.6
17L	12.75"	7.125"	-	-	24.7
19L	16"	7.125"	-	-	27.0
21L	16"	7.125"	-	-	29.8
23L	18"	8.625"	-	-	32.7
25L	18"	8.625"	-	-	35.6
27L	18"	8.625"	-	-	38.7
29L	18"	8.625"	-	-	42.0

PIER 9 - CABLES (RIGHT SIDE)

Cable Number	Transition Pipe O.D.	Cable O.D.	Replace Boot		Re-Wrap 20' Vert.
			Each	Foot	
28R	18"	8.625"	-	-	37.2
26R	18"	8.625"	-	-	36.7
24R	18"	8.625"	-	-	35.7
22R	18"	8.625"	-	-	32.8
20R	16"	7.125"	-	-	30.0
18R	16"	7.125"	-	-	27.3
16R	12.75"	7.125"	-	-	24.9
14R	12.75"	7.125"	-	-	22.8
12R	12.75"	5.563"	-	-	21.1
10R	12.75"	5.563"	-	-	20.0
S1	16"	7.125"	-	-	19.5
S2	16"	7.125"	-	-	19.5
11R	12.75"	5.563"	-	-	19.9
13R	12.75"	5.563"	-	-	21.0
15R	12.75"	7.125"	-	-	22.6
17R	12.75"	7.125"	-	-	24.7
19R	16"	7.125"	-	-	27.0
21R	16"	7.125"	-	-	29.8
23R	18"	8.625"	-	-	32.7
25R	18"	8.625"	-	-	35.6
27R	18"	8.625"	-	-	38.7
29R	18"	8.625"	-	-	42.0

PIER 10 - CABLES (LEFT SIDE)

Cable Number	Transition Pipe O.D.	Cable O.D.	Replace Boot		Re-Wrap 20' Vert.
			Each	Foot	
49L	18"	8.625"	-	-	42.0
47L	18"	8.625"	-	-	38.7
45L	18"	8.625"	-	-	35.6
43L	18"	8.625"	-	-	32.7
41L	16"	7.125"	-	-	29.8
39L	16"	7.125"	-	-	27.0
37L	12.75"	7.125"	-	-	24.7
35L	12.75"	7.125"	-	-	22.6
33L	12.75"	5.563"	-	-	21.0
31L	12.75"	5.563"	-	-	19.9
S4	16"	7.125"	-	-	19.5
S3	16"	7.125"	-	-	19.5
30L	12.75"	5.563"	-	-	20.0
32L	12.75"	5.563"	-	-	21.1
34L	12.75"	7.125"	-	-	22.8
36L	12.75"	7.125"	-	-	24.9
38L	16"	7.125"	-	-	27.3
40L	16"	7.125"	-	-	30.0
42L	18"	8.625"	-	-	32.8
44L	18"	8.625"	-	-	35.7
46L	18"	8.625"	-	-	38.7
48L	18"	8.625"	-	-	42.0

PIER 10 - CABLES (RIGHT SIDE)

Cable Number	Transition Pipe O.D.	Cable O.D.	Replace Boot		Re-Wrap 20' Vert.
			Each	Foot	
49R	18"	8.625"	-	-	42.0
47R	18"	8.625"	-	-	38.7
45R	18"	8.625"	-	-	35.6
43R	18"	8.625"	-	-	32.7
41R	16"	7.125"	-	-	29.8
39R	16"	7.125"	-	-	27.0
37R	12.75"	7.125"	-	-	24.7
35R	12.75"	7.125"	-	-	22.6
33R	12.75"	5.563"	-	-	21.0
31R	12.75"	5.563"	-	-	19.9
S2	16"	7.125"	-	-	19.5
S1	16"	7.125"	-	-	19.5
30R	12.75"	5.563"	-	-	20.0
32R	12.75"	5.563"	-	-	21.1
34R	12.75"	7.125"	-	-	22.8
36R	12.75"	7.125"	-	-	24.9
38R	16"	7.125"	-	-	26.9
40R	16"	7.125"	-	-	29.1
42R	18"	8.625"	-	-	31.3
44R	18"	8.625"	-	-	33.5
46R	18"	8.625"	-	-	34.4
48R	18"	8.625"	-	-	34.6

CABLE WRAPPING - SPOT REPAIRS

Pier No.	Cable No.	Repair Location	Cable O.D.	Units	Quantity
9	S1	20' Above Bridge Deck	7.125"	Foot	1.0
9	S4	50' Above Bridge Deck	7.125"	Foot	1.0
9	S4	60' Above Bridge Deck	7.125"	Foot	1.0
9	10L	90' Above Bridge Deck	5.563"	Foot	2.0
9	10L	120' Above Bridge Deck	5.563"	Foot	2.0
9	10L	126' Above Bridge Deck	5.563"	Foot	1.0
9	14R	50' Above Bridge Deck	7.125"	Foot	2.0
9	14R	90' Above Bridge Deck	7.125"	Foot	1.0
9	14R	95' Above Bridge Deck	7.125"	Foot	2.0
9	16R	100' Above Bridge Deck	7.125"	Foot	2.0
9	16L	110' Above Bridge Deck	7.125"	Foot	1.0
9	17L	135' Above Bridge Deck	7.125"	Foot	3.0
9	18L	110' Above Bridge Deck	7.125"	Foot	1.0
9	20R	80' Above Bridge Deck	7.125"	Foot	1.0
9	21L	125' Above Bridge Deck	7.125"	Foot	2.0
9	23L	125' Above Bridge Deck	8.625"	Foot	1.0
9	24R	145' Above Bridge Deck	8.625"	Foot	1.0
9	26R	60' Above Bridge Deck	8.625"	Foot	2.0
9	28R	140' Above Bridge Deck	8.625"	Foot	10.0
9	28L	165' Above Bridge Deck	8.625"	Foot	5.0
9	29L	30' Above Bridge Deck	8.625"	Foot	1.0

Pier No.	Cable No.	Repair Location	Cable O.D.	Units	Quantity
10	30R	80' Above Bridge Deck	5.563"	Foot	4.0
10	33L	169' Above Bridge Deck	5.563"	Foot	1.0
10	33R	50' Above Bridge Deck	5.563"	Foot	2.0
10	35L	100' Above Bridge Deck	7.125"	Foot	2.0
10	38R	80' Above Bridge Deck	7.125"	Foot	1.0
10	38R	120' Above Bridge Deck	7.125"	Foot	2.0
10	38L	130' Above Bridge Deck	7.125"	Foot	1.0
10	44L	145' Above Bridge Deck	8.625"	Foot	1.0
10	44L	160' Above Bridge Deck	8.625"	Foot	2.0
10	46L	40' Above Bridge Deck	8.625"	Foot	2.0
10	46L	50' Above Bridge Deck	8.625"	Foot	1.0
10	46L	80' Above Bridge Deck	8.625"	Foot	1.0
10	46L	145' Above Bridge Deck	8.625"	Foot	1.0
10	48L	145' Above Bridge Deck	8.625"	Foot	2.0
10	48L	160' Above Bridge Deck	8.625"	Foot	2.0
10	49L	50' Above Bridge Deck	8.625"	Foot	1.0

DESIGNED -	EXAMINED -	DATE -	STATE OF ILLINOIS DEPARTMENT OF TRANSPORTATION	REPAIRS as DESIGNATED - CABLE WRAPPING STRUCTURE NO. 060-0255	F.A.P. R.T.E. 304	SECTION 100B-10S-1	COUNTY MADISON	TOTAL SHEETS 58	SHEET NO. 24
CHECKED -	ENGINEER OF STRUCTURAL SERVICES				CONTRACT NO. 76E73				
DRAWN Rod	PASSED				ILLINOIS FED. AID PROJECT				
CHECKED MNM	ENGINEER OF BRIDGES AND STRUCTURES				SHEET NO. 14 OF 48 SHEETS				