

MISSOURI PYLON - 476.25 to 492.92
Looking North

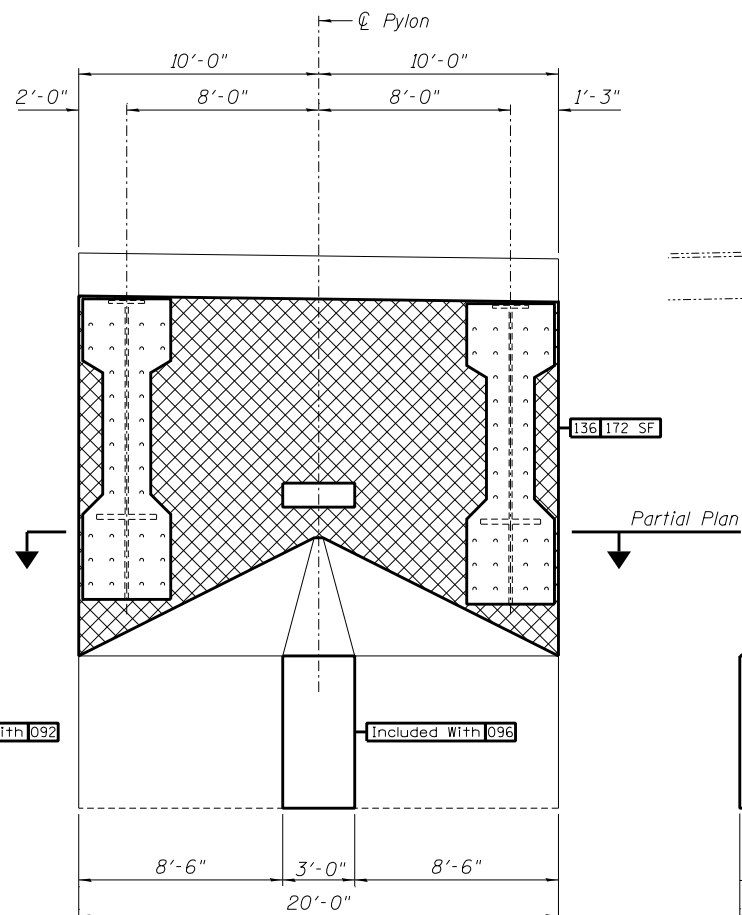

MISSOURI PYLON - 476.25 to 492.92
Looking East

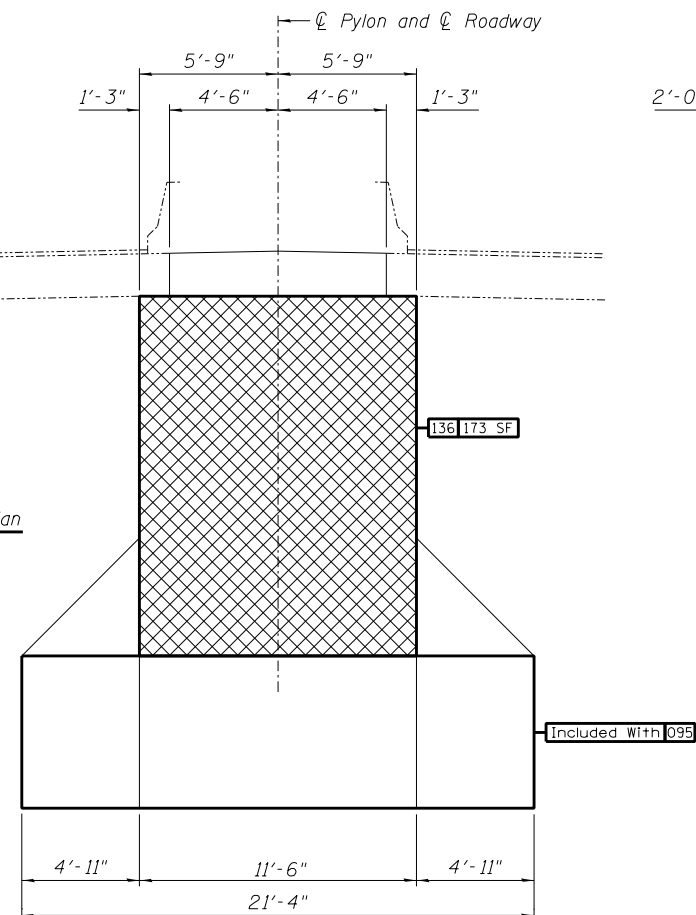

MISSOURI PYLON - 476.25 to 492.92
Looking South

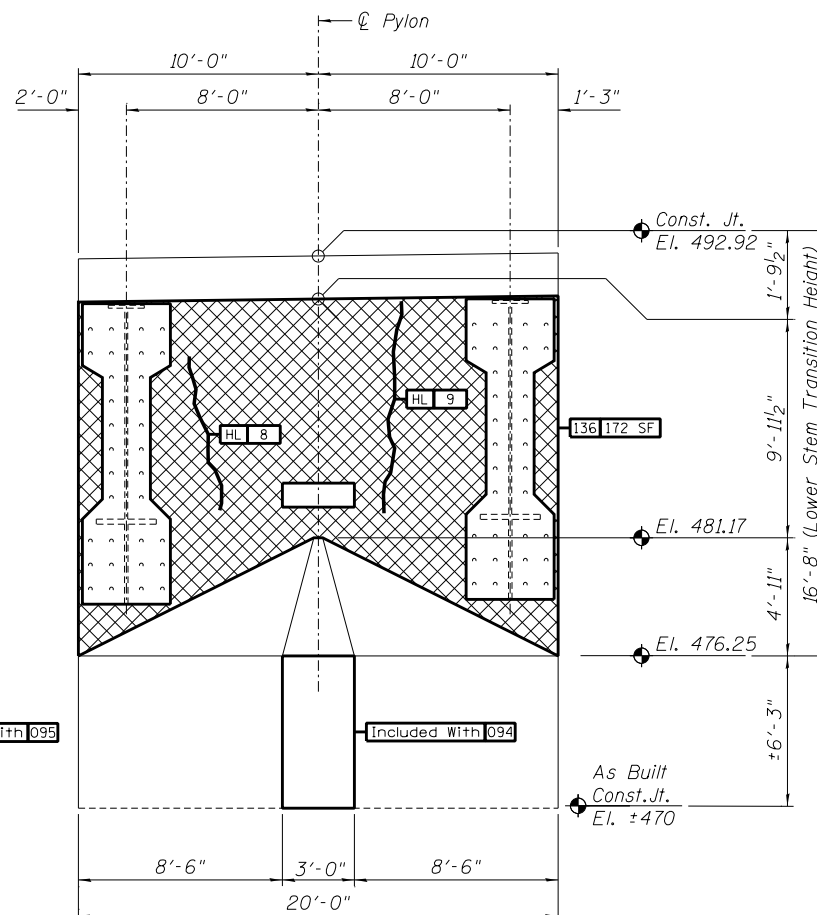

MISSOURI PYLON - 476.25 to 492.92
Looking West

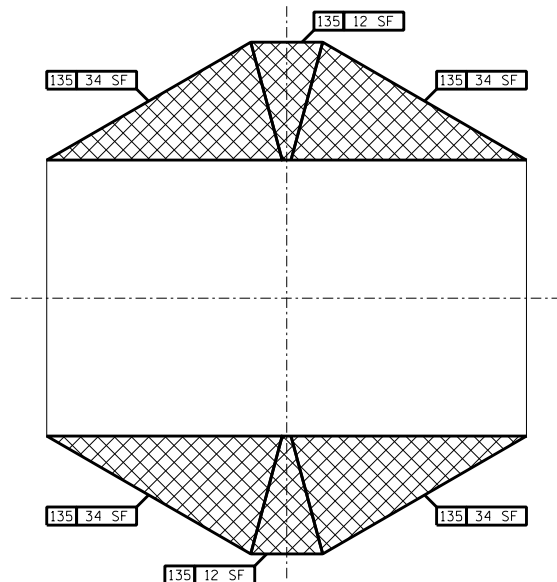

PARTIAL PLAN
MISSOURI PYLON - 476.25 to 481.17
(Showing Sloping Surfaces)



REPAIRS LIST - PIER 9 - COLUMN BELOW BRIDGE DECK

| I.D. | Description | Pay Item | Units | Quantity |
|------|------------------------------------|-----------------|---------|----------|
| 135 | Top Most Section Sloping Surfaces | Concrete Sealer | SQ. FT. | 160 |
| 136 | Top Most Section Vertical Surfaces | Concrete Sealer | SQ. FT. | 688 |

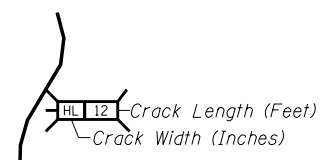

| | | |
|-------------|------------------------------------|--------|
| DESIGNED - | EXAMINED _____ | DATE - |
| CHECKED - | ENGINEER OF STRUCTURAL SERVICES | |
| DRAWN Rod | PASSED _____ | |
| CHECKED MNM | ENGINEER OF BRIDGES AND STRUCTURES | |

STATE OF ILLINOIS
DEPARTMENT OF TRANSPORTATION

REPAIRS TO - CSS - MISSOURI PYLON (PIER 9) - (476.25 to 492.92)
STRUCTURE NO. 060-0255

SHEET NO. 32 OF 48 SHEETS

| | | | | |
|---------------------------|------------|---------|--------------|-----------|
| F.A.P. RTE. | SECTION | COUNTY | TOTAL SHEETS | SHEET NO. |
| 304 | 100B-1D5-1 | MADISON | 58 | 42 |
| CONTRACT NO. 76E73 | | | | |
| ILLINOIS FED. AID PROJECT | | | | |