

FAS ROUTE NO.	SEC	COUNTY	TOTAL SHEETS	SHEET NO.
188	*	LEE	22	1
ILLINOIS PROJECT BRS-0188(121)				
* 08-00303-00-BR				

PLANS FOR PROPOSED FEDERAL-AID PROJECT

F.A.S. 188 (C.H. 15) INDIAN HEAD ROAD PROPOSED STRUCTURE NO. 052-3413 SECTION 08-00303-00-BR LEE COUNTY PROJECT BRS-0188(121) JOB NO. C-92-111-12

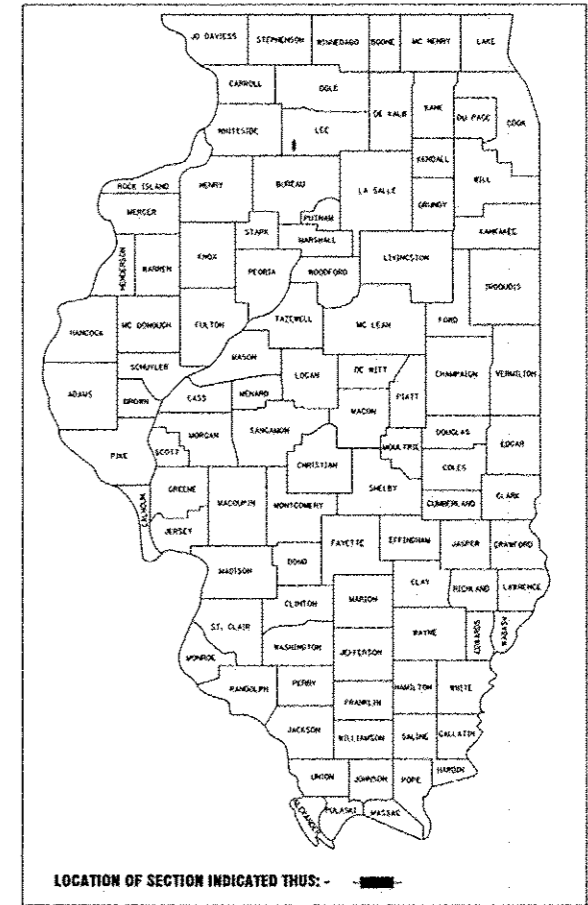

INDEX OF SHEETS

1. COVER SHEET
2. SUMMARY AND SCHEDULE OF QUANTITIES AND TYPICAL SECTIONS
3. PLAN AND PROFILE
- 4-6. ROADWAY CROSS SECTIONS
7. EROSION CONTROL PLAN
8. GENERAL PLAN AND ELEVATION
9. DECK ELEVATIONS LAYOUT
10. DECK ELEVATIONS
11. SUPERSTRUCTURE
12. SUPERSTRUCTURE DETAILS
13. FRAMING PLAN
14. STRUCTURAL STEEL DETAILS
15. ABUTMENTS
16. PIERS
17. PILING DETAILS
18. ANCHOR BOLT DETAILS
- 19-21. SOIL BORINGS

STANDARDS:

- 000001-06 STANDARD SYMBOLS, ABBREVIATIONS, AND PATTERNS
- 001001-02 AREAS OF REINFORCEMENT BARS
- 280001-07 TEMPORARY EROSION CONTROL SYSTEMS
- 515001-03 NAME PLATE FOR BRIDGES
- 630301-06 SHOULDER WIDENING FOR TYPE 1 (SPECIAL) GUARDRAIL TERMINALS
- 635006-03 REFLECTOR AND TERMINAL MARKER PLACEMENT
- 635011-02 REFLECTOR MARKER AND MOUNTING DETAILS
- 701006-04 OFF-RD OPERATIONS, 2L, 2W, 15' TO 24" FROM PAVEMENT EDGE
- 701301-04 LANE CLOSURE, 2L, 2W, SHORT TIME OPERATIONS
- 701901-02 TRAFFIC CONTROL DEVICES
- 720011-01 METAL POSTS FOR SIGNS, MARKERS & DELINEATORS
- 728001-01 TELESCOPING STEEL SIGN SUPPORT
- 729001-01 APPLICATIONS OF TYPES A & B METAL POSTS (FOR SIGNS & MARKERS)
- BLR 21-9 TYPICAL APPLICATION OF TRAFFIC CONTROL DEVICES
- BLR 22-7 TYPICAL APPLICATION OF TRAFFIC CONTROL DEVICES FOR CONSTRUCTION ON RURAL LOCAL HIGHWAYS
- BLR 23-4 TRAFFIC BARRIER TERMINAL, TYPE 1
- BLR 27-1 TRAFFIC BARRIER TERMINAL, TYPE 5A

SECTION 08-00303-00-BR
ENDS AT STA. 15+50

SECTION 08-00303-00-BR
THREE SPAN 27" STEEL COMPOSITE BEAM WITH POURED CONCRETE DECK SUPPORTED ON PILE BEAM ABUTMENTS AND PIERS. 166'-5" BK.-BK. ABUTMENTS. SKEW 15' RT. AHEAD 32'-0" F.-F. RAILING

SECTION 08-00303-00-BR
BEGINS AT STA. 4+50

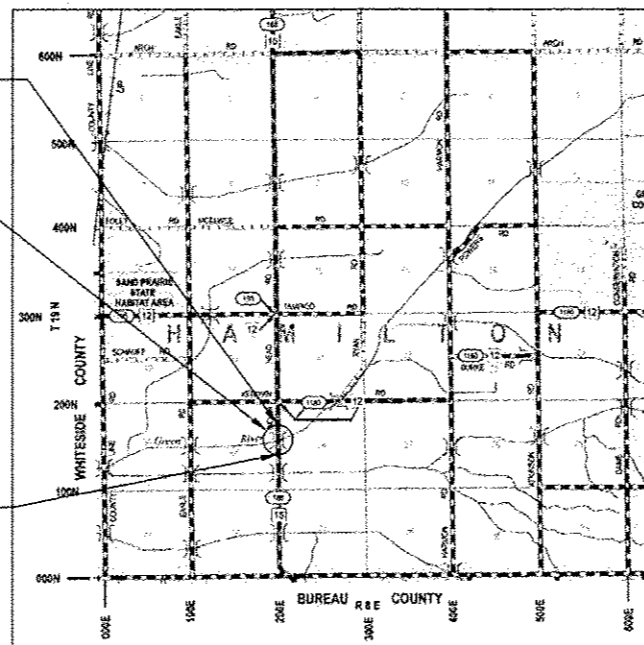

LOCATION MAP

GROSS LENGTH OF SECTION = 1100 FEET (0.21 MILE)
NET LENGTH OF SECTION = 1100 FEET (0.21 MILE)

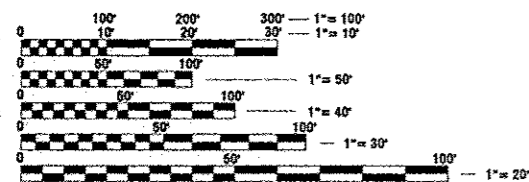

FULL SIZE PLANS HAVE BEEN PREPARED USING STANDARD ENGINEERING SCALES. REDUCED SIZED PLANS WILL NOT CONFORM TO STANDARD SCALES. IN MAKING MEASUREMENTS ON REDUCED PLANS, THE ABOVE SCALES MAY BE USED.

J.U.L.I.E.
JOINT UTILITY LOCATION INFORMATION FOR EXCAVATION
1-800-892-0123

CONTRACT NO. 85573

DESIGN CRITERIA

ROADWAY	DESIGN CLASSIFICATION	ADT 2012	DESIGN SPEED
INDIAN HEAD ROAD	RURAL COLLECTOR	325	40
	3R GUIDELINES	3% TRUCKS	



Richard A. Baumann
DATE: 12/27/12
RICHARD A. BAUMANN
STERLING, ILLINOIS
ILLINOIS LICENSED PROFESSIONAL ENGINEER NO. 062-035417
EXPIRES 11-30-2014

wendler
GROUND-BREAKING SOLUTIONS
engineers - surveyors - scientists
www.wendlers.com ph: 615.288.2261
Illinois Professional Design Firm No. 184-000848

STATE OF ILLINOIS
DEPARTMENT OF TRANSPORTATION
DIVISION OF HIGHWAYS

SUBMITTED 12/20 2012

Don M. Anderson
COUNTY ENGINEER

PASSED Jan. 9 2013
Paul A. Bauman
DISTRICT 2 ENGINEER OF LOCAL ROADS & STREETS

RELEASED FOR BID BASED ON LIMITED REVIEW
Jan. 9 2013
Paul A. Bauman
DEPUTY DIRECTOR OF HIGHWAYS, REGION 2 ENGINEER

PRINTED BY THE AUTHORITY OF THE STATE OF ILLINOIS