

R 8 E, 4th PM

R 9 E, 4th PM

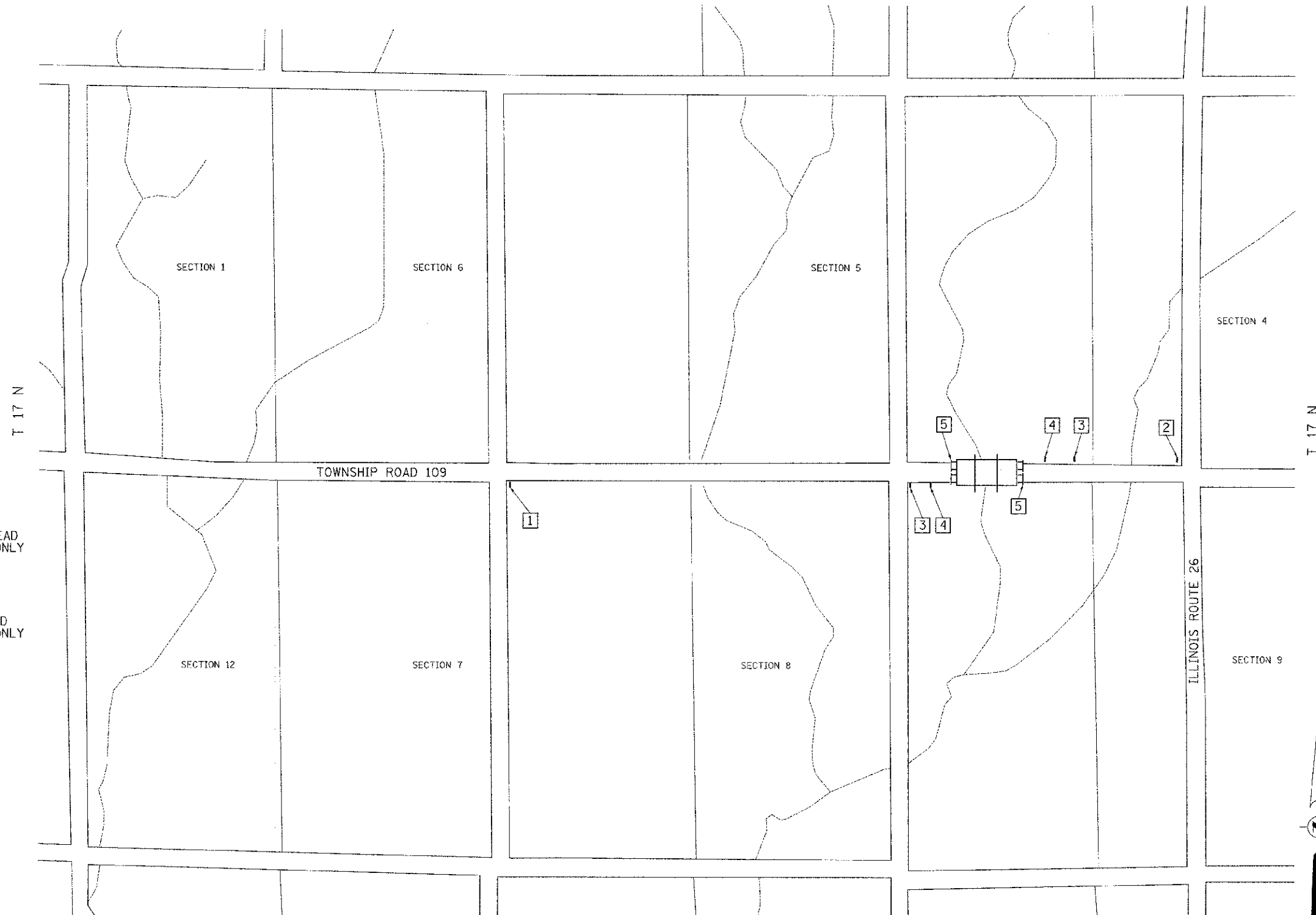

1 ROAD CLOSED  
1 1/4 MILES AHEAD  
LOCAL TRAFFIC ONLY  
R11-3

2 ROAD CLOSED  
1/2 MILE AHEAD  
LOCAL TRAFFIC ONLY  
R11-3

3 ROAD CLOSED  
CLOSED  
AHEAD  
W20-3

4 ROAD CLOSED  
500 FT  
W20-3

5 TYPE III BARRICADES

SEE STANDARD BLR 21  
AND SPECIAL PROVISIONS

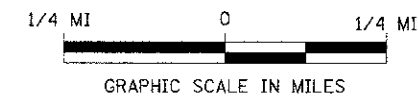

|   |                           |            |           |  |  |                         |                                |  |                |        |              |           |
|---|---------------------------|------------|-----------|--|--|-------------------------|--------------------------------|--|----------------|--------|--------------|-----------|
| FILE NAME *<br>V:\Design\3165 Bureau\31651201.dgn | USER NAME *<br>jhutchison | DESIGNED - | REVISED - | <b>BUREAU COUNTY<br/>TOWNSHIP ROAD 109 OVER<br/>LIME CREEK TRIBUTARY</b> | <b>TRAFFIC CONTROL PLAN<br/>INDIVIDUAL CLOSURE SN 006-4089</b> |                         |                                | RT#  | SECTION        | COUNTY | TOTAL SHEETS | SHEET NO. |
|   |                           | DRAWN -    | REVISED - |  | SCALE: NONE  | SHEET NO. 1 OF 1 SHEETS | STA. 57+75.00 TO STA. 61+25.00 | TR 109   | 07-03126-00-BR | BUREAU | 61           | 7         |
|   |                           | CHECKED -  | REVISED - |  |  |                         |                                | CONTRACT NO. 87528   |                |        |              |           |
|   |                           | DATE -     | REVISED - |  |  |                         |                                | FED. ROAD DIST. NO. 7 ILLINOIS FED. AID PROJECT BROS-0011087 |                |        |              |           |