

**TWO ABUTMENTS
BILL OF MATERIAL**

BAR NO.	SIZE	LENGTH	SHAPE
h	#4	24'-9"	—
h ₁	#4	6'-6"	—
p	#7	24'-9"	—
s	#4	10'-5"	□
u	#6	11'-7"	□
v	#4	4'-0"	—
v ₁	#4	7'-9"	—
Concrete Structures		CU YD	21.0
Reinforcement Bars		POUND	2,380
Name Plates		EACH	1
Furnishing Metal Shell Piles 12"x0.250"		FOOT	256
Driving Piles		FOOT	256
Test Pile Metal Shells		EACH	2
Pile Shoes		EACH	10
Concrete Encasement		CU YD	2.6

DESIGN STRESSES
 $f'_c = 3,500$ p.s.i.
 $f_y = 60,000$ p.s.i.

- NOTES**
- The Backwall and the portion of the Wingwalls above the bonded construction joint shall be cast against the in-place beam.
 - Reinforcement bars shall conform to ASTM A706 Grade 60.

PILE DATA
 Type & Size: Metal Shell 12"x0.250" walls w/ Pile Shoes
 Nominal Required Bearing: 225 kips
 Factored Resistance Available: 125 kips
 Est. Length: 31' West Abutment
 33' East Abutment
 No. Req'd: 10 (Includes 1 Test Pile at Each Abut.)

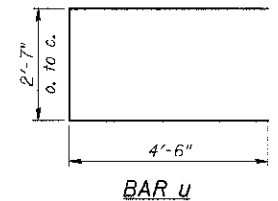
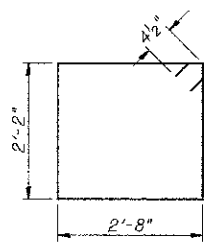
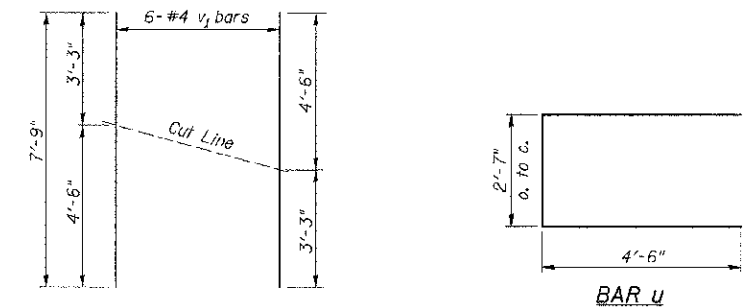

**ABUTMENTS
BUREAU COUNTY
SECTION 07-03126-00-BR
T.R. 109 OVER WEST BUREAU CREEK**

SHEET NO. 6 11 SHEETS	ROUTE NO.	SECTION	COUNTY	TOTAL SHEETS	SHEET NO.
	TR 109	07-03126-00-BR	BUREAU	61	19
	S.N. 006-4553		CONTRACT NO. 87528		
FED. ROAD DIST. NO. 7		ILLINOIS	FED. AID PROJECT DROS-0011087		