

**LEGEND**

- HMA SURFACE REMOVAL
- HMA PAVEMENT REMOVAL, FULL DEPTH
- AGG SHOULDER REMOVAL (INCLUDED IN EARTH EX)
- SIDEWALK REMOVAL
- DRIVEWAY PAVEMENT REMOVAL
- CURB & GUTTER REMOVAL
- CLEARING & GRUBBING (INCLUDED IN EARTH EX)
- TEMP. CONST. FENCE ORANGE MESH

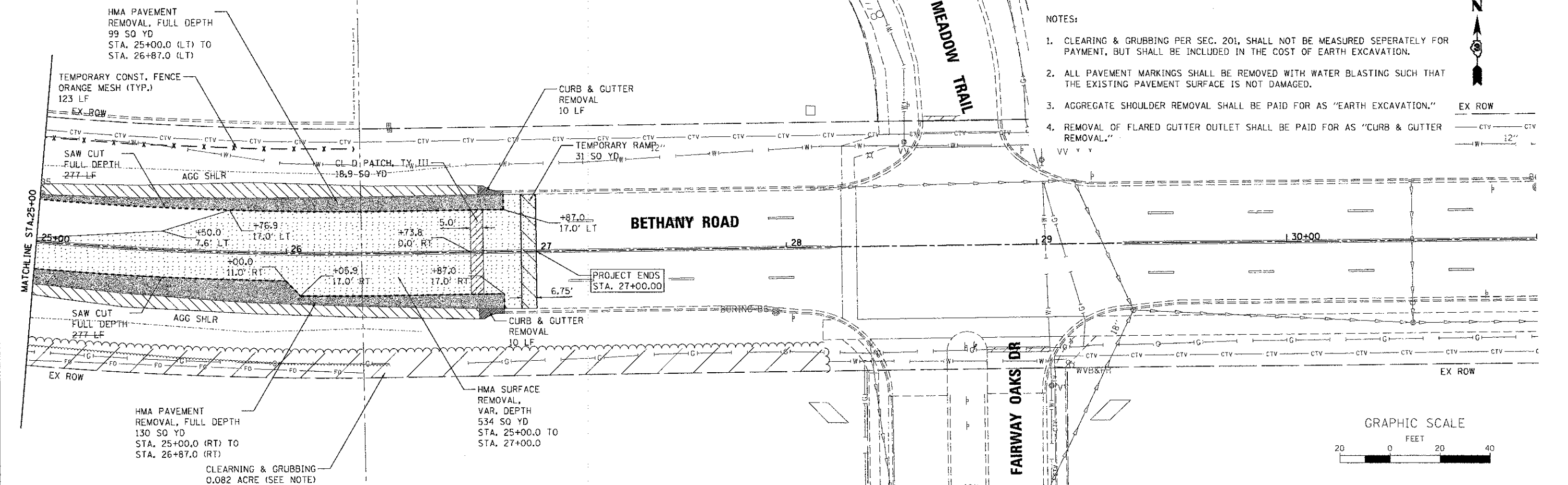

- NOTES:**
1. CLEARING & GRUBBING PER SEC. 201, SHALL NOT BE MEASURED SEPERATELY FOR PAYMENT, BUT SHALL BE INCLUDED IN THE COST OF EARTH EXCAVATION.
  2. ALL PAVEMENT MARKINGS SHALL BE REMOVED WITH WATER BLASTING SUCH THAT THE EXISTING PAVEMENT SURFACE IS NOT DAMAGED.
  3. AGGREGATE SHOULDER REMOVAL SHALL BE PAID FOR AS "EARTH EXCAVATION."
  4. REMOVAL OF FLARED GUTTER OUTLET SHALL BE PAID FOR AS "CURB & GUTTER REMOVAL."

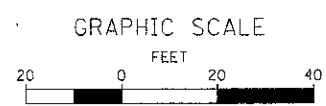
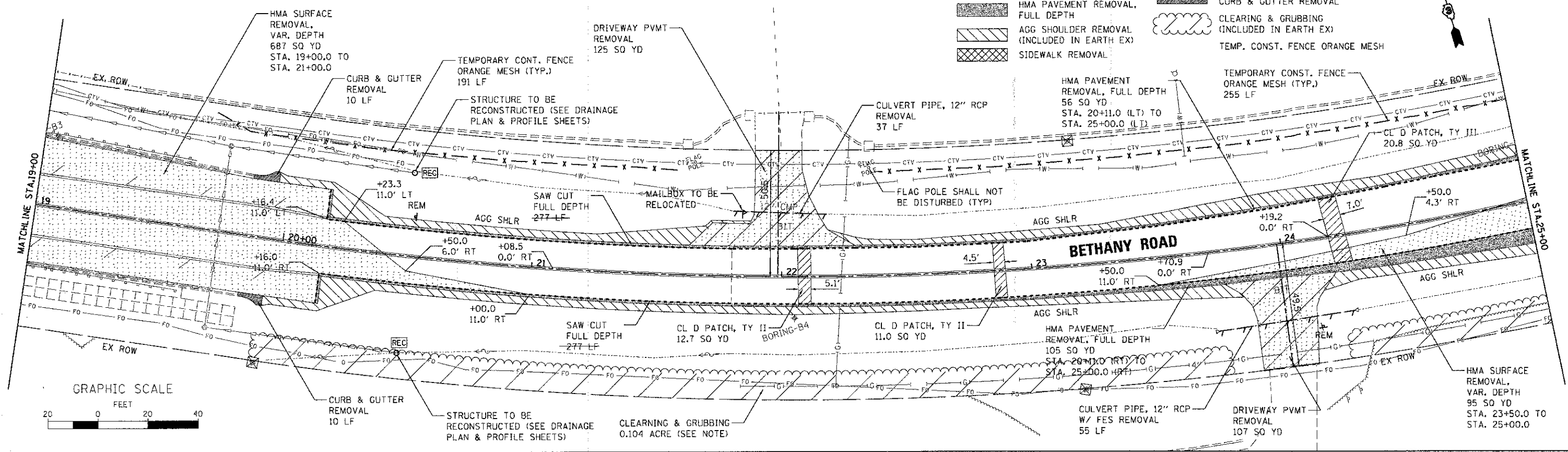

FILE NAME = MAP\Projects\2012\120855\_Bethany\3-CADD\Civil\Drawn\Sheet\REM\_02.dwg

**WILLS BURKE KELSEY ASSOCIATES LTD.**  
 116 West Main Street, Suite 201  
 St. Charles, Illinois 60174

USER NAME = cpar19	DESIGNED - KMA	REVISED -
PLOT SCALE = 1:20	DRAWN - NDP	REVISED -
PLOT DATE = 12/20/2012	CHECKED - DPB	REVISED -
	DATE - 12/21/12	REVISED -

**STATE OF ILLINOIS  
 DEPARTMENT OF TRANSPORTATION**

**EXISTING CONDITIONS AND REMOVAL PLAN**  
 SCALE: 1"=20' SHEET NO. 2 OF 2 SHEETS STA. 19+00.00 TO STA. 27+00.00

F.A.U. RTE. 5355	SECTION 10-00167-01-WR	COUNTY DEKALB	TOTAL SHEETS 78	SHEET NO. 20
CONTRACT NO. 87544				
ILLINOIS FED. AID PROJECT				