

TRAFFIC SIGNAL NOTES

1. THE PROPOSED PEDESTRIAN PUSH-BUTTONS IN THE NORTHWEST AND SOUTHEAST MAST ARM POLES SHALL UTILIZE THE EXISTING 2/C CABLE THAT CURRENTLY SERVES THE EXISTING PUSH-BUTTONS. THE CONTROLLER SHALL BE MODIFIED SO THAT THE PUSH-BUTTONS CALL THE APPROPRIATE PEDESTRIAN PHASE.
2. LEVEL HMA OR PCC SURFACE SHALL BE PROVIDED BETWEEN THE EDGE OF THE MULTI-USE PATH AND THE RELOCATED PEDESTRIAN PUSH-BUTTON ON THE TRAFFIC SIGNAL POSTS.
3. QUANTITY FOR FULL REPLACEMENT OF THE LEAD-IN CABLES CONNECTING THE PROPOSED DETECTOR LOOPS TO THE CONTROLLER HAS BEEN ESTIMATED. IF THE LOOPS CAN BE MADE FUNCTIONAL WITHOUT REPLACING THE LEAD-IN CABLE BETWEEN THE EXISTING HANDHOLE AND THE CONTROLLER, THEN THE PROPOSED DETECTOR LOOPS SHALL CONNECT TO THE EXISTING LEAD-IN CABLES AT THE EXISTING HANDHOLE.
4. THE UNIT DUCTS FOR DETECTOR LOOPS WILL NOT BE MEASURED FOR PAYMENT AND THE COST WILL BE CONSIDERED INCIDENTAL TO THE COST OF THE DETECTOR LOOP.
5. THE CONTRACTOR SHALL UTILIZE EXISTING CONDUIT HOLES IN THE HANDHOLE WHERE POSSIBLE TO AVOID DRILLING ADDITIONAL HOLES FOR THE PROPOSED CONDUITS AND UNIT DUCTS. UPON ENGINEER'S APPROVAL, THE CONTRACTOR MAY DRILL EXISTING HANDHOLE. THE PAY ITEM "DRILL EXISTING HANDHOLE" WILL ONLY BE PAID ONCE PER HANDHOLE, NO MATTER HOW MANY HOLES HAVE BEEN DRILLED. THE HANDHOLE SHALL BE SEALED WHERE THE PROPOSED CONDUITS AND UNIT DUCTS ENTER IT. THE SEALING WILL NOT BE MEASURED FOR PAYMENT AND WILL BE CONSIDERED INCIDENTAL TO THE COST OF THE CONDUIT AND UNIT DUCT (DETECTOR LOOP).
6. THE PEDESTRIAN PUSH-BUTTONS AND SIGNS (MUTCD R10-3E) SHALL BE INSTALLED PERPENDICULAR TO THE DIRECTION OF THEIR RESPECTIVE CROSSWALKS.
7. THE PROPOSED PEDESTRIAN SIGNAL HEADS SHALL UTILIZE THE EXISTING 3/C CABLE THAT CURRENTLY SERVES THE EXISTING PEDESTRIAN SIGNAL HEADS.

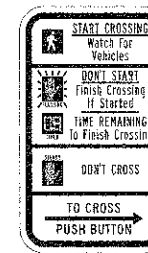

R10-3E
9"x15"

SEE EXISTING SIGNAL PLANS IN CONTROLLER FOR LAYOUT OF EXISTING DETECTOR LOOPS.

SEE EXISTING SIGNAL PLANS IN CONTROLLER FOR LAYOUT OF EXISTING DETECTOR LOOPS.

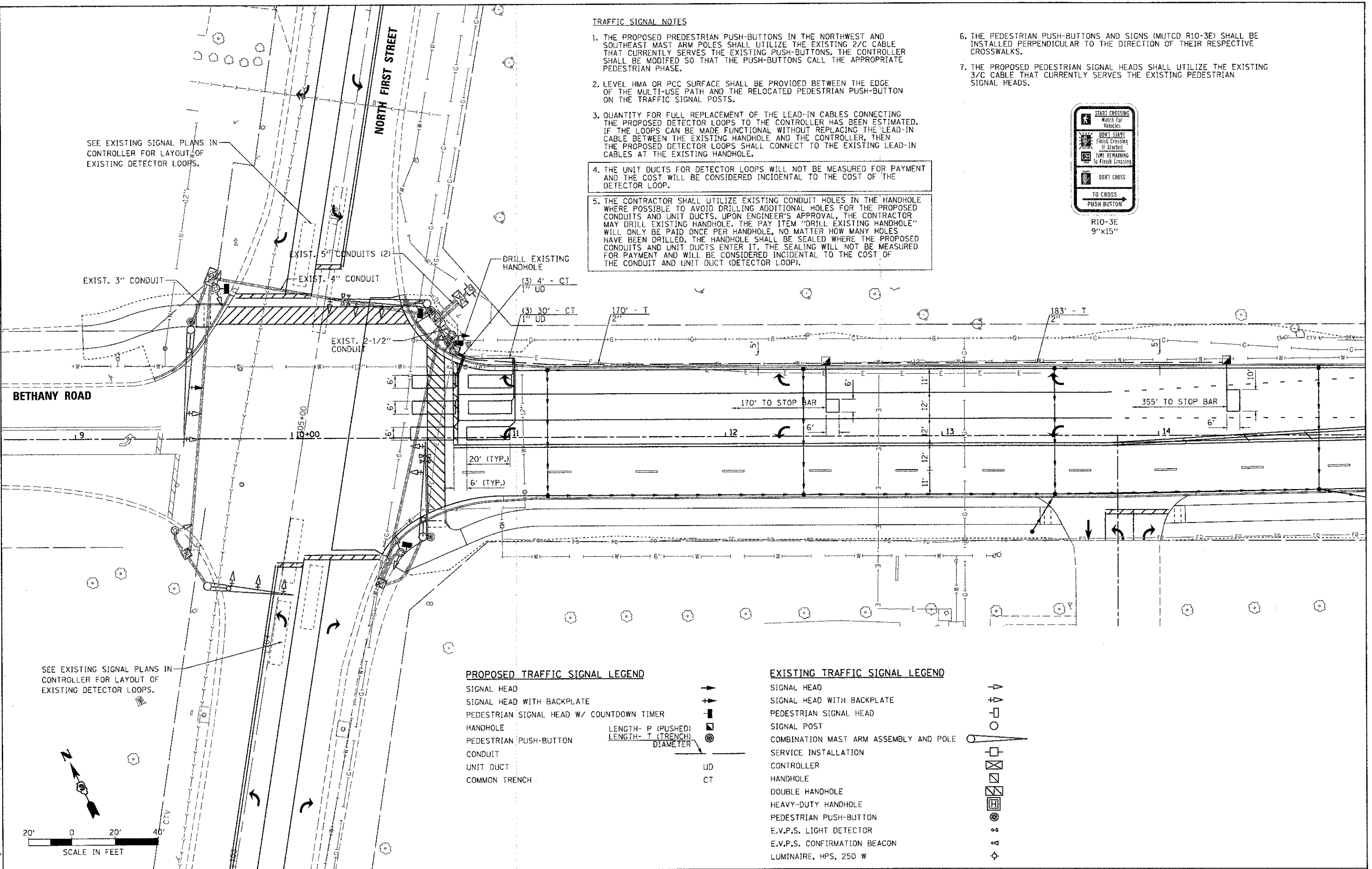

PROPOSED TRAFFIC SIGNAL LEGEND

- SIGNAL HEAD
- SIGNAL HEAD WITH BACKPLATE
- PEDESTRIAN SIGNAL HEAD W/ COUNTDOWN TIMER
- HANDHOLE
- PEDESTRIAN PUSH-BUTTON
- CONDUIT
- UNIT DUCT
- COMMON TRENCH

EXISTING TRAFFIC SIGNAL LEGEND

- SIGNAL HEAD
- SIGNAL HEAD WITH BACKPLATE
- PEDESTRIAN SIGNAL HEAD
- SIGNAL POST
- COMBINATION MAST ARM ASSEMBLY AND POLE
- SERVICE INSTALLATION
- CONTROLLER
- HANDHOLE
- DOUBLE HANDHOLE
- HEAVY-DUTY HANDHOLE
- PEDESTRIAN PUSH-BUTTON
- E.V.P.S. LIGHT DETECTOR
- E.V.P.S. CONFIRMATION BEACON
- LUMINAIRE, HPS, 250 W

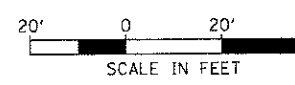

**STATE OF ILLINOIS
DEPARTMENT OF TRANSPORTATION**

TRAFFIC SIGNAL PLAN

SCALE: AS SHOWN SHEET NO. 2 OF 3 SHEETS STA. TO STA.

F.A.U. RTE.	SECTION	COUNTY	TOTAL SHEETS	SHEET NO.
5355	10-00167-01-WR	DEKALB	18	49
CONTRACT NO. 87544				
ILLINOIS FED. AID PROJECT				

FILE NAME: W:\Projects\2012\120115 Bethany\5355\CRD\Civil\Drawings\TS_2.dgn

WILLS BURKE KELSEY ASSOCIATES LTD.
116 West Main Street, Suite 201
St. Charles, Illinois 60174

USER NAME: nparr15	DESIGNED: KMA	REVISED:
PLLOT SCALE: 1/20	DRAWN: KMA	REVISED:
PLLOT DATE: 12/20/2012	CHECKED: DPB	REVISED:
	DATE: 12/21/12	REVISED: