

BM #5 EAST SIDE OF LOGAN AVE AT DANVILLE TENNIS CENTER, BOLT ON FIRE HYDRANT BETWEEN ALBERT "C" VILLE, ELEV 620.19

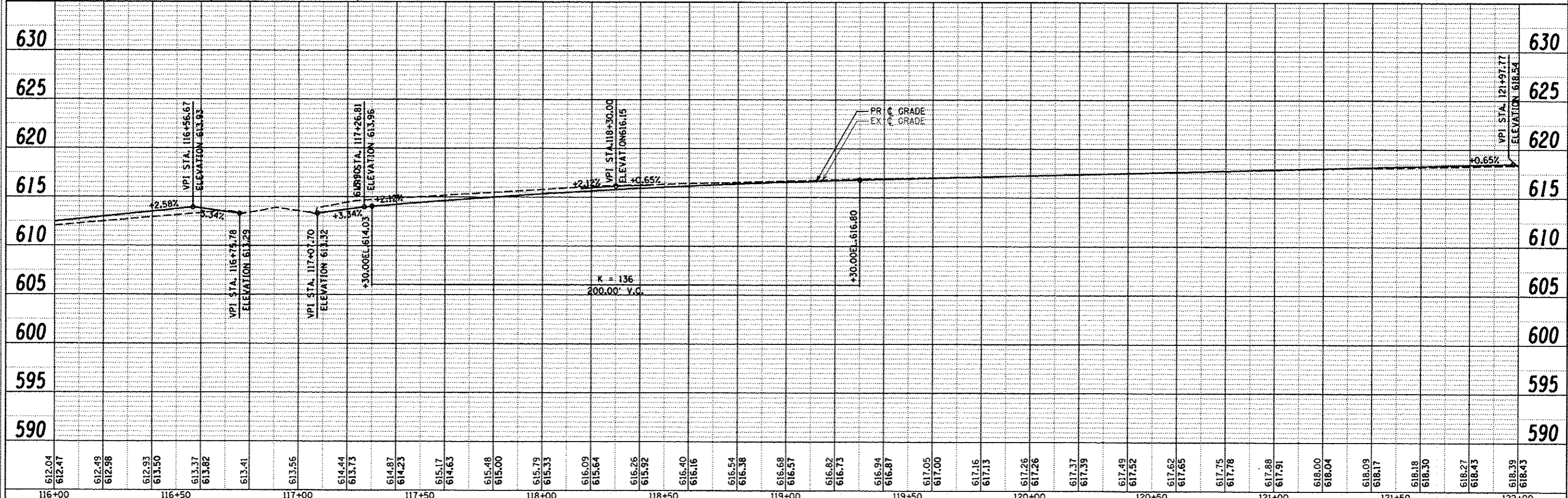
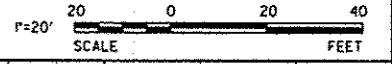

612.04	612.47	612.49	612.98	612.93	613.50	613.37	613.82	613.41	613.56	614.44	613.73	614.87	614.23	615.17	614.63	615.48	615.00	615.79	615.33	616.09	615.64	616.26	615.92	616.40	616.16	616.54	616.38	616.68	616.57	616.82	616.73	616.94	616.87	617.05	617.00	617.16	617.13	617.26	617.26	617.37	617.39	617.49	617.52	617.62	617.65	617.75	617.78	617.88	617.91	618.00	618.04	618.09	618.17	618.18	618.30	618.27	618.43	618.39	618.43
116+00	116+50	117+00	117+50	118+00	118+50	119+00	119+50	120+00	120+50	121+00	121+50	122+00																																															

ESI CONSULTANTS, LTD
753 WINDSOR ROAD
CHARLESTON, IL 61920
(217) 248-1900
WWW.ESI-CONSULTANTS.COM
ILLINOIS DEPARTMENT OF PROFESSIONAL REGULATION REGISTRATION #184-003085

CITY OF DANVILLE
1155 E. VOORHEES STREET
SUITE A
DANVILLE, IL 61832

NO.	DATE	DESCRIPTION OF REVISIONS	NO.	DATE	DESCRIPTION OF REVISIONS

SECTION NO. 08-00224-00-BT
ENGR: ADG
ESI PROJECT NO: 07-163-074-01
DRAWN BY: ADG
DATE: 10-31-2012
QC/QA: DLCPAT

**LINCOLN PARK HISTORIC
DIST SHARED USE PATH**
CITY OF DANVILLE, VERMILION COUNTY

PLAN AND PROFILE
STA 116+00 TO STA 122+00
SHEET 4 OF 14
DRAWING NO. **17**
OF 40