

FROMAN, IONA
DWL 2570

BRIDGEWATER, HAROLD JR
& MONIQUE
DWL 2569

WHITE,
ELIZABETH A
DWR 0007

DAVIS, RICHARD & TAMMY
DWR 0008

GARFIELD ELEMENTARY SCHOOL

CONTRACT NO. 91476

ENGLISH ST & GILBERT ST
RADIUS POINT COORDINATES:
NW - X: 1179303.88, Y: 1266463.09
NE - X: 1179375.57, Y: 1266464.20
SW - X: 1179304.67, Y: 1266391.17
SE - X: 1179376.61, Y: 1266389.21

MATCHLINE STA 150+00

MATCHLINE STA 156+00

HUTCHERSON, CECILE
DWL 1900
BM #10 SW CORNER OF ENGLISH ST AND GILBERT ST, BOLT ON FIRE HYDRANT BETWEEN ALBERT "TJ" VILLE. ELEV 615.60

HUNTER, DUANE A
DWL 1899

NEW UNION BAPTIST CHURCH
DWL 1789A

HAMILTON, ROBERT
DWL 1810

FORD, SYLVESTER H
DWL 1811

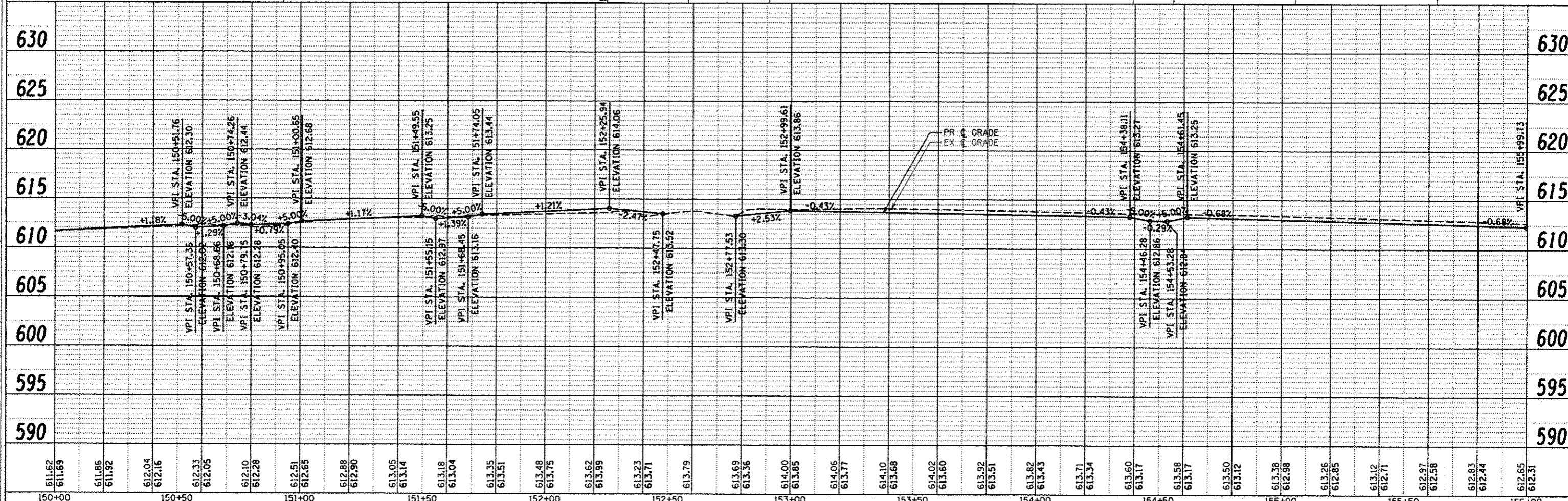

611.62	611.69	611.86	611.92	612.04	612.16	612.33	612.05	612.10	612.28	612.51	612.65	612.88	612.90	613.05	613.14	613.18	613.04	613.35	613.51	613.48	613.75	613.62	613.99	613.23	613.71	613.79	613.69	613.36	614.00	613.85	614.06	613.77	614.10	613.68	614.02	613.60	613.92	613.51	613.82	613.43	613.71	613.34	613.60	613.17	613.58	613.17	613.50	613.12	613.38	612.98	613.26	612.85	613.12	612.71	612.97	612.58	612.83	612.44	612.65	612.51
150+00	150+50	151+00	151+50	152+00	152+50	153+00	153+50	154+00	154+50	155+00	155+50	156+00																																																

ESI CONSULTANTS, LTD
752 WINDSOR ROAD
CHARLESTON, IL 61923
(217) 348-1800
WWW.ESICONSULTANTS.COM
ILLINOIS DEPARTMENT OF PROFESSIONAL REGULATION REGISTRATION #184-003895

CITY OF DANVILLE
1155 E. VOORHEES STREET
SUITE A
DANVILLE, IL 61832

NO.	DATE	DESCRIPTION OF REVISIONS	NO.	DATE	DESCRIPTION OF REVISIONS

SECTION NO. 08-00224-00-BT
ENGR: ADG
ESI PROJECT NO. 07-163-074-01
DRAWN BY: ADG
DATE: 10-31-2012
CCQA: DLCPAT

**LINCOLN PARK HISTORIC
DIST SHARED USE PATH**
CITY OF DANVILLE, VERMILION COUNTY

PLAN AND PROFILE
STA 150+00 TO STA 156+00
DRAWING NO. **23**
SHEET 10 OF 14 OF 40