

INDEX OF SHEETS

- COVER SHEET, INDEX OF SHEETS, SCHEDULE OF QUANTITIES AND HIGHWAY STANDARDS
- GENERAL NOTES AND TYPICAL SECTIONS
- PLAN - MAIN ST AND ELECTRICAL DETAILS
- PLAN - OAK ST & 3RD ST
- PLAN - 2ND ST & 1ST ST
- SCHEDULE OF QUANTITIES

HIGHWAY STANDARDS

424001-07	PERPENDICULAR CURB RAMPS FOR SIDEWALKS
606001-05	CONCRETE CURB TYPE B AND COMBINATION CONCRETE CURB AND GUTTER
701501-06	URBAN LANE CLOSURE, 2L, 2W UNDIVIDED
701006-04	OFF-RD OPERATIONS, 2L, 2W, 15' TO 24" FROM PAVEMENT EDGE
701801-05	SIDEWALK, CORNER OR CROSSWALK CLOSURE
701901-02	TRAFFIC CONTROL DEVICES
805001-01	ELECTRIC SERVICE INSTALLATION DETAILS
880001-01	SPAN WIRE MOUNTED SIGNALS AND FLASHING BEACON INSTALLATION
814001-02	HANDHOLES

△ SPECIALTY ITEMS

SCHEDULE OF QUANTITIES

QUANTITY	UNIT	PAY ITEMS	PAY ITEM NUMBER	SP
24	UNIT	TREE REMOVAL (OVER 15 UNITS DIAMETER)	20100210	
19,507	SQ FT	PORTLAND CEMENT CONCRETE SIDEWALK 4 INCH	42400100	
1,082	SQ FT	PORTLAND CEMENT CONCRETE SIDEWALK 6 INCH	42400300	
248	SQ FT	DETECTABLE WARNINGS	42400800	
22	FOOT	COMBINATION CURB AND GUTTER REMOVAL	44000500	
17,269	SQ FT	SIDEWALK REMOVAL	44000600	
61	FOOT	PIPE CULVERTS, CLASS C, TYPE 1 1/2"	542C0217	
12	FOOT	PIPE CULVERTS, CLASS C, TYPE 1 1/2"	542C0220	
26	FOOT	PIPE CULVERTS, CLASS C, TYPE 1 1/2"	542C0223	
22	FOOT	COMBINATION CURB AND GUTTER REMOVAL, TYPE B-6.24 (ABUTTING EXISTING PAVEMENT)	60605100	*
1	L SUM	MOBILIZATION	67100100	
260	FOOT	PAINT PAVEMENT MARKING - LINE 4"	78001110	△
57	FOOT	PAINT PAVEMENT MARKING - LINE 6"	78001130	△
69	FOOT	UNDERGROUND CONDUIT, PVC, 1 1/2" DIA.	81028340	△
28	FOOT	CONDUIT ATTACHED TO STRUCTURE, 1 1/2" DIA., GALVANIZED STEEL	81100500	△
1	EACH	HANDHOLE	81400100	△
1	EACH	FLASHER/CONTROLLER	85800100	△
103	FOOT	ELECTRIC CABLE IN CONDUIT, SIGNAL NO. 14 3C	87301225	△
2	EACH	SIGNAL HEAD, POLYCARBONATE, LED, 1-FACE, 1-SECTION, POST MOUNTED	88040030	△
2	EACH	POST MOUNTED FLASHING BEACON INSTALLATION	X0326865	* △
1	L SUM	TRAFFIC CONTROL AND PROTECTION, (SPECIAL)	X7010216	* △
1	EACH	SERVICE INSTALLATION, TYPE A (MODIFIED)	X8050115	* △
60	SQ FT	DETECTABLE WARNINGS, SPECIAL	XX007729	* △
2	EACH	PORTLAND CEMENT CONCRETE SIDEWALK OFFSET GRINDING	XX008552	* △

STATE OF ILLINOIS  
DEPARTMENT OF TRANSPORTATION  
DIVISION OF HIGHWAYS

SAFE ROUTES TO SCHOOL PROGRAM  
VILLAGE OF ALLENDALE  
WABASH COUNTY

SECTION 12-00006-00-SW  
PROJECT SRTS-4009(245)  
JOB NO. C-97-020-13



Know what's below.  
Call before you dig.



LOCATION OF SECTION INDICATED THUS: X

AGENCY RESPONSIBLE FOR LETTING

APPROVED December 21 2012

Timothy J. Gorman  
VILLAGE PRESIDENT

PASSED 1-8 2013

Manuel K. Kroll  
DISTRICT 7 ENGINEER OF LOCAL ROADS & STREETS

RELEASING FOR BID  
BASED ON LIMITED  
REVIEW 1-8 2013

Ronnie L. Dishell  
DEPUTY DIRECTOR OF HIGHWAYS, REGION 4 ENGINEER

PROFESSIONAL ENGINEER'S SIGN & SEAL

Michael L. Gill  
MICHAEL L. GILL, P.E.  
EXP. 11-30-13

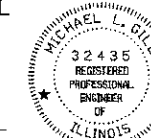

SEAL

PRINTED BY THE AUTHORITY  
OF THE STATE OF ILLINOIS

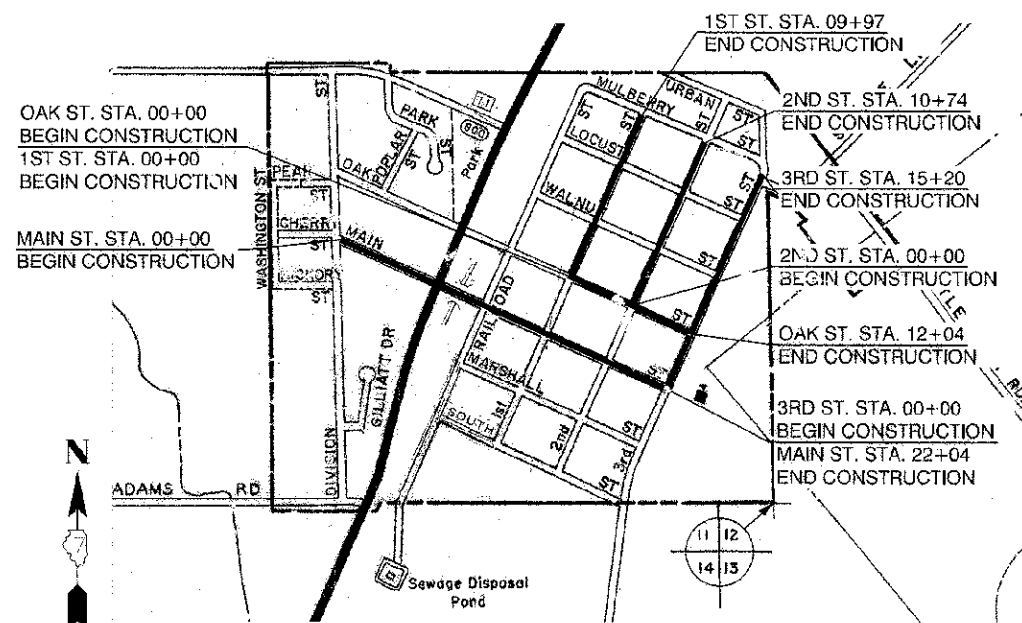

LOCATION MAP  
(NOT TO SCALE)

PROJECT GROSS LENGTH:  
MAIN STREET = 2204 FEET (0.42 MILES)  
OAK STREET = 1204 FEET (0.23 MILES)  
3RD STREET = 1520 FEET (0.29 MILES)  
2ND STREET = 1074 FEET (0.20 MILES)  
1ST STREET = 997 FEET (0.19 MILES)

TOTAL = 6999 FEET (1.33 MILES)



223 W. 190th St.  
P.O. Box 130  
151 - 46th Ave. S. 32803  
PHONE: 612-267-8855  
FAX: 612-267-3327  
WWW.LAMAC.NET

USER NAME = X	DESIGNED = DSR	REVISED = X
LEC # C12L017AD	CHECKED = AMM	REVISED = X
PLOT SCALE = X	DRAWN = DSR	REVISED = X
PLOT DATE = X	CHECKED = AMM	REVISED = X

VILLAGE OF ALLENDALE

COVER SHEET/TITLE PAGE

SCALE: STA. X TO STA. X

F.A.U. RTE.	SECTION	COUNTY	TOTAL SHEETS	SHEET NO.
VAR	12-000-06-00-SW	WABASH	1	8
LEC JOB NO. C12L017AD		CONTRACT NO. 95699		
FED. ROAD DIST. NO. 7   ELP#018   FED. AID PROJECT SRTS-4009(245)				