

PLAN	BY	DATE
SURVEYED		
ALIGNED		
GRADES CHECKED		
STRUCTURE NOTATIONS OK'D		
NOTE BOOK		
NO. OF WAYS CHECKED		
NO. OF FILE NAME		

PROFILE	BY	DATE
SURVEYED		
GRADES CHECKED		
STRUCTURE NOTATIONS OK'D		
NOTE BOOK		
NO. OF WAYS CHECKED		
NO. OF FILE NAME		

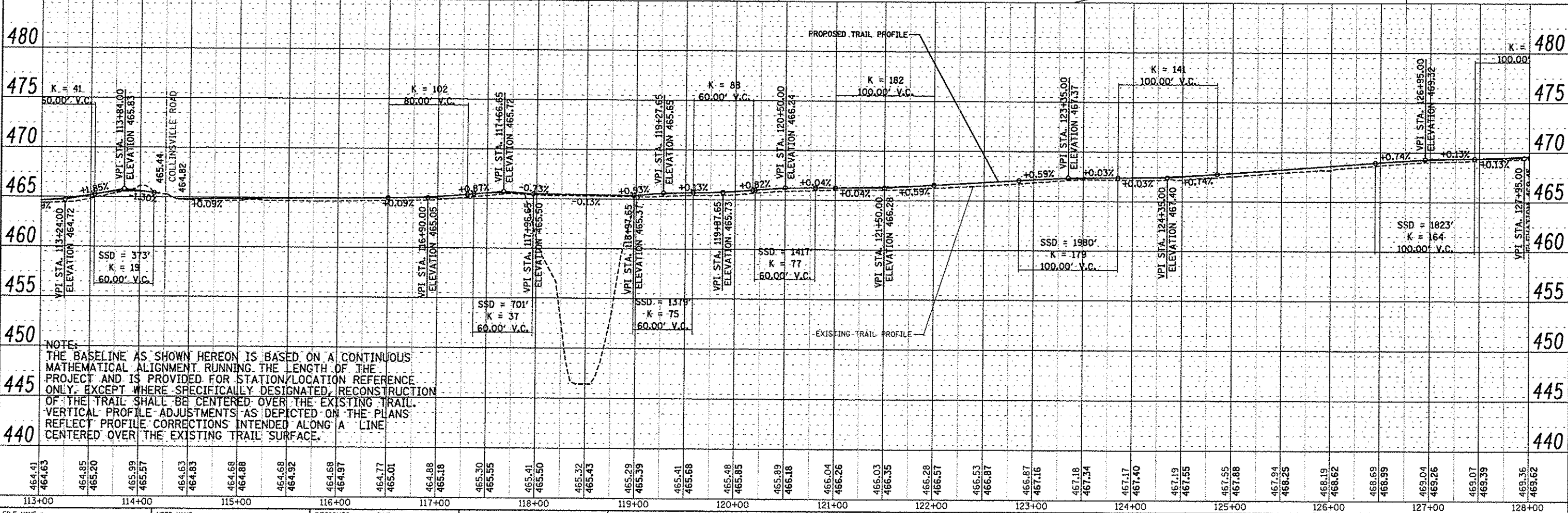
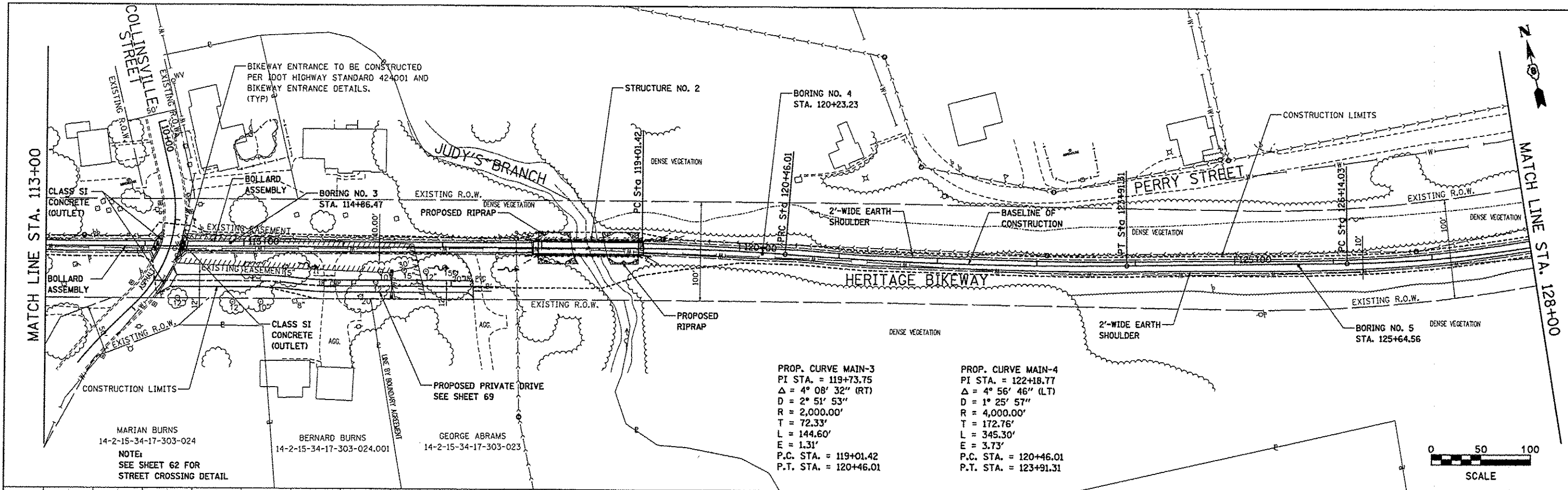

NOTE:
 THE BASELINE AS SHOWN HEREON IS BASED ON A CONTINUOUS MATHEMATICAL ALIGNMENT RUNNING THE LENGTH OF THE PROJECT AND IS PROVIDED FOR STATION/LOCATION REFERENCE ONLY. EXCEPT WHERE SPECIFICALLY DESIGNATED, RECONSTRUCTION OF THE TRAIL SHALL BE CENTERED OVER THE EXISTING TRAIL. VERTICAL PROFILE ADJUSTMENTS AS DEPICTED ON THE PLANS REFLECT PROFILE CORRECTIONS INTENDED ALONG A LINE CENTERED OVER THE EXISTING TRAIL SURFACE.

FILE NAME = p1a-02.dgn	USER NAME = jeramy	DESIGNED - SAS	MADISON COUNTY TRANSIT DISTRICT		PLAN AND PROFILE		F.A. R.T.E.	SECTION	COUNTY	TOTAL SHEETS	SHEET NO.
		DRAWN - JOH	HERITAGE BIKEWAY					06-00016-00-BT	MADISON	310	33
		CHECKED - WJB			SCALE: 1" = 50'		SHEET NO. 2 OF 30 SHEETS		STA. 113+00.00 TO STA. 128+00.00		CONTRACT NO. 97433
		DATE = 11/30/12							FED. ROAD DIST. NO.		ILLINOIS FED. AID PROJECT