

PLAN	DATE
BY	
REVISIONS	
NO.	
DESCRIPTION	
DATE	
BY	

PROFILE	DATE
BY	
REVISIONS	
NO.	
DESCRIPTION	
DATE	
BY	

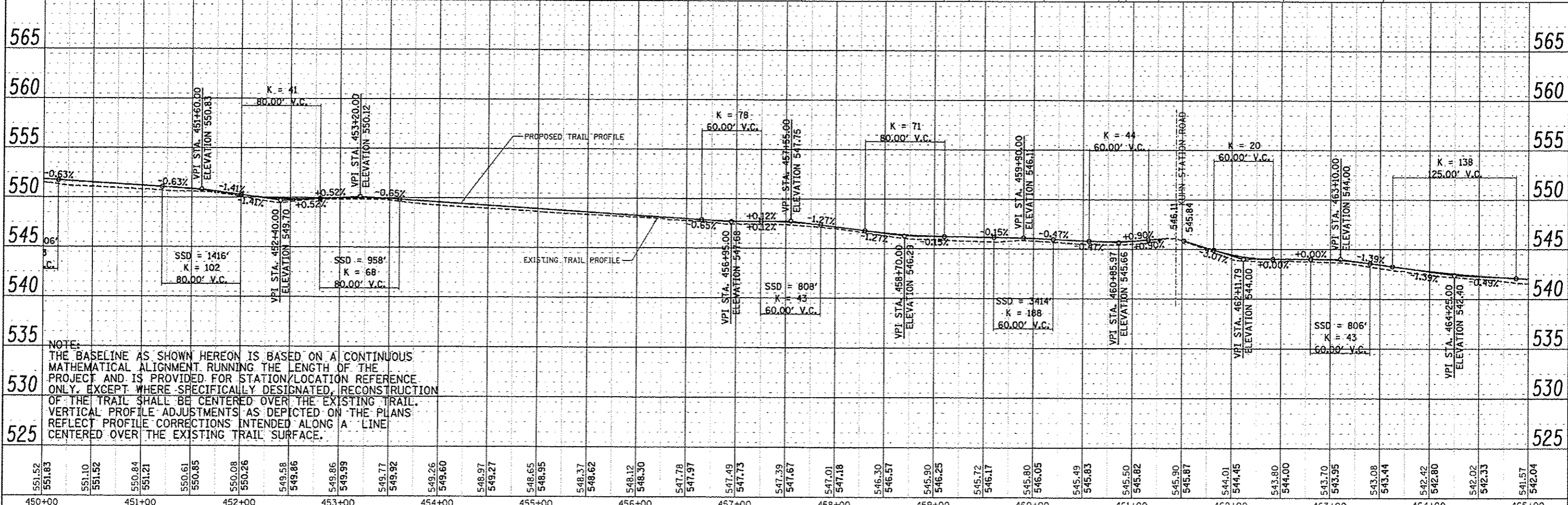
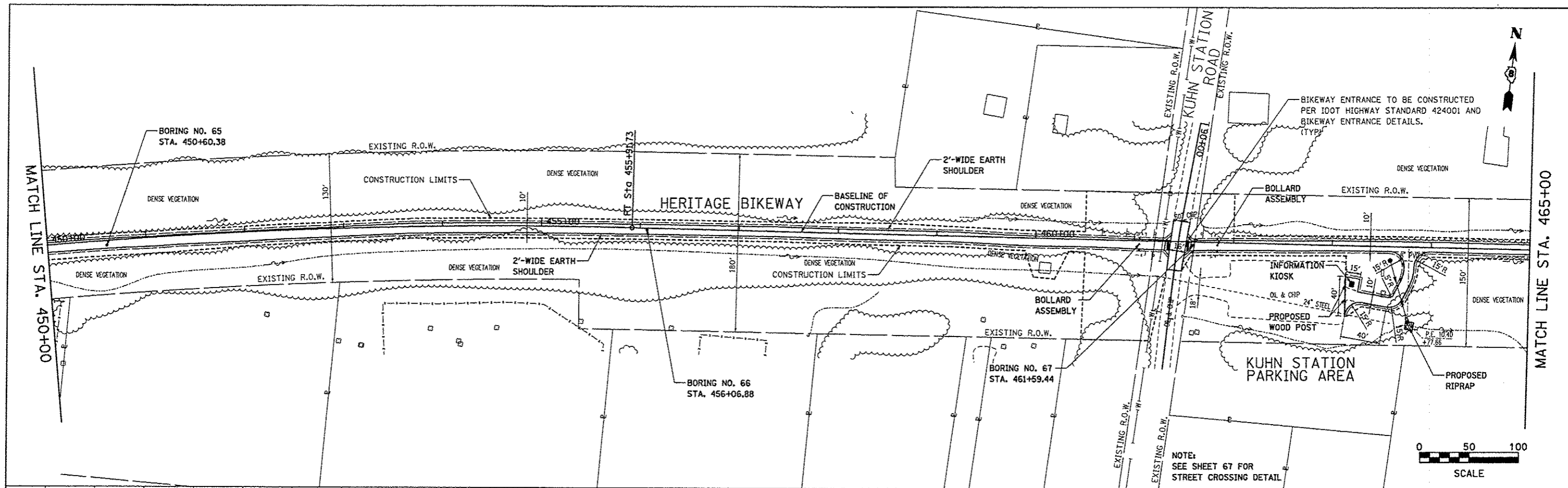

NOTE:
 THE BASELINE AS SHOWN HEREON IS BASED ON A CONTINUOUS MATHEMATICAL ALIGNMENT RUNNING THE LENGTH OF THE PROJECT AND IS PROVIDED FOR STATION/LOCATION REFERENCE ONLY. EXCEPT WHERE SPECIFICALLY DESIGNATED, RECONSTRUCTION OF THE TRAIL SHALL BE CENTERED OVER THE EXISTING TRAIL. VERTICAL PROFILE ADJUSTMENTS AS DEPICTED ON THE PLANS REFLECT PROFILE CORRECTIONS INTENDED ALONG A LINE CENTERED OVER THE EXISTING TRAIL SURFACE.

FILE NAME = plan25.dgn	USER NAME = Jeremy	DESIGNED - SAS	MADISON COUNTY TRANSIT DISTRICT		PLAN AND PROFILE		F.A. RTE.	SECTION	COUNTY	TOTAL SHEETS	SHEET NO.
		DRAWN - JQH	HERITAGE BIKEWAY		SCALE: 1" = 50'		06-00016-00-BT	MADISON	310	56	
		CHECKED - WJB			SHEET NO. 25 OF 30 SHEETS						
		DATE = 11/30/12			STA. 450+00.00 TO STA. 465+00.00		ILLINOIS FED. AID PROJECT		CONTRACT NO. 97433		