

F.A.U. RTE.	SECTION	COUNTY	TOTAL SHEETS	SHEET NO.
	06-00016-00-BT	MADISON	310	185
FED. ROAD DIST. NO.	ILLINOIS CONTRACT NO.		97433	

WOOD RAIL BILL OF MATERIAL

Item	Unit	Quantity
Wood Rail	Foot	43.5

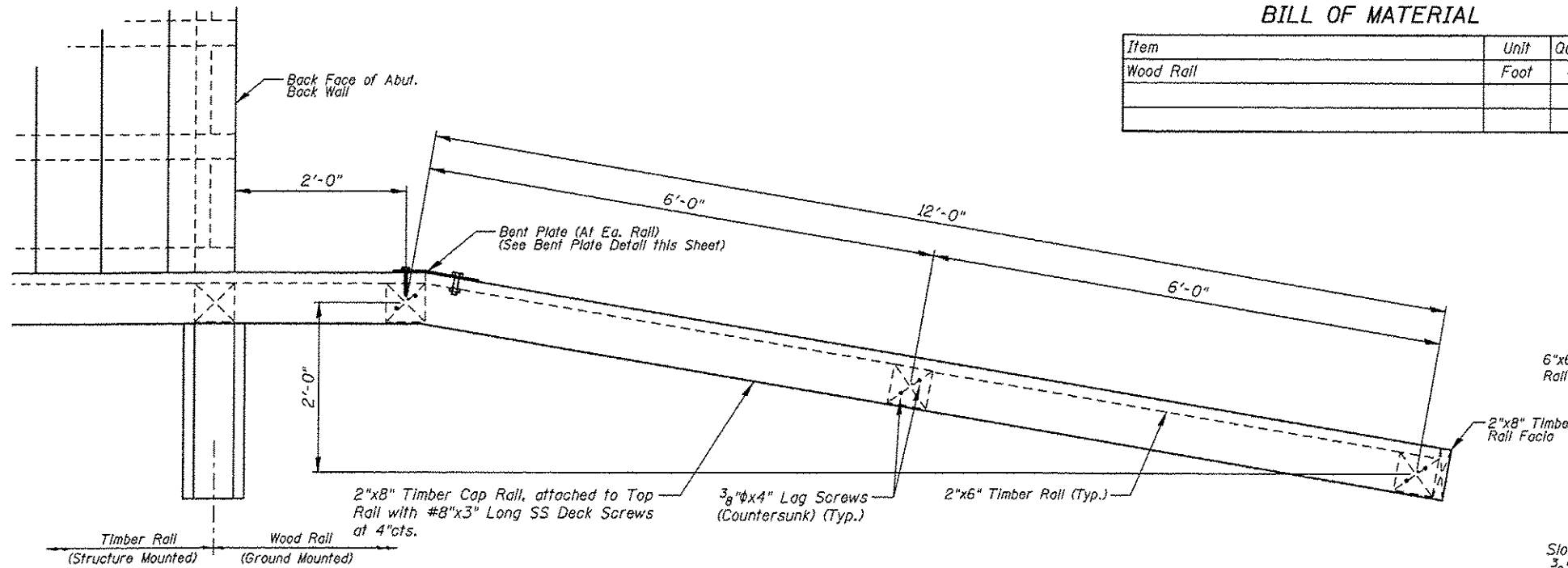

PLAN

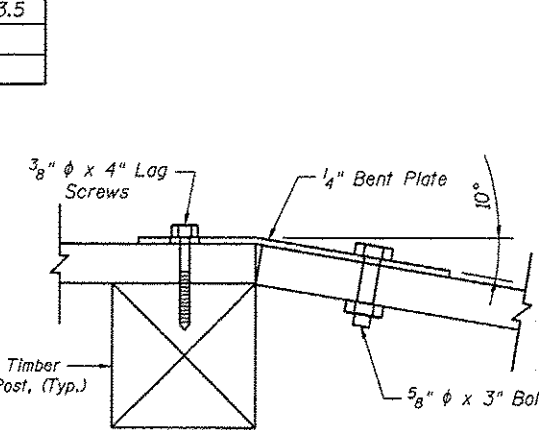

BENT PLATE

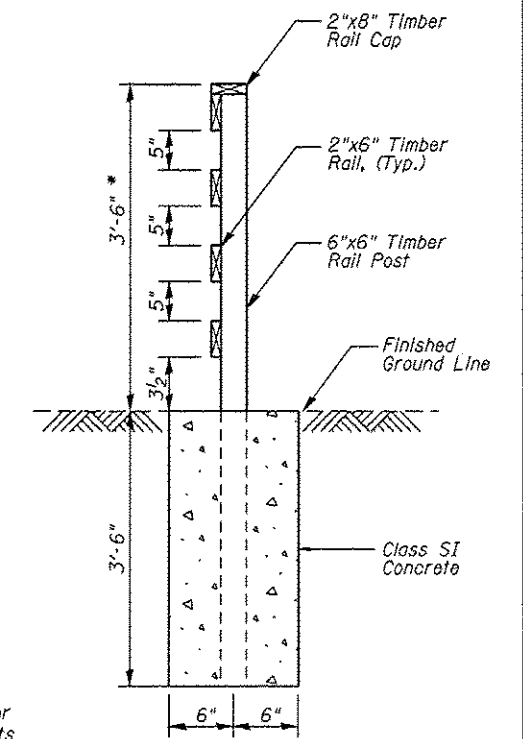

SECTION A-A

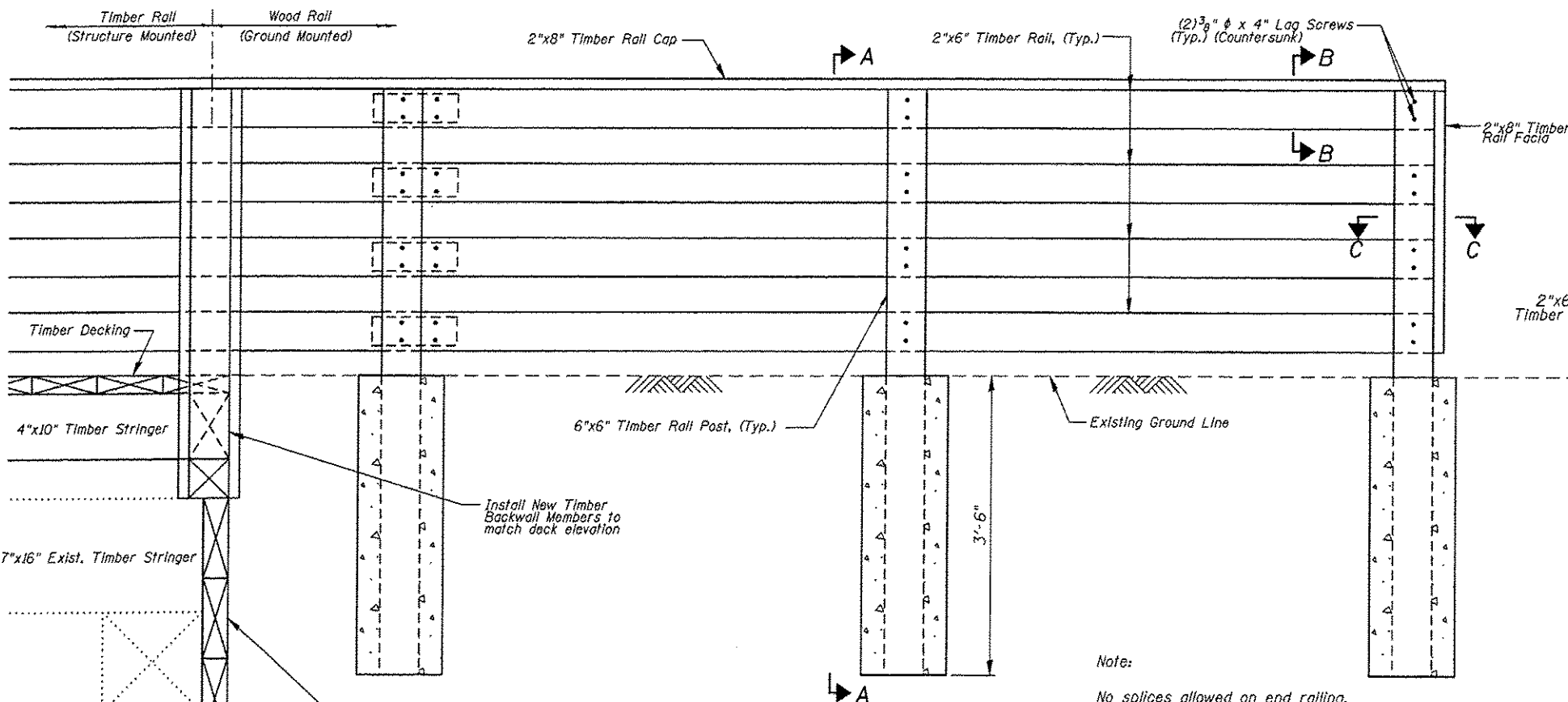

ELEVATION

Typical Wood Rail
Except as Noted (See Sheet 6)

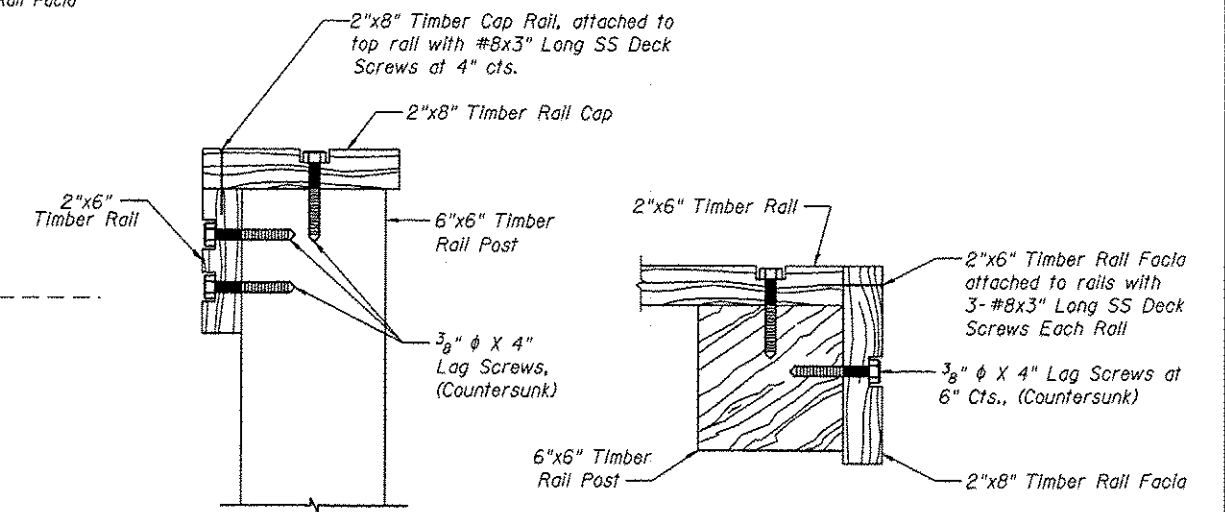

SECTION B-B

SECTION C-C

Note:

No splices allowed on end railing.

Payment for furnishing & installing all material, necessary to construct the wood rail, including all posts, rails, rail cap, bent plate, hardware, excavation, Class SI concrete and all other appurtenances and incidental work, complete in place, will be considered completely covered by the contract unit price per foot for Wood Rail.

* Top of top timber rail shall be installed a minimum of 3'-6" above the finished groundline. Adjust post length according in field.

WOOD RAIL DETAILS

		GLEN CARBON HERITAGE BIKE TRAIL OVER JUDY BRANCH MADISON COUNTY STATION 167+25.86 STRUCTURE NO. 4	
REVISIONS NO. DATE BY REMARKS		SCALE: NOT TO SCALE, FOLLOW DIMENSIONS	
DSN. BY: DB	DATE: 10/18/12	SHEET	185
DWN. BY: EER	DATE: 10/18/12	CHK'D: WWH	DATE: 10/18/12
DGN NAME:	JOB NO. E064403	DGN NO.	DP 510 SHEETS

10/03/07 AM 12/19/2012 W:\STRUCTURE\064403 MCT Heritage Trail\Drawings\Structure 107-2012\05-061015-100 Fence Details.dgn