

F.A.U. RTE.	SECTION	COUNTY	TOTAL SHEETS	SHEET NO.
	06-00016-00-BT	MADISON	310	199
FED. ROAD DIST. NO.		ILLINOIS CONTRACT NO. 97433		

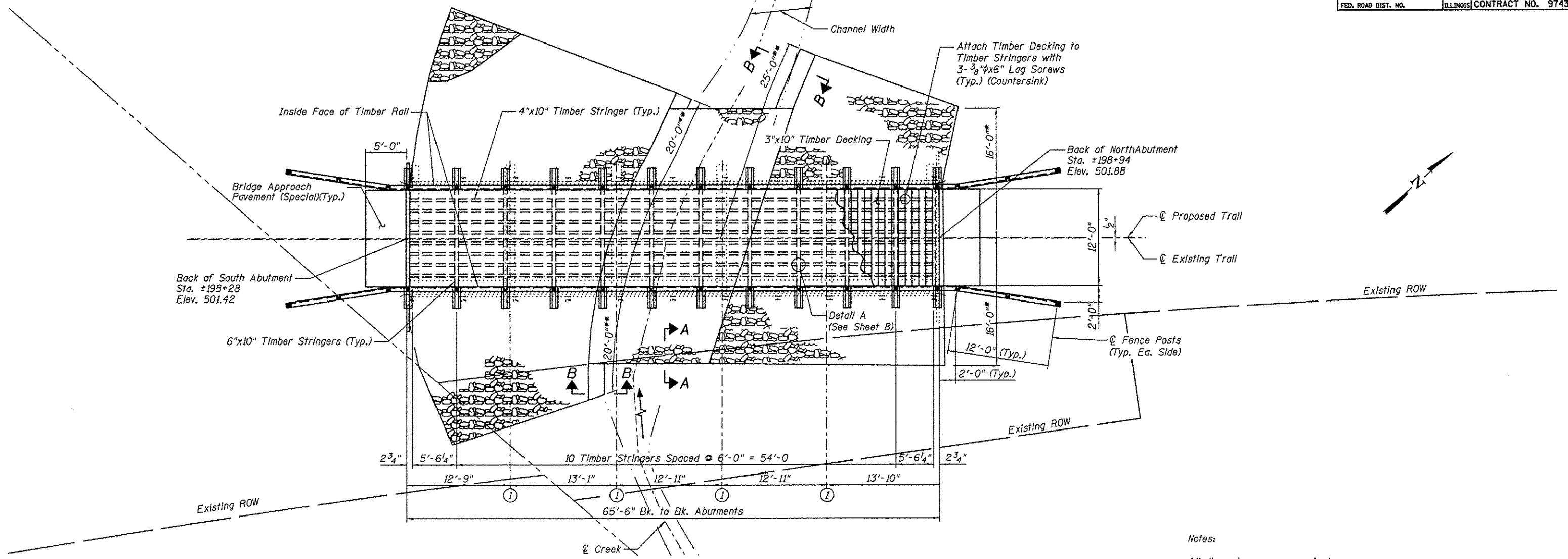

Notes:

All dimensions are approximate.

For General Notes and Total Bill of Material, see Sheet No. 2

For Cross Sections and Approach Slab Detail, see Sheet No. 3

For Section A-A & B-B and Stone Riprap Details, see Sheet No. 3

All new timber members shown shall be included in the pay item Treated Timber.

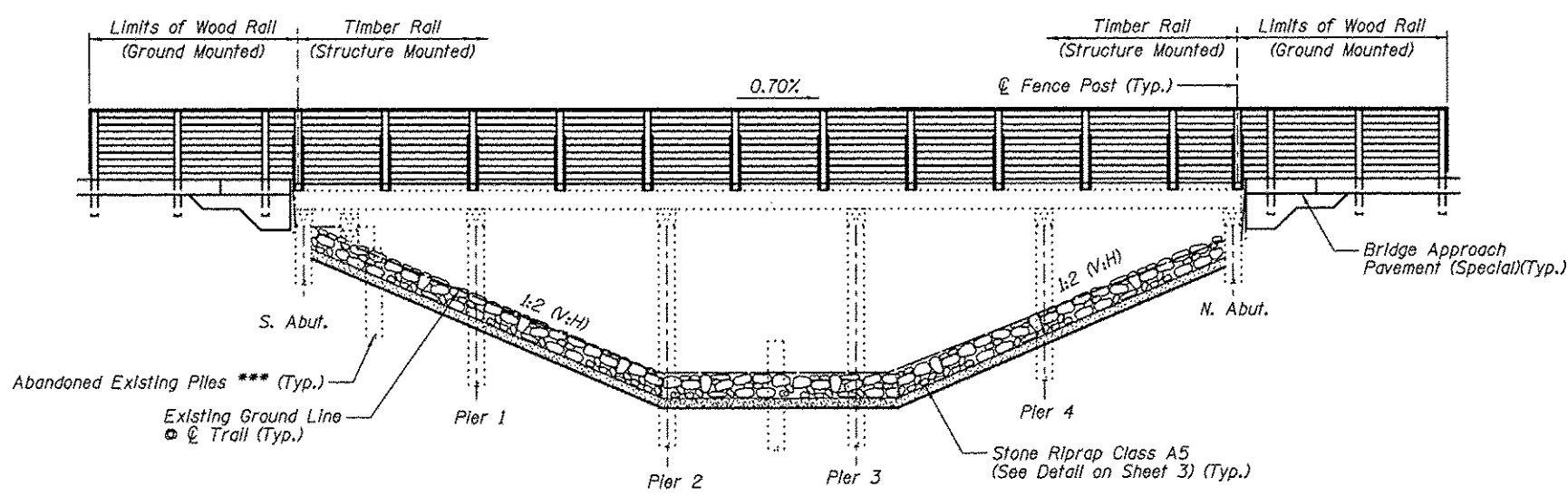

I certify to the best of knowledge, information and belief, this bridge design is structurally adequate for the design loading shown on the plans. The design is an economical one for the style of structure and complies with requirements of the current AASHTO Standard Specification for Highway Bridges.

WESLEY W. HERNDON, S.E. 11/2/13

Expire 11-30-13

* Limits of Stone Riprap

** Limits of Stone Riprap, measured along Toe of Slope.

*** Abandoned Existing Piles shall be removed to at least 1 foot below the proposed ground surface

 Juneau Associates, Inc. P.C. CONSULTING ENGINEERS AND LAND SURVEYORS 2100 State Street, P.O. Box 1125 Oneida, TN 37133-1125 Phone: (615) 947-1400 Fax: (615) 947-9401		GLEN CARBON HERITAGE BIKE TRAIL OVER JUDY BRANCH MADISON COUNTY STATION 198+54.27 STRUCTURE NO. 6	
REVISIONS		SCALE: NOT TO SCALE, FOLLOW DIMENSIONS	
NO.	DATE	BY	REMARKS
		DSN. BY: DB	DATE: 10/18/12
		DWN. BY: EER	DATE: 10/18/12
		CHK'D: WWH	DATE: 10/18/12
DGN NAME:		JOB NO. E064403	DGN. NO.
			OF 310 SHTS

M:\STRUCTURE\Drawings\Structure\06\Proposed Structure\07-2012\00005\Plan & Elevation.dgn
 1/2/2013 8:27:57 AM
 Printed