

UTILITY NOTE

THE LOCATION, SIZE, AND TYPE OF MATERIAL OF EXISTING UNDERGROUND AND/OR ABOVEGROUND UTILITIES INDICATED ON THE PLANS ARE NOT REPRESENTED AS BEING ACCURATE, SUFFICIENT OR COMPLETE. NEITHER THE OWNER NOR THE ENGINEER ASSUMES ANY RESPONSIBILITY WHATEVER IN RESPECT TO THE ACCURACY, COMPLETENESS, OR SUFFICIENCY OF THE INFORMATION. THERE IS NO GUARANTEE, EITHER EXPRESSED OR IMPLIED, THAT THE LOCATIONS, SIZE AND TYPE OF MATERIAL OF EXISTING UNDERGROUND UTILITIES INDICATED ARE REPRESENTATIVE OF THOSE TO BE ENCOUNTERED IN THE CONSTRUCTION. IT SHALL BE THE CONTRACTOR'S RESPONSIBILITY TO DETERMINE THE ACTUAL LOCATION OF ALL SUCH FACILITIES, INCLUDING SERVICE CONNECTIONS TO UNDERGROUND UTILITIES. PRIOR TO CONSTRUCTION, THE CONTRACTOR SHALL NOTIFY THE UTILITY COMPANIES OF HIS OPERATIONAL PLANS AND SHALL OBTAIN FROM THE RESPECTIVE UTILITY COMPANIES DETAILED INFORMATION AND ASSISTANCE RELATIVE TO THE LOCATION OF THEIR FACILITIES AND THE WORKING SCHEDULE OF THE COMPANIES FOR REMOVAL OR ADJUSTMENT WHERE REQUIRED. IN THE EVENT AN UNEXPECTED UTILITY INTERFERENCE IS ENCOUNTERED DURING CONSTRUCTION, THE CONTRACTOR SHALL IMMEDIATELY NOTIFY THE UTILITY COMPANY OF JURISDICTION. THE OWNER'S REPRESENTATIVE AND/OR THE RESIDENT ENGINEER SHALL ALSO BE IMMEDIATELY NOTIFIED. ANY DAMAGE TO SUCH MAINS AND SERVICES SHALL BE RESTORED TO SERVICE AT ONCE AND PAID FOR BY THE CONTRACTOR AT NO ADDITIONAL COST TO THE CONTRACT. ALL UTILITY CABLES AND LINES SHALL BE LOCATED BY THE RESPECTIVE UTILITY. **CONTACT JULIE (JOINT UTILITY LOCATION INFORMATION FOR EXCAVATORS) FOR UTILITY INFORMATION, PHONE: 1-800-892-0123.** CONTACT THE FAA (FEDERAL AVIATION ADMINISTRATION) FOR ASSISTANCE IN LOCATING FAA CABLES AND UTILITIES. LOCATION OF FAA POWER, CONTROL, AND COMMUNICATION CABLES SHALL BE COORDINATED WITH AND/OR LOCATED BY THE FAA. ALSO CONTACT AIRPORT DIRECTOR/MANAGER AND AIRPORT PERSONNEL FOR ASSISTANCE IN LOCATING UNDERGROUND AIRPORT CABLES AND/OR UTILITIES. ALSO COORDINATE WORK WITH ALL ABOVEGROUND UTILITIES.

HAUL ROUTE AND VEHICLE PARKING

THE CONTRACTOR WILL USE THE DESIGNATED HAUL ROUTE AND PARKING AREA AS SHOWN ON THIS SHEET. THE CONTRACTOR WILL BE REQUIRED TO MAINTAIN THE PROPOSED HAUL ROUTE AND PARKING AREA THROUGHOUT THE COURSE OF THE PROJECT. ANY AREAS DAMAGED OUTSIDE OF THESE AREAS WILL BE REPAIRED BY THE CONTRACTOR AND AT THE CONTRACTOR'S OWN EXPENSE. AT THE CONCLUSION OF THE PROJECT THE CONTRACTOR WILL RESTORE THE SECTIONS OF THE HAUL ROUTE AND THE PARKING AREA THAT ARE DESIGNATED TO BE REMOVED AS NEEDED TO RESTORE THEM TO THEIR ORIGINAL STATE. RESTORATION OF THE HAUL ROUTE AND PARKING AREA WILL BE CONSIDERED INCIDENTAL TO THE PROJECT AND NO ADDITIONAL COMPENSATION WILL BE ALLOWED.

CONTRACTOR RESPONSIBILITIES

THE CONTRACTOR'S EQUIPMENT PARKING AND STORAGE AREA WILL BE AS SHOWN ON THIS SHEET. THE CONTRACTOR'S EMPLOYEES WILL PARK THEIR VEHICLES IN THIS AREA. ONLY CONTRACTOR VEHICLES WILL BE ALLOWED OUTSIDE THIS AREA.

THE CONTRACTOR AND HIS EMPLOYEES WILL BE RESTRICTED TO THE WORK AREA AND ALL OTHER AREAS OF THE AIRPORT ARE "OFF LIMITS" TO THEM.

THE CONTRACTOR SHALL FOLLOW THE PROPOSED STAGING PLAN IN THE SPECIAL PROVISIONS FOR KEEPING RUNWAYS/TAXIWAYS OPEN AND CLOSING THEM.

ALL WORK PERFORMED SHALL BE DONE IN A ORDERLY AND EFFECTIVE MANNER TO MINIMIZE RUNWAY CLOSURE.

NO TRENCHES OR HOLES WILL REMAIN OPEN OVERNIGHT.

BARRICADES

IT WILL BE THE CONTRACTOR'S RESPONSIBILITY TO PLACE AND MAINTAIN BARRICADES AS DIRECTED BY THE AIRPORT MANAGER. THE BARRICADES WILL BE EQUIPPED WITH RED FLASHING OR RED STEADY-BURN LIGHTS AND 20" SQUARE ORANGE FLAGS. THE BARRICADES, THEIR MAINTENANCE, PLACEMENT AND REMOVAL WILL BE CONSIDERED AS AN INCIDENTAL ITEM TO THE CONTRACT AND NO ADDITIONAL COMPENSATION WILL BE ALLOWED.

LEGEND

- EXISTING IMPROVEMENTS
- PROPOSED IMPROVEMENTS
- FUTURE PAVEMENT
- EXISTING BUILDINGS
- EXISTING HAUL ROUTE AND EQUIPMENT PARKING AREA
- PROPOSED HAUL ROUTE
- PROPOSED BENCHMARK
- PROPOSED BARRICADES WHEN RUNWAY 13-31 IS CLOSED
- PROPOSED BARRICADES WHEN RUNWAY 18-36 IS CLOSED

SCOPE OF WORK

BASE BID
THIS PROJECT CONSISTS OF PAVING, LIGHTING & MARKING AN 805' EXTENSION TO RUNWAY END 31. ASSOCIATED WORK WILL INCLUDE UNCLASSIFIED EXCAVATION, DRAINAGE, EROSION PROTECTION, SEEDING AND MULCHING. PROJECT ALSO INCLUDES THE REPLACEMENT OF THE MRL SYSTEM ON RUNWAY 13-31.

ADDITIVE ALTERNATE NO. 1
ADDITIVE ALTERNATE NO. 1 WILL CONSIST OF THE REMOVAL AND REPLACEMENT OF THE PRECISION APPROACH PATH INDICATOR (PAPI) UNITS ON RUNWAY END 31.

ADDITIVE ALTERNATE NO. 2
ADDITIVE ALTERNATE NO. 2 WILL CONSIST OF THE UPGRADE OF THE MEDIUM INTENSITY RUNWAY LIGHTS TO TYPE L-861(L) WITH LED (LIGHT EMITTING DIODE) ILLUMINATION, UPGRADE OF THE MEDIUM INTENSITY THRESHOLD LIGHTS TO TYPE L-861E(L) WITH LED ILLUMINATION.

ADDITIVE ALTERNATE NO. 3
ADDITIVE ALTERNATE NO. 3 WILL CONSIST OF THE REPAINTING OF THE REMAINING PORTION OF THE MARKING ON RUNWAY 13-31.

BENCHMARK DATA

NO.	DESCRIPTION	NORTHING	EASTING	ELEV.
1	LACPORT NGS MONUMENT	1,585,214.690	2,512,981.969	565.44
2	LACPORT AZ MONUMENT	1,587,067.557	2,510,579.083	536.82
3	5/8" IRON PIN W/ HEI METAL CAP	1,586,449.457	2,511,380.665	549.16

NOTE

ALL CONSTRUCTION OPERATIONS ARE TO BE PERFORMED IN ACCORDANCE WITH FAA ADVISORY CIRCULAR (AC) 150/5370-2F "OPERATIONAL SAFETY ON AIRPORTS DURING CONSTRUCTION" AND AC 150/5300-13A "AIRPORT DESIGN".

ALL CONSTRUCTION EQUIPMENT ON THE AIRPORT SHALL BE MARKED, LIGHTED AND/OR FLAGGED IN ACCORDANCE WITH AC 150/5210-5 AND 70/7460-1.

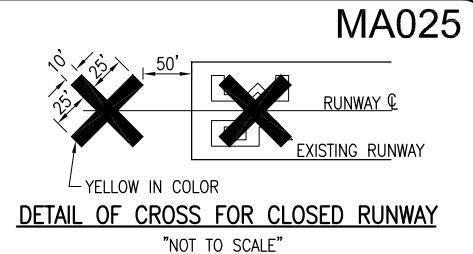

NOTE:

COST OF CONSTRUCTING, PLACING, MAINTAINING AND REMOVING CROSSES WILL BE CONSIDERED INCIDENTAL TO THE CONTRACT AND NO ADDITIONAL COMPENSATION WILL BE ALLOWED. THE CROSSES WILL BE YELLOW IN COLOR AND SHALL BE MADE OF A SUITABLE MATERIAL AS APPROVED BY THE AIRPORT MANAGER. THE CROSSES WILL BE PLACED OVER THE NUMERALS AND SECURED IN A MANNER APPROVED BY THE MANAGER. THE PROPOSED CROSSES WILL BE PLACED EACH DAY THE RUNWAY IS CLOSED AND REMOVED WHEN THE RUNWAY IS RE-OPENED. THE CONTRACTOR WILL BE RESPONSIBLE FOR THE PLACEMENT AND REMOVAL OF THE CROSSES. NO ADDITIONAL COMPENSATION WILL BE ALLOWED.

J.U.L.I.E. INFORMATION

COUNTY _____ MARSHALL
CITY _____ LACON
TOWNSHIP _____ HOPEWELL
SECTION NO. _____ 31
ADDRESS _____ MARSHALL COUNTY AIRPORT
LACON, ILLINOIS 61540

PROPOSED SAFETY PLAN

GENERAL - THE MARSHALL COUNTY AIRPORT IS COMPRISED OF TWO RUNWAYS. SEE THE SPECIAL PROVISIONS FOR THE PROPOSED STAGING PLAN AND ANTICIPATED RUNWAY CLOSURES.

IDENTIFICATION - WHEN THE CONTRACTORS VEHICLES AND EQUIPMENT ARE ON THE AIRPORT THEY SHALL BE PROPERLY MARKED WITH THREE (3) FOOT SQUARE CHECKERED FLAGS (INTERNATIONAL ORANGE AND WHITE). THE CONTRACTOR WILL ALSO PROVIDE WORKERS WITH SOME TYPE OF TAG OR GARMENT TO IDENTIFY THE PERSON AS BEING PART OF THE CONSTRUCTION CREW.

RADIO CONTROL - THE CONTRACTOR WILL BE REQUIRED TO BE IN TWO-WAY RADIO CONTACT (122.80 MHz.) WITH THE AIRPORT UNICOM. THIS WILL KEEP THE CONTRACTOR IN CONSTANT CONTACT WITH THE MARSHALL COUNTY AIRPORT AND ENABLE THE AIRPORT TO IMMEDIATELY CONTACT THE CONTRACTOR IN CASE OF AN AERONAUTIC EMERGENCY THAT WOULD REQUIRE ACTION BY THE CONTRACTOR AND/OR HIS PERSONNEL.

150-ENGINEER'S FIELD OFFICE NOTES

THE PROPOSED ENGINEER'S FIELD OFFICE WILL BE FURNISHED, MAINTAINED, AND REMOVED IN ACCORDANCE WITH ITEM AR150510 "ENGINEER'S FIELD OFFICE" AS STATED ON PAGE 49 OF THE STANDARD SPECIFICATIONS FOR CONSTRUCTION OF AIRPORTS NOV. 2, 2009.

THE LOCATION OF THE PROPOSED ENGINEER'S FIELD OFFICE WILL BE DETERMINED AT THE PRE-CONSTRUCTION MEETING.

THE ENGINEERING FIRM WILL MAKE PAYMENT FOR ALL LONG DISTANCE TELEPHONE CALLS IN EXCESS OF ONE HUNDRED DOLLARS (\$100.00) PER MONTH.

THE CONTRACTOR WILL FURNISH A WIRELESS PHONE TO THE RESIDENT ENGINEER FOR HIS EXCLUSIVE USE FOR THE DURATION OF THIS PROJECT. THE RESIDENT ENGINEER WILL USE THIS PHONE FOR PROJECT BUSINESS ONLY. THE CONTRACTOR WILL BE RESPONSIBLE FOR ALL CHARGES ASSOCIATED WITH THIS CELL PHONE.

THE PROPOSED ENGINEER'S FIELD OFFICE WILL BE PAID FOR UNDER ITEMS: AR150510 ENGINEER'S FIELD OFFICE _____ 1 L.S.

EROSION CONTROL

THIS PROJECT WILL DISTURB MORE THAN 1 ACRE OF LAND, THEREFORE A N.P.D.E.S. PERMIT WILL BE REQUIRED.

AIRCRAFT OPERATION LINE

THE CONTRACTOR WILL LOCATE THESE LINES AT THE START OF CONSTRUCTION AND WILL PLACE FLAGGED LATHE EVERY 150' ALONG THEM. THESE LINES WILL BE THE LIMITS THAT ALL CONTRACTOR PERSONNEL MAY VENTURE WHEN A RUNWAY/TAXIWAY IS NOT CLOSED. THE CONTRACTOR WILL MAINTAIN THESE LATHE LINES.

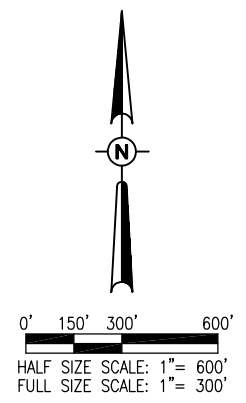
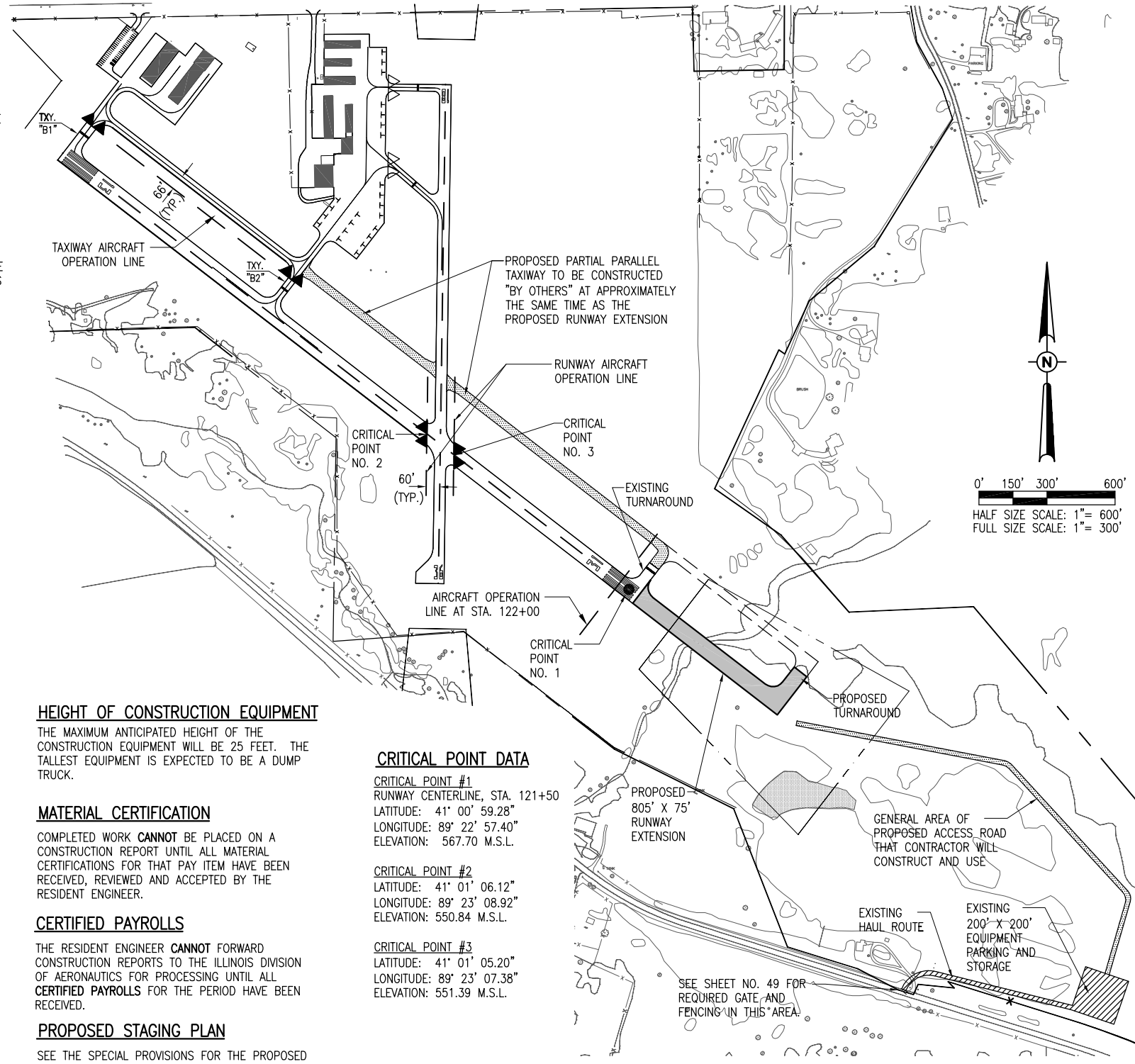

HEIGHT OF CONSTRUCTION EQUIPMENT

THE MAXIMUM ANTICIPATED HEIGHT OF THE CONSTRUCTION EQUIPMENT WILL BE 25 FEET. THE TALLEST EQUIPMENT IS EXPECTED TO BE A DUMP TRUCK.

MATERIAL CERTIFICATION

COMPLETED WORK CANNOT BE PLACED ON A CONSTRUCTION REPORT UNTIL ALL MATERIAL CERTIFICATIONS FOR THAT PAY ITEM HAVE BEEN RECEIVED, REVIEWED AND ACCEPTED BY THE RESIDENT ENGINEER.

CERTIFIED PAYROLLS

THE RESIDENT ENGINEER CANNOT FORWARD CONSTRUCTION REPORTS TO THE ILLINOIS DIVISION OF AERONAUTICS FOR PROCESSING UNTIL ALL CERTIFIED PAYROLLS FOR THE PERIOD HAVE BEEN RECEIVED.

PROPOSED STAGING PLAN

SEE THE SPECIAL PROVISIONS FOR THE PROPOSED STAGING PLAN FOR THIS PROJECT.

CRITICAL POINT DATA

CRITICAL POINT #1
RUNWAY CENTERLINE, STA. 121+50
LATITUDE: 41° 00' 59.28"
LONGITUDE: 89° 22' 57.40"
ELEVATION: 567.70 M.S.L.

CRITICAL POINT #2
LATITUDE: 41° 01' 06.12"
LONGITUDE: 89° 23' 08.92"
ELEVATION: 550.84 M.S.L.

CRITICAL POINT #3
LATITUDE: 41° 01' 05.20"
LONGITUDE: 89° 23' 07.38"
ELEVATION: 551.39 M.S.L.

JAN 10, 2013 2:27 PM KINC400394 I:\AIRPORTS\MARSHALL\10A0051\AIRPORT SHEETS\10-003SFY.DWG

REVISION		MARSHALL COUNTY AIRPORT LACON, ILLINOIS	BLOCK GRANT PROJ.: 3-17-0059-B15
DATE			
LAYOUT	BAK	07/08/10	PROPOSED SAFETY PLAN
DRAWN	BAK	07/08/10	
REVIEWED	CAH	03/30/11	
DATE	DATE	DATE	
Hanson Prof. No. 10A0051 Filename: R-003SFY.DWG Scale: 1"=300' Date: 12/14/12		 © Copyright Hanson Professional Services Inc. 2013 Hanson Professional Services Inc. 1525 South Sixth Street Springfield, Illinois 62703-2986 Ph: (217) 788-2450 Fax: (217) 788-2503 www.hanson-inc.com Offices Nationwide	
PAVE, LIGHT AND MARK 805' EXTENSION		3 3 of 75 sheets	