

PROJECT ENGINEER: SCOTT KULLERSTRAND
 SQUAD LEADER: LANCE NICKLAUS 815-284-5407

03-08-2019 LETTING ITEM 085

STATE OF ILLINOIS
DEPARTMENT OF TRANSPORTATION
DIVISION OF HIGHWAYS

PROPOSED
HIGHWAY PLANS

FAU ROUTE 5839 (US 150)
 SECTION D2 RS 2019-2
 ROCK ISLAND COUNTY
 C-92-013-19

F.A.U. RTE.	SECTION	COUNTY	TOTAL SHEETS	SHEET NO.
5839	D2 RS 2019-2	ROCK ISLAND	7	1
FED. ROAD DIST. NO. _	ILLINOIS	CONTRACT NO. 64N22		

FOR INDEX OF SHEETS, SEE SHEET NO. 2
 FOR STATE STANDARDS, SEE SHEET NO. 2

D-92-068-18

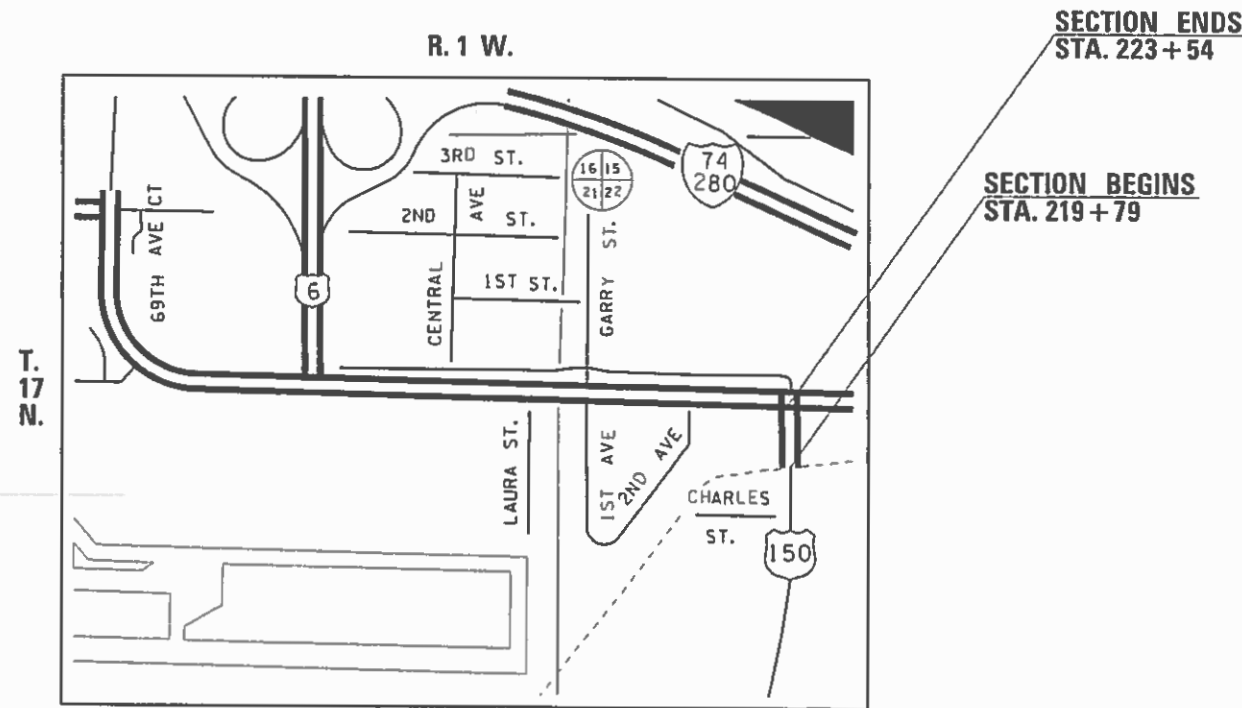

COAL VALLEY TOWNSHIP SECTION (22)

J.U.L.I.E.
 JOINT UTILITY LOCATION INFORMATION FOR EXCAVATION
 1-800-892-0123
 OR 811

GROSS LENGTH = 375 FT. = 0.071 MILE
 NET LENGTH = 375 FT. = 0.071 MILE

CONTRACT NO. 64N22

FAU ROUTE 5839 (US 150) SECTION D2 RS 2019-2 ROCK ISLAND COUNTY

STATE OF ILLINOIS
 DEPARTMENT OF TRANSPORTATION
 DIVISION OF HIGHWAYS

SUBMITTED 12-4-2018

 REGION ENGINEER
Feb 20 2019

 ENGINEER OF DESIGN AND ENVIRONMENT
Feb 20 2019

 DIRECTOR OF HIGHWAYS, PROJECT IMPLEMENTATION

PRINTED BY THE AUTHORITY
OF THE STATE OF ILLINOIS

INDEX

1	Cover Sheet
2	Index of Sheets / State Standards
3-4	Summary of Quantities
5	General Notes
6	Typicals
7	Plan Sheet

STATE STANDARDS

701006-05	OFF-ROAD OPERATIONS, 2L, 2W, 15'(4.5m) TO 24"(600mm) FROM PAVEMENT EDGE
701101-05	OFF-ROAD OPERATIONS, MULTILANE, 15'(4.5m) TO 24"(600mm) FROM PAVEMENT EDGE
701606-10	URBAN SINGLE LANE CLOSURE, MULTILANE, 2W WITH MOUNTABLE MEDIAN
701701-10	URBAN LANE CLOSURE, MULTILANE INTERSECTION
701901-08	TRAFFIC CONTROL DEVICES
720011-01	METAL POST FOR SIGNS, MARKERS AND DELINEATORS
728001-01	TELESCOPING STEEL SIGN SUPPORT
729001-01	APPLICATIONS OF TYPES A AND B METAL POST (FOR SIGNS & MARKERS)
780001-05	TYPICAL PAVEMENT MARKINGS
781001-04	TYPICAL APPLICATION RAISED REFLECTIVE PAVEMENT MARKERS

DISTRICT STANDARDS

49.2	SAFETY EDGE (3P PROJECTS)
34.1	WORK ZONE SIGN DETAILS
41.1	TYPICAL PAVEMENT MARKINGS

SUMMARY OF QUANTITIES

FAU 5839 (US 150)
SECTION D2 RS 2019-2
ROCK ISLAND COUNTY
CONTRACT # 64N22
SHEET 3 OF 7
URBAN
100% State
0005

CODE NO.	ITEM	UNIT	TOTAL QUANTITY
40600290	BITUMINOUS MATERIALS (TACK COAT)	POUND	1,628
40600627	LEVELING BINDER (MACHINE METHOD), IL-9.5FG, N50 N50	TON	134
40600990	TEMPORARY RAMP	SQ YD	192
40603335	HOT-MIX ASPHALT SURFACE COURSE, MIX "D", N50	TON	231
44000159	HOT-MIX ASPHALT SURFACE REMOVAL 2-1/2"	SQ YD	2412
67100100	MOBILIZATION	L SUM	1
70102625	TRAFFIC CONTROL AND PROTECTION, STANDARD 701606	L SUM	1
70102635	TRAFFIC CONTROL AND PROTECTION, STANDARD 701701	L SUM	1
70300100	SHORT TERM PAVEMENT MARKING	FOOT	663
70300150	SHORT TERM PAVEMENT MARKING REMOVAL	SQ FT	74

* Specialty Items

REV. 1/23/19

SUMMARY OF QUANTITIES

FAU 5839 (US 150)
SECTION D2 RS 2019-2
ROCK ISLAND COUNTY
CONTRACT # 64N22
SHEET 4 OF 7
URBAN
100% State
0005

CODE NO.	ITEM	UNIT	TOTAL QUANTITY
* 78000100	THERMOPLASTIC PAVEMENT MARKING - LETTERS AND SYMBOLS	SQ FT	162
* 78000200	THERMOPLASTIC PAVEMENT MARKING - LINE 4"	FOOT	1822
* 78000500	THERMOPLASTIC PAVEMENT MARKING - LINE 8"	FOOT	120
* 78000600	THERMOPLASTIC PAVEMENT MARKING - LINE 12"	FOOT	40
* 78000650	THERMOPLASTIC PAVEMENT MARKING - LINE 24"	FOOT	50
* 78100100	RAISED REFLECTIVE PAVEMENT MARKER	EACH	21
78300200	RAISED REFLECTIVE PAVEMENT MARKER REMOVAL	EACH	21
X8140115	HANDHOLE TO BE ADJUSTED	EACH	2
* X8860400	DETECTOR LOOP, SPECIAL	FOOT	700

* Specialty Items

GENERAL NOTES

All Borrow/Waste/Use sites must be approved by the Department prior to removing any material from the project or initiating any earthmoving activities, including temporary stockpiling outside the limits of construction.

The following Mixture Requirements are applicable for this project:

Location(s):	RESURFACING	RESURFACING	
Mixture Use(s):	SURFACE	LEVEL BINDER	
PG:	PG 64-22	PG 64-22	
Design Air Voids:	3.0 @ N50	3.0 @ N50	
Mixture Composition (Mixture Gradation):	IL 9.5	IL 9.5 FG	
Friction Aggregate:	D	N/A	
Mixture Weight:	112/LBS/SY/IN	112/LBS/SY/IN	
Quality Management Program:	QC/QA	QC/QA	
Sublot Size:			
Number of Roller Passes ¹⁾ :			

1) When a number of roller passes is specified, the Contractor may opt to use intelligent compaction in lieu of density testing under the Quality Control for Performance (QCP) program.

The Contractor shall place temporary hot-mix asphalt tapers along all sides of the utility structures protruding above the milled surface. The temporary tapers shall extend 2' outside of the castings, except for the approach side to traffic shall have a 4' taper length. Hot-mix asphalt meeting the approval of the Engineer shall be used, no cold millings will be allowed. The cost of the material, placement, maintenance, removal and disposal of said work will be included in the Pay Item for Hot-Mix Asphalt Surface Removal.

The area to be tacked or primed shall be limited to that which can be covered with HMA on the next day's production, but no more than five days in advance of the placement of the HMA, unless approved by the Engineer.

Pavement Marking shall be done according to Standard 780001, except as follows:

1. All words, such as ONLY, shall be 8 feet high.
2. All non-freeway arrows shall be the large size.
3. The distance between yellow no-passing lines shall be 8 inches, not 7 inches, as shown in the detail of Typical Lane and Edge Lines.
4. Centerline Skip Dash Pavement Marking on multi-lane divided, multi-lane undivided, and one-way roadway shall be according to District Standard 41.1.

The Contractor shall be responsible for locating and protecting utility property during construction operations as outlined in Article 107.39 of the Standard Specifications. A minimum of 48 hours advance notice is required for non-emergency work. The JULIE number is 800-892-0123. The following listed utilities located within the project limits or immediately adjacent to the project construction limits are members of JULIE:

(Type name & phone number of JULIE companies from attached utility form.)

IDOT is not a member of JULIE. If you are near any overhead lighting, intersection lighting or traffic signals, contact the IDOT Traffic Office at 815/284-5469 at least 48 hours prior to work.

It shall be the Contractor's responsibility to contact the municipality to determine approved methods of utility structure adjustment. Utility structures may include, but are not limited to, manholes, water valves, handholes, etc. All materials and work necessary to complete adjustments per municipality requirements shall be considered included in the cost of the associated adjustment pay item.

Any District Standards listed on the Index of Sheets for this contract shall be retrieved from the IDOT webpage (<http://apps.dot.illinois.gov/eplan/desenv/standards/District%202/D2DistrictStandards/>). It shall be the responsibility of both the Contractor and the RE to print any standards needed. The suffix ".1" indicates a full size standard, ".2" indicates a half size standard, and ".4" indicates a quarter size standard. Contact the District's Project Engineer for any questions.

The overlay for this section ranges from 1.1 to 3.1 inches, averaging 2.3 inches. The existing surface shall be removed to the concrete. When removing the existing surface, the concrete shall be scuffed by the milling machine to a depth of $\pm \frac{1}{4}$ ". This work shall be included in the contract unit price SQ YD for HOT-MIX ASPHALT SURFACE REMOVAL 2-1/2".

FILE NAME = 64N22GN.DOCX	USER NAME =	DESIGNED - Engineering Systems	REVISED -	STATE OF ILLINOIS DEPARTMENT OF TRANSPORTATION	GENERAL NOTES	FAB	SECTION	COUNTY	TOTAL SHEETS	SHEET NO.	
		DRAWN -	REVISED -			5839	D2 RS 2019-2	Rock Island	7	5	
	PLOT SCALE =	CHECKED -	REVISED -			CONTRACT NO.					
	PLOT DATE = 11/26/2018 11:40 AM	DATE - 11/19/2018 4:37 PM	REVISED -			SCALE:	SHEET NO.	OF	SHEETS	STA.	TO STA.

TYPICAL SECTION

US 150

HMA SHOULDER
 STA. 219+79 - 222+70
 CURB AND GUTTER
 STA. 222+70 - 223+54

STA. 219-79 - 223+54

HMA SHOULDER
 STA. 219+79 - 222+50
 CURB AND GUTTER
 STA. 222+50 - 223+54

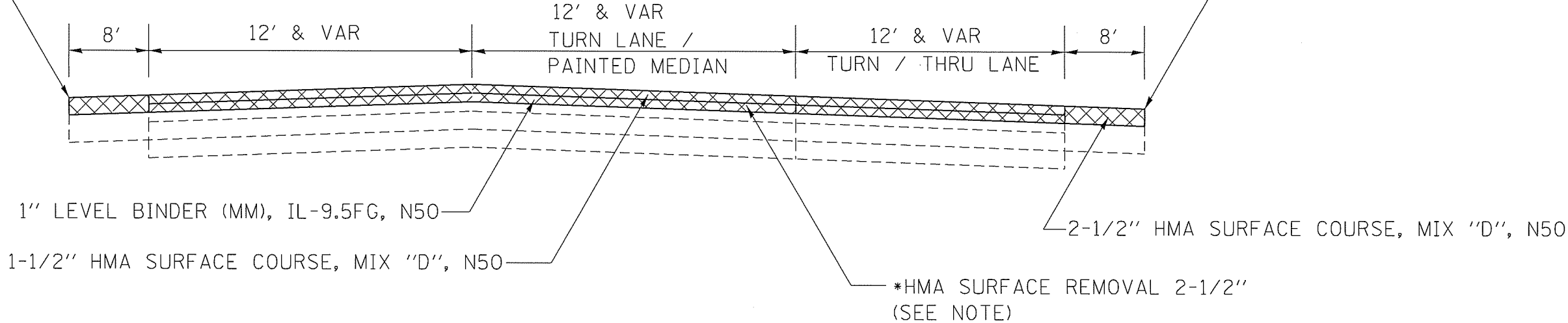

*NOTE:
 EXISTING HMA SURFACE THICKNESS
 VARIES FROM 1.1 TO 3.1 INCHES
 WITH AN AVERAGE THICKNESS OF
 2.3 INCHES. REMOVAL OR ALL HMA
 SURFACE TO CONCRETE SHALL BE
 PAID FOR AS - HMA SURFACE
 REMOVAL 2-1/2".

FILE NAME = O:\PL\Nicklaus\FY 19 jobs\Dave S\US150&US6\CADD\p03598aa.dgn	USER NAME = nicklausle	STATE OF ILLINOIS DEPARTMENT OF TRANSPORTATION	TYPICAL SECTIONS	FAU RTE.	SECTION	COUNTY	TOTAL SHEETS	SHEET NO.
				5839	D2 RS 2019-2	ROCK ISLAND	7	6
				CONTRACT NO. 64N22				
				FED. ROAD DIST. NO. _ ILLINOIS FED. AID PROJECT				
PLOT DATE = Nov-27-2018 08:37:25 AM								

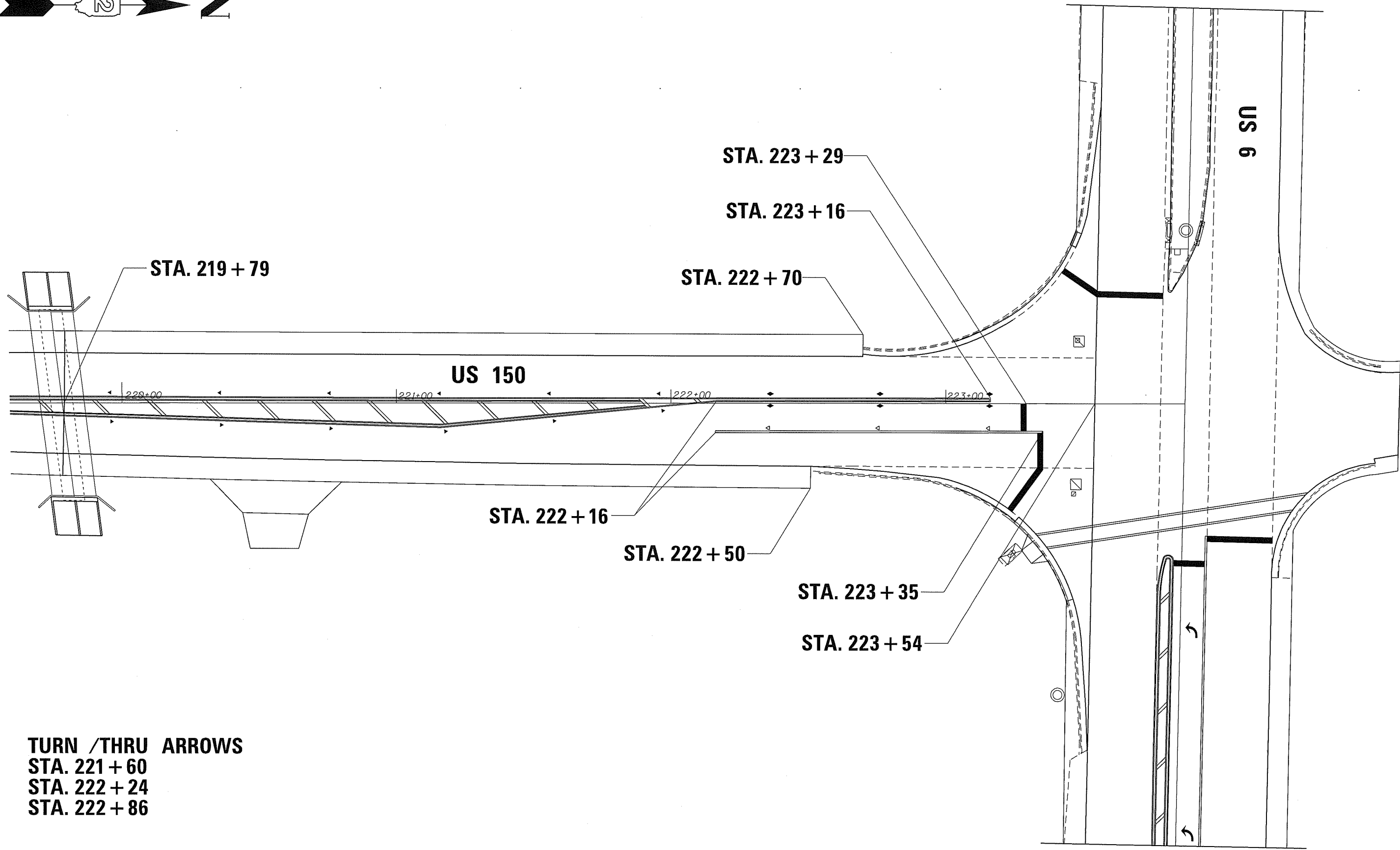

TURN /THRU ARROWS
STA. 221 + 60
STA. 222 + 24
STA. 222 + 86

MODEL: Detail
 FILE NAME: C:\P\Nicklaus\TY 19\Bibb\Draws\515150&56\CAD\DWG\3298aa.dwg

USER NAME = nick/austr	DESIGNED - _____	REVISED - _____
DRAWN - _____	REVISIONS - _____	
PLOT SCALE = 514.9802' / in.	CHECKED - _____	REVISED - _____
PLOT DATE = Nov-27-2018 08:38:59 AM	DATE - _____	REVISED - _____

**STATE OF ILLINOIS
 DEPARTMENT OF TRANSPORTATION**

SCALE: _____ SHEET _____ OF _____ SHEETS STA. _____ TO STA. _____

F.A.U. RTE.	SECTION	COUNTY	TOTAL SHEETS	SHEET NO.
5839	D2 RS 2019-2	ROCK ISLAND	7	7
CONTRACT NO. 64N22				
ILLINOIS FED. AID PROJECT				