

STATE OF ILLINOIS
DEPARTMENT OF TRANSPORTATION

SR RTE	SECTION	COUNTY	TOTAL SHEETS	SHEET NO.
86	1RS-1	JEFFERSON	6	1
		ILLINOIS	CONTRACT NO. 78A31	

FOR INDEX OF SHEETS, SEE SHEET NO. 3
FOR SUMMARY OF QUANTITIES, SEE SHEET NO. 4

PROPOSED HIGHWAY PLANS

SB ROUTE 86 (GAME FARM ROAD)
SECTION 1RS-1
SEAL COAT
JEFFERSON COUNTY

D-99-010-24

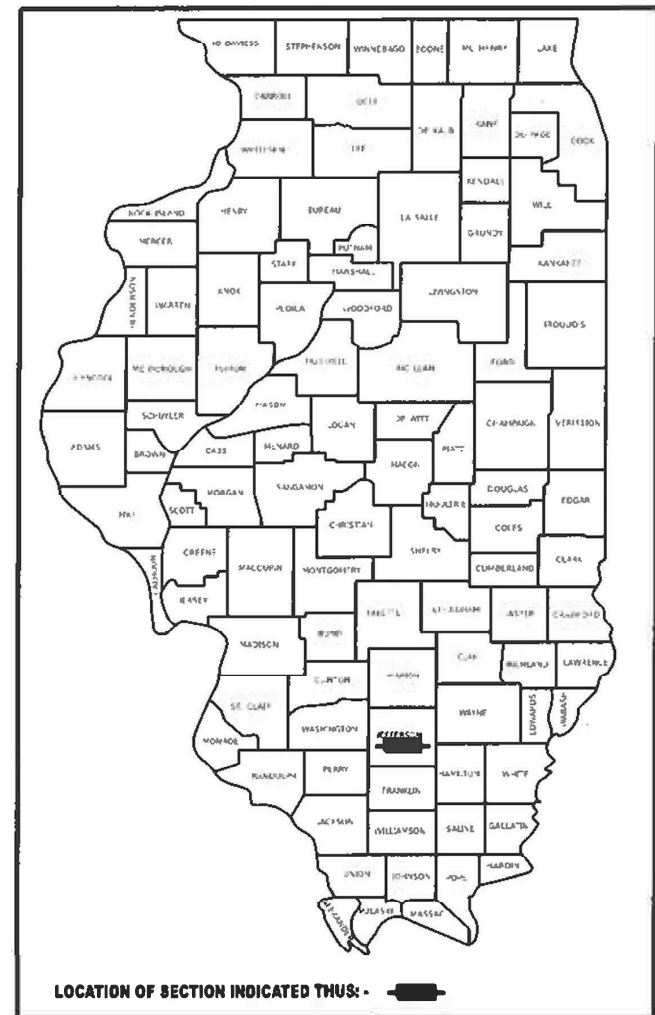

TRAFFIC DATA (2024)

ADT: 210 %TRUCKS: 11.9%

C-99-034-24

TOWNSHIPS DODDS

PROJECT BEGINS:
INTERSECTION OF IL 37

RAILROAD OMISSION

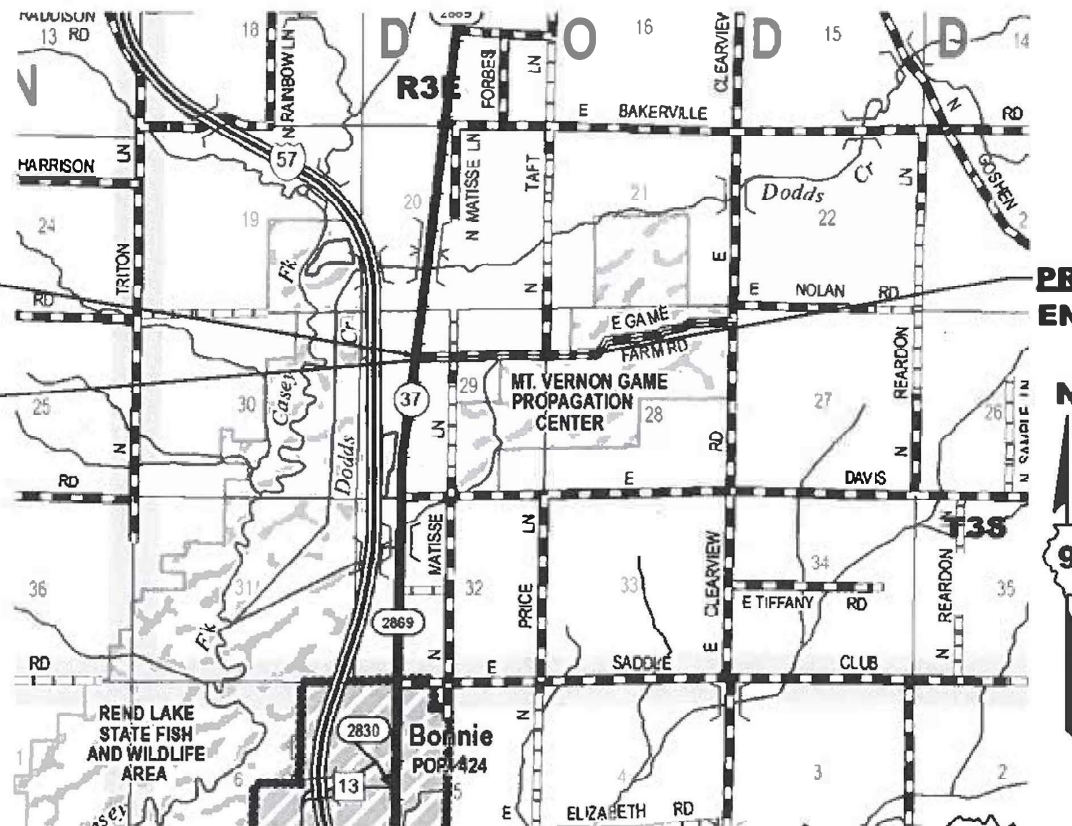

PROJECT ENDS:
ENTRANCE GATE TO THE STATE GAME FARM

J.U.L.I.E.
JOINT UTILITY LOCATION INFORMATION FOR EXCAVATION
1-800-892-0123
OR 811

PROJECT ENGINEER: SUSAN POE
PROJECT DESIGNER: JAKE STARK

GROSS LENGTH = 4,438 FT. = 0.84 MILES
NET LENGTH = 4,416 FT. = 0.84 MILES

CONTRACT NO. 78A31

STATE OF ILLINOIS
DEPARTMENT OF TRANSPORTATION

SUBMITTED Nov 27 2023
Kirk H. Brown
REGION FIVE ENGINEER

February 2, 2024 [Signature]
ENGINEER OF DESIGN AND ENVIRONMENT

February 2, 2024 [Signature]
DIRECTOR OF HIGHWAYS PROJECT IMPLEMENTATION

PRINTED BY THE AUTHORITY
OF THE STATE OF ILLINOIS

MODEL SIGNATURE SHEET (Sheet)
FILE NAME: \\sbs\pww\dot\documents\DOT Office\District Board\Project\MAJ\CD\Drawings\Attachments\078A31-288A-Cover_E.dwg

Prepared By: Charles Stein
DISTRICT STUDIES & PLANS ENGINEER

Examined By: Nancy Lee
DISTRICT LAND ACQUISITION ENGINEER

Examined By: Andrew
DISTRICT PROGRAM DEVELOPMENT ENGINEER

Examined By: [Signature]
DISTRICT OPERATIONS ENGINEER

Examined By: Douglas J. Muesel
DISTRICT PROJECT IMPLEMENTATION ENGINEER

Examined By: Douglas J. Muesel
DISTRICT CONSTRUCTION ENGINEER

Examined By: Aan Hays
DISTRICT MATERIALS ENGINEER

USER NAME	= Jacob.Stark	DESIGNED	-	REVISED	-
		DRAWN	-	REVISED	-
PLOT SCALE	= 0.18666633 / in.	CHECKED	-	REVISED	-
PLOT DATE	= 10/24/2023	DATE	-	REVISED	-

STATE OF ILLINOIS
DEPARTMENT OF TRANSPORTATION

SIGNATURE

SCALE: SHEET 2 OF 6 SHEETS STA. TO STA.

SB RTE.	SECTION	COUNTY	TOTAL SHEETS	SHEET NO.
86	1RS-1	JEFFERSON	6	2
				CONTRACT NO. 78A31
ILLINOIS FED. AID PROJECT				

INDEX OF SHEETS

SHEET NO	DESCRIPTION
1	COVER SHEET
2	SIGNATURE SHEET
3	INDEX OF SHEETS, GENERAL NOTES, STANDARDS
4	SUMMARY OF QUANTITIES
5	TYPICAL
6	SCHEDULES

HIGHWAY STANDARDS

000001-08_STANDARDSYMBOLSABBREVIATIONS-PATTERNS-001
 001006_DECIMALOFINCH-FOOT
 701306-04_ENCLOSURE2L2W-SLOWMOVEOPDAYONLY45MPHORMORE
 701001-09_TRAFCNTRLDEVICES
 780001-05_TYPICALPVMTRKINGS

GENERAL NOTES

FACTORS USED FOR ESTIMATING PLAN QUANTITIES ARE AS FOLLOWS AND SHALL NOT BE USED FOR THE BASIS OF FINAL QUANTITIES:

ALL AGGREGATE 2.05 TONS/CU. YD.

COMMITMENTS: NONE

REV. - MS

MODEL: INDEX OF SHEETS GENERAL NOTES (Sheet)
 FILE NAME: P:\GIS\Projects\78A31\CD\Drawings\DOT\Office\Printed\808D\Project\78A31\CD\Drawings\DOT\Office\Printed\808D\Project\78A31-Ship Index_GenNotes.dgn

USER NAME = Jacob.Stark	DESIGNED -	REVISED -
	DRAWN -	REVISED -
PLOT SCALE = 0.16666633 / in.	CHECKED -	REVISED -
PLOT DATE = 10/24/2023	DATE -	REVISED -

STATE OF ILLINOIS
 DEPARTMENT OF TRANSPORTATION

INDEX OF SHEETS, GENERAL NOTES, STANDARDS

SCALE: SHEET 3 OF 6 SHEETS STA. TO STA.

SB RTE.	SECTION	COUNTY	TOTAL SHEETS	SHEET NO.
86	1RS-1	JEFFERSON	6	3
CONTRACT NO. 78A31				
ILLINOIS FED. AID PROJECT				

SUMMARY OF QUANTITIES

COUNTY:	JEFFERSON CO
ROUTE:	SB 86
FUNDING:	100% STATE
LOCATION:	RURAL
TOTAL QUANTITY	ROADWAY 0005

CODE NUMBER	ITEM DESCRIPTION	UNIT	TOTAL QUANTITY	
67100100	MOBILIZATION	L SUM	1	1
70100460	TRAFFIC CONTROL AND PROTECTION, STANDARD 701306	L SUM	1	1
70107025	CHANGEABLE MESSAGE SIGN	CAL DA	28	28
* 78001100	PAINT PAVEMENT MARKING - LETTERS AND SYMBOLS	SQ FT	122	122
* 78001180	PAINT PAVEMENT MARKING - LINE 24"	FOOT	48	48
X1500006	BITUMINOUS SURFACE TREATMENT, A3	SQ YD	7,988	7,988
Z0048665	RAILROAD PROTECTIVE LIABILITY INSURANCE	L SUM	1	1

* SPECIALTY ITEM

MODEL: SCHEDULE OF QUANTITIES (Sheet)
FILE NAME: P:\GIS\Projects\DOT\Documents\DOT Office\Dist19\ORD Project\78A31\CADData\CAD\Sheet\DOT78A31-SHQ-500.dgn

USER NAME = Jacob.Stark PLOT SCALE = 0.16666633' / in. PLOT DATE = 10/24/2023	DESIGNED - DRAWN - CHECKED - DATE -	REVISED - REVISED - REVISED - REVISED -	STATE OF ILLINOIS DEPARTMENT OF TRANSPORTATION	SCHEDULE OF QUANTITIES	SB RTE. 86 SECTION 1RS-1 COUNTY JEFFERSON TOTAL SHEETS 6 SHEET NO. 4	CONTRACT NO. 78A31 ILLINOIS FED. AID PROJECT
			SCALE:	SHEET 4 OF 6 SHEETS	STA. TO STA.	

GAME FARM ROAD
(SB 86)

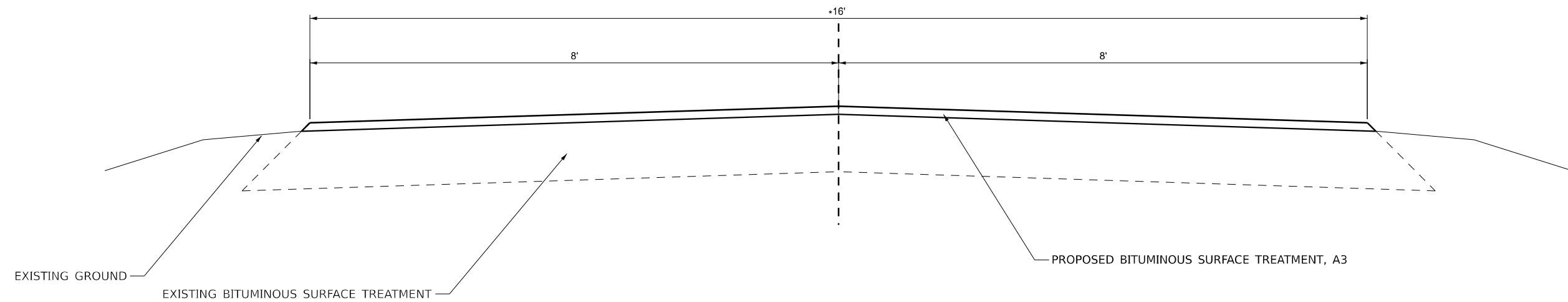

TO BE USED:

*STA. 0+12 TO STA. 0+78 (VARIABLE WIDTH)
 STA. 0+78 TO STA. 0+90 (RAILROAD OMISSION)
 STA. 0+90 TO STA. 44+50

MODEL: TYPICAL (Sheet)
 FILE NAME: P:\GIS\Projects\DOT\Office\District 9\ORD Project\78A31\CADData\CAD\Sheet\DOT78A31-SR05-Typicals.dwg

USER NAME = Jacob.Stark	DESIGNED -	REVISED -
	DRAWN -	REVISED -
PLOT SCALE = 0.16666633' / in.	CHECKED -	REVISED -
PLOT DATE = 10/24/2023	DATE -	REVISED -

STATE OF ILLINOIS
DEPARTMENT OF TRANSPORTATION

TYPICAL

SCALE: SHEET 5 OF 6 SHEETS STA. TO STA.

SB RTE.	SECTION	COUNTY	TOTAL SHEETS	SHEET NO.
86	1RS-1	JEFFERSON	6	5
CONTRACT NO. 78A31				
ILLINOIS FED. AID PROJECT				

RESURFACING SCHEDULE

LOCATION STATION TO STATION	LENGTH	PAVEMENT WIDTH	PAVEMENT AREA	BITUMINOUS SURFACE TREATMENT, A3	REMARKS
	(FEET)	(FEET)	(SQ FT)	(SQ YD)	
GAME FARM RD (SB 86)					
0+12 TO 0+78	66	VARIABLE	2,135	237	
0+78 TO 0+90 GAP RAILROAD TRACKS					
0+90 TO 44+50	4,360	16	69,760	7,751	STOP AT GATE
TOTAL	4,426			7,988	

PAVEMENT MARKING SCHEDULE

LOCATION STATION TO STATION	PAINT PAVEMENT MARKING		
	LINE 24"	LETTERS AND SYMBOLS	REMARKS
	(FEET)	(SQ FT)	
GAME FARM RD (SB 86)			
EB 0+60	16	61	RAILROAD
WB 04+40	16	61	RAILROAD- ADJACENT TO RR SIGN
WB 01+05	8		STOP BAR RAILROAD
WB 0+42	8		STOP BAR
TOTAL	48	122	

MODEL: SCHEDULES (Sheet)
 FILE NAME: P:\GIS\Projects\DOT\Office\District 9\ORIG Project\78A31\CADData\CAD\Drawings\DOT78A31-SHE-Schedules.dwg

USER NAME = Jacob.Stark PLOT SCALE = 0.16666633' / in. PLOT DATE = 10/24/2023	DESIGNED - DRAWN - CHECKED - DATE -	REVISED - REVISED - REVISED - REVISED -	STATE OF ILLINOIS DEPARTMENT OF TRANSPORTATION	SCHEDULES	SB RTE. 86 SECTION 1RS-1 COUNTY JEFFERSON TOTAL SHEETS 6 SHEET NO. 6 CONTRACT NO. 78A31	SCALE: SHEET 6 OF 6 SHEETS STA. TO STA. ILLINOIS FED. AID PROJECT
---	--	--	---	------------------	--	--