

STATE OF ILLINOIS  
DEPARTMENT OF TRANSPORTATION

S.B.I. RTE	SECTION	COUNTY	TOTAL SHEETS	SHEET NO.
* SBI 11/FAS 781	34Q	BOND	5	1
		ILLINOIS	CONTRACT NO. 76T23	

FOR INDEX OF SHEETS, SEE SHEET NO. 2

# PROPOSED HIGHWAY PLANS

SBI 11/FAS ROUTE 781 (STATE STREET)  
SECTION 34Q  
PROJECT STP-92NI(041)  
SMART RESURFACING  
BOND COUNTY

C-98-091-23

R4W

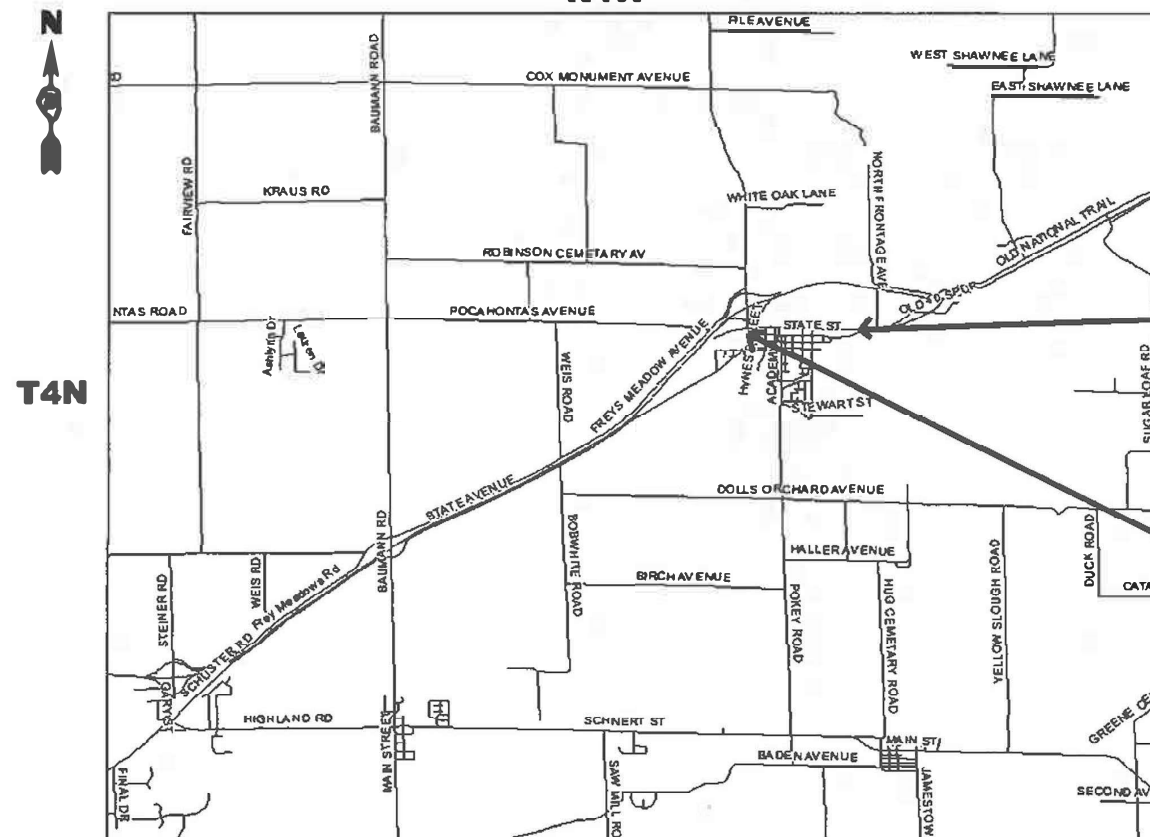

END PROJECT  
US 40  
LAT: 38.828672  
LONG: -89.528573

BEGIN PROJECT  
O'FALLON ST  
LAT: 38.828266  
LONG: -89.545380



LOCATION OF SECTION INDICATED THUS: - [shaded rectangle symbol]

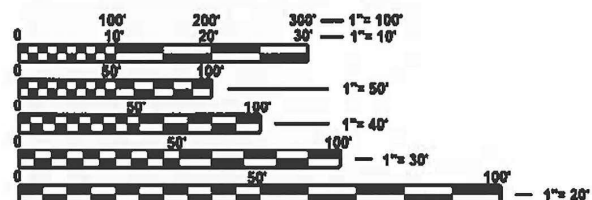

FULL SIZE PLANS HAVE BEEN PREPARED USING STANDARD ENGINEERING SCALES. REDUCED SIZED PLANS WILL NOT CONFORM TO STANDARD SCALES. IN MAKING MEASUREMENTS ON REDUCED PLANS, THE ABOVE SCALES MAY BE USED.

J.U.L.I.E.  
JOINT UTILITY LOCATION INFORMATION FOR EXCAVATION  
1-800-892-0123  
OR 811

PROJECT ENGINEER: CHERYL KEPLAR  
PROJECT MANAGER: CHERYL KEPLAR

CONTRACT NO. 76T23

GROSS LENGTH = 4963.2 FT. = 0.94 MILE  
NET LENGTH = 4963.2 FT. = 0.94 MILE  
MAP NOT TO SCALE

STATE OF ILLINOIS  
DEPARTMENT OF TRANSPORTATION

SUBMITTED December 19, 2023  
Kirk B. Brown  
REGIONAL ENGINEER

February 2, 2024  
[Signature]  
ENGINEER OF DESIGN AND ENVIRONMENT

February 2, 2024  
[Signature]  
DIRECTOR OF HIGHWAYS PROJECT IMPLEMENTATION

PRINTED BY THE AUTHORITY  
OF THE STATE OF ILLINOIS

**INDEX OF SHEETS**

1. COVER SHEET
2. INDEX OF SHEETS, HIGHWAY STANDARDS, GENERAL NOTES, ADT, AND COMMITMENTS
3. SUMMARY OF QUANTITIES
4. TYPICAL SECTIONS
5. SCHEDULE OF QUANTITIES

**GENERAL NOTES**

1. THE FOLLOWING UTILITIES KNOW TO HAVE FACILITIES WITHIN THE PROJECT AREA ARE AS FOLLOWS:  
 ALHAMBRA-GRANTFORK TELEPHONE CO.  
 AMEREN ILLINOIS  
 CLEARWAVE FIBER LLC  
 DEPARTMENT OF CENTRAL MANAGEMENT SERVICES  
 FRONTIER COMMUNICATIONS  
 PLAINES MARKETING, LP  
 VILLAGE OF POCAHONTAS  
 ZAYO GROUP LLC
2. THE RESIDENT ENGINEER SHALL VERIFY THE EXISTENCE OF HIGHWAY LIGHTING AND/OR INTELLIGENT TRANSPORTATIONS SYSTEMS (I.T.S.) UTILITIES WITHIN THE PROJECT LIMITS. IF HIGHWAY LIGHTING AND/OR I.T.S. EXISTS WITHIN THE PROJECT LIMITS, AND IF THESE ITEMS REQUIRE LOCATING, THE CONTRACTOR SHALL BE DIRECTED TO DO SO ACCORDING TO SECTION 803 OF THE STANDARD SPECIFICATIONS. THIS WORK SHALL BE PAID FOR ACCORDING TO ARTICLE 109.04 OF THE STANDARD SPECIFICATIONS.
3. NO SURVEY WAS PERFORMED FOR THIS PROJECT AND THE PLANS WERE CREATED USING MICROFILM AND FIELD MEASUREMENTS
4. ALL TURF AREAS DISTURBED BY THE CONTRACTOR SHALL BE SEEDED WITH THE APPROPRIATE EROSION CONTROL AS DIRECTED BY THE ENGINEER, AT THE CONTRACTOR'S EXPENSE.
5. THE DEPARTMENT STRONGLY ENCOURAGES THE PRIME CONTRACTOR AND THEIR APPROVED SUB-CONTRACTORS TO HIRE MINORITY, WOMEN, AND DISADVANTAGED INDIVIDUALS FROM ITS FEDERALLY FUNDED HIGHWAY CONSTRUCTION CAREERS TRAINING PROGRAM (HCCTP) TO HELP MEET WORKFORCE AND TRAINEE GOALS. THIS PROGRAM IS TRAINING MINORITIES, WOMEN AND DISADVNTAGED INDIVIDUALS IN HIGHWAY CONSTRUCTION-RELATED SKILLS, E.G., MATH FOR THE TRADES, JOB READINESS, TECHNICAL SKILLS COURSEWORK (CARPENTRY, CONCRETE FLATWORK, BLUEPRINT READING, SITE PLANS, SITE WORK, TOOLS USE, ETC.) AND OSHA 10 HOUR CERTIFICATION, TO PREPARE THEM FOR A CAREER IN THE HIGHWAY CONSTRUCTION TRADES. GRADUATES ARE WELL-TRAINED AND READY TO BECOME PRODUCTIVE ENTRY-LEVEL CONSTRUCTION WORKERS. CONTACT THE DISTRICT 8 EEO OFFICE AT 618-346-3360 AND/OR THE HCCTP COORDINATOR AT 618-874-6528 TO LEARN MORE ABOUT THE PROGRAM AND FOR ASSISTANCE IN MEETING WORKFORCE AND TRAINEE GOALS.

**HIGHWAY STANDARDS**

- |           |   |
|-----------|---|
| 000001-08 | STANDARD SYMBOLS ABBREVIATIONS & PATTERNS                                 |
| 001006    | DECIMAL OF INCH & FOOT  |
| 701301-04 | LANE CLOSURE 2 LANE 2 WAY SHORT TIME OPERATIONS                           |
| 701306-04 | LANE CLOSURE, 2L, 2W, SLOW MOVING OPERATIONS DAY ONLY, FOR SPEEDS> 45 MPH |
| 701311-03 | LANE CLOSURE, 2L, 2W, MOVING OPERATIONS - DAY ONLY                        |
| 701501-06 | URBAN LANE CLOSURE, 2L, 2W, UNDIVIDED                                     |
| 701901-09 | TRAFFIC CONTROL DEVICES   |
| 780001-05 | TYPICAL PAVEMENT MARKINGS   |
| 781001-04 | TYPICAL APPLICATION RAISED REFLECTIVE PAVEMENT MARKERS                    |

**ADT**

FROM O'FALLON ST. TO US 40 IN POCAHONTAS  
 2020 ADT = 1600 (ACTUAL)  
 2024 ADT = 1600 (ESTIMATED)  
 2044 ADT = 1800 (ESTIMATED)  
 SU = 2.0%      MU = 0.8%

**MIXTURE COMPOSITION**

DESCRIPTION	SMART OVERLAY
MIXTURE USE	SURFACE
AC/PG	PG 64-22
DESIGN AIR VOIDS	4.0% @ Ndes=70
MIX COMPOSITION (Gradation)	IL 9.5
FRICITON AGG	MIXTURE "C"
QUALITY MGMT PROGRAM	QC/QA
MatTranDev Required?	NO

PLAN QUANTITIES FOR HOT-MIX ASPHALT ITEMS ARE CALCULATED USING A UNIT WEIGHT OF 112 LB/SQ YD/IN

**COMMITMENTS**

NO COMMITMENTS

MODEL: C:\Users\jgreen\OneDrive\Documents\DOT Office\District 8\ORD Projects\7623\CADD\Drawings\7623-24-0000.dgn  
 FILE NAME: P:\Users\jgreen\OneDrive\Documents\DOT Office\District 8\ORD Projects\7623\CADD\Drawings\7623-24-0000.dgn

USER NAME = John.P.Green	DESIGNED -	REVISED -	<b>STATE OF ILLINOIS DEPARTMENT OF TRANSPORTATION</b>	<b>INDEX OF SHEETS, HIGHWAY STANDARDS GENERAL NOTES, ADT, AND COMMITMENTS</b>	S.B.I. RTE.	SECTION	COUNTY	TOTAL SHEETS	SHEET NO.
PLOT SCALE = 0.16666633' / in.	DRAWN -	REVISED -			*	34Q	BOND	5	2
PLOT DATE = 1/26/2024	CHECKED -	REVISED -			* SBI 11/FAS 781	CONTRACT NO. 76T23			
	DATE -	REVISED -			ILLINOIS FED. AID PROJECT				
					SCALE:	SHEET	OF	SHEETS	STA. TO STA.

80% FED  
20% STATE

CODE NO.	ITEM	UNIT	TOTAL QUANTITY	CONSTR. CODE
				ROADWAY 0005 RURAL
40600290	BITUMINOUS MATERIALS (TACK COAT)	POUND	3971	3971
40600370	LONGITUDINAL JOINT SEALANT	FOOT	4963	4963
40600990	TEMPORARY RAMP	SQ YD	60	60
40604052	HOT-MIX ASPHALT SURFACE COURSE, IL-9.5, MIX "C", N70	TON	927	927
44000155	HOT-MIX ASPHALT SURFACE REMOVAL, 1 1/2"	SQ YD	11029	11029
67100100	MOBILIZATION	L SUM	1	1
70100460	TRAFFIC CONTROL AND PROTECTION, STANDARD 701306	L SUM	1	1
70102620	TRAFFIC CONTROL AND PROTECTION, STANDARD 701501	L SUM	1	1
70300100	SHORT TERM PAVEMENT MARKING	FOOT	451	451
70300150	SHORT TERM PAVEMENT MARKING REMOVAL	SQ FT	150	150
70300221	TEMPORARY PAVEMENT MARKING - LINE 4"- PAINT	FOOT	13942	13942
* 78001120	PAINT PAVEMENT MARKING - LINE 5"	FOOT	13942	13942
78300202	PAVEMENT MARKING REMOVAL - WATER BLASTING	SQ FT	4647	4647
X7810400	TEMPORARY RAISED PAVEMENT MARKER	EACH	62	62

\* SPECIALTY ITEM

MODEL: soq final (Sheet)  
FILE NAME: c:\new\work\pav\pav\john.p.green\illinois.gov\0896745\08161723-ah-SOQ.dgn

REV. - MS

STATE OF ILLINOIS  
DEPARTMENT OF TRANSPORTATION

SUMMARY OF QUANTITY

USER NAME - John.P.Green	DESIGNED -	REVISED -	SCALE	SHEET	OF	SHEETS	STA.	TO STA.	S.B.I. RTE.	SECTION	COUNTY	TOTAL SHEETS	SHEET NO.
DRAWN -	CHECKED -	REVISED -							*	34Q	BOND	5	3
PLOT SCALE = 0.10000000 1/in	DATE -	REVISED -							* SBI 11/FAS 781		CONTRACT NO. 76T23		
PLOT DATE = 12/19/2023	DATE -	REVISED -							ILLINOIS FED AID PROJECT				

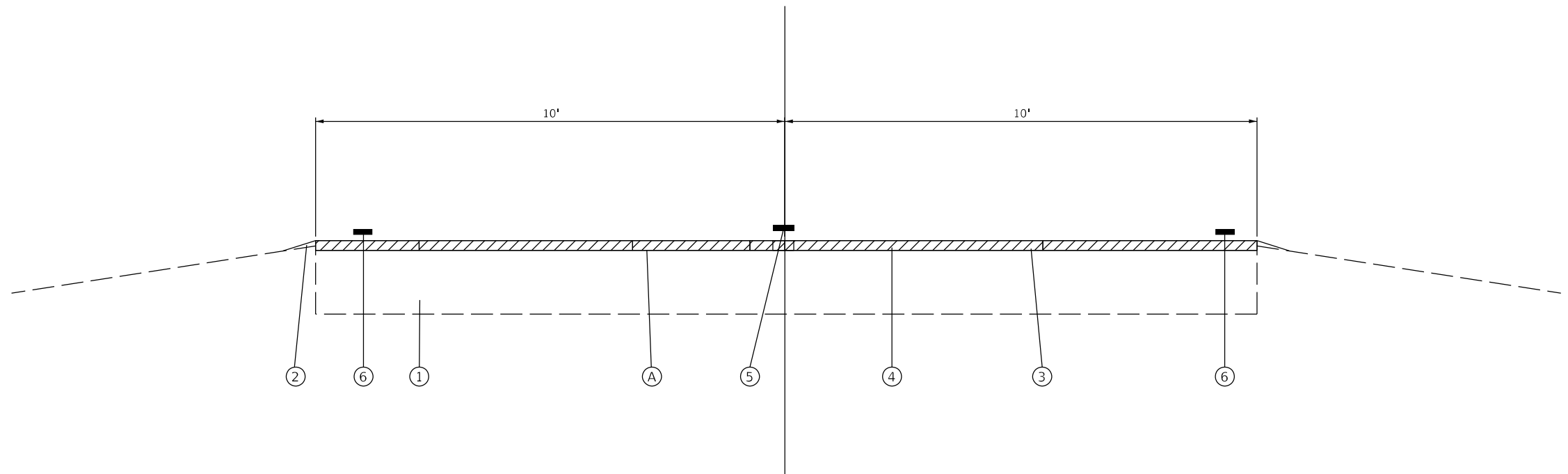

**TYPICAL SECTION**  
MS 0.00 to MS 0.94

**LEGEND**

- ① EXISTING PAVEMENT
- ② PROPOSED AGGREGATE WEDGE
- ③ PROPOSED BITUMINOUS MATERIALS, TACK COAT
- ④ PROPOSED HMA SURFACE COURSE, IL-9.5, MIX "C", N70, 1½"
- ⑤ PROPOSED LONGITUDINAL JOINT SEALANT
- ⑥ PROPOSED PAVEMENT MARKING
- Ⓐ PROPOSED HOT-MIX ASPHALT SURFACE REMOVAL, 1½"

MODEL: Typical Sheet Correct Final [Sheet]  
FILE NAME: c:\p\work\wis\john\_d.green@illinois.gov\45086745\0876723-shh-typical.dgn

USER NAME = John.P.Green	DESIGNED -	REVISED -
	DRAWN -	REVISED -
PLOT SCALE = 0.16666633' / in.	CHECKED -	REVISED -
PLOT DATE = 1/26/2024	DATE -	REVISED -

**STATE OF ILLINOIS**  
**DEPARTMENT OF TRANSPORTATION**

**TYPICAL SECTIONS**

SCALE: SHEET OF SHEETS STA. TO STA.

S.B.I. RTE.	SECTION	COUNTY	TOTAL SHEETS	SHEET NO.
*	34Q	BOND	5	4
* SBI 11/FAS 781			CONTRACT NO. 76T23	
ILLINOIS FED. AID PROJECT				

### PAVEMENT MARKING SCHEDULE

LOCATION	PAINT PAVEMENT MARKING - LINE 5"					SHORT TERM PAVEMENT MARKING (FT)	SHORT TERM PAVEMENT MARKING REMOVAL (SQ FT)	TEMPORARY RAISED PAVEMENT MARKERS EACH	TEMPORARY PAVEMENT MARKING - LINE 4" - PAINT (FT)	PAVEMENT MARKING REMOVAL - WATER BLASTING (SQ FT)
	SKIP-DASH YELLOW	SOLID YELLOW (FT)		SOLID WHITE	DOUBLE YELLOW LINE					
	(FT)	NO PASSING ZONE		(FT)	(FT)					
	CENTERLINE	WB	EB	EDGELINES	MEDIAN					
MP 0.00 TO 0.02	26			211		10	3	1	238	79
MP 0.02 TO 0.04				211	215	10	3	1	426	142
MP 0.04 TO 0.13	119	475		950		43	14	6	1544	515
MP 0.13 TO 0.18	66			528		24	8	3	594	198
MP 0.18 TO 0.31	172		686	1373		62	21	9	2230	743
MP 0.31 TO 0.41	132	528		1056		48	16	7	1716	572
MP 0.41 TO 0.45	53			422		19	6	3	475	158
MP 0.45 TO 0.54	119		475	950		43	14	6	1544	515
MP 0.54 TO 0.62	106	422		845		38	13	5	1372	457
MP 0.62 TO 0.94	422			3379		154	51	21	3802	1267
<b>SUB-TOTAL</b>	1,214	1,425	1,161	9,926	215					
<b>TOTAL</b>	<b>13,942</b>					<b>451</b>	<b>150</b>	<b>62</b>	<b>13942</b>	<b>4647</b>

### RESURFACING SCHEDULE

LOCATION	WIDTH (FT)	BITUMINOUS MATERIALS, TACK COAT (LBS)	HMA SURFACE COURSE, IL-9.5, MIX "C", N70, 1.5" (TON)	HMA SURFACE REMOVAL, 1.5" (SQ YD)	LONGITUDINAL JOINT SEALANT (FT)
MP 0.00 TO 0.59	20	2492	582	6923	3115
MP 0.59 TO 0.94	20	1478	345	4107	1848
<b>TOTAL</b>		<b>3971</b>	<b>927</b>	<b>11029</b>	<b>4963</b>

MODEL: I:\unfiled (Sheet)  
 FILE NAME: c:\pwwork\john.p.green@illinois.gov\0886745\0876123-shs-schedule.dgn

USER NAME = John.P.Green	DESIGNED -	REVISED -
	DRAWN -	REVISED -
PLOT SCALE = 0.16666633' / in.	CHECKED -	REVISED -
PLOT DATE = 1/26/2024	DATE -	REVISED -

**STATE OF ILLINOIS  
DEPARTMENT OF TRANSPORTATION**

SCHEDULE OF QUANTITIES

SCALE: SHEET OF SHEETS STA. TO STA.

S.B.I. RTE.	SECTION	COUNTY	TOTAL SHEETS	SHEET NO.
*	34Q	BOND	5	5
* SBI 11/FAS 781		CONTRACT NO. 76T23		
ILLINOIS		FED. AID PROJECT		