

STATE OF ILLINOIS
DEPARTMENT OF TRANSPORTATION

FAS RTE.	SECTION	COUNTY	TOTAL SHEETS	SHEET NO.
1909	D9 CRACK SEAL 2018-2	UNION	5	1
ILLINOIS		CONTRACT NO. 78629		

FOR INDEX OF SHEETS, SEE SHEET NO. 3
FOR SUMMARY OF QUANTITIES, SEE SHEET NO. 4

**PROPOSED
HIGHWAY PLANS**

FAS 1909 (IL 127)
SECTION D9 CRACK SEAL 2018-2

**CENTERLINE CRACK SEALING
UNION COUNTY**

**TRAFFIC DATA
SEE PAGE 3**

**TOWNSHIPS
JONESBORO, POMONA**

DESIGN DESIGNATION : NA
COORDINATE SYSTEM : ILLINOIS EAST
POSTED SPEED : 55 MPH

J.U.L.I.E.
JOINT UTILITY LOCATION INFORMATION FOR EXCAVATION
1-800-892-0123
OR 811

PROJECT ENGINEER CHARLES STEIN 618-351-5210
PROJECT DESIGNER AESHA JACKSON 618-351-5215

CONTRACT NO. 78629

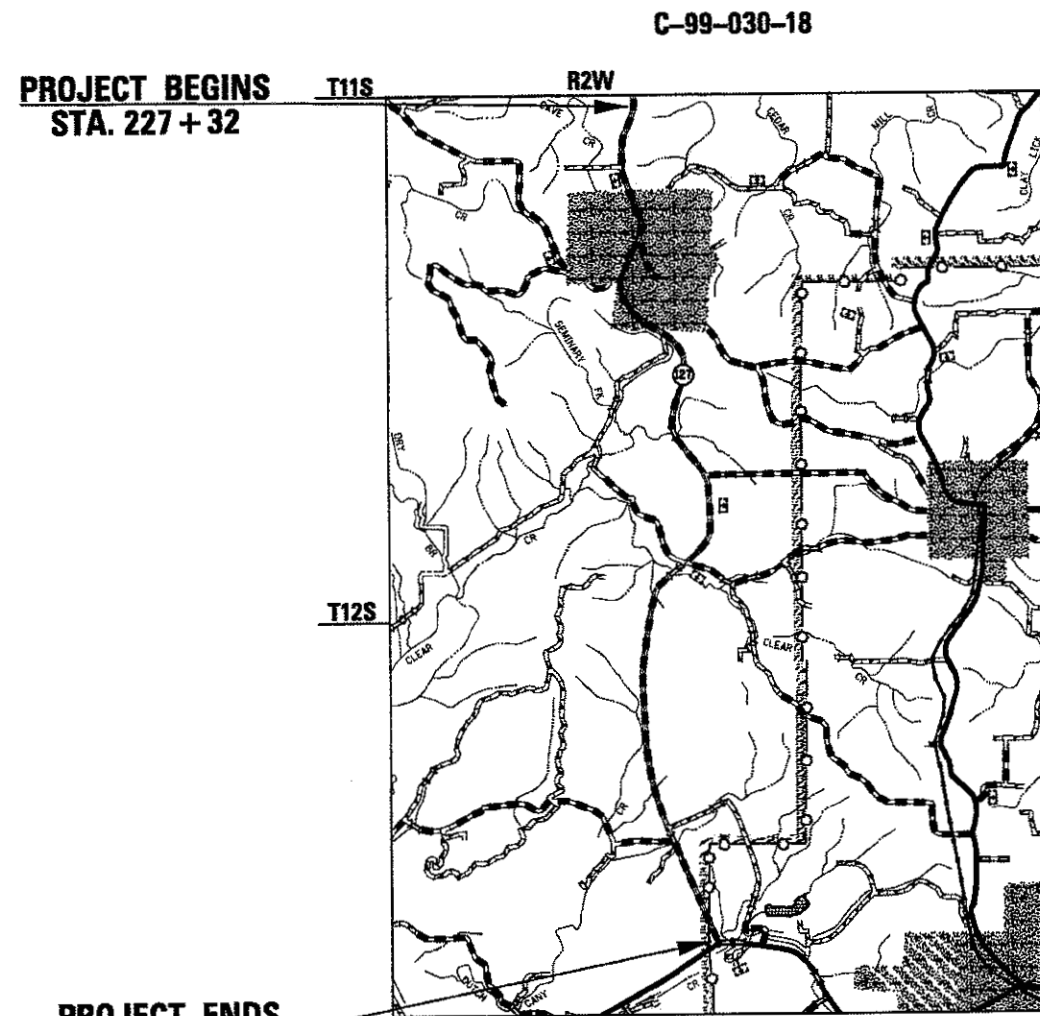

GROSS LENGTH = 54,043 FT. = 10.235 MILES
OMISSION = 1,000 FT. = 0.189 MILES
NET LENGTH = 53,043 FT. = 10.046 MILES

D-99-030-18

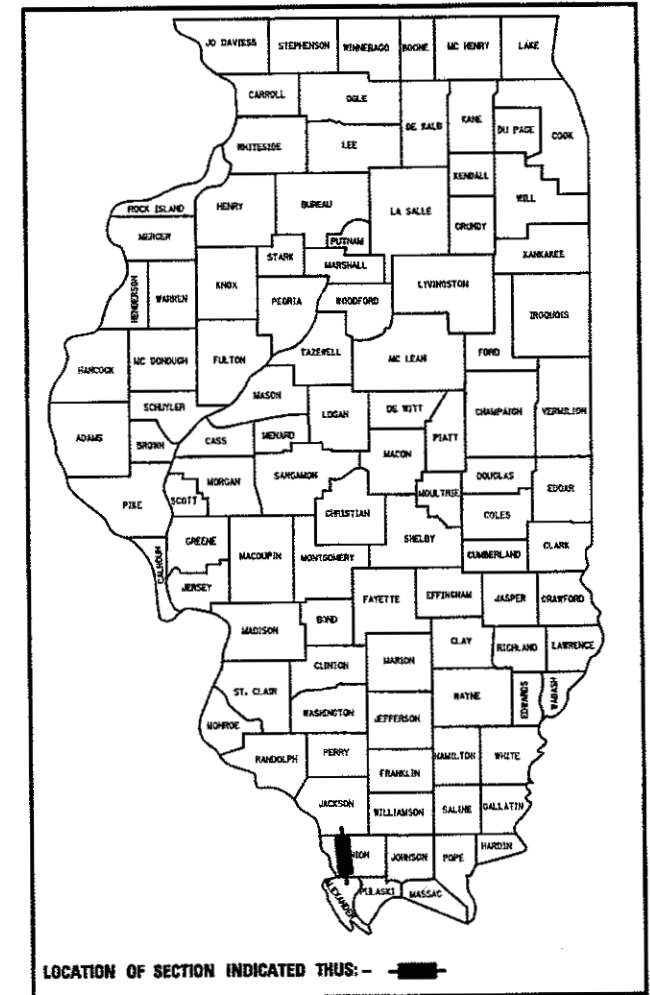

STATE OF ILLINOIS
DEPARTMENT OF TRANSPORTATION

SUBMITTED Dec 19 2017
Jeffrey L Keen
REGION FIVE ENGINEER
Feb 2 2018
[Signature]
ENGINEER OF DESIGN AND ENVIRONMENT
Feb 2 2018
[Signature]
DIRECTOR OF PROGRAM DEVELOPMENT

**PRINTED BY THE AUTHORITY
OF THE STATE OF ILLINOIS**

MODEL: Default
 FILE: \\nas101.psw.usllb\BEBID\NTEC\Illinois.gov\PW\DOT\Documents\DOT_Offices\District 9\Projects\78629\CADD\Data\CAD\Sheet\78629-Sheets.dgn

Prepared By: _____
 DISTRICT STUDIES & PLANS ENGINEER

Examined By: _____
 DISTRICT LAND ACQUISITION ENGINEER

Examined By: _____
 DISTRICT PROGRAM DEVELOPMENT ENGINEER

Examined By: _____
 DISTRICT OPERATIONS ENGINEER

Examined By: _____
 DISTRICT PROJECT IMPLEMENTATION ENGINEER

Examined By: _____
 DISTRICT CONSTRUCTION ENGINEER

Examined By: _____
 DISTRICT MATERIALS ENGINEER

USER NAME = jacksonac	DESIGNED -	REVISED -
	DRAWN -	REVISED -
PLOT SCALE = 100.0000 ' / in.	CHECKED -	REVISED -
PLOT DATE = 12/20/2017	DATE -	REVISED -

**STATE OF ILLINOIS
 DEPARTMENT OF TRANSPORTATION**

SIGNATURE SHEET

SCALE: SHEET OF SHEETS STA. TO STA.

F.A.S. RTE.	SECTION	COUNTY	TOTAL SHEETS	SHEET NO.
1909	D9 CRACK SEAL 2018-2	UNION	5	2
			CONTRACT NO. 78629	
		ILLINOIS	FED. AID PROJECT	

INDEX OF SHEETS

SHEET NO.	DESCRIPTION
1	COVER SHEET
2	SIGNATURE SHEET
3	INDEX OF SHEETS, GENERAL NOTES, STANDARDS, OMISSION, COMMITMENTS, STATION EQUATION, TRAFFIC DATA
4	SUMMARY OF QUANTITIES
5	SCHEDULE OF QUANTITIES

GENERAL NOTES

FACTORS USED FOR QUANTITY CALCULATIONS ARE AS FOLLOWS:
 JOINT SEALER.....1.25 LB/FT

THE QUANTITY USED FOR CRACK FILLING IS AN ESTIMATE. THE ACTUAL AMOUNT USED WILL BE DETERMINED BY THE ENGINEER.

STANDARDS

- 701311-03 LANE CLOSURE 2L, 2W-MOVING OPERATIONS DAY ONLY
- 701901-07 TRAFFIC CONTROL DEVICES

STATION EQUATIONS

- STA. EQ. 273+52.60 (BK) = STA. 274+02.70 (AH)
- STA. EQ. 305+30.70 (BK) = STA. 305+50.00 (AH)
- STA. EQ. 376+60.50 (BK) = STA. 372+96.50 (AH)
- STA. EQ. 528+28.10 (BK) = STA. 529+02.60 (AH)
- STA. EQ. 533+40.60 (BK) = STA. 530+37.90 (AH)
- STA. EQ. 619+26.10 (BK) = STA. 619+23.80 (AH)
- STA. EQ. 685+22.20 (BK) = STA. 685+44.70 (AH)

TRAFFIC DATA

IL 37 (FAS 1909)		LOC B:
M.P.	(0.0-8.50)	(8.50-10.09)
(2018)		
PV =	1,450	1,580
SU =	60	50
MU =	40	20
ADT =	1,550	1,650
(2038)		
PV =	1,765	1,920
SU =	75	65
MU =	50	25
ADT =	1,890	2,010

OMISSIONS

SN 091-0068 (STA. 536+00 TO STA. 546+00)

COMMITMENTS

NONE

MODEL: Default
 FILE NAME: P:\IL0848\BND\NTEG_IL\inois.gov\PWD\DOT\Documents\13\DOT_Offices\13\13\Projects\78629\CADD\data\CAD\Sheets\78629-Sheets.dgn

USER NAME = jac ksr ac	DESIGNED -	REVISED -	STATE OF ILLINOIS DEPARTMENT OF TRANSPORTATION	INDEX OF SHEETS, GENERAL NOTES, STANDARDS, OMISSION COMMITMENTS, STATION EQUATION, TRAFFIC DATA	F.A.S. R.B.	SECTION	COUNTY	TOTAL SHEETS	SHEET NO.
PLOT SCALE = 100.0000' / in.	DRAWN -	REVISED -			1909	D9 CRACK SEAL 2018-2	UNION	5	3
PLOT DATE = 12/20/2017	CHECKED -	REVISED -			CONTRACT NO. 78629				
	DATE -	REVISED -			SCALE:		SHEET	OF	SHEETS
					IL IN06		FED. AID PROJECT		

SUMMARY OF QUANTITIES

COUNTY:	Union County (181)
ROUTE:	FAS 1909 IL 127
FUNDING:	100% STATE
LOCATION:	RURAL
TOTAL QUANTITY	ROADWAY 0005

CODE NUMBER	ITEM DESCRIPTION	UNIT	TOTAL QUANTITY	ROADWAY 0005
45100100	CRACK ROUTING (PAVEMENT)	FOOT	53,043	53,043
45100200	CRACK FILLING	POUND	66,306	66,306
67100100	MOBILIZATION	LSUM	1	1

3

MODEL: Default FILE: I:\GIS\PROJECTS\1909\1909001\Documents\SUMMARY OF QUANTITIES.DWG OFFICE: District 9 PROJECT: 1909 IL 127 COUNTY: Union County SHEET: 4 OF 5

USER NAME = jackobac PLOT SCALE = 100 0000 ' / in. PLOT DATE = 12/20/2017	DESIGNED - DRAWN - CHECKED - DATE -	REVISED - REVISED - REVISED - REVISED -	STATE OF ILLINOIS DEPARTMENT OF TRANSPORTATION	SUMMARY OF QUANTITIES SCALE: SHEET OF SHEETS STA. TO STA.	F.A.S. RTE. 1909 SECTION D9 CRACK SEAL 2018-2 COUNTY UNION TOTAL SHEETS 5 SHEET NO. 4 CONTRACT NO. 78629 ILLINOIS FED. AID PROJECT
---	--	--	---	---	--

SCHEDULE OF QUANTITIES

					CENTER OF ROADWAY LONGITUDINAL CRACKS ONLY	
LOCATION FAS 1909 (IL 127)	STA.	TO	STA.	LENGTH	CRACK ROUTING	CRACK FILLING
UNION CO.				(FT)	(FT)	(POUND)
FAS 1909 (IL 127)	227+32.	TO	273+52.6	4,621	4,621	5,777
FAS 1909 (IL 127)	273+52.60 BK	=	274+02.70 AH	STA. EQ.		
FAS 1909 (IL 127)	274+02.7	TO	305+30.7	3,128	3,128	3,910
FAS 1909 (IL 127)	305+30.70 BK	=	305+50.0 AH	STA. EQ.		
FAS 1909 (IL 127)	305+50.	TO	376+60.5	7,111	7,111	8,889
FAS 1909 (IL 127)	376+60.50 BK	=	372+96.50 AH	STA. EQ.		
FAS 1909 (IL 127)	372+96.5	TO	528+28.1	15,532	15,532	19,415
FAS 1909 (IL 127)	528+28.10 BK	=	529+02.60 AH	STA. EQ.		
FAS 1909 (IL 127)	529+02.6	TO	533+40.6	438	438	548
FAS 1909 (IL 127)	533+40.60 BK	=	530+37.90 AH	STA. EQ.		
FAS 1909 (IL 127)	530+37.9	TO	536+00.	562	563	704
SN 091-0068	536+00.	TO	546+00.	OMIT		
FAS 1909 (IL 127)	546+00.	TO	619+26.1	7326.1	7,327	9,159
FAS 1909 (IL 127)	619+26.10 BK	=	619+23.80 AH	STA. EQ.		
FAS 1909 (IL 127)	619+23.8	TO	685+22.2	6598	6,599	8,249
FAS 1909 (IL 127)	685+22.20 BK	=	685+44.70 AH	STA. EQ.		
FAS 1909 (IL 127)	685+44.7	TO	762+68.	7,723	7,724	9,655
TOTAL					53,043	66,306

MODEL: Default
 FILE: \\nas01c.psu.edu\B&E\BID\NTEC\Illinois\gov\PI\DOT\Documents\DOT_Offices\Director\Projects\78629\CADD\Drawings\CAD\Drawings\78629-Sheets.dgn

	USER NAME = jacksonac	DESIGNED -	REVISED -	STATE OF ILLINOIS DEPARTMENT OF TRANSPORTATION	SCHEDULE OF QUANTITIES			F.A.S. RTE.	SECTION	COUNTY	TOTAL SHEETS	SHEET NO.
		DRAWN -	REVISED -									
	PLOT SCALE = 100,0000 ' / in.	CHECKED -	REVISED -									
	PLOT DATE = 12/20/2017	DATE -	REVISED -			SCALE:	SHEET	OF	SHEETS	STA.	TO	STA.
											ILLINOIS	FED. AID PROJECT

1909	D9 CRACK SEAL 2018-2	UNION	5	5
CONTRACT NO. 78629				