

*REF-topo33
*REF-topo34

CONTRACT NO. 60A09

F.A.I. RTE.	SECTION	COUNTY	TOTAL SHEETS	SHEET NO.
I-57	2005-038 I	WILL	58	25
STA. 578+00		TO STA. 608+00		
FED. ROAD DIST. NO.	ILLINOIS	FED. AID PROJECT		

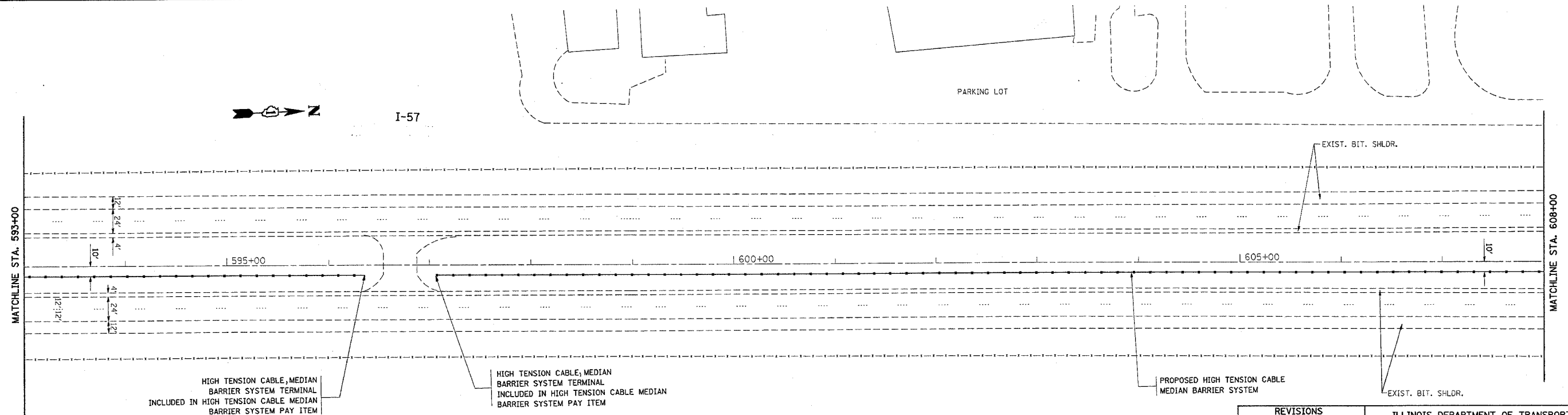
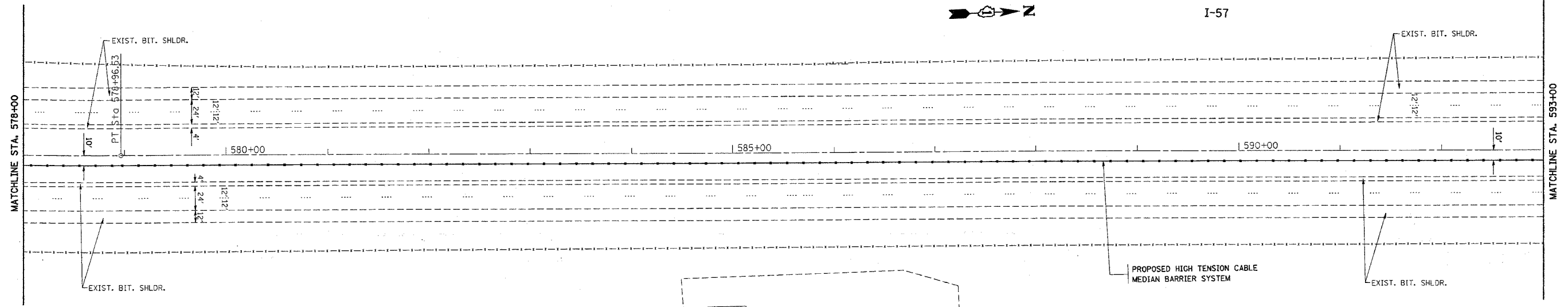

PLOT DATE = 1/4/2006
 FILE NAME = c:\p\proj\60a\127005\ah_rdg_ab.dgn
 USER NAME = ltrankr

REVISIONS	
NAME	DATE

ILLINOIS DEPARTMENT OF TRANSPORTATION

**I-57 (I80 TO COUNTY LINE RD.)
PROPOSED PLAN**

SCALE: VERT. 1"=50'
HORIZ. DATE 1/4/2006

DRAWN BY
CHECKED BY