

REF-topo35  
REF-topo36

CONTRACT NO. 60A09

F.A.I. RTE.	SECTION	COUNTY	TOTAL SHEETS	SHEET NO.
I-57	2005-038 I	WILL	58	38
STA. 938+00		TO STA. 968+00		
FED. ROAD DIST. NO.		ILLINOIS FED. AID PROJECT		

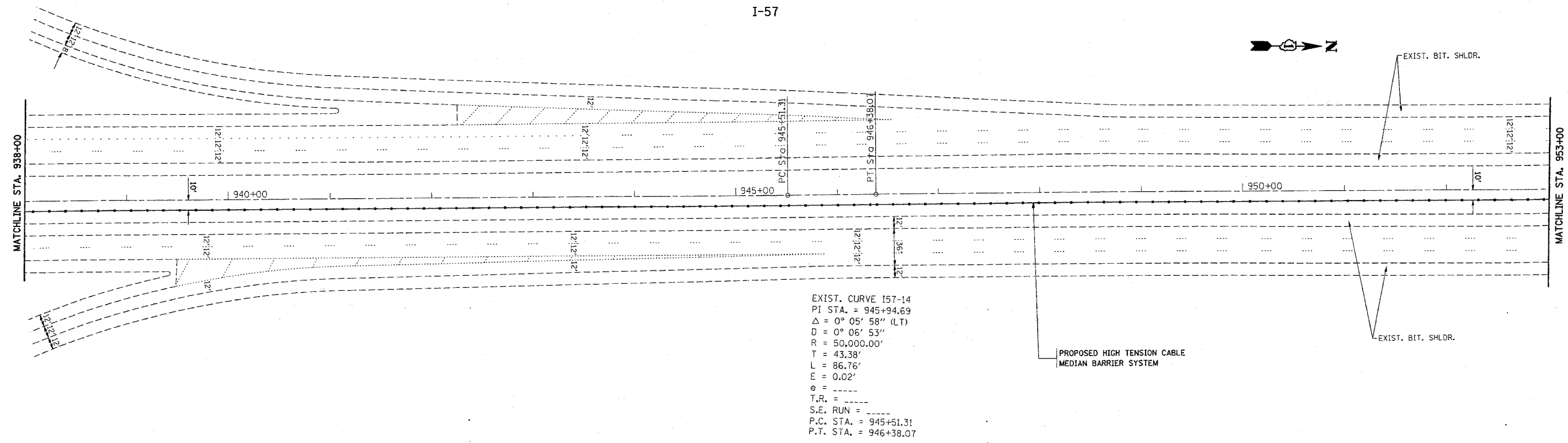

EXIST. CURVE I57-14  
 PI STA. = 945+94.69  
 $\Delta = 0^\circ 05' 58''$  (LT)  
 $D = 0^\circ 06' 53''$   
 $R = 50,000.00'$   
 $T = 43.38'$   
 $L = 86.76'$   
 $E = 0.02'$   
 $e =$   
 $T.R. =$   
 $S.E. RUN =$   
 $P.C. STA. = 945+51.31$   
 $P.T. STA. = 946+38.07$

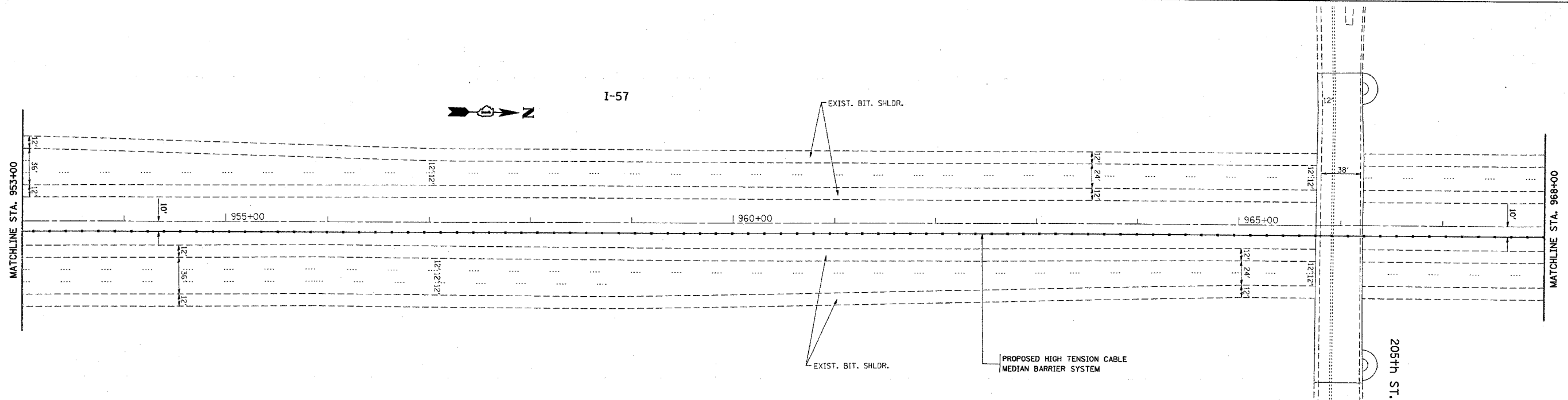

REVISIONS	
NAME	DATE

ILLINOIS DEPARTMENT OF TRANSPORTATION  
**I-57 (I80 TO COUNTY LINE RD.)  
 PROPOSED PLAN**  
 SCALE: VERT. 1"=50'  
 HORIZ. 1"=50'  
 DATE 1/4/2006  
 DRAWN BY  
 CHECKED BY

PLOT DATE = 1/4/2006  
 FILE NAME = c:\pcc\projects\127886\sh\_rdy\_ab.dgn  
 PLOT SCALE = 1/4"=50' / IN.  
 USER NAME = janzhof