

\*REF-top61  
\*REF-top62

CONTRACT NO. 60A09

F.A.I. RTE.	SECTION	COUNTY	TOTAL SHEETS	SHEET NO.
I-57	2005-038 I	WILL	58	40
STA. 998+00		TO STA. 1028+00		
FED. ROAD DIST. NO.		ILLINOIS		FED. AID PROJECT

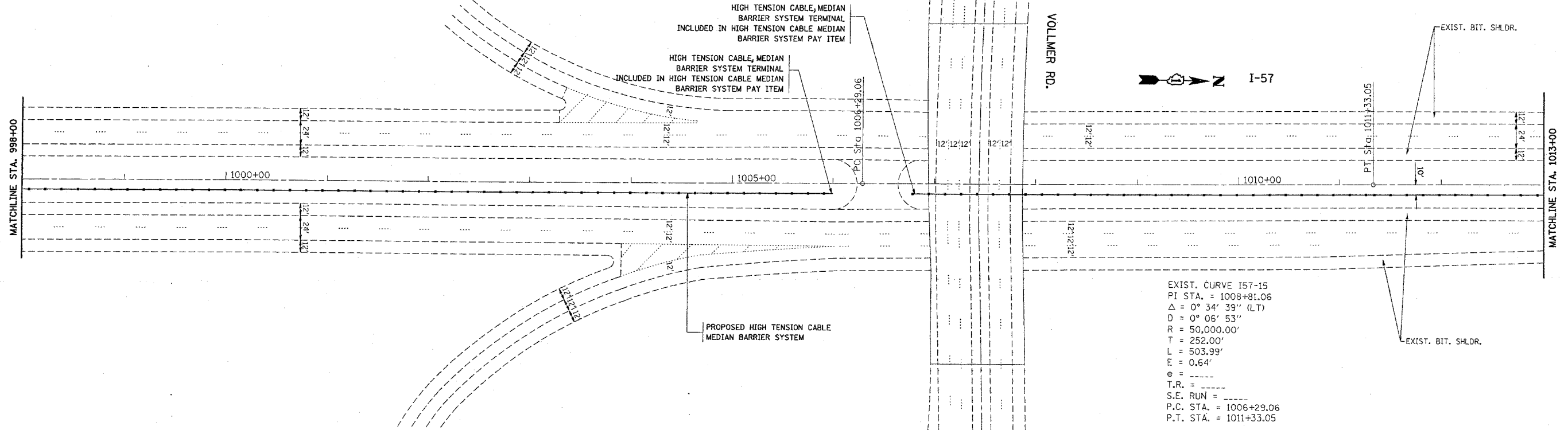

EXIST. CURVE I57-15  
 PI STA. = 1008+81.06  
 $\Delta = 0^\circ 34' 39''$  (LT)  
 $D = 0^\circ 06' 53''$   
 $R = 50,000.00'$   
 $T = 252.00'$   
 $L = 503.99'$   
 $E = 0.64'$   
 $e =$   
 $T.R. =$   
 $S.E. RUN =$   
 P.C. STA. = 1006+29.06  
 P.T. STA. = 1011+33.05

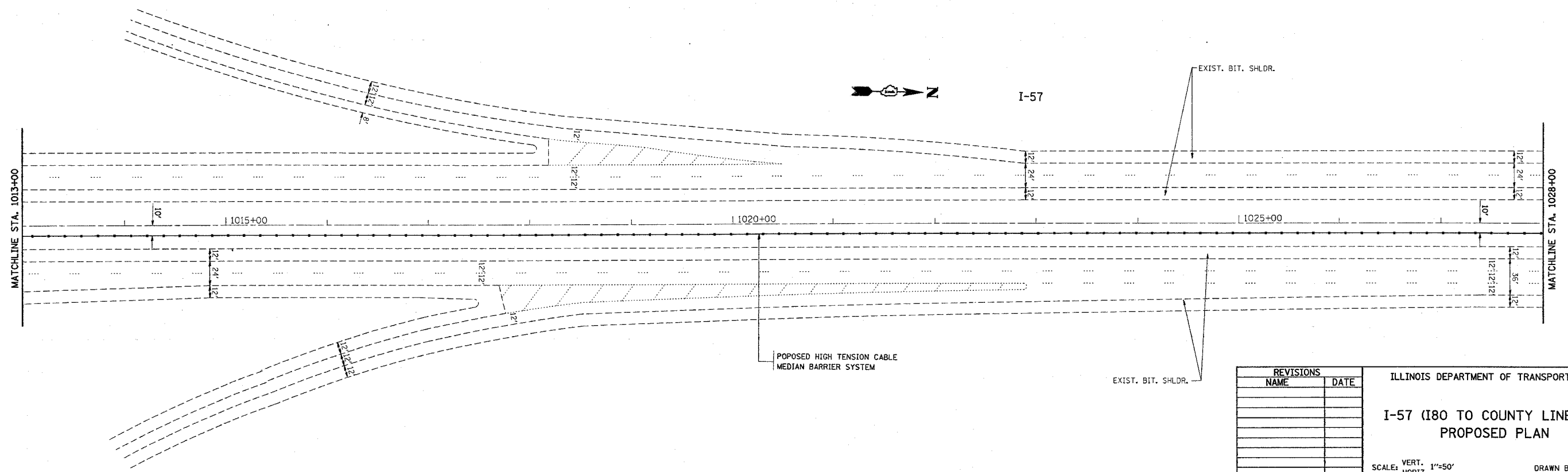

REVISIONS	
NAME	DATE

ILLINOIS DEPARTMENT OF TRANSPORTATION  
 I-57 (I80 TO COUNTY LINE RD.)  
 PROPOSED PLAN  
 SCALE: VERT. 1"=50'  
 HORIZ. 1"=50'  
 DATE 1/4/2006  
 DRAWN BY  
 CHECKED BY

PLT DATE = 1/4/2006  
 PLOT SCALE = 50.0000 / IN.  
 USER NAME = jhsakhrf