

|                       |           |                  |              |           |
|-----------------------|-----------|------------------|--------------|-----------|
| F.A.I. NO.            | SECTION   | COUNTY           | TOTAL SHEETS | SHEET NO. |
| 94                    | 2005-0115 | COOK             | 40           | 37        |
| STA.                  | TO STA.   |                  |              |           |
| FED. ROAD DIST. NO. 1 | BLDG.     | FED. AID PROJECT |              |           |

62929

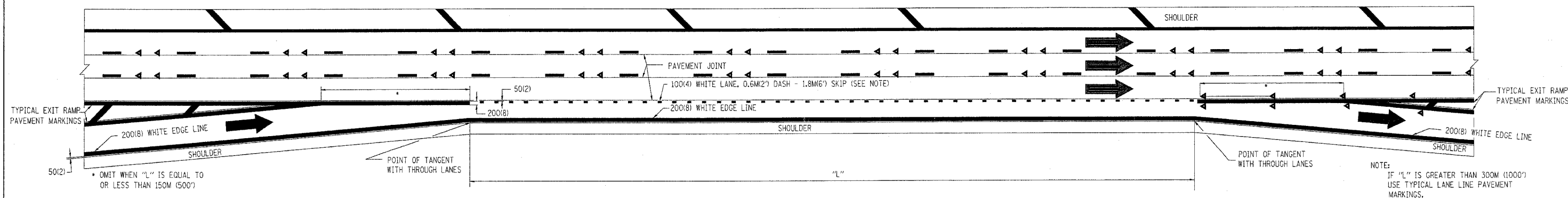

**TYPICAL ENTRANCE/EXIT RAMP COMBINATION PAVEMENT MARKINGS**

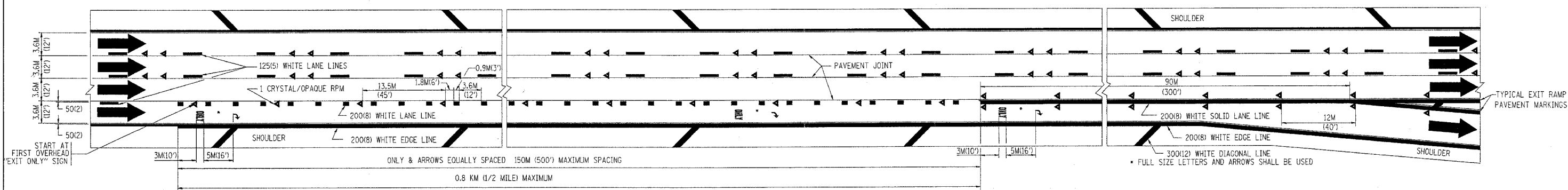

**TYPICAL EXIT ONLY LANE PAVEMENT MARKINGS**

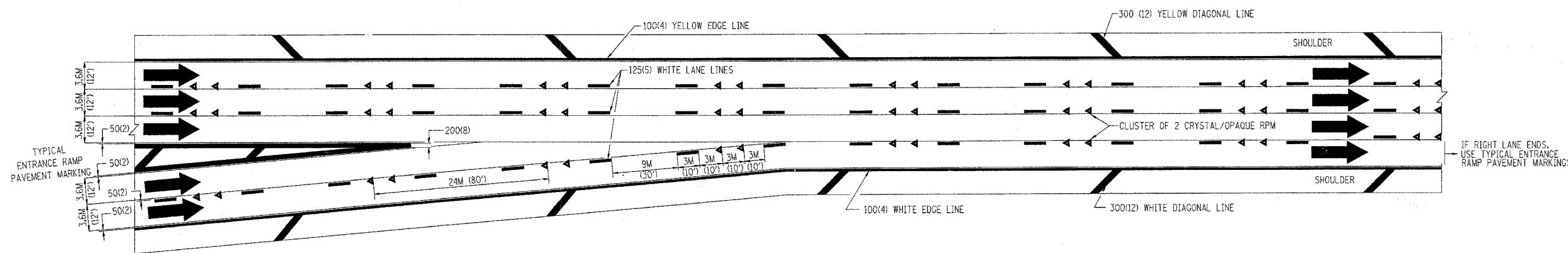

**TYPICAL TWO LANE ENTRANCE RAMP PAVEMENT MARKINGS**

| REVISIONS |      |
|-----------|------|
| NAME      | DATE |
| DWS       | 1/90 |
| DWS       | 5/91 |
|           |      |
|           |      |
|           |      |
|           |      |

ILLINOIS DEPARTMENT OF TRANSPORTATION

**MULTI-LANE FREEWAY PAVEMENT MARKING DETAILS**

SCALE: NONE  
DATE: 5/31/2005

DRAWN BY C.A.D.D.  
CHECKED BY  
TC12 SHEET 2 OF 2  
REVISION DATE: 01/01/96

5/31/2005  
wdlstrd\val2.dgn  
VI-T-C12  
galbann