

F.A.P. RTE.	SECTION	COUNTY	TOTAL SHEETS	SHEET NO.
642	11BR-8	JODAVIESS	45	1

(10BR-3)D

STATE OF ILLINOIS  
DEPARTMENT OF TRANSPORTATION  
DIVISION OF HIGHWAYS  
**PROPOSED  
HIGHWAY PLANS**

FAP ROUTE 642 (IL 78)  
SECTION (10BR-3)D & 11BR-8  
PROJECT  
JODAVIESS COUNTY  
C-92-045-06

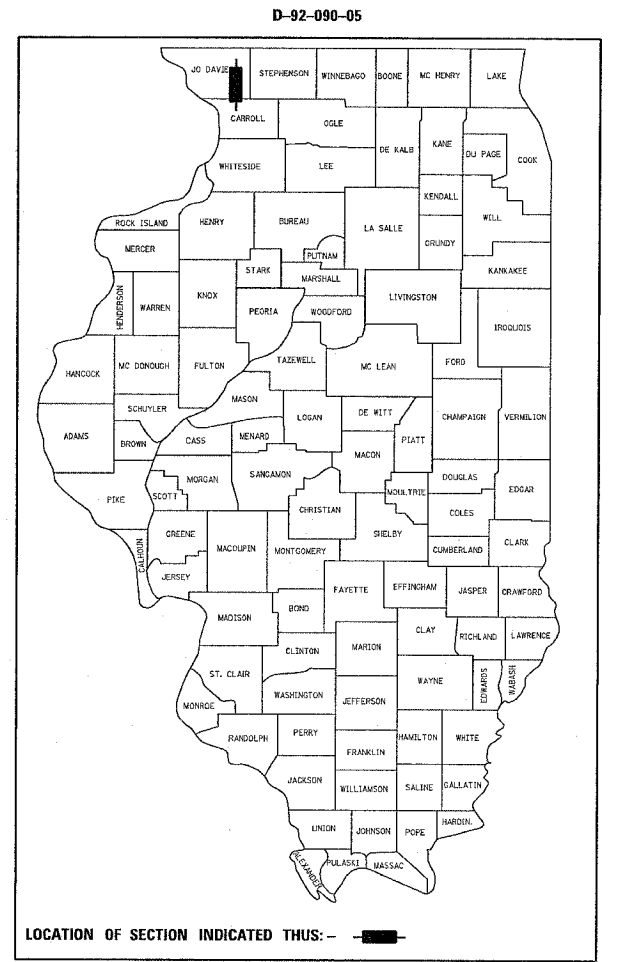

PLANS ENGINEER  
ROBERT WAGNER

SQUAD LEADER  
MIKE YUSEF  
(815) 284-5343

PROJECT ENGINEER  
THOMAS HALLA  
PHONE: (815) 284-5993

INDEX OF SHEETS

- 1 COVER SHEET
- 2-3 SUMMARY OF QUANTITIES
- 4 GENERAL NOTES
- 5-6 TYPICAL SECTIONS
- 7 BUTT-JOINT DETAILS
- 8-9 SCHEDULE OF QUANTITIES
- 10-11 HORIZONTAL & VERTICAL CONTROL
- 12-13 ROADWAY PLAN SHEETS
- 14-17 STAGING DETAILS
- 18 EROSION CONTROL DETAIL
- 19-27 BRIDGE PLAN AND DETAILS FOR PLUM RIVER (SN # 043-0040)
- 28-39 BRIDGE PLAN AND DETAILS FOR DAVIS CREEK (SN # 043-0042)
- 40 DELINEATOR AND POST (37.4)
- 40 WITNESS MARKER FOR PERMANENT SURVEY MARKERS TYPE 2 (38.4)
- 40 INFORMATIONAL WARNING SIGN (FOR NARROW TRAVEL LANES) 39.4
- 40 STOP LINE FOR TEMPORARY SIGNAL (99.4)
- 41-42 TYPICAL PAVEMENT MARKINGS (41.1)
- 43-45 CROSS SECTIONS

STATE STANDARDS

- 001001 AREAS OF REINFORCEMENT REBARS
- 001006 DECIMAL OF AN INCH AND A FOOT
- 280001-02 TEMPORARY EROSION CONTROL SYSTEMS
- 420001-06 PAVEMENT JOINTS
- 515001-02 NAME PLATE FOR BRIDGES
- 542401 END SECTION, METAL, FOR PIPE CULVERT
- 630001-05 STEEL PLATE BEAM GUARDRAIL
- 630301-03 SHOULDER WIDENING FOR TYPE 1 (SPECIAL) GUARDRAIL TERMINALS
- 631032-01 TRAFFIC BARRIER TERMINAL, TYPE 6A
- 635001 DELINEATORS
- 635006-02 REFLECTOR AND TERMINAL MARKER REPLACEMENT
- 635011-01 REFLECTOR MARKER AND MOUNTING DETAILS
- 667101 PERMANENT SURVEY MARKERS
- 701006-02 TYPICAL APPLICATION OF TRAFFIC CONTROL DEVICES
- 701201-02 TYPICAL APPLICATION OF TRAFFIC CONTROL DEVICES
- 701301-02 TYPICAL APPLICATION OF TRAFFIC CONTROL DEVICES
- 701311-02 TYPICAL APPLICATION OF TRAFFIC CONTROL DEVICES
- 701321-08 TYPICAL APPLICATION OF TRAFFIC CONTROL DEVICES
- 701326-02 TYPICAL APPLICATION OF TRAFFIC CONTROL DEVICES
- 702001-05 TRAFFIC CONTROL DEVICES
- 704001-02 TEMPORARY CONCRETE
- 720011 METAL POSTS FOR SIGNS, MARKERS & DELINEATORS
- 780001-01 TYPICAL PAVEMENT MARKINGS
- 781001-02 TYPICAL APPLICATIONS RAISED REFLECTIVE PAVEMENT MARKERS
- 886001 DETECTOR LOOP INSTALLATIONS
- 886006 TYPICAL LAYOUT FOR DETECTION LOOPS

FULL SIZE PLANS HAVE BEEN PREPARED USING STANDARD ENGINEERING SCALES. REDUCED SIZED PLANS WILL NOT CONFORM TO STANDARD SCALES. IN MAKING MEASUREMENTS ON REDUCED PLANS, THE ABOVE SCALES MAY BE USED.

J.U.L.I.E.  
JOINT UTILITY LOCATION INFORMATION FOR EXCAVATION  
1-800-892-0123

JODAVIESS COUNTY  
PLEASANT VALLEY TOWNSHIP, SECTION 3 & 35, T. 26-N. & R-4-E.

CONTRACT NO. 64B27

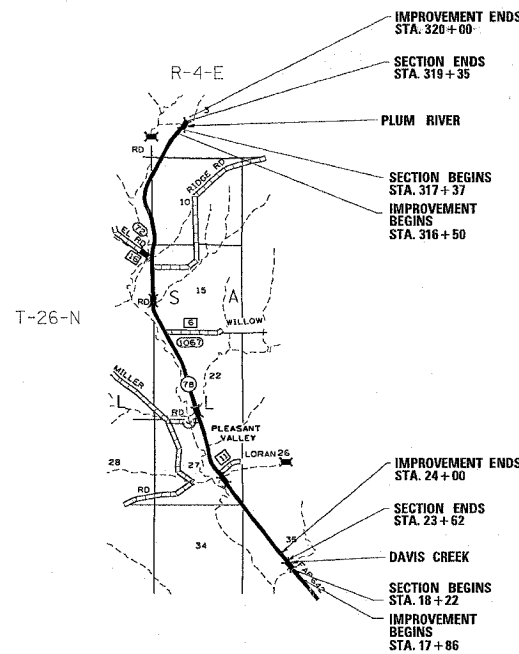

-DAVIS CREEK (SN#043-0042) INCLUDES THE REMOVAL AND REPLACEMENT OF SUPERSTRUCTURE ON BRIDGE CARRYING IL 78 OVER DAVIS CREEK WITH GUARDRAIL UP DATES

-PLUM RIVER (SN# 043-0040) WILL INCLUDE ONLY A NEW CONCRETE DECK OVERLAY

GROSS LENGTH OF SECTION = 738 FEET = .014 MILES  
NET LENGTH OF SECTION = 738 FEET = .014 MILES

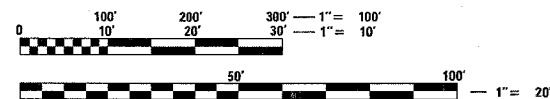

STATE OF ILLINOIS  
DEPARTMENT OF TRANSPORTATION  
DIVISION OF HIGHWAYS

SUBMITTED December 30<sup>th</sup> 20 05

George Z. Prunty  
DEPUTY DIRECTOR OF HIGHWAYS, REGION ENGINEER

February 3, 20 06  
Mike Nive  
ENGINEER OF DESIGN AND ENVIRONMENT

February 3, 20 06  
Milton R. Sees, P.E.  
DIRECTOR OF HIGHWAYS, CHIEF ENGINEER

PRINTED BY THE AUTHORITY  
OF THE STATE OF ILLINOIS