

STATE OF ILLINOIS  
DEPARTMENT OF TRANSPORTATION

F.A.I. RTE.	SECTION	COUNTY	TOTAL SHEETS	SHEET NO.
80	32-3HBR-1	GRUNDY	88	32
STA.	TO STA.			
FED. ROAD DIST. NO.	ILLINOIS	FED. AID PROJECT		

SHEET NO. B5  
OF 35 SHEETS

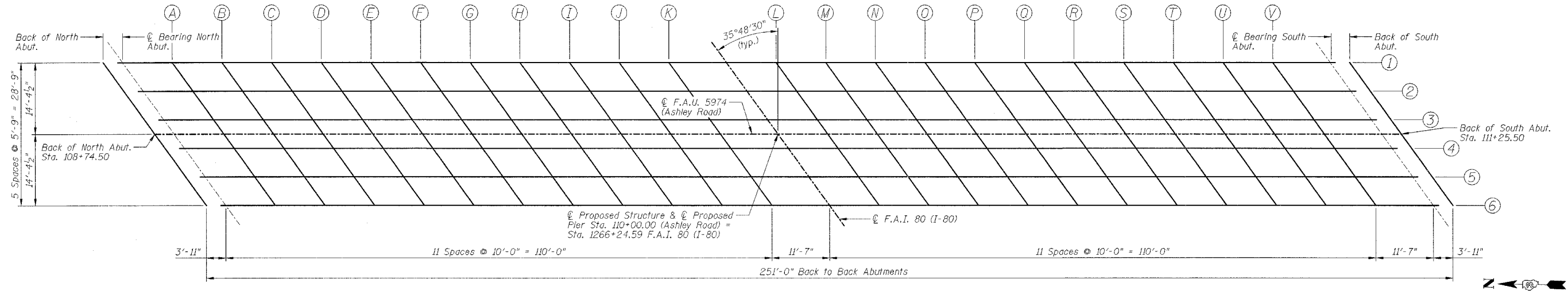

PLAN

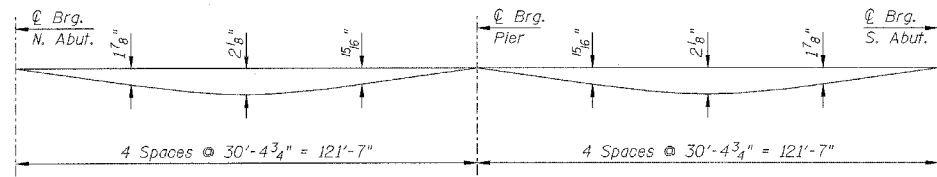

DEAD LOAD DEFLECTION DIAGRAM

(Includes weight of concrete only)

- NOTES: 1.) The above deflections are not to be used in the field if the Engineer is working from the Theoretical Grade Elevations Adjusted for Dead Load Deflections as shown on Sheets B6 & B7.  
2.) Work this sheet with Sheets B6 & B7.

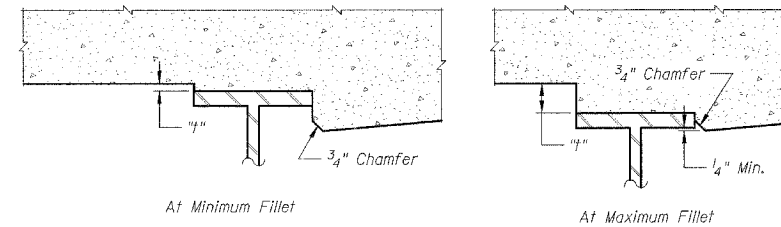

To determine "t": After all structural steel has been erected, elevations of the top flanges of the beams shall be taken at intervals shown above. These elevations subtracted from the "Theoretical Grade Elevations Adjusted for Dead Load Deflection" shown on Sheets B6 & B7, minus slab thickness, equals the fillet heights "t" above top flange of beams.

FILLET HEIGHTS

REVISIONS		ILLINOIS DEPARTMENT OF TRANSPORTATION ELEVATION LOCATIONS AND DEAD LOAD DEFLECTION DIAGRAM F.A.I. 80 (I-80) F.A.U. 5974 (ASHLEY ROAD) OVER I-80 SECTION 32-3HBR-1 GRUNDY COUNTY STATION 110+00.00 STRUCTURE NO. 032-0113 DESIGNED BY: JML DATE: 09/09/05
NAME	DATE	
		DRAWN BY: DJM CHECKED BY: MSW