

STATE OF ILLINOIS
DEPARTMENT OF TRANSPORTATION

ROUTE NO.	SECTION	COUNTY	TOTAL SHEETS	SHEET NO.	SHEET NO. 6 7 SHEETS
FAS 1324	38 BR-1	IROQUOIS	29	14	
FED. ROAD DIST. NO.	ILLINOIS	FED. AID PROJECT			

Contract # 66564

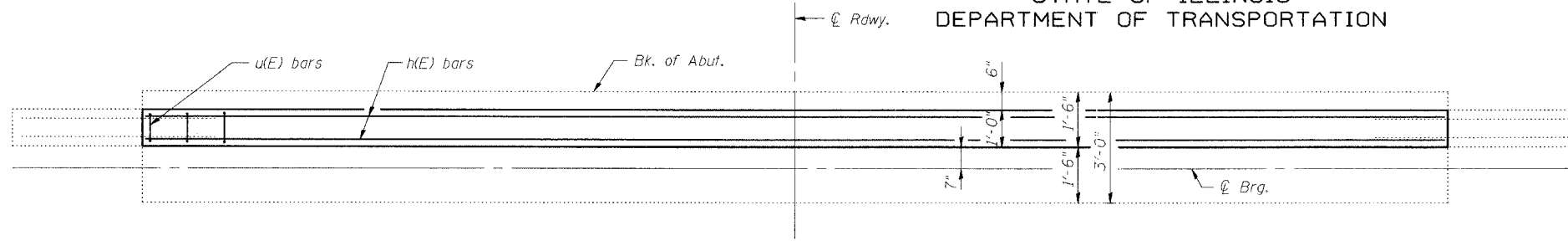

PLAN

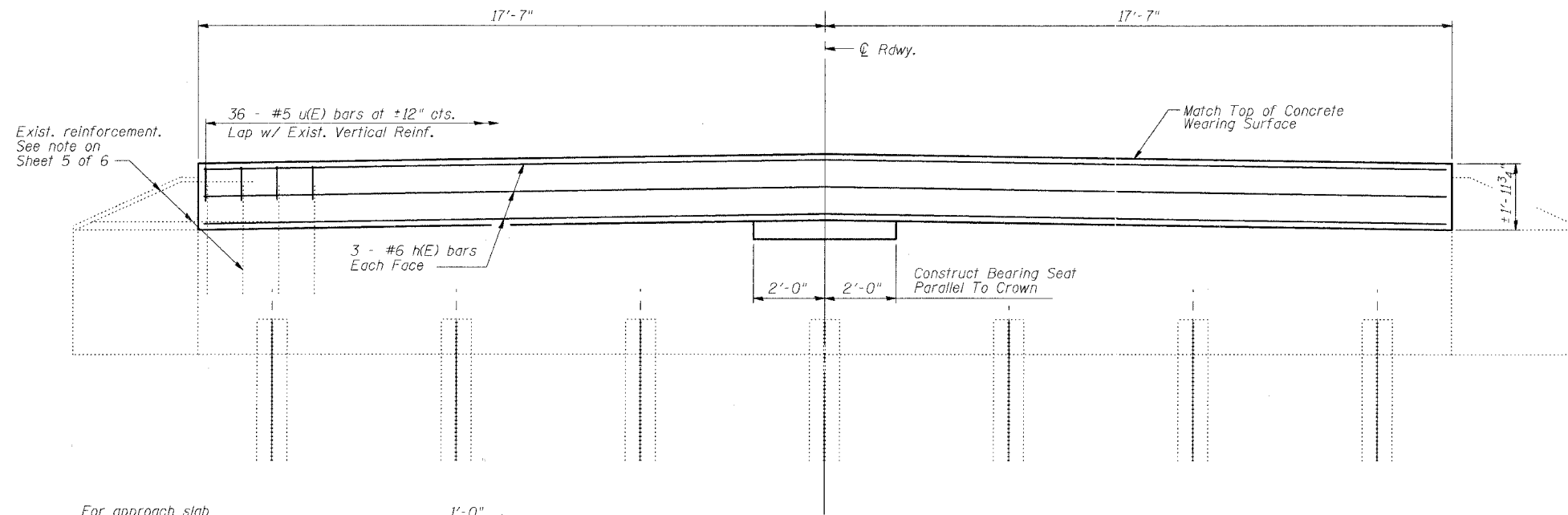

ELEVATION

Looking North (N. Abut.)
Looking South (S. Abut.)

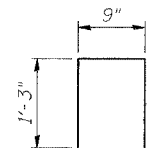

BAR u(E)

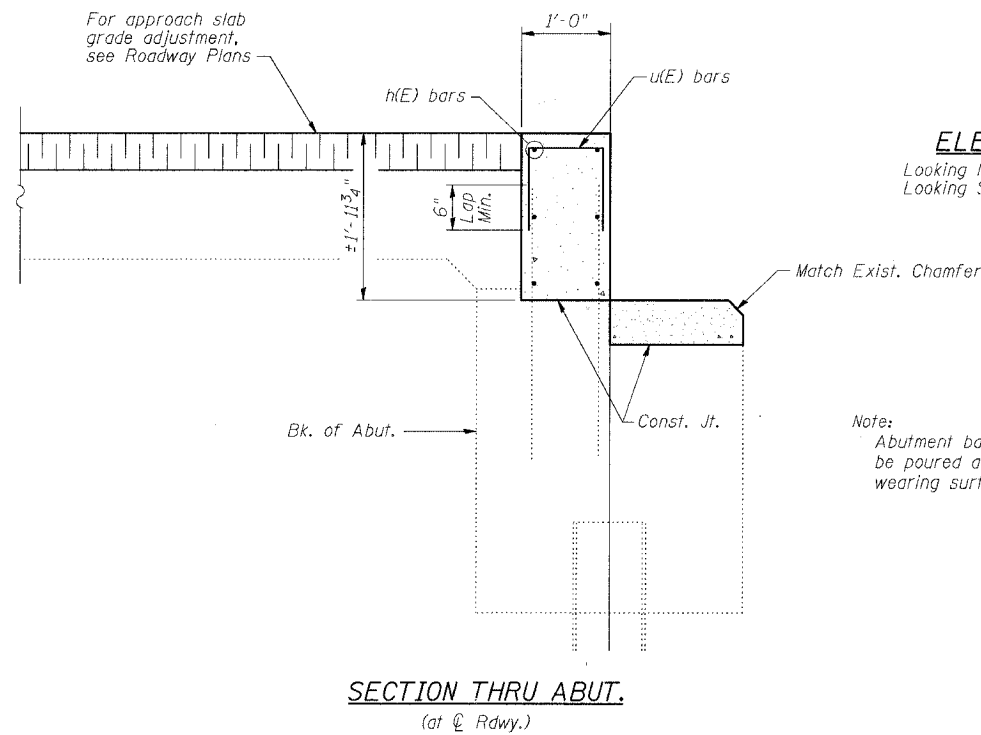

SECTION THRU ABUT.

(at Brg.)

Note:
Abutment backwall shall be poured after concrete wearing surface is in place.

BILL OF MATERIAL

Bar	No.	Size	Length	Shape
h(E)	12	#6	34'-10"	—
u(E)	72	#5	3'-3"	□
Concrete Removal			Cu. Yd.	4.0
Concrete Structures			Cu. Yd.	5.3
Reinforcement Bars, Epoxy Coated			lb.	870

Reinforcement bars designated (E) shall be epoxy coated.

REVISIONS	
NAME	DATE

ILLINOIS DEPARTMENT OF TRANSPORTATION
ABUTMENTS
OLD US 45 OVER LANGAN CREEK
FAS ROUTE 1324 SECTION 38 BR-1
IROQUOIS COUNTY
STATION 558+74
S.N. 038-0185

SCALE: VERT. _____
HORIZ. _____
DATE: #/##/05

DRAWN BY: HEBERLING
DESIGNED BY: SANFORD
CHECKED BY: _____

GREENE & BRADFORD, INC.
OF SPRINGFIELD
PROFESSIONAL ENGINEERS AND ARCHITECTS
CORPORATION
501 N. 11TH ST., SPRINGFIELD, ILL. 62761
TEL. 217-223-7700 FAX 217-223-7701

COMPUTER FILE NO.
abutments.dgn
PROJECT WO-10
03236

FILE NAME = JA\03236\WOOD\DRAWINGS\038-0185\NO38-0185-AB.dgn
PLOT DATE = 11/18/05
PLOT TIME = 8:55:32 AM
OPERATOR = dcv/h