

F&M FILE NO.	SECTION	COUNTY	TOTAL SHEETS	SHEET NO.
2955	02-00049-00-PV	COOK	45	9
STA. TO STA.		FED. ROAD DIST. NO.		
		ILLINOIS	FED. AID PROJECT	

Contract 83819



LEGEND

- 1 ROAD CLOSED 1000FT
W20-3 48"x48"
- 2 ROAD CLOSED 500FT
W20-3 48"x48"
- 3 OAK PARK AVENUE
D3-1 36"x6"
- 4 ROAD CLOSED TO THRU TRAFFIC
R11-4 60"x30"
(ON TYPE III BARRICADE)
- 5 DETOUR
M4-8 24"x12"
- 6 NORTH
M3-1 24"x12"
- 7 SOUTH
M3-3 24"x12"
- 8 OAK PARK AVENUE
24"x24"
- 9 END DETOUR
M4-8a 24"x18"
- 10
M5-1 21"x15"
- 11
M5-1 21"x15"
- 12
M6-1 21"x15"
- 13
M6-1 21"x15"
- 14
M6-3 21"x15"
- 15 DETOUR AHEAD
W20-2 48"x48"
- 16 DETOUR
M4-10L 48"x18"
- 17 DETOUR
M4-10R 48"x18"

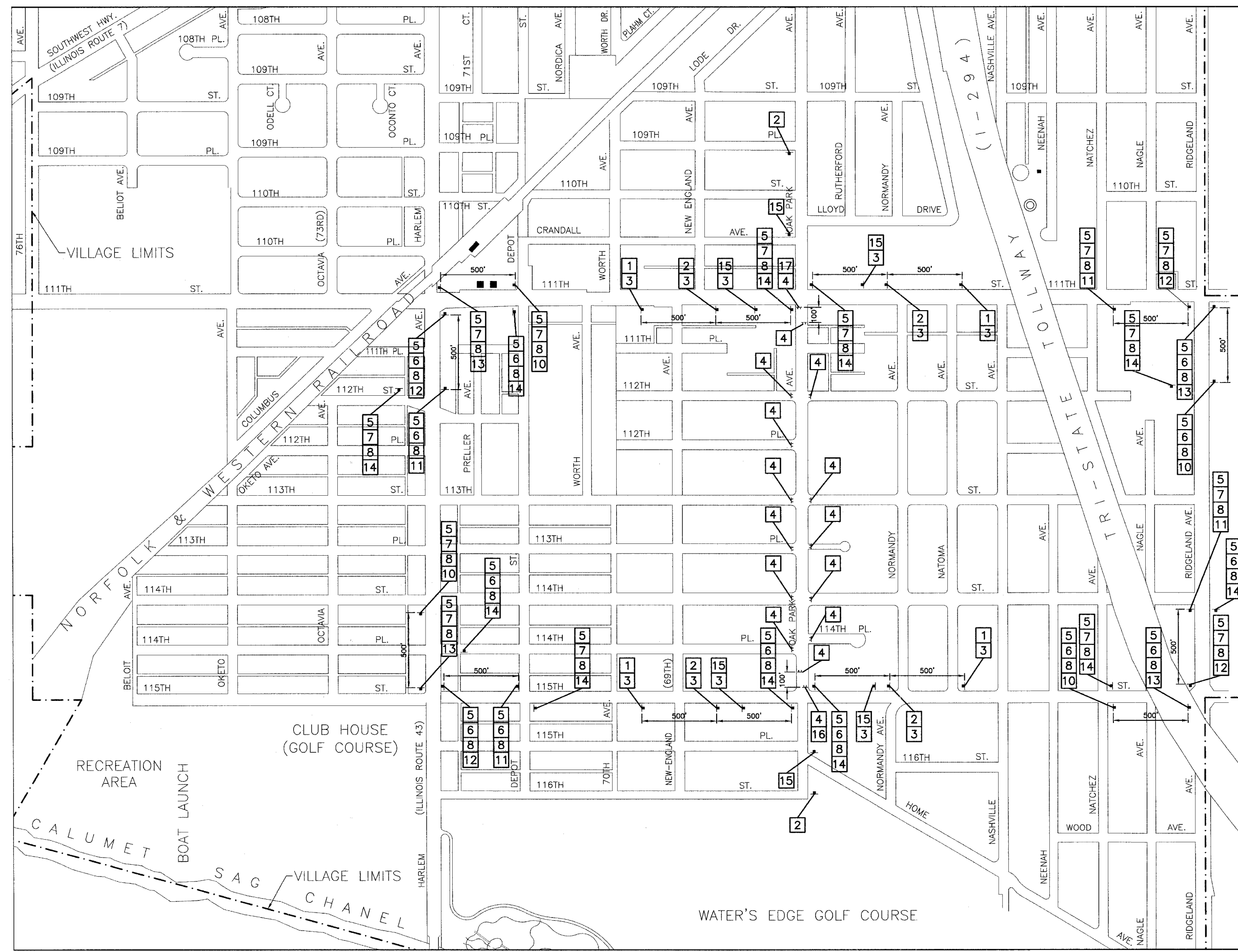

ROBINSON ENGINEERING, LTD.
CONSULTING REGISTERED PROFESSIONAL ENGINEERS
AND PROFESSIONAL LAND SURVEYORS
17000 SOUTH PARK AVENUE SOUTH HOLLAND, ILLINOIS 60473
(708) 351-6700 © COPYRIGHT 2004 ILLINOIS DESIGN FIRM REGISTRATION NO. 184001128

**OAK PARK AVENUE RECONSTRUCTION
115TH STREET TO 111TH STREET
DETOUR PLAN**

WORTH, ILLINOIS

Drawn by: EC Date: 3/31/04
Checked by: JMN Scale: 1"=300'
Sheet of Project No: 02-162

REVISIONS		
No.	Date	Remarks
1	9-7-05	REL