

PROJECT NO.	SECTION	COUNTY	SHEET NO.	TOTAL SHEETS
6385	*	McLEAN	34	9
FED. RD. DIST. #7 ILLINOIS PROJ. # M-5227 (45)				

* 03-00182-03-RS
CONTRACT NO. 87275

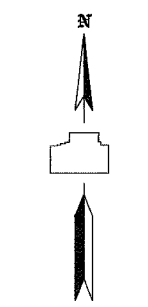

SCALE: 1" = 20'
ALL DETAILS

SPECIAL ENTRANCE DETAIL
WHITEOAK ROAD AND NORTH O'NEIL PARK ENTRANCE
STATION: 820+56

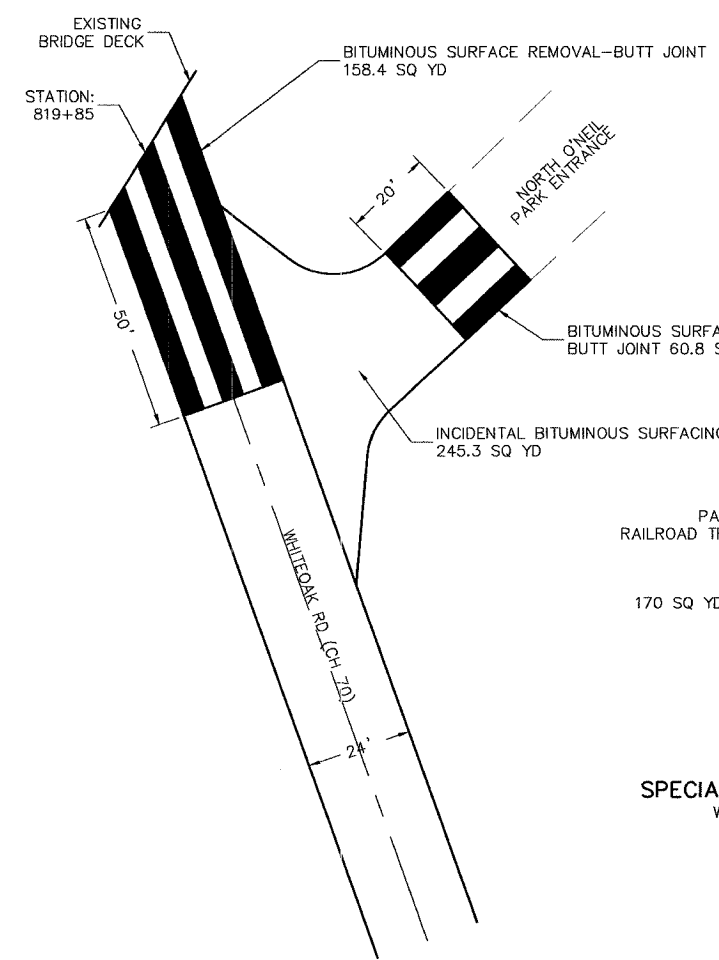

SPECIAL ENTRANCE DETAIL
WHITEOAK ROAD AND SOUTH O'NEIL PARK ENTRANCE
STATION: 827+17

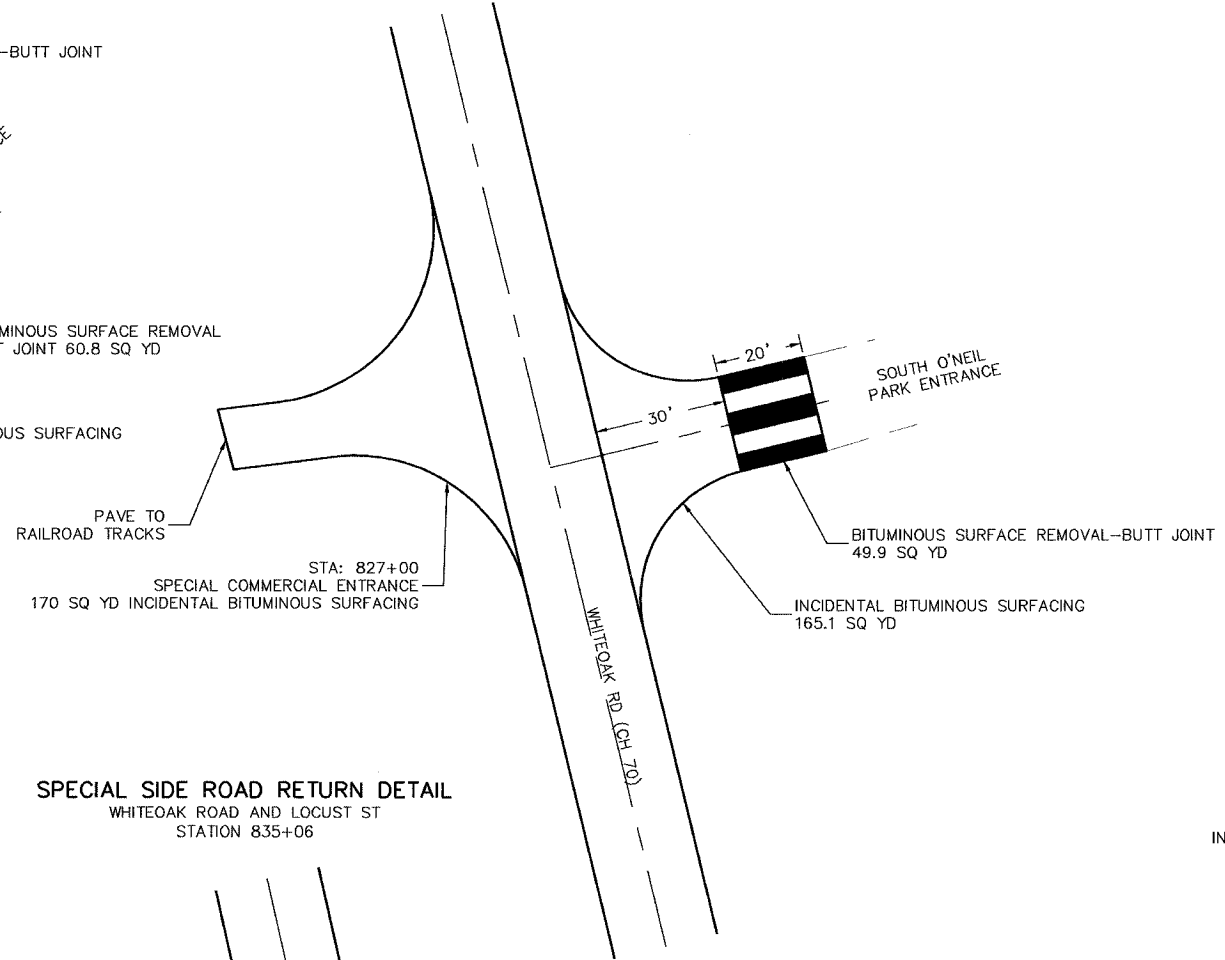

SPECIAL SIDE ROAD RETURN DETAIL
WHITEOAK ROAD AND CHESTNUT ST
STATION 832+28

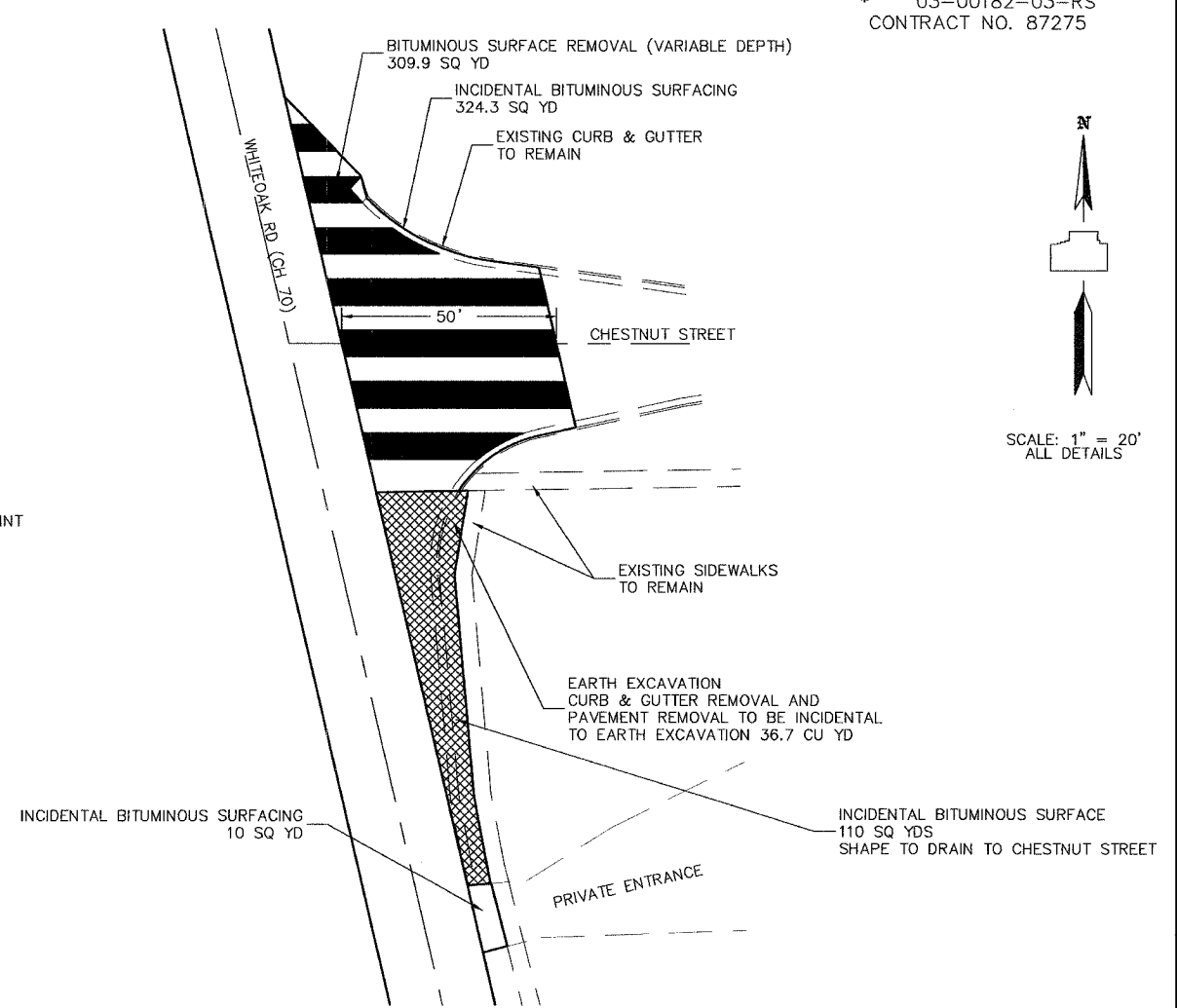

SPECIAL SIDE ROAD RETURN DETAIL
WHITEOAK ROAD AND LOCUST ST
STATION 835+06

