

F.A.U. RTE.	SECTION	COUNTY	TOTAL SHEETS	SHEET NO.
*	**	McLEAN	34	19
STA.		TO STA.		
FED. ROAD DIST. NO.		ILLINOIS	FED. AID PROJECT	

\* 6352 - COLLEGE AVENUE  
 6385 - WHITE OAK ROAD (C.H. 70)  
 \*\* 03-00182-00-R5

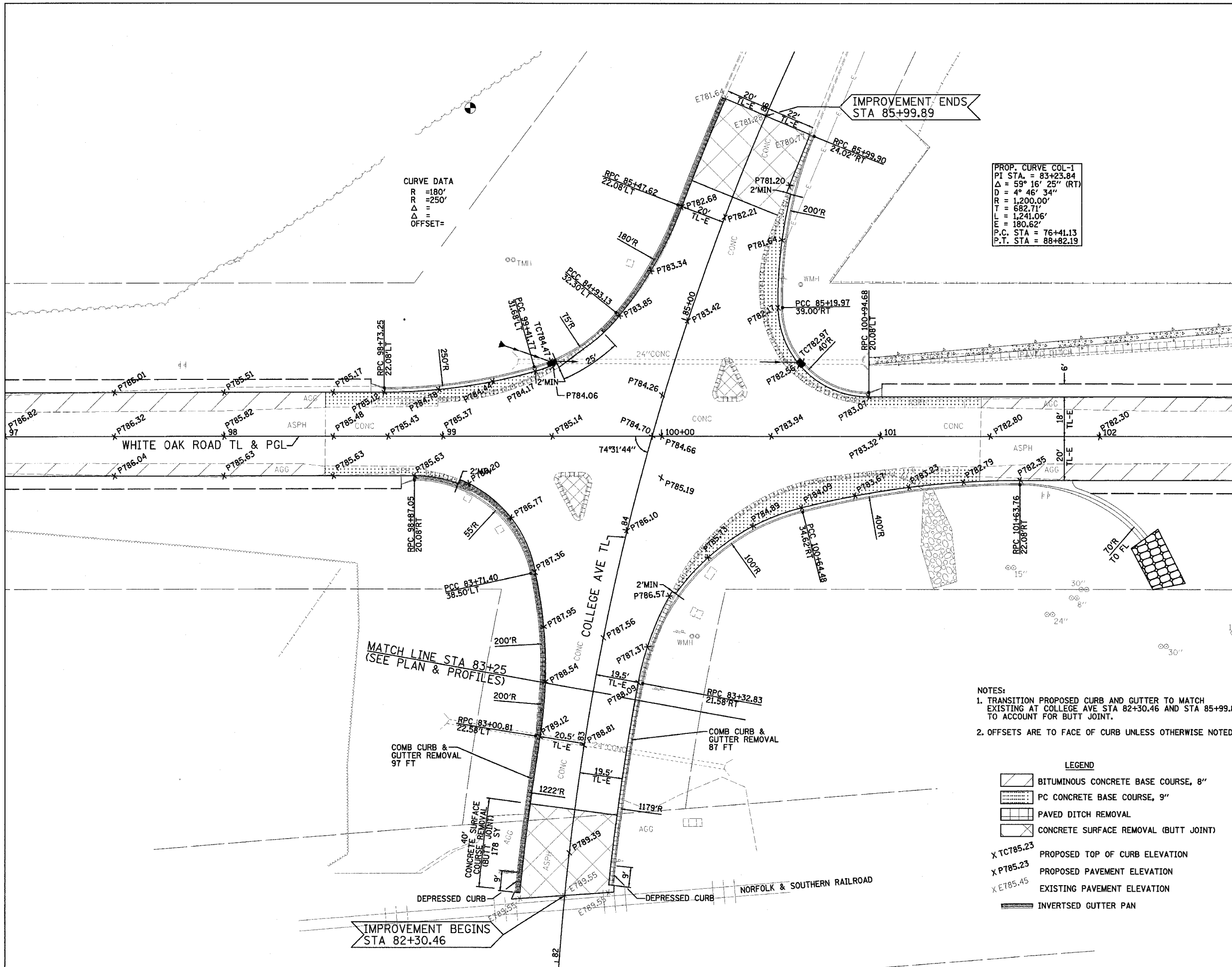

CURVE DATA  
 R = 180'  
 R = 250'  
 Δ =  
 OFFSET =

PROP. CURVE COL-1  
 P.I. STA. = 83+23.84  
 Δ = 53° 16' 25" (RT)  
 D = 4° 46' 34"  
 R = 1,200.00'  
 T = 682.71'  
 L = 241.06'  
 E = 180.62'  
 P.C. STA = 76+41.13  
 P.T. STA = 88+82.19

- NOTES:
- TRANSITION PROPOSED CURB AND GUTTER TO MATCH EXISTING AT COLLEGE AVE STA 82+30.46 AND STA 85+99.89 TO ACCOUNT FOR BUTT JOINT.
  - OFFSETS ARE TO FACE OF CURB UNLESS OTHERWISE NOTED.

- LEGEND
- BITUMINOUS CONCRETE BASE COURSE, 8"
  - PC CONCRETE BASE COURSE, 9"
  - PAVED DITCH REMOVAL
  - CONCRETE SURFACE REMOVAL (BUTT JOINT)
  - X TC785.23 PROPOSED TOP OF CURB ELEVATION
  - X P785.23 PROPOSED PAVEMENT ELEVATION
  - X E785.45 EXISTING PAVEMENT ELEVATION
  - INVERTSED GUTTER PAN

McLEAN CO SECTION 03-00182-00-R5  
 COLLEGE AVENUE & WHITE OAK ROAD WIDENING

**INTERSECTION DETAIL**

DRAWN BY J.OCHSNER	 2709 McGraw Drive Bloomington, Illinois 61704 308.883-8486 / fax 308.883-1871	FILE NO. 24-7482
DATE 03/08/05		BOOK NO. 2704
CHECKED BY RGD		SHEET NO.

REVISED 12/08/05