

F.A.U. NO.	SECTION	COUNTY	TOTAL SHEETS	SHEET NO.
*	**	McLEAN	34	22
STA.	TO STA.			
FED. ROAD DIST. NO. ILLINOIS FED. AID PROJECT				
* 6352 - COLLEGE AVENUE 6385 - WHITE OAK ROAD (C.H. 70)				
** 03-00182-00-RS				

STA 90+16.41 AHEAD=
STA 716+77.02 BACK

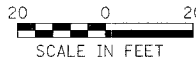
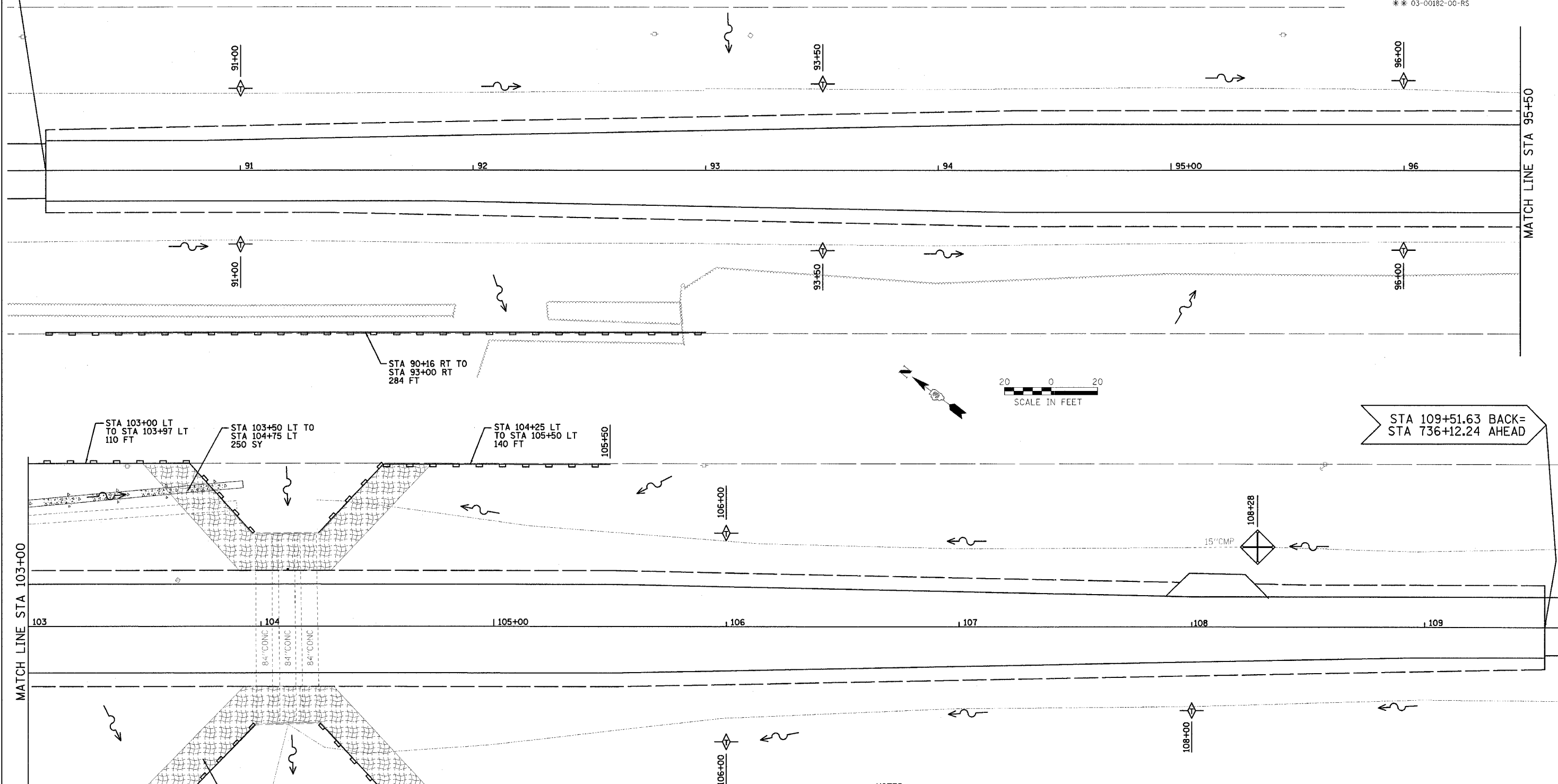

STA 109+51.63 BACK=
STA 736+12.24 AHEAD

MATCH LINE STA 103+00

MATCH LINE STA 95+50

STA 90+16 RT TO
STA 93+00 RT
284 FT

STA 103+00 LT
TO STA 103+97 LT
110 FT

STA 103+50 LT TO
STA 104+75 LT
250 SY

STA 104+25 LT
TO STA 105+50 LT
140 FT

STA 103+00 RT
TO STA 103+97 RT
110 FT

STA 103+50 RT TO
STA 104+75 RT
250 SY

STA 104+25 RT
TO STA 105+50 RT
140 FT

LEGEND

- PERIMETER EROSION CONTROL BARRIER
- TEMPORARY DITCH CHECK
- INLET & PIPE PROTECTION
- EROSION CONTROL BLANKET
- PROPOSED DRAINAGE ARROW

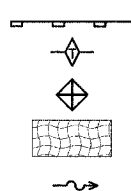

NOTES:

1. THE CONTRACTOR SHALL PROTECT PROPOSED INLETS AND PIPES IMMEDIATELY AFTER THEY ARE CONSTRUCTED UNTIL THE SURFACE'S THAT DRAIN TO THEM ARE PAVED OR FULLY REVEGETATED.
2. THE CONTRACTOR SHALL UTILIZE STRAW BALES IN ACCORD WITH STANDARD 280001-02 FOR PLACEMENT OF TEMPORARY DITCH CHECKS IN DRAINAGEWAYS.
3. TEMPORARY EROSION CONTROL SEEDING SHALL BE APPLIED AT 100 POUNDS PER ACRE.
4. PERMANENT EROSION CONTROL BLANKET REPLACES MULCH AT ALL END SECTIONS FOR A FOUR FOOT PERIMETER WIDTH, UNLESS AN ALTERNATIVE LINING IS INDICATED.
5. THE MULCH METHOD 2 PAY ITEM SHALL BE REQUIRED FOR FINAL PERMANENT SEEDING, AND USED AS NECESSARY FOR TEMPORARY SEEDING AT EROSION SLOPE AREAS.
6. THE CONTRACTOR SHALL REMOVE ALL TEMPORARY EROSION CONTROL ITEMS SUCH AS DITCH CHECKS AND INLET/PIPE PROTECTION AFTER SEEDING IS FULLY ESTABLISHED. NO COMPENSATION SHALL BE ALLOWED FOR THIS WORK.

McLEAN CO SECTION 03-00182-00-RS
COLLEGE AVENUE & WHITE OAK ROAD WIDENING

EROSION CONTROL PLAN

DRAWN BY J.OCHSNER	DATE 03/08/05	CHECKED BY RGD	FILE NO. 24-7482	BOOK NO. 2704	SHEET NO.
-----------------------	------------------	-------------------	---------------------	------------------	-----------

