

F.A.U. RTE.	SECTION	COUNTY	TOTAL SHEETS	SHEET NO.
*	**	McLEAN	34	23

STA.	TO STA.

FED. ROAD DIST. NO. [ILLINOIS] FED. AID PROJECT
 * 6352 - COLLEGE AVENUE
 6385 - WHITE OAK ROAD (C.H. 70)
 ** 03-00182-00-R5

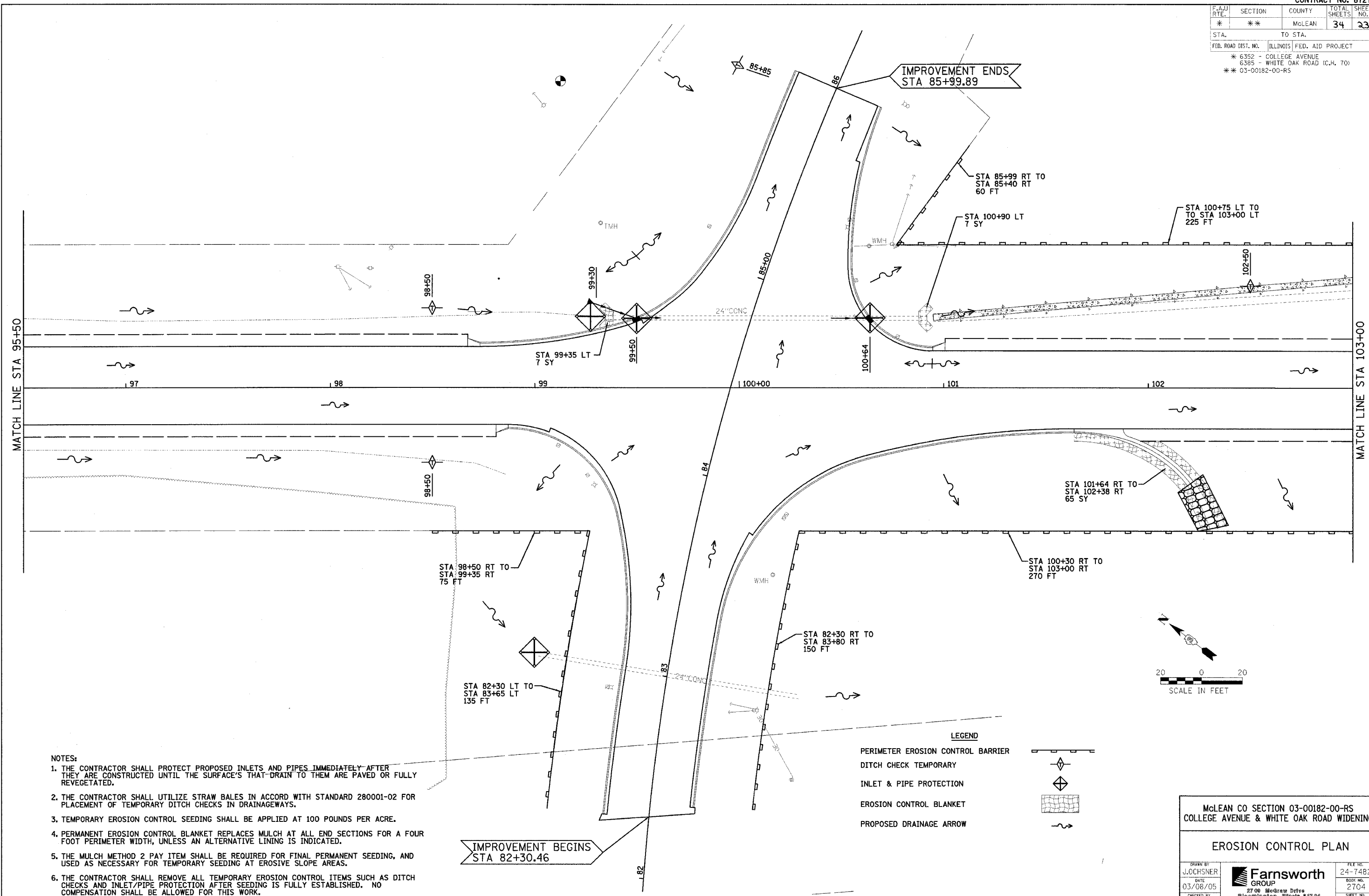

MATCH LINE STA 95+50

MATCH LINE STA 103+00

IMPROVEMENT ENDS
STA 85+99.89

IMPROVEMENT BEGINS
STA 82+30.46

- NOTES:**
1. THE CONTRACTOR SHALL PROTECT PROPOSED INLETS AND PIPES IMMEDIATELY AFTER THEY ARE CONSTRUCTED UNTIL THE SURFACE'S THAT DRAIN TO THEM ARE PAVED OR FULLY REVEGETATED.
 2. THE CONTRACTOR SHALL UTILIZE STRAW BALES IN ACCORD WITH STANDARD 280001-02 FOR PLACEMENT OF TEMPORARY DITCH CHECKS IN DRAINAGEWAYS.
 3. TEMPORARY EROSION CONTROL SEEDING SHALL BE APPLIED AT 100 POUNDS PER ACRE.
 4. PERMANENT EROSION CONTROL BLANKET REPLACES MULCH AT ALL END SECTIONS FOR A FOUR FOOT PERIMETER WIDTH, UNLESS AN ALTERNATIVE LINING IS INDICATED.
 5. THE MULCH METHOD 2 PAY ITEM SHALL BE REQUIRED FOR FINAL PERMANENT SEEDING, AND USED AS NECESSARY FOR TEMPORARY SEEDING AT EROSION SLOPE AREAS.
 6. THE CONTRACTOR SHALL REMOVE ALL TEMPORARY EROSION CONTROL ITEMS SUCH AS DITCH CHECKS AND INLET/PIPE PROTECTION AFTER SEEDING IS FULLY ESTABLISHED. NO COMPENSATION SHALL BE ALLOWED FOR THIS WORK.

LEGEND

PERIMETER EROSION CONTROL BARRIER	
DITCH CHECK TEMPORARY	
INLET & PIPE PROTECTION	
EROSION CONTROL BLANKET	
PROPOSED DRAINAGE ARROW	

McLEAN CO SECTION 03-00182-00-R5
 COLLEGE AVENUE & WHITE OAK ROAD WIDENING

EROSION CONTROL PLAN

DRAWN BY J.OCHSNER	 2709 McGraw Drive Bloomington, Illinois 61704 309.882-8499 / fax 309.882-1571	FILE NO. 24-7482
DATE 03/08/05		BOOK NO. 2704
CHECKED BY RGD		SHEET NO.