

F.A.U. RTE.	SECTION	COUNTY	TOTAL SHEETS	SHEET NO.
*	**	McLEAN	34	29
STA. 89+00		TO STA. 93+00		
FED. ROAD DIST. NO. ILLINOIS FED. AID PROJECT				
* 6352 COLLEGE AVENUE				
* 6385 WHITE OAK ROAD (C.H. 70)				
** 03-00182-00-RS				

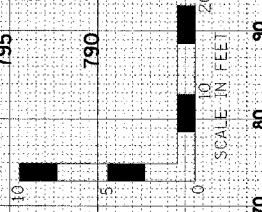

ALL DISTURBED AREAS SHALL HAVE TOPSOIL PLACEMENT 4"

UTILITY LOCATIONS SHOWN ON THE CROSS SECTIONS ARE BASED UPON APPROXIMATE LOCATIONS SUPPLIED BY THE UTILITY COMPANY. THE CONTRACTOR SHALL VERIFY UTILITY LOCATIONS PRIOR TO CONSTRUCTION.

FINAL	DATE
REVISION	BY
SURVEY	DATE
NOTED	BY
PLOTTED	DATE
TEMPLATE	BY
AREAS CHECKED	BY

ORIGINAL	DATE
SURVEY	BY
NOTED	DATE
PLOTTED	BY
TEMPLATE	DATE
AREAS CHECKED	BY

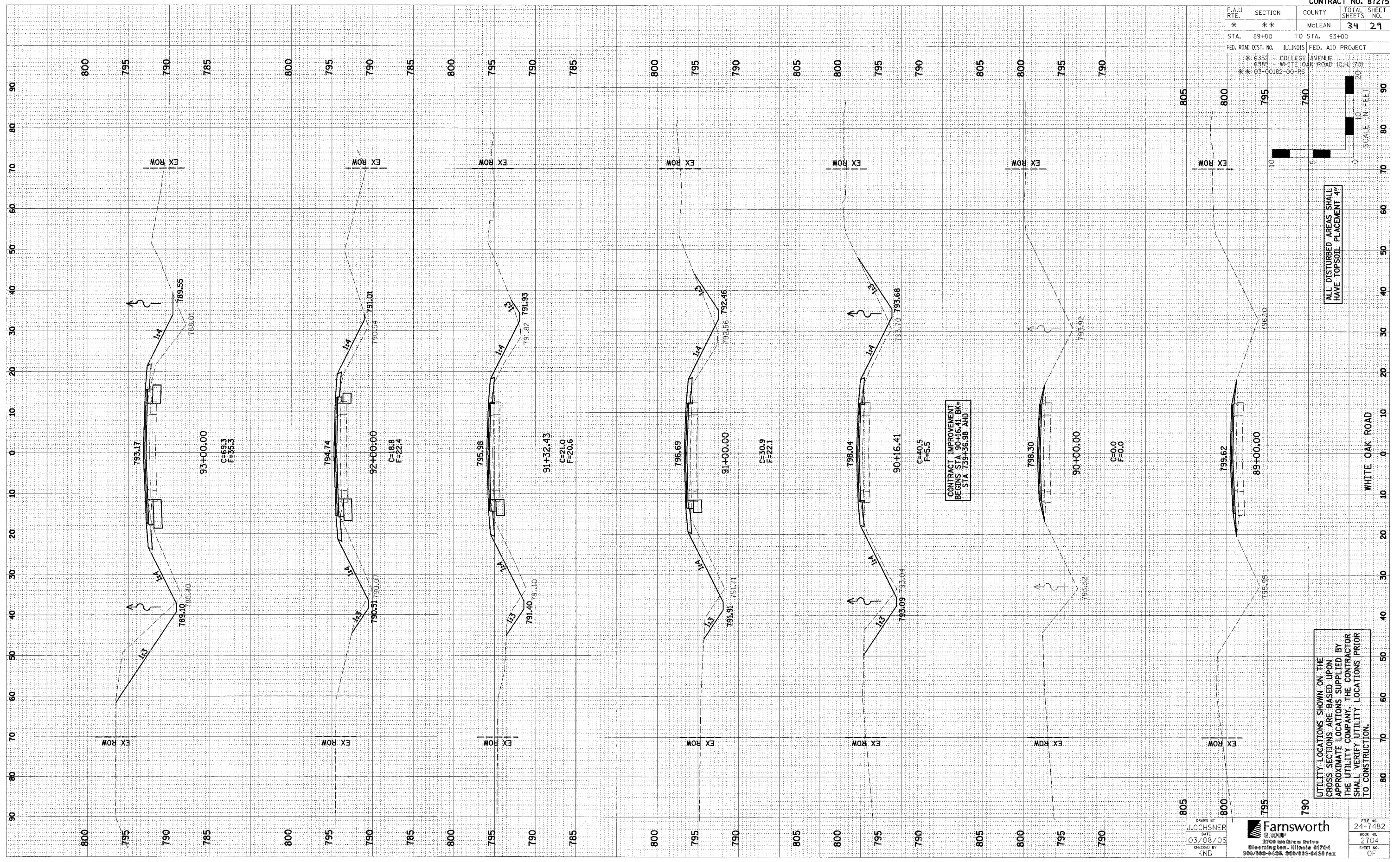

DRAWN BY
J. JOCHNER
DATE
03/08/05
CHECKED BY
KNB

Farnsworth
2700 West Drive
Bloomington, Illinois 61704
309/882-8438, 309/882-8438 fax

FILE NO.
24-7482
BOOK NO.
2704
SHEET NO.
OF