

F.A.U. RTE.	SECTION	COUNTY	TOTAL SHEETS	SHEET NO.
*	**	McLEAN	34	33
STA. 104+10.51		TO STA. 108+00		
FED. ROAD DIST. NO. ILLINOIS FED. AID PROJECT				
* 6382 - COLLEGE AVENUE				
* 6385 - WHITE OAK ROAD (C.H. TO				
* 03-00182-00-RS				

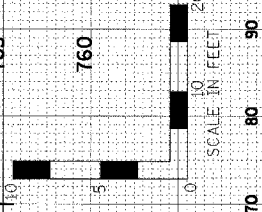

FILE	BY	DATE
SURVEYED		
PLOTTED		
NOTE BOOK		
AREAS CHECKED		

ORIGINAL	BY	DATE
SURVEYED		
PLOTTED		
NOTE BOOK		
AREAS CHECKED		

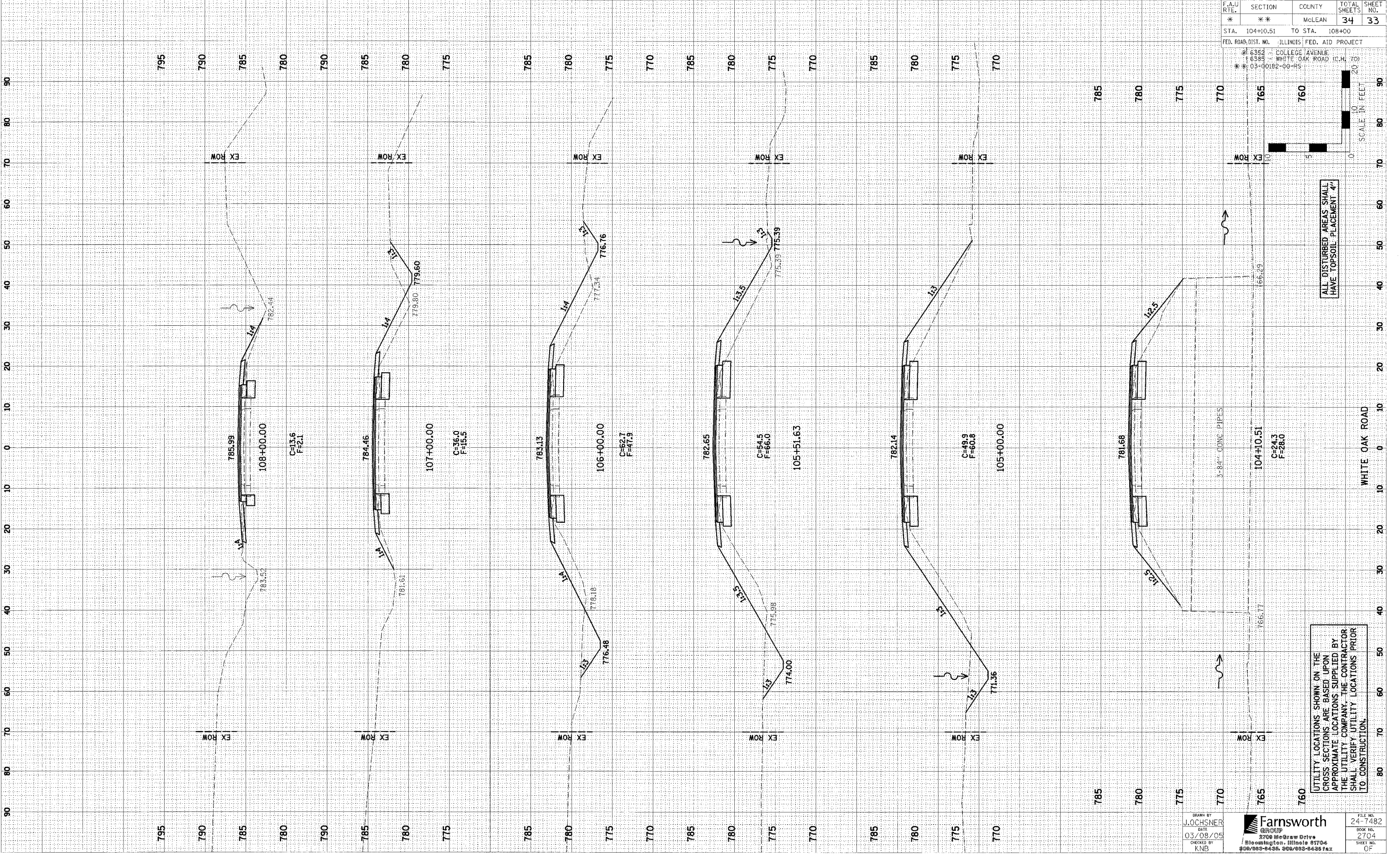

ALL DISTURBED AREAS SHALL HAVE TOPSOIL PLACEMENT 4"

UTILITY LOCATIONS SHOWN ON THE CROSS SECTIONS ARE BASED UPON APPROXIMATE LOCATIONS SUPPLIED BY THE UTILITY COMPANY. THE CONTRACTOR SHALL VERIFY UTILITY LOCATIONS PRIOR TO CONSTRUCTION.

DRAWN BY
J. OCHSNER
DATE
03/08/05
CHECKED BY
KNB

Farnsworth GROUP
2700 McGraw Drive
Bloomington, Illinois 61704
309/555-6435 309/555-6439 fax

FILE NO.
24-7482
BOOK NO.
2704
SHEET NO.
OF