

RTE.	SECTION	COUNTY	TOTAL SHEETS	SHEET NO.
C.H. 19	03-00181-00-BR	MACON	13	4
STA. 9+50.00 TO STA. 21+49.54				
FED. ROAD DIST. NO.	ILLINOIS	PROJECT: BRS-555(205)		

CONTRACT NO. 91342

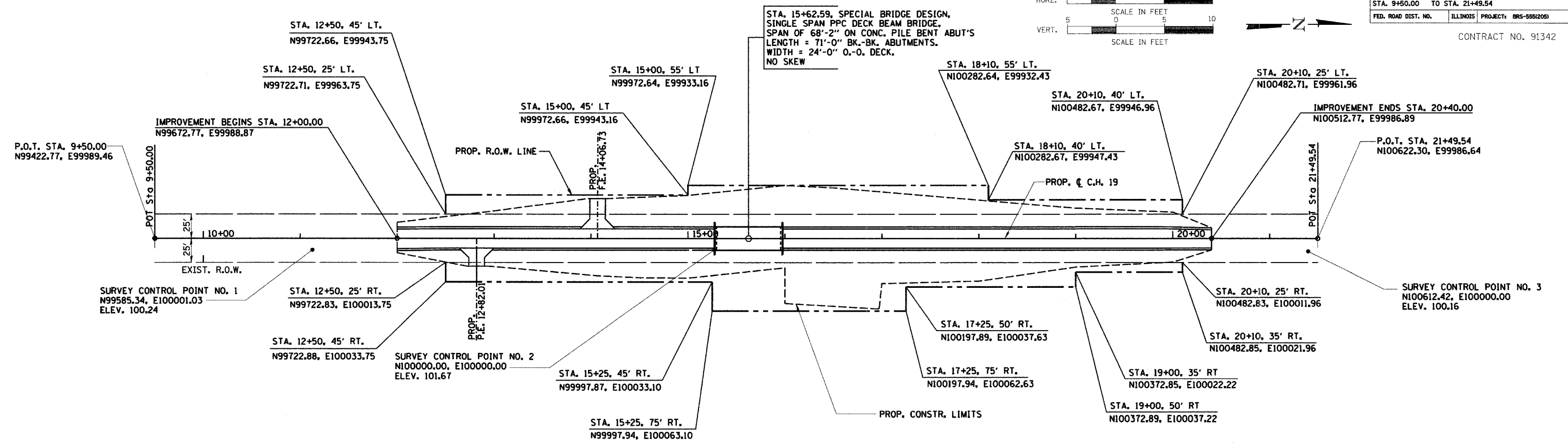
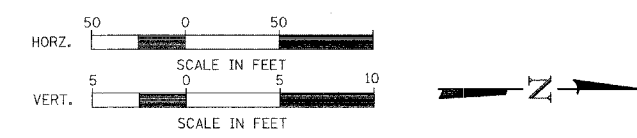

STA. 15+62.59, SPECIAL BRIDGE DESIGN,  
SINGLE SPAN PPC DECK BEAM BRIDGE,  
SPAN OF 68'-2" ON CONC. PILE BENT ABUT'S  
LENGTH = 71'-0" BK.-BK. ABUTMENTS.  
WIDTH = 24'-0" O.-O. DECK.  
NO SKEW

PROPOSED STRUCTURE LAYOUT

SOUTH ABUTMENT

BK. OF S. ABUT. STA. 15+27.09  
N99999.86, E99988.10

☐ S. ABUT. STA. 15+28.34  
N100001.11, E99988.10

FACE OF S. ABUT. STA. 15+29.59  
N100002.36, E99988.09

NORTH ABUTMENT

BK. OF N. ABUT. STA. 15+98.09  
N100070.86, E99987.93

☐ N. ABUT. STA. 15+96.84  
N100069.61, E99987.93

FACE OF N. ABUT. STA. 15+95.59  
N100068.36, E99987.94

**NOTE:**  
FOR TIE POINTS AND BENCHMARK LOCATION,  
SEE SHEET 3 OF 13.

HORIZONTAL LAYOUT