

RTE.	SECTION	COUNTY	TOTAL SHEETS	SHEET NO.
C.H. 19	03-00181-00-BR	MACON	13	8
STA. 9+50.00		TO STA. 21+49.54		
FED. ROAD DIST. NO.		ILLINOIS	PROJECT BRS-555(205)	

CONTRACT NO. 91342

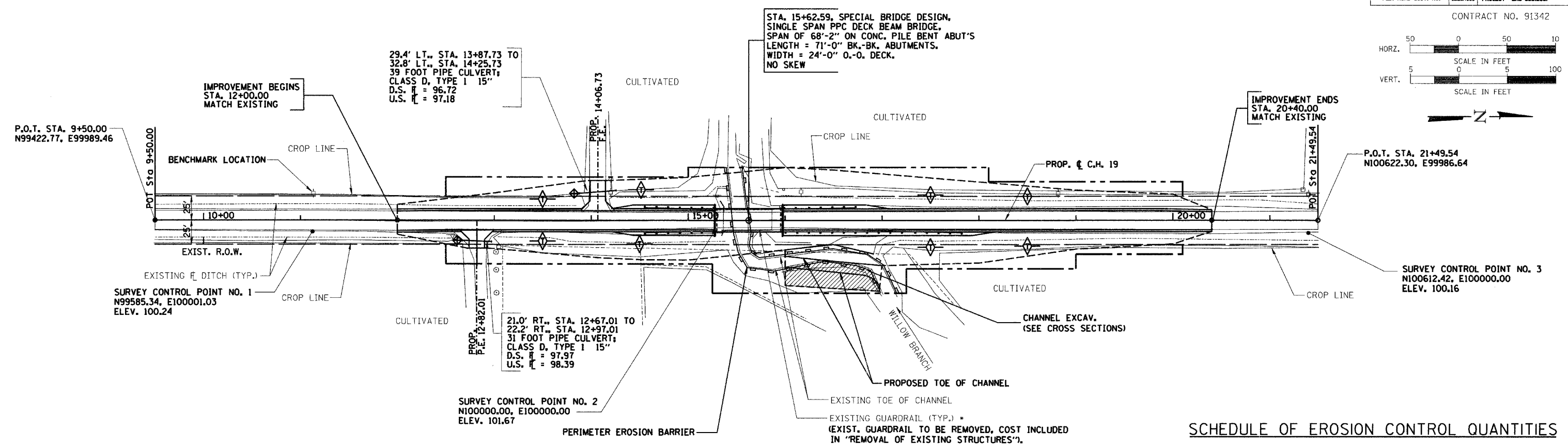
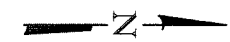
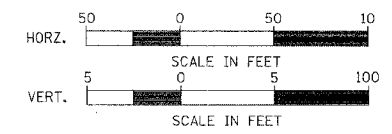

LEGEND

- ◆ TEMPORARY AGGREGATE DITCH CHECK (TYP.) (COST INCLUDED IN TEMPORARY DITCH CHECK, SEE STD. 280001)
 - PERIMETER EROSION BARRIER
 - ◆ TEMPORARY PIPE PROTECTION
- ALL ITEMS SHALL BE CONSTRUCTED AS SHOWN ON STANDARD 280001 AND AS DIRECTED BY THE ENGINEER. MAINTENANCE AND CLEANING OF THE EROSION CONTROL ITEMS SHALL BE INCLUDED IN THE RESPECTIVE EROSION CONTROL PAY ITEM.

STORM WATER POLLUTION PREVENTION PLAN

DESCRIPTION OF INTENDED SEQUENCE FOR MAJOR CONSTRUCTION ACTIVITIES:

1. REMOVAL OF EXISTING STRUCTURE.
2. EXCAVATION WILL BE COMPLETED ALONG THE ENTIRE LENGTH OF THE JOB TO REMOVE THE EXISTING ROADWAY AND GRADE THE PROPOSED DITCHES.
3. NECESSARY EMBANKMENT WILL BE PLACED ALONG THE ENTIRE LENGTH OF THE JOB FOR THE PROPOSED ROADWAY.
4. PLACEMENT, MAINTENANCE, REMOVAL AND PROPER CLEAN-UP OF TEMPORARY EROSION CONTROL ITEMS, SUCH AS PERIMETER EROSION BARRIER, AGGREGATE DITCH CHECKS, TEMPORARY SEEDING AND OTHER MISCELLANEOUS EROSION CONTROL MEASURES.
5. CONSTRUCT NEW BRIDGE SUBSTRUCTURE UNITS.
6. PLACEMENT OF PERMANENT EROSION CONTROL ITEMS, INCLUDING RIPRAP AND SEEDING.
7. CONSTRUCT NEW BRIDGE SUPERSTRUCTURE AND APPROACH ROADWAY.
8. FINAL GRADING AND OTHER MISCELLANEOUS ITEMS.

NOTES:
 ALL DITCH CHECKS SHALL BE AGGREGATE.
 FOR LAYOUT OF STONE RIPRAP AT BRIDGE, SEE SHT. 10 OF 13.

SCHEDULE OF EROSION CONTROL QUANTITIES

- EARTH EXCAVATION FOR EROSION CONTROL**
TOTAL = 59 CU. YD.
- TEMPORARY EROSION CONTROL SEEDING**
100 LBS/ACRE X 1.1 ACRES = 110 POUNDS
- SEEDING, CLASS 2**
AREA INSIDE OF CONSTRUCTION LIMITS, LESS ROADWAY.
TOTAL = 1.1 ACRES
- NITROGEN FERTILIZER NUTRIENT**
TOTAL = 99 POUNDS
- PHOSPHORUS FERTILIZER NUTRIENT**
TOTAL = 99 POUNDS
- POTASSIUM FERTILIZER NUTRIENT**
TOTAL = 99 POUNDS
- MULCH, METHOD 2**
TOTAL = 1.1 ACRES
- INLET AND PIPE PROTECTION**
21.0' RT., STA. 12+67.01 = 1 EACH
29.4' LT., STA. 13+87.73 = 1 EACH
TOTAL = 2 EACH
- PERIMETER EROSION BARRIER**
TO BE CONSTRUCTED AT LOCATIONS SHOWN ON PLANS. LAYOUT MAY VARY AS DIRECTED BY THE ENGINEER.
TOTAL = 524 FOOT
- TEMPORARY DITCH CHECK**
STA. 13+50, LT. & RT. = 2 EACH
STA. 14+50, LT. & RT. = 2 EACH
STA. 17+50, LT. & RT. = 2 EACH
STA. 18+50, LT. & RT. = 2 EACH
TOTAL = 8 EACH

STORM WATER POLLUTION PREVENTION AND EROSION CONTROL PLAN