

F.A.P. RTE.	SECTION	COUNTY	TOTAL SHEETS	SHEET NO.
777	10(B-1, BR-2)	MONTGOMERY	104	35
STA.		TO STA.		
FED. ROAD DIST. NO.		ILLINOIS FED. AID PROJECT		

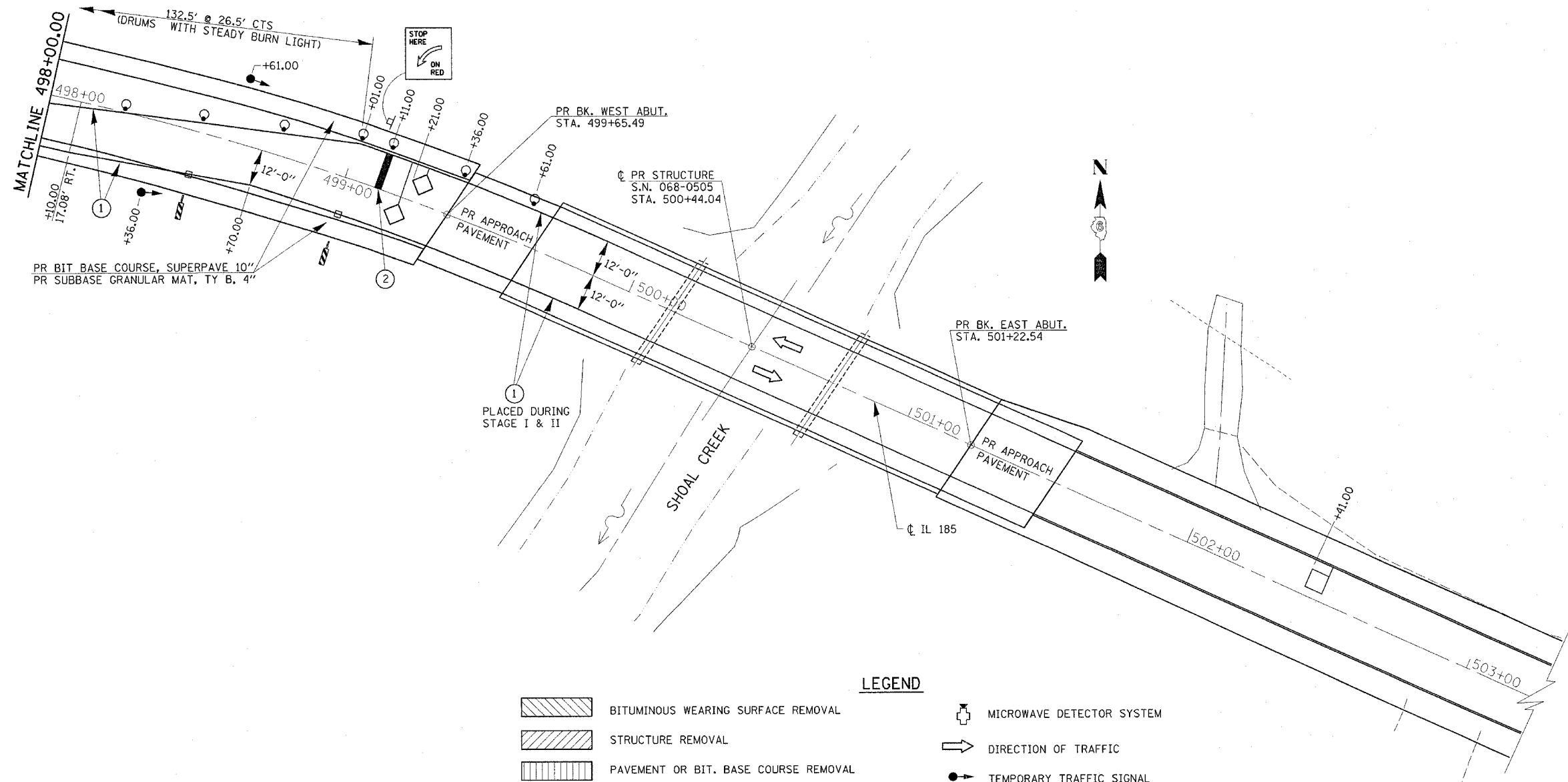

PR BIT BASE COURSE, SUPERPAVE 10"
PR SUBBASE GRANULAR MAT, TY B, 4"

1 PLACED DURING STAGE I & II

LEGEND

- BITUMINOUS WEARING SURFACE REMOVAL
- STRUCTURE REMOVAL
- PAVEMENT OR BIT. BASE COURSE REMOVAL
- EXISTING BITUMINOUS SHOULDER REMOVAL
- TEMPORARY CONCRETE BARRIER
- DOUBLE VERTICAL PANEL
- WHITE BI-DIRECTIONAL TEMP. PAVEMENT MARKER
- DRUM WITH STEADY BURN LIGHT
- MICROWAVE DETECTOR SYSTEM
- DIRECTION OF TRAFFIC
- TEMPORARY TRAFFIC SIGNAL
- INDUCTION LOOP DETECTOR
- TEMP. IMPACT ATTENUATOR (NON REDIRECT) TL 3
- TYPE III BARRICADE
- TEMPORARY PAVEMENT MARKING - LINE 5"
- TEMPORARY PAVEMENT MARKING - LINE 24"
- TEMP. IMPACT ATTENUATOR (FULLY REDIRECT NARROW) TL 3

PLOT DATE = 1/23/2006
FILE NAME = c:\p\objects\453851\stage.dgn
PLOT SCALE = 20.0000 / IN.
USER NAME = slobiert

REVISIONS	
NAME	DATE

ILLINOIS DEPARTMENT OF TRANSPORTATION
MAINTENANCE OF TRAFFIC & STAGING PLANS
STAGE III
 FAP 777 (IL RTE. 185)
 SECTION 10(B-1, BR-2)
 MONTGOMERY COUNTY

SCALE: VERT. _____
 HORIZ. _____
 DATE _____

DRAWN BY RTS
 CHECKED BY _____