

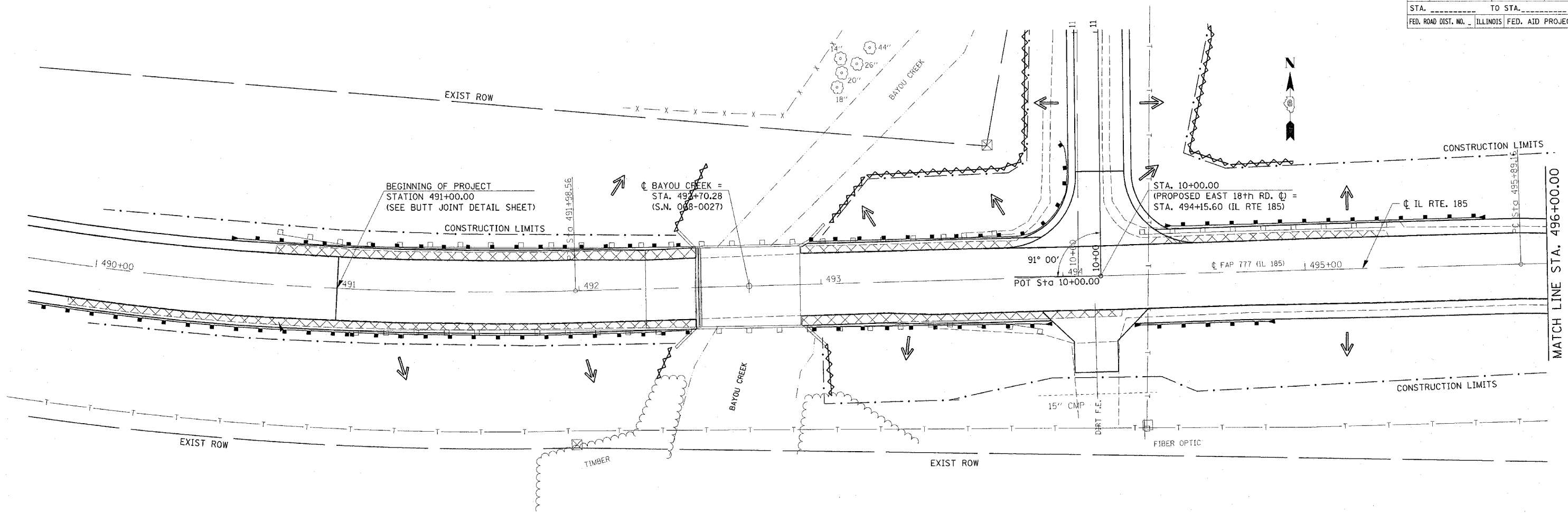







F.A.R. RTE.	SECTION	COUNTY	TOTAL SHEETS	SHEET NO.
177	10(B-1, BR-2)	MONTGOMERY	104	17
STA. _____		TO STA. _____		
FED. ROAD DIST. NO. _____		ILLINOIS FED. AID PROJECT		

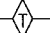
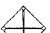

LEGEND FOR STORM WATER POLLUTION PREVENTION PLAN

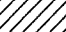
-  AGGREGATE (EROSION CONTROL)
[STONE DUMPED RIPRAP DITCH CHECKS: Height = 2'-0"]
-  TEMPORARY DITCH CHECKS
(HAY OR STRAW BALE DITCH CHECKS OR APPROVED SUBSTITUTION)
-  INLET PIPE PROTECTION (I&PP)
(HAY OR STRAW BALE DITCH CHECKS OR APPROVED SUBSTITUTION)
-  EROSION CONTROL FENCE
-  EARTH EXCAVATION FOR EROSION CONTROL
(SEDIMENT BASINS)
-  PRESERVE EXISTING TREES,
WOODLANDS, AND UNDERSTORY
(OUTSIDE CONSTRUCTION LIMITS)
-  * ITEM *
ITEM PLACED AT BEGINNING OF
CONSTRUCTION (Requirement)
-  ITEM
ITEM PLACED AS DIRECTED BY
ENGINEER (When required by situation)
-  →
DIRECTION OF OVERLAND FLOW

GENERAL NOTES

All items shall be constructed as shown on this sheet, on Standard 280001, and as directed by the Engineer.

The symbology on the STORM WATER POLLUTION PREVENTION PLAN sheets does not represent the size or quantity of bales, for number of bales refer to details and notes shown on this sheet and/or as directed by the Engineer.

THE CONTRACTOR SHALL INSTALL DITCH CHECKS AS DIRECTED BY THE ENGINEER. IF THE ENGINEER ELECTS TO UTILIZE FLUSH RIPRAP DITCH CHECKS IN LIEU OF TEMPORARY DITCH CHECKS AS SHOWN ON THE FOLLOWING PLAN SHEETS, THE SPACING SHOULD BE DOUBLED.

REVISIONS	
NAME	DATE

ILLINOIS DEPARTMENT OF TRANSPORTATION
STORM WATER POLLUTION PREVENTION PLAN
 FAP 777 RTE. 185
 10(B-1, BR-2)
 MONTGOMERY COUNTY

SCALE: VERT. _____
 HORIZ. _____
 DATE _____

DRAWN BY R.T.S.
 CHECKED BY _____

PLOT DATE = 1/9/2006
 FILE NAME = c:\projects\ed56594\hwp\p28.dgn
 PLOT SCALE = 20,000 / IN.
 USER NAME = slgler