

INDEX OF SHEETS

- 1 COVER SHEET
- 2 PLAN & PROFILE
- 3 CROSS SECTIONS
- 4-10 BRIDGE PLANS

STANDARDS: 280001-02 - EROSION CONTROL
(SEE PROPOSAL) 702001-05 - TRAFFIC
BLR 21-6 - TRAFFIC
BLR 22-4 - TRAFFIC

STATE OF ILLINOIS
DEPARTMENT OF TRANSPORTATION
DIVISION OF HIGHWAYS
PLANS FOR PROPOSED
FEDERAL-AID B.R.R. PROGRAM
LAWRENCE COUNTY
SECTION 05-02126-00-BR
BOND ROAD DISTRICT
STRUCTURE NO. 051-3276
PROJECT NO. BROS-101(23)
JOB NO. C-97-026-06
TR 47

SCALES

PLAN 1 INCH = 50 FEET
PROFILE HORZ. 1 INCH = 50 FEET
PROFILE VERT. 1 INCH = 10 FEET
CROSS SECTION 1 INCH = 5 FEET

SUMMARY OF QUANTITIES			
QTY	UNIT	ITEM	XX00-2A CODE NO
240	TON	AGGREGATE SURFACE COURSE, TYPE B (CA-6)	XX003658
120	TON	AGGREGATE SURFACE COURSE, TYPE B (CA-9)	XX003659
0.5	ACRE	TREE REMOVAL, ACRES	20100500
300	CU YD	EARTH EXCAVATION	20200100
92	CU YD	CHANNEL EXCAVATION	20300100
399	CU YD	FURNISHED EXCAVATION	20400800
0.50	ACRE	SEEDING, CLASS 2 (SPECIAL)	25001000
4	EACH	TEMPORARY DITCH CHECKS	28000300
80	FOOT	PERIMETER EROSION BARRIER	28000400
90	TON	STONE DUMPED RIPRAP, CLASS A4	28100807
48	TON	STONE RIPRAP DITCH	28102600
1	EACH	REMOVAL OF EXISTING STRUCTURES	50100100
19.8	CU YD	CONCRETE STRUCTURES	50300225
1400	SQ FT	PRECAST PRESTRESSED CONCRETE DECK BEAMS (21" DEPTH)	50400405
1940	POUND	REINFORCEMENT BARS	50800105
100	FOOT	STEEL RAILING, TYPE S1	50900205
594	FOOT	FURNISHING STEEL PILES HP10X42	51201400
594	FOOT	DRIVING STEEL PILES	51202700
1	EACH	TEST PILE STEEL HP 10X42	51203400
2.6	CU YD	CONCRETE ENCASEMENT	51204315
1	EACH	NAME PLATES	51500100
1	L SUM	MOBILIZATION	67100100
1	L SUM	TRAFFIC CONTROL AND PROTECTION	70101700

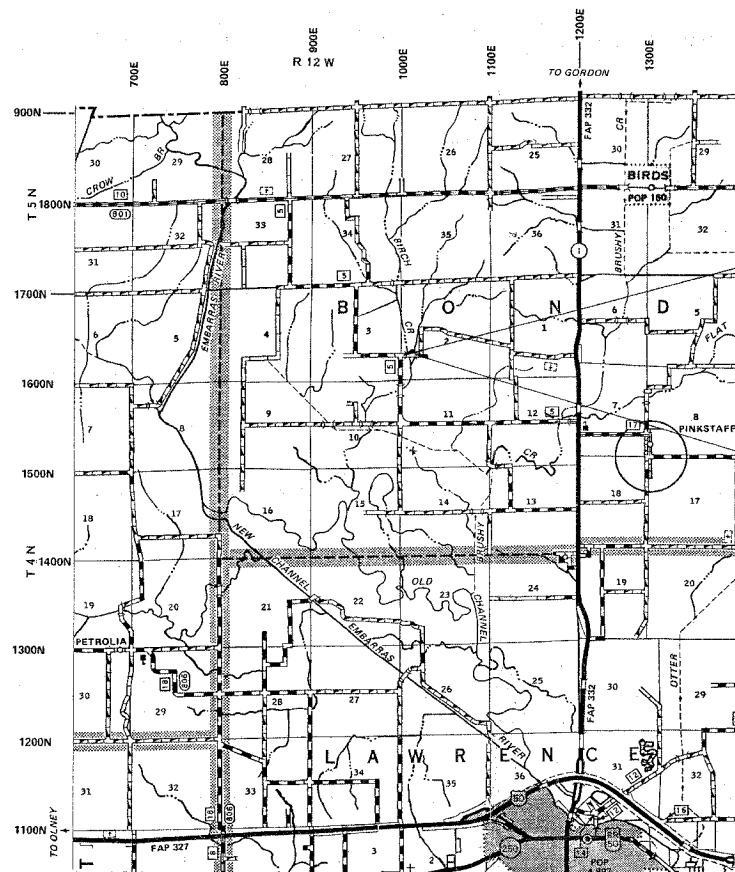

SECTION 05-02126-00-BR
BEGINS STA. 4+00

STA. 6+30 - STANDARD BRIDGE DESIGN
PROPOSED PRECAST PRESTRESSED CONCRETE DECK
BEAM BRIDGE. 1 SPAN @ 50'. 28' RDWY., SKEW = 0'
EXISTING STR. NO. 051-3057
PROPOSED STR. NO. 051-3276

SECTION 05-02126-00-BR
ENDS STA. 8+50

FUNCTIONAL CLASS: RURAL LOCAL ROAD
ADT = 50
DESIGN SPEED = 30 MPH

CONTRACT NO. 95452

LOCATION MAP

APPROXIMATE SCALE: 1 INCH = 1 MILE
NET LENGTH = 450 L.F. = 0.085 MILES

TOLL FREE JOINT UTILITY LOCATING
INFORMATION FOR EXCAVATORS (J.U.L.I.E.)
TELEPHONE NO. 1-800-892-0123

PROFESSIONAL DESIGN FIRM #184-000832

Michael J. ... 10/26/2005
ILLINOIS REGISTERED PROFESSIONAL ENGINEER # 31350
LICENSE EXPIRES NOVEMBER 30, 2007

APPROVED 10/27, 2005

[Signature]
LOCAL AGENCY REPRESENTATIVE

PASSED 12-23, 2005

Manuel E. Kattl
DISTRICT SEVEN ENGINEER
OF LOCAL ROADS & STREETS

RELEASING FOR BID BASED ON LIMITED REVIEW

12/23, 2005

Christie M. Reed
DEPUTY DIRECTOR OF HIGHWAYS
REGION FOUR ENGINEER
STATE OF ILLINOIS
DEPARTMENT OF TRANSPORTATION