

ROUTE NO.	SECTION	COUNTY	TOTAL SHEETS	SHEET NO.
*	LAWRENCE	10	4	

\*05-02126-00-BR

B.M.

Existing Structure

Salvage- SEE SPECIAL PROVISIONS

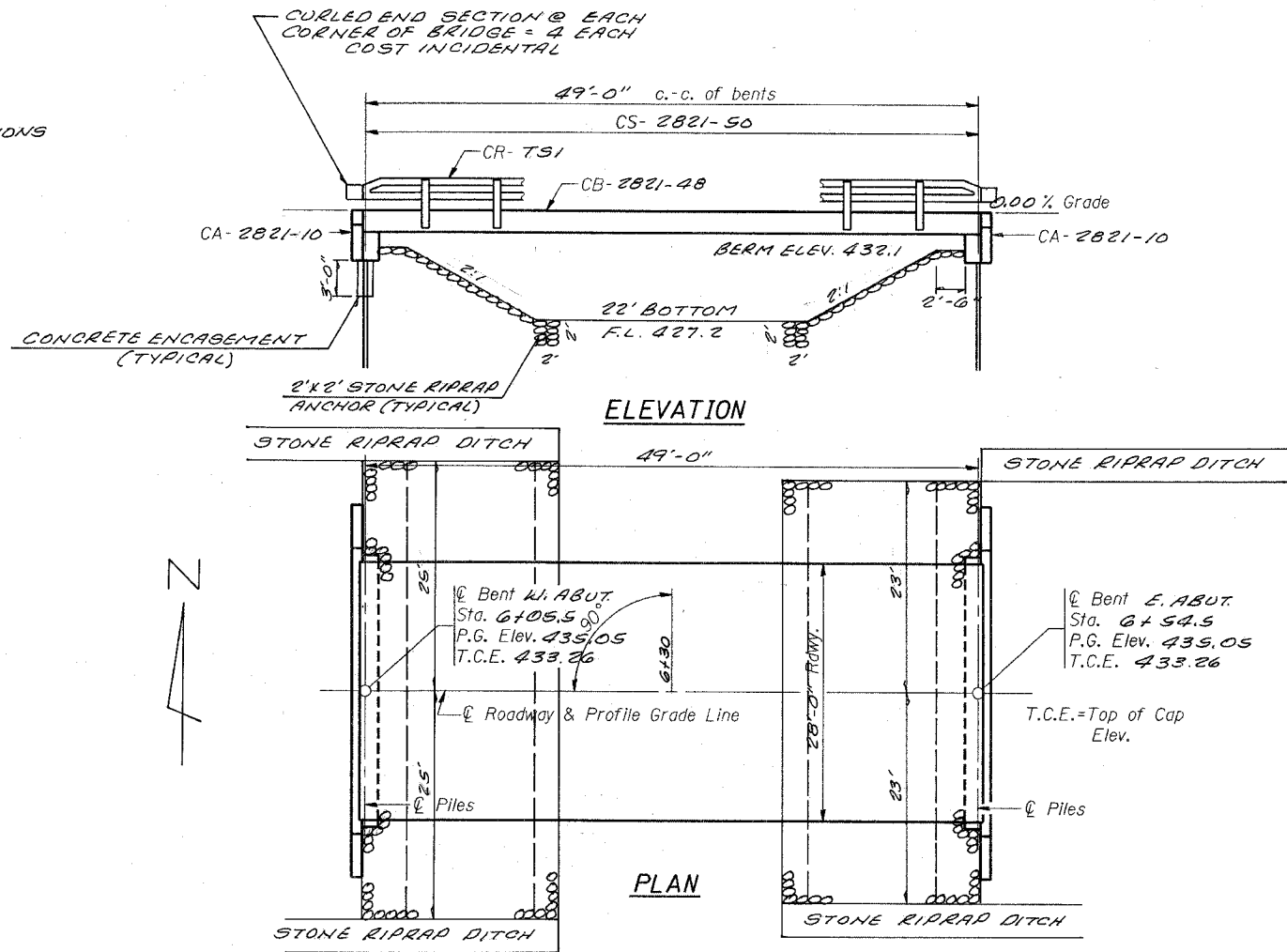

**GENERAL NOTES**

1. The Contractor shall drive 1 test piles, as specified, in a permanent location as directed by the Engineer before ordering the remaining piles.
2. See Special Provisions for boring logs.
3. ~~A Calcium Nitrite Corrosion inhibitor, as covered in the Special Provisions, shall be used in the concrete for precast prestressed concrete deck beams.~~

**TOTAL BILL OF MATERIAL**

Item	Unit	Super	Sub.		Total
			Piers	Abuts.	
Removal of Existing Structures	Each				1
Bituminous Concrete Surface Course, Class I	Ton				
Waterproofing Membrane System	Sq. Yd.				
Concrete Structures	Cu. Yd.			19.8	19.8
Precast Prestressed Concrete Deck Beams (21" Depth)	Sq. Ft.	1400			1400
Steel Bridge Rail, Type SM	Foot				
Steel Railing, Type S-1	Foot	100			100
Reinforcement Bars	Pound			1940	1940
Furnishing STEEL PILES HP 10 X 42	Foot			594	594
Driving STEEL PILES	Foot			594	594
Test Piles STEEL HP 10 X 42	Each			1	1
Name Plates	Each			1	1
Class I Concrete Encasement	Cu. Yd.			2.6	2.6
STONE DUMPED RIPRAP, CLASS A4	TON				90

STONE RIPRAP DITCH CLASS A4 = 90 TON  
MINIMUM THICKNESS = 12"

STATION 6+30  
BIRCH CREEK  
SEC. 05-02126-00-BR BUILT 200  
PROJ. NO. BROS 101(23)  
LAWRENCE COUNTY  
LOADING HS20  
STR. NO. 051-3276

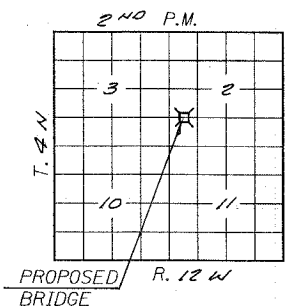

LOCATION SKETCH

**PILE DATA (2-ABUTS.)**

Type STEEL HP 10 X 42  
Capacity REFUSAL Tons  
Estimated Length 66 Feet  
Number Required 10 (Includes 1 Test Pile located in Bent #1) WEST ABUT.

**LETTERING FOR NAME PLATE**

Locate Name Plate at S.W. Corner of Bridge (See Std. CN)

**WATERWAY INFORMATION**

Drainage Area = 5.22 SQ. MI. Low Grade Elev. = 432.1 @ Sta. 4+00

Flood	Freq. Yr.	Q C.F.S.	Opening Sq. Ft.		Nat. H.W.E.	Head - Ft.		Headwater El.	
			Exist.	Prop.		Exist.	Prop.	Exist.	Prop.
Design	15	1275	52,120	84,155	432.10	0.1	0.2	432.2	432.3
Base	100	2059	84,152	85,172	432.50	0.2	0.3	432.7	432.8
Overtopping									
Max. Calc.	500								

**DESIGN SPECIFICATIONS**

1992 AASHTO, 1993 & 1994 Interims  
HS20-44 Loading, Load Factor Design.

**INDEX OF SHEETS**

1. General Plan & Elevation
2. Standard CS - 2821 - 50
3. Standard CB - 2821 - 48
4. Standard CA - 2821 - 10
5. Standard CR - 791
6. Standard CN
7. Standard CX - 1
8. Standard
9. Standard

**GENERAL PLAN & ELEVATION**

T.R. ROUTE 47  
OVER BIRCH CREEK  
SECTION 05-02126-00-BR  
LAWRENCE COUNTY  
STATION 6+30