

KEYMAP

THIS SHEET

CA002
 K:\SpringfieldAp\0503507\Draw\Sheets
 FILE: 31_JNT02.dwg
 UPDATE BY: Dove Allen
 PLOT DATE: 2/6/2006 4:33 PM
 KEY
 BASE_PROPGEO
 BASE_EXISTTOPO
 tbinfo
 BASE_PROPJOINT

REVISIONS		
NUMBER	BY	DATE

0 1 2
 THIS BAR IS EQUAL TO 2"
 AT FULL SCALE (34X22).

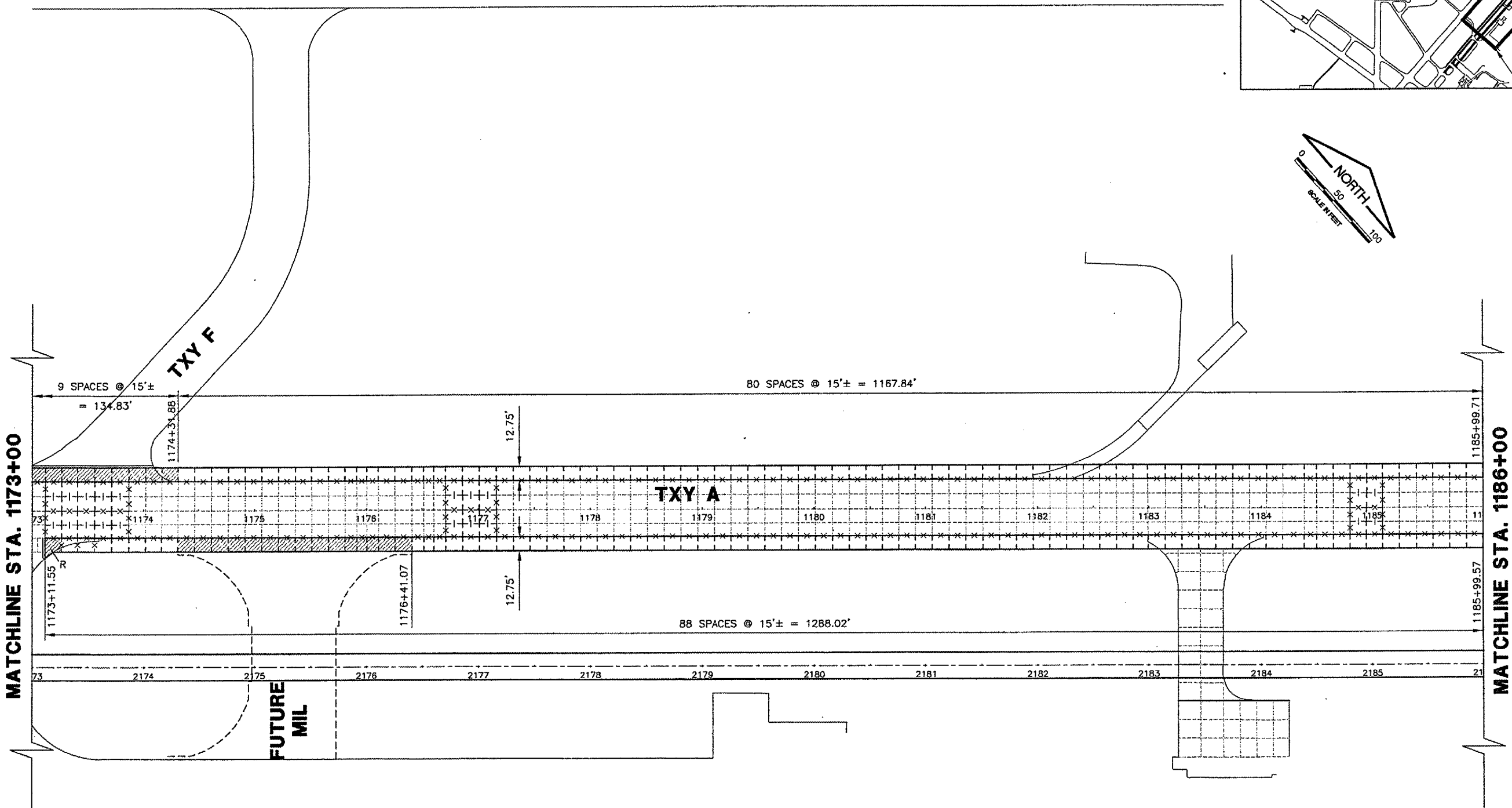

MATCHLINE STA. 1173+00

MATCHLINE STA. 1186+00

LEGEND

- TYPE B EXPANSION JOINT
- THICKENED EDGE
- TYPE D (DOWELED)
- TYPE F (DOWELED)
- TYPE G HINGED (TIED)
- TYPE H (DUMMY)
- REINFORCED PANEL
- EXISTING JOINT
- FUTURE PAVEMENT

NOTES:

AT LOCATIONS WHERE NEW 13" PCC ABUTS AN EXISTING 10" PCC SURFACE, DOWEL BARS FOR THE NEW TYPE D (DOWELED) CONSTRUCTION JOINT SHALL BE SIZED FOR THE 10" PAVEMENT (T=10")

SPRINGFIELD AIRPORT AUTHORITY
 ABRAHAM LINCOLN CAPITAL AIRPORT
 SPRINGFIELD, ILLINOIS

WIDEN TAXIWAY A - CONSTRUCT PERIMETER ROAD
 JOINTING PLAN 2

© Copyright CMT, Inc.
CMT
 CRAWFORD, MURPHY & TILLY, INC.
 CONSULTING ENGINEERS
 License No. 784-000618

DESIGN BY:	RLV
DRAWN BY:	DPA
CHECKED BY:	RLV
APPROVED BY:	RLV
DATE:	1/23/06
JOB No:	0503507
IL. PROJ. NO.	SPI-3555
AIP PROJ. NO.	3-17-0096-44
SHEET 31 OF 83 SHEETS	