

CA002  
 K:\SpringfieldAp\0503507\Draw\Sheets  
 FILE: 51\_ELEC01.dwg  
 UPDATE BY: Dove Allen  
 PLOT DATE: 2/6/2006 4:39 PM  
 BASE\_PROGCEO  
 BASE\_EXISTTOPO  
 KEY  
 BASE\_PROPELEC  
 tbinfo

REVISIONS		
NUMBER	BY	DATE

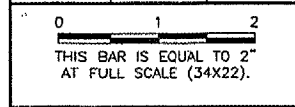

**LEGEND**

- EXISTING STAKE MOUNTED TAXIWAY LIGHT
- ◻ EXISTING BASE MOUNTED RUNWAY LIGHT
- ◻ EXISTING BASE MOUNTED TAXIWAY LIGHT
- ◻ NEW BASE MOUNTED TAXIWAY LIGHT
- ⊙ EXISTING FLUSH MOUNTED RUNWAY EDGE LIGHT
- RP EXISTING AIRFIELD SIGN (SIGN PANELS TO BE REPLACED)
- ◻ NEW AIRFIELD SIGN
- ⊙ EXIST. SPLICE CAN
- ⊙ NEW SPLICE CAN
- ▬ EXISTING DUCT BANK
- ▬ NEW DUCT BANK
- ▬ NEW 4" SPLIT DUCT
- ▬ EXISTING CABLE
- ▬ NEW CIRCUIT #3
- ▬ NEW CIRCUIT #7
- EXISTING FO CABLE
- NEW FO CABLE
- R REMOVE

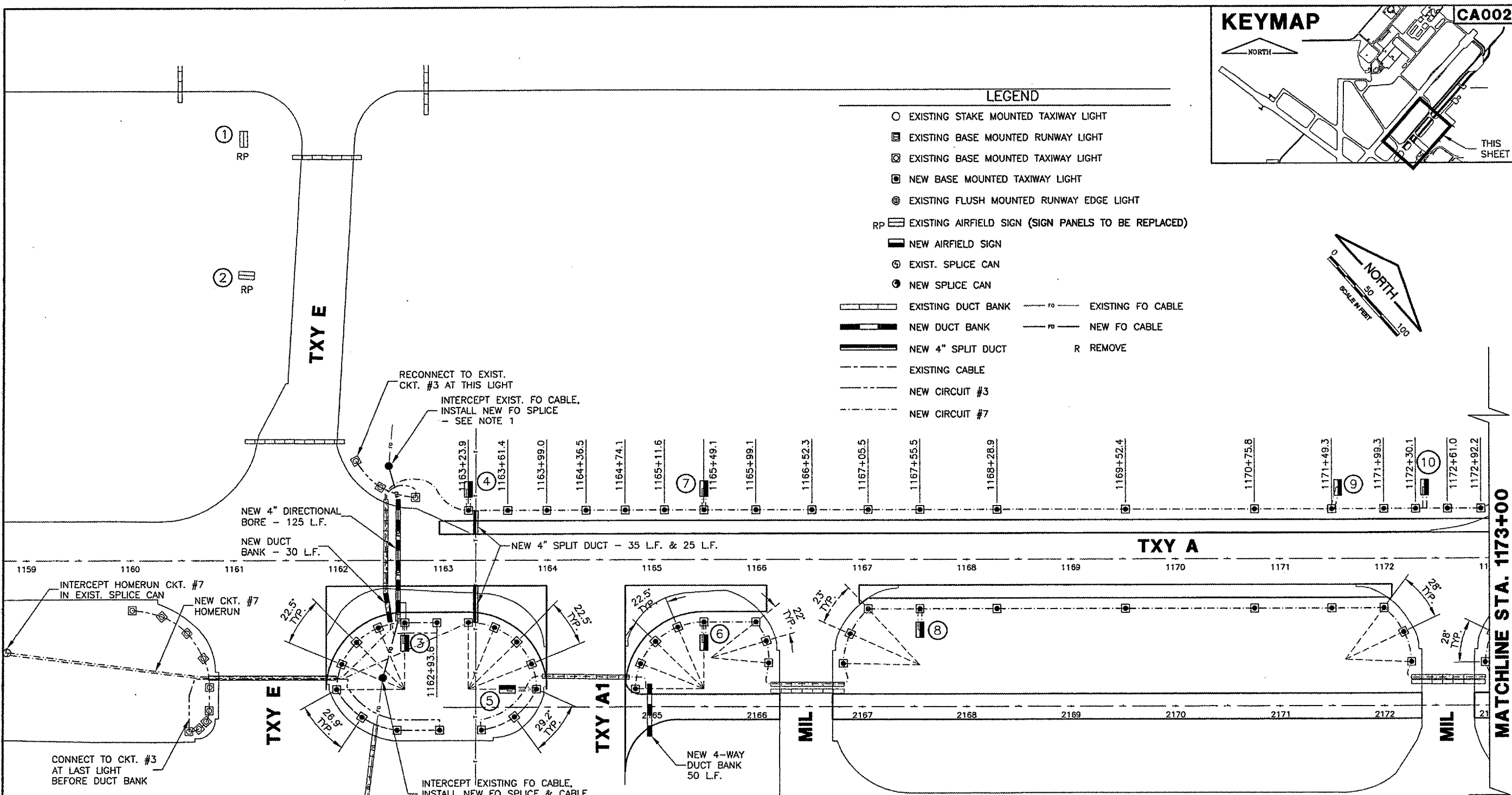

SIGN	STATION
1	NO CHANGE
2	NO CHANGE
3	1162+50.84
4	1163+23.90
5	125' RT.
6	1165+49.10
7	1165+49.10
8	1167+47.50
9	1171+55.42
10	1172+39.08

**ILLINOIS AIR  
 NATIONAL  
 GUARD**

**NOTES:**

1. DUE TO SECURITY CONSIDERATIONS, THE OUTAGE TIME FOR THE FIBER-OPTIC CABLE SHALL BE MINIMIZED. OUTAGE SHALL BE COORDINATED 3 DAYS PRIOR TO PERFORMING WORK.

**SPRINGFIELD AIRPORT AUTHORITY  
 ABRAHAM LINCOLN CAPITAL AIRPORT  
 SPRINGFIELD, ILLINOIS**

**WIDEN TAXIWAY A - CONSTRUCT PERIMETER ROAD  
 ELECTRICAL & LIGHTING PLAN 1**

© Copyright GMT, Inc.  
**GMT**  
 CRAWFORD, MERRY & TILLY, INC.  
 CONSULTING ENGINEERS  
 License No. 194-00615

DESIGN BY: MB/KLB  
 DRAWN BY: DPA  
 CHECKED BY: *RLM*  
 APPROVED BY: *RLM*  
 DATE: 1/23/06  
 JOB No: 0503507  
 IL PROJ. NO. SPI-3555  
 AIP PROJ. NO. 3-17-0096-44  
 SHEET 51 OF 83 SHEETS