

- NOTES:**
- 1.) CROSS SECTION SLOPES, CENTERLINE PROFILE GRADES, AND ALL SPOT GRADES SHALL BE SUBJECT TO CHANGE, AS DIRECTED BY THE RESIDENT ENGINEER, AT THE TIME OF CONSTRUCTION.
 - 2.) GRADES SHOWN ON THIS SHEET AT EDGE OF PAVEMENT ARE PROPOSED SURFACE ELEVATIONS OF PAVEMENT. PROPOSED EARTH SHOULDER FINAL GRADE AT EDGE OF PAVMT. IS 0.125' BELOW EDGE OF PROPOSED PAVEMENT GRADE.
 - 3.) SEE CROSS SECTIONS FOR SURFACE ELEVATIONS OF THE PROPOSED GROUND IN THE SHOULDER AREA.
 - 4.) 76.80 = PROPOSED ELEVATION 576.80.
 - 5.) 576.60 = EXISTING ELEVATION 576.60.

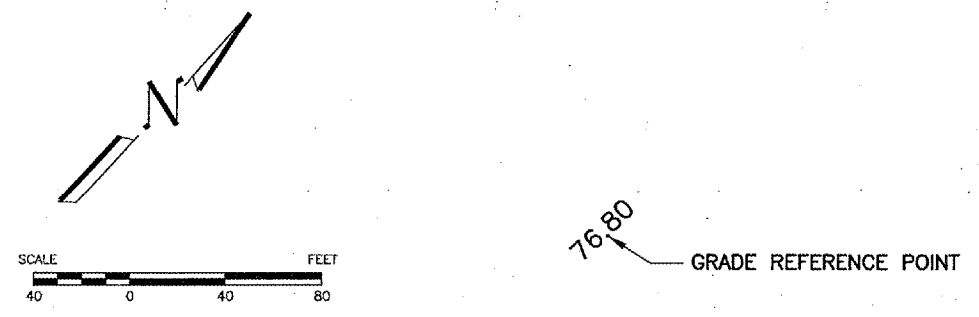

G:\Airport\A05T028\STAKING.dwg, 1/20/2006 8:35:45 AM, jeffm