

STATE OF ILLINOIS
DEPARTMENT OF TRANSPORTATION

** = 710 & 710 1

F.A.P. RTE.	SECTION	COUNTY	TOTAL SHEETS	SHEET NO.
**	D7 PATCHING 2023-6	MACON	20	1
		ILLINOIS	CONTRACT NO. 74B58	

D97-001-23

FOR INDEX OF SHEETS, SEE SHEET NO. 2

PROPOSED
HIGHWAY PLANS

FAP ROUTE 710 (OLD US 51)
SECTION D7 PATCHING 2023-6
PARTIAL WIDTH RESURFACING
MACON COUNTY

C-97-001-23

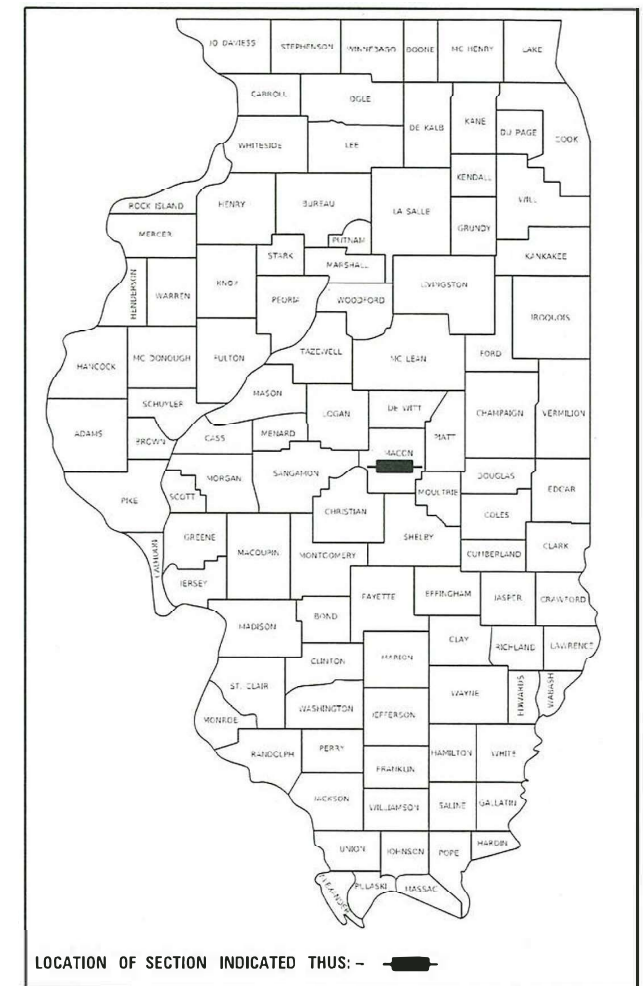

END OF JOB
OLD US 51
NORTH/SOUTH BOUND

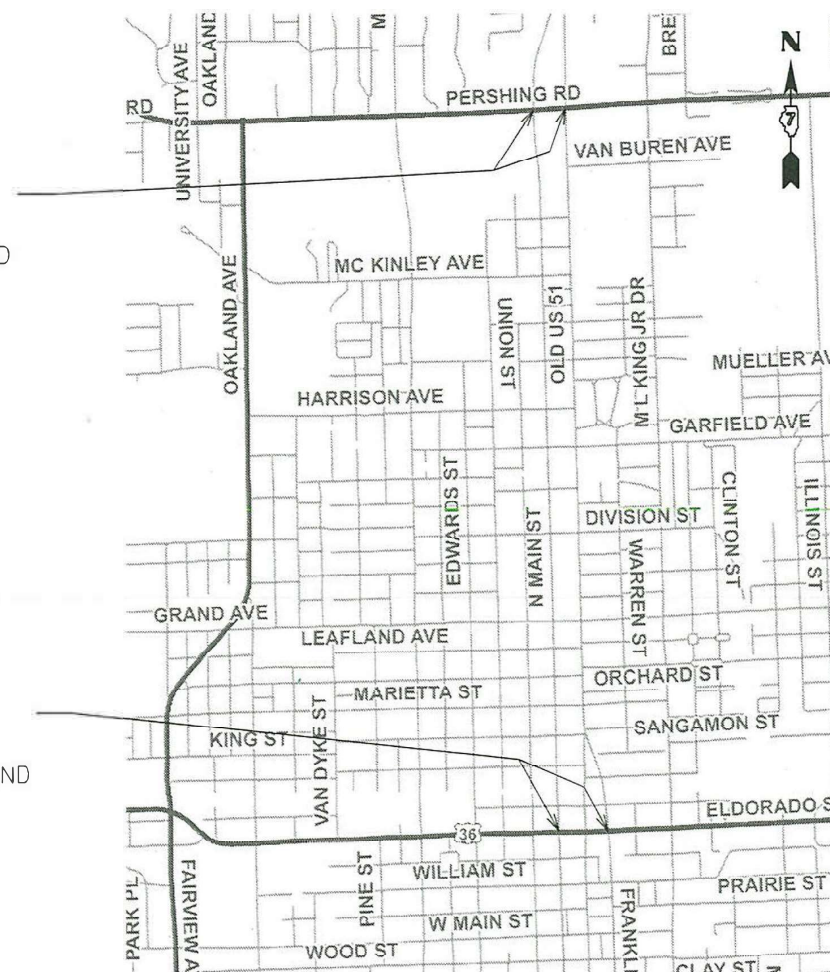

START OF JOB
OLD US 51
NORTH/SOUTH BOUND

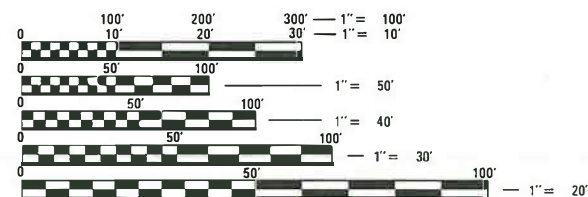

FULL SIZE PLANS HAVE BEEN PREPARED USING STANDARD ENGINEERING SCALES. REDUCED SIZED PLANS WILL NOT CONFORM TO STANDARD SCALES. IN MAKING MEASUREMENTS ON REDUCED PLANS, THE ABOVE SCALES MAY BE USED.

J.U.I.E.
JOINT UTILITY LOCATION INFORMATION FOR EXCAVATORS
1-800-892-0123
OR 811

PROJECT ENGINEER DEBRA BARRETT
PROJECT MANAGER KYLE PRICE

CONTRACT NO. 74B58

STATE OF ILLINOIS
DEPARTMENT OF TRANSPORTATION

SUBMITTED DECEMBER 22 20 22
Jeffrey P. Myrks
REGIONAL ENGINEER

February 3, 2023
Scott A. Etk
ENGINEER OF DESIGN AND ENVIRONMENT

February 3, 2023
Stephen M. Smith
DIRECTOR OF HIGHWAYS PROJECT IMPLEMENTATION

PRINTED BY THE AUTHORITY
OF THE STATE OF ILLINOIS

INDEX OF SHEETS

1	COVER SHEET
2	GENERAL NOTES / INDEX OF SHEETS
3	SUMMARY OF QUANTITIES
4-5	SCHEDULE OF QUANTITIES
6	JOB LOCATION PLAN VIEW
7-14	PLAN VIEWS OLD US 51 SOUTH BOUND
15-16	PLAN VIEWS OLD US 51 NORTH BOUND
17-20	DISTRICT STANDARD 78000001

GENERAL NOTES

THIS PROJECT IS LOCATED ON FAP 710 AND FAP 710 1 (OLD US 51 NORTH AND SOUTH BOUND) IN MACON COUNTY, BETWEEN PERSHING (ILL 121) AND ELDORADO (US 36). THE WORK INCLUDED IN SECTION D7 PATCHING 2023-6 CONSISTS OF MILLING SELECT LOCATIONS AND RESURFACING AND ALL OTHER WORK NECESSARY TO COMPLETE THIS SECTION.

SHORT TERM PAVEMENT MARKING SHALL BE TAPE.

THE ACTUAL LOCATIONS OF PAVEMENT RESURFACING AND FINAL QUANTITIES SHALL BE DETERMINED BY THE ENGINEER IN THE FIELD.

ALL MILLED LOCATIONS SHALL BE FILLED WITH HMA AND FINISHED IN THE SAME WORK PERIOD. NO MILLED LOCATIONS WILL BE LEFT OVERNIGHT WITH THE 1.5 INCH DROP OFF.

THERMOPLASTIC PAVEMENT MARKINGS WILL NOT BE GROOVED INTO THE PAVEMENT.

THE FOLLOWING MIXTURE REQUIREMENTS ARE APPLICABLE FOR THIS PROJECT:

APPLICATION	AC/PG	DESIGN AIR VOIDS	MIXTURE COMPOSITION	FRICTION AGGREGATE	QUALITY MANAGEMENT
POLYMERIZED HMA SURFACE COURSE, IL-9.5, MIX "D", N90	SBS PG 70-22	4.0% @ N=90	IL - 9.5	MIXTURE D	QC/QA

THE FOLLOWING STANDARDS ARE A PART OF THESE PLANS AND ARE INCLUDED FOLOWING THE LAST NUMBERED SHEET OF THE PLANS.

<u>STD. NO.</u>	<u>DESCRIPTION</u>
000001 - 08	STANDARD SYMBOLS, ABBREVIATIONS, AND PATTERNS
001006	DECIMAL OF AN INCH AND OF A FOOT
667101 - 02	PERMANENT SURVEY MARKERS
701427 - 05	LANE CLOSURE, MULTILANE, INTERMITTENT OR MOVING OPERATION, FOR SPEEDS ≤ 40 MPH
701601 - 09	URBAN LANE CLOSURE, MULTILANE, 1W OR 2W WITH NONTRAVERSABLE MEDIAN
701701 - 10	URBAN LANE CLOSURE, MULTILANE INTERSECTION
701901 - 08	TRAFFIC CONTROL DEVICES
780001 - 05	TYPICAL PAVEMENT MARKINGS
781001 - 04	TYPICAL APPLICATIONS RAISED REFLECTIVE PAVEMENT MARKERS
886001 - 01	DETECTOR LOOP INSTALLATIONS
886006 - 01	TYPICAL LAYOUTS FOR DETECTION LOOPS

THE FOLLOWING RATES OF APPLICATION HAVE BEEN USED IN CALCULATING PLAN QUANTITIES:

HOT MIX ASPHALT	112 LB/SQ YD/IN
BITUMINOUS MATERIALS (TACK COAT)	
MILLED SURFACE	0.05 LB/SQ FT
BETWEEN HMA LIFTS	0.025 LB/SQ FT
GRANULAR MATERIAL	2.05 TONS/CU YD

REV. - MS

** = 710 & 710 1

MODEL: D:\default
 FILE: Macos: p:\illinois\paw_bentley.com\p\illinois\Documents\DOT_Offices\District_7\Project\74858\CADD\Drawings\CAD\Sheet\DOT_74858-11b-general.dgn

USER NAME = Jessica.Hille	DESIGNED -	REVISED -	STATE OF ILLINOIS DEPARTMENT OF TRANSPORTATION	GENERAL NOTES AND INDEX OF SHEETS		F.A.P. RTE.	SECTION	COUNTY	TOTAL SHEETS	SHEET NO.	
PLOT SCALE = 100.0000' / in.	DRAWN -	REVISED -				**	D7 PATCHING 2023-6	MACON	20	2	
PLOT DATE = 12/22/2022	CHECKED -	REVISED -		SCALE:		SHEET OF SHEETS	STA.	TO STA.	ILLINOIS FED. AID PROJECT		
	DATE -	REVISED -									

URBAN

URBAN

SUMMARY OF QUANTITIES			TOTAL QUANTITIES	CONSTRUCTION TYPE CODE		
CODE NO	ITEM	UNIT		MACON CO 0006 100% STATE		
40600275	BITUMINOUS MATERIALS (PRIME COAT)	POUND	5125	5125		
40604164	POLYMERIZED HOT-MIX ASPHALT SURFACE COURSE, IL-9.5, MIX "D", N90	TON	957	957		
44000155	HOT-MIX ASPHALT SURFACE REMOVAL, 1 1/2"	SO YD	11389	11389		
67100100	MOBILIZATION	L SUM	1	1		
70102630	TRAFFIC CONTROL AND PROTECTION, STANDARD 701601	L SUM	1	1		
70102635	TRAFFIC CONTROL AND PROTECTION, STANDARD 701701	L SUM	1	1		
70107025	CHANGEABLE MESSAGE SIGN	CAL DA	28	28		
70300100	SHORT TERM PAVEMENT MARKING	FOOT	1028	1028		
70300150	SHORT TERM PAVEMENT MARKING REMOVAL	SQ FT	343	343		
* 78000100	THERMOPLASTIC PAVEMENT MARKING - LETTERS AND SYMBOLS	SQ FT	47	47		
* 78000200	THERMOPLASTIC PAVEMENT MARKING - LINE 4"	FOOT	2570	2570		
* 78000400	THERMOPLASTIC PAVEMENT MARKING - LINE 6"	FOOT	664	664		
* 78000650	THERMOPLASTIC PAVEMENT MARKING - LINE 24"	FOOT	87	87		

SUMMARY OF QUANTITIES			TOTAL QUANTITIES	CONSTRUCTION TYPE CODE		
CODE NO	ITEM	UNIT		MACON CO 0006 100% STATE		
* 78100100	RAISED REFLECTIVE PAVEMENT MARKER	EACH	147	147		
78300200	RAISED REFLECTIVE PAVEMENT MARKER REMOVAL	EACH	147	147		
* 88600100	DETECTOR LOOP, TYPE I	FOOT	250	250		
Z0048665	RAILROAD PROTECTIVE LIABILITY INSURANCE	L SUM	1	1		
Z0049799	PROTECTING OR RESETTING SURVEY MARKERS	EACH	4	4		

* SPECIALTY ITEM

** = 701 & 701 1

REV. - MS

MODEL: Default
FILE: \\miller-dw-bentley.com\FN\DOT\Documents\DOT_Offices\District_7\Projects\74858\CADD\Drawings\CAD\Sheet\74858-eh-S00.dgn

USER NAME = Jessica.Hille	DESIGNED -	REVISED -
PLOT SCALE = 100.0000 ' / in.	DRAWN -	REVISED -
PLOT DATE = 12/22/2022	CHECKED -	REVISED -
	DATE -	REVISED -

STATE OF ILLINOIS
DEPARTMENT OF TRANSPORTATION

SUMMARY OF QUANTITIES

SCALE: SHEET OF SHEETS STA. TO STA.

F.A.P. RTE.	SECTION	COUNTY	TOTAL SHEETS	SHEET NO.
**	D7 PATCHING 2023-6	MACON	20	3
ILLINOIS FED. AID PROJECT			CONTRACT NO. 74858	

STATION	TO	STATION	LANE(S)	LENGTH	WIDTH	HOT-MIX ASPHALT SURFACE REMOVAL, 1 1/2"	POLYMERIZED HMA SURFACE COURSE, IL-9 5, MIX "D", N90	BITUMINOUS MATERIALS (PRIME COAT)
						44000155	40604164	40600275
US 51 BUSINESS SOUTH (MAIN ST)				FT	FT	SQ YD	TON	POUND
364+97.77		363+82.77	1	115	12	153	13	69
362+62.77		361+27.77	2	135	12	180	15	81
360+32.77		358+42.77	1,2,3	190	12	253	21	114
355+82.77		354+47.77	1,2,3	135	12	180	15	81
353+32.77		352+92.77	2	40	12	53	4	24
351+02.77		350+12.77	2	90	12	120	10	54
348+62.77		348+22.77	2	40	12	53	4	24
339+12.77		337+32.77	1	180	12	240	20	108
334+72.77		331+92.77	1	280	12	373	31	168
334+72.77		333+42.77	2	130	12	173	15	78
325+82.77		323+72.77	1	210	12	280	24	126
320+92.77		318+17.77	1	275	12	367	31	165
320+92.77		319+02.77	2	190	12	253	21	114
314+92.77		311+42.77	1	350	12	467	39	210
314+92.77		312+27.77	2	265	12	353	30	159
314+92.77		312+27.77	3	265	13	383	32	172
309+57.77		303+07.77	1	650	12	867	73	390
309+57.77		309+42.77	2	15	12	20	2	9
309+57.77		305+82.77	3	375	13	542	46	244
302+22.77		301+22.77	2	100	12	133	11	60
304+37.77		300+00.00	3	437.77	13	632	53	285
302+22.77		300+00.00	1	222.77	12	297	25	134
STA EQUATION 269+97.10 = 300+00.00								
269+97.10		261+76.29	3	820.81	13	1186	100	534
269+97.10		261+76.29	1	820.81	12	1094	92	492
STA EQUATION 257+28.09 = 261+76.29								
257+28.09		253+26.67	3	401.42	13	580	49	261
257+28.09		256+31.67	1	96.42	12	129	11	58
254+16.67		253+26.67	1	90	12	120	10	54
251+31.67		249+36.67	3	195	13	282	24	127
249+36.67		249+11.67	1	25	12	33	3	15
243+41.67		247+91.67	1	50	12	67	6	30
240+51.67		239+66.67	1,2,3	85	12	113	10	51
235+96.67		233+91.67	1	205	12	273	23	123
235+96.67		235+06.67	2	90	12	120	10	54
232+21.67		230+91.67	1,2,3	130	12	173	15	78
228+26.67		225+61.67	LT TURN LANE	265	12	353	30	159
US 51 BUSINESS NORTH (WATER ST)								
1241+21.00		1242+55.00	2,3,4	134	12	179	15	80
1251+30.00		1252+25.00	3	95	12	127	11	57
1253+60.00		1255+00.00	4	140	12	187	16	84
TOTALS				8334	462	11389	957	5125

** PLEASE NOTE THE LANES ARE NUMBERED LEFT TO RIGHT IN THE DIRECTION OF THE THE TRAFFIC FLOW.

STATION	OFFSET	DESCRIPTION	PROTECT OR RESET	Z0049799
364+77.19	0	PT - Mag Nail w/washer	TYPE I - DISK Flush	1
362+36.75	0	PI - Mag Nail w/washer	TYPE I - DISK Flush	1
359+95.69	0	PC - Mag Nail w/washer	TYPE I - DISK Flush	1
319+69.60	0	PI Kink - Mag Nail w/washer	TYPE I - DISK Flush	1
TOTAL				4

NUMBER OF TURNS REQUIRED IN DETECTOR LOOPS

		LOOP SIZE IN (FT)			NUMBER OF TURNS	
		6 X 6	6 X 30	6 X 40		
		DISTANCE FROM CONTROLLER (FT)				
		0	491	0	627	2 TURNS
		492	982	628	1255	3 TURNS
0	545	983	1636	1256	2091	4 TURNS
546	818	1637	2455	2092	3136	5 TURNS
819	1145	2456	3436			6 TURNS
1146	1527					7 TURNS
1528	1964					8 TURNS
1965	2455					9 TURNS
2456	3000					10 TURNS

** = 701 & 701 1

MODEL: Default
FILE: \\MAILSrv\public\paw_bentley.com\PI\DOT\Documents\DOT Office\Dir\dir_7\Project\74858\CADD\DATA\CAD\Sheet\74858-1-1-1.dwg

USER NAME = Jessica.Hille	DESIGNED -	REVISED -
	DRAWN -	REVISED -
PLOT SCALE = 100,0000 ' / in.	CHECKED -	REVISED -
PLOT DATE = 12/22/2022	DATE -	REVISED -

**STATE OF ILLINOIS
DEPARTMENT OF TRANSPORTATION**

SCHEDULE OF QUANTITIES

SCALE: SHEET OF SHEETS STA. TO STA.

F.A.P. RTE.	SECTION	COUNTY	TOTAL SHEETS	SHEET NO.
**	D7 PATCHING 2023-6	MACON	20	4
			CONTRACT NO. 74858	
		ILLINOIS	FED. AID PROJECT	

MODEL: Default
 FILE: \\maile-pw-beadley.com\FW\DOT\Documents\DOT Office\Director_7\Project\74858\CADD\DATA\CAD\Sheet\74858-1-1-1-1.dwg

STATION	TO	STATION	LANE(S)	LENGTH	WIDTH	RAISED REFLECTIVE PAVEMENT MARKER REMOVAL	RAISED REFLECTIVE PAVEMENT MARKER	SHORT TERM PAVEMENT MARKING (4")	SHORT TERM PAVEMENT MARKING REMOVAL	THERMOPLASTIC PAVEMENT MARKING - LINE 4"	THERMOPLASTIC PAVEMENT MARKING - LINE 6"	THERMOPLASTIC PAVEMENT MARKING - LINE 24"	THERMOPLASTIC PAVEMENT MARKING - LETTERS AND SYMBOLS
						78300200	78100100	70300100	70300150	78000200	78000400	78000650	78000100
				FT	FT	EACH	EACH	FT	SQ FT	FT	FT	FT	SQ FT
US 51 BUSINESS SOUTH (MAIN ST)													
364+97.77		363+82.77	1	115	12	2	2	12	4.0	30			
362+62.77		361+27.77	2	135	12	4	4	32	10.7	80			
360+32.77		358+42.77	1,2,3	190	12	6	6	40	13.3	100			
355+82.77		354+47.77	1,2,3	135	12	4	4	32	10.7	80			
353+32.77		352+92.77	2	40	12	2	2	8	2.7	20			
351+02.77		350+12.77	2	90	12	4	4	24	8.0	60			
348+62.77		348+22.77	2	40	12	2	2	8	2.7	20			
339+12.77		337+32.77	1	180	12	3	3	20	6.7	50			
334+72.77		331+92.77	1	280	12	2	2	16	5.3	40			
334+72.77		333+42.77	2	130	12	4	4	32	10.7	80			
325+82.77		323+72.77	1	210	12	3	3	24	8.0	60			
320+92.77		318+17.77	1	275	12	2	2	12	4.0	30	48	12	
320+92.77		319+02.77	2	190	12	6	6	40	13.3	100	48	12	
314+92.77		311+42.77	1	350	12	2	2	12	4.0	30			
314+92.77		312+27.77	2	265	12	8	8	56	18.7	140			
314+92.77		312+27.77	3	265	13	0	0	0	0.0	0			
309+57.77		303+07.77	1	650	12	9	9	68	22.7	170			
309+57.77		309+42.77	2	15	12	0	0	0	0.0	0			
309+57.77		305+82.77	3	375	13	5	5	40	13.3	100			
302+22.77		301+22.77	2	100	12	4	4	24	8.0	60			
304+37.77		300+00.00	3	437.77	13	5	5	44	14.7	110			
302+22.77		300+00.00	1	222.77	12	2	2	24	8.0	60			
STA EQUATION 269+97.10 = 300+00.00													
269+97.10		261+76.29	3	820.81	13	11	11	84	28.0	210	48	12	
269+97.10		261+76.29	1	820.81	12	11	11	84	28.0	210	138	12	
STA EQUATION 257+28.09 = 261+76.29													
257+28.09		253+26.67	3	401.42	13	6	6	44	14.7	110	52	13	
257+28.09		256+31.67	1	96.42	12	2	2	12	4.0	30	48	12	
254+16.67		253+26.67	1	90	12	2	2	12	4.0	30			
251+31.67		249+36.67	3	195	13	3	3	20	6.7	50			
249+36.67		249+11.67	1	25	12	1	1	4	1.3	10			
243+41.67		242+91.67	1	50	12	1	1	8	2.7	20			
240+51.67		239+66.67	1,2,3	85	12	4	4	24	8.0	60			
235+96.67		233+91.67	1	205	12	2	2	12	4.0	30	24		
235+96.67		235+06.67	2	90	12	4	4	24	8.0	60	24		
232+21.67		230+91.67	1,2,3	130	12	4	4	32	10.7	80			
228+26.67		225+61.67	LT TURN LANE	265	12	7	7	28	9.3	70	234	14	46.8
US 51 BUSINESS NORTH (WATER ST)													
1241+21.00		1242+55.00	2,3,4	134	12	4	4	32	11	80			
1251+30.00		1252+25.00	3	95	12	4	4	24	8	60			
1253+60.00		1255+00.00	4	140	12	2	2	16	5	40			
			TOTAL	8334	462	147	147	1028	343	2570	664	87	47

** PLEASE NOTE THE LANES ARE NUMBERED LEFT TO RIGHT IN THE DIRECTION OF THE THE TRAFFIC FLOW.

** = 701 & 701 1

USER NAME = Jessica.Hille	DESIGNED -	REVISED -	STATE OF ILLINOIS DEPARTMENT OF TRANSPORTATION	SCHEDULE OF QUANTITIES				F.A.P. RTE.	SECTION	COUNTY	TOTAL SHEETS	SHEET NO.
DRAWN -	REVISED -	**						D7 PATCHING 2023-6	MACON	20	5	
PLOT SCALE = 100,0000 ' / in.	CHECKED -	REVISED -		CONTRACT NO. 74858				ILLINOIS FED. AID PROJECT				
PLOT DATE = 12/22/2022	DATE -	REVISED -		SCALE:	SHEET	OF	SHEETS	STA.	TO	STA.		



OLD US 51 SB & NB (BETWEEN ELDORADO & PERSHING)

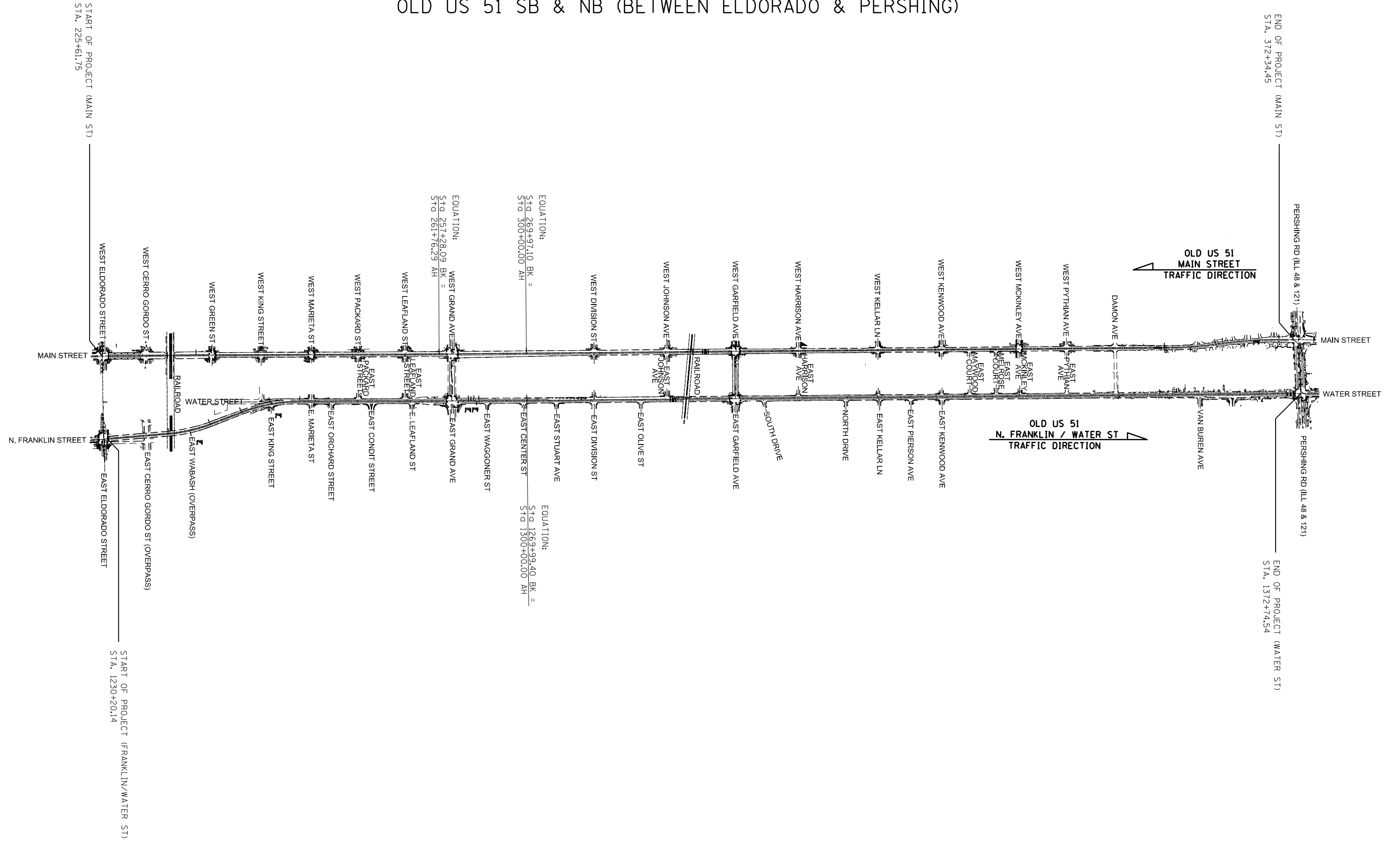

MODEL: Default
 FILE: Mainfile.pia\uldrct-aw-beadfw.com\FW\DOT\Documents\DOT Office\Dir\drct_7\Project\74858\CADD\DATA\CADD\Sheet\74858-shp-dt-2.dwg

USER NAME = Jessica.Hille	DESIGNED -	REVISED -
PLOT SCALE = 850,0000 ' / in.	DRAWN -	REVISED -
PLOT DATE = 12/22/2022	CHECKED -	REVISED -
	DATE -	REVISED -

**STATE OF ILLINOIS
DEPARTMENT OF TRANSPORTATION**

PLAN VIEW OF JOB LOCATION

SCALE: SHEET OF SHEETS STA. TO STA.

** = 701 & 701 1

F.A.P. RTE.	SECTION	COUNTY	TOTAL SHEETS	SHEET NO.
**	D7 PATCHING 2023-6	MACON	20	6
CONTRACT NO. 74858				
ILLINOIS		FED. AID PROJECT		

OLD US 51 SB (STA. 225+50 TO STA. 239+00)

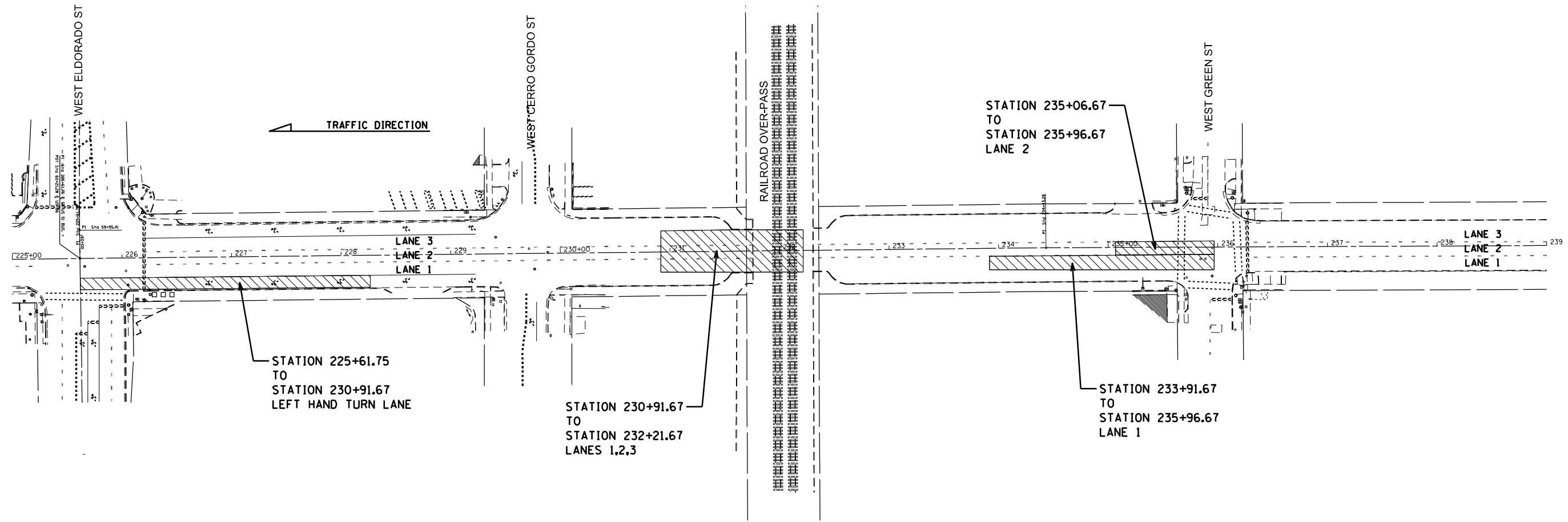
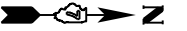

RESURFACING AREA =

** = 710 & 710 1

MODEL: Default
 FILE: Mainfile.pia
 PROJECT: 74858\CADD\DATA\CAD\PROJECTS\74858-PLAN.dwg
 PLOT DATE: 12/22/2022

USER NAME = Jessica.Hille	DESIGNED -	REVISED -
	DRAWN -	REVISED -
PLOT SCALE = 100,0000' / in.	CHECKED -	REVISED -
PLOT DATE = 12/22/2022	DATE -	REVISED -

**STATE OF ILLINOIS
DEPARTMENT OF TRANSPORTATION**

**PLAN VIEW - OLD US 51 SOUTH BOUND
MAIN STREET**

SCALE: SHEET OF SHEETS STA. TO STA.

F.A.P. RTE.	SECTION	COUNTY	TOTAL SHEETS	SHEET NO.
**	D7 PATCHING 2023-6	MACON	20	7
CONTRACT NO. 74858				
ILLINOIS FED. AID PROJECT				

OLD US 51 SB (STA. 239+00 TO STA. 253+00)

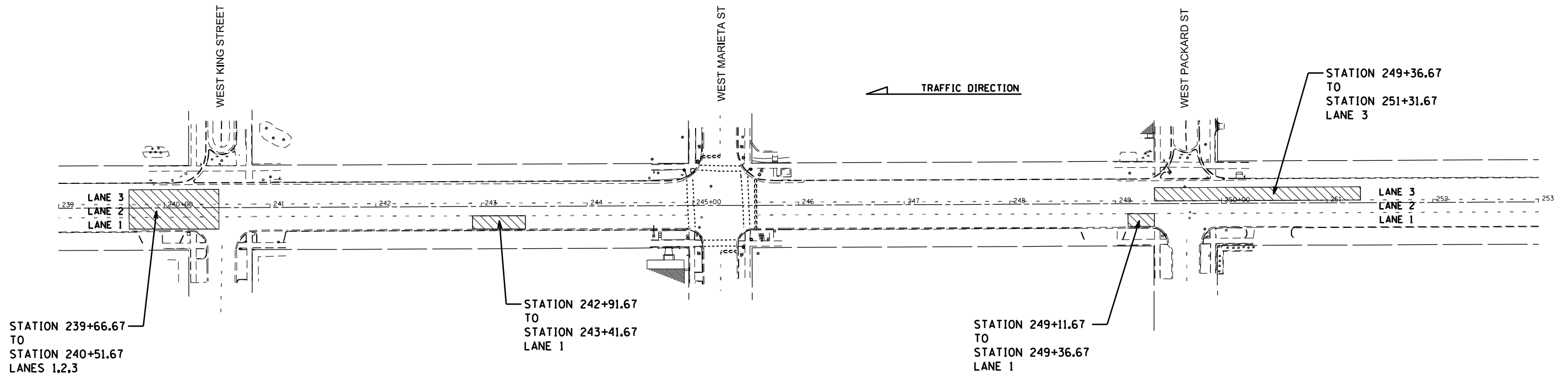
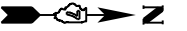

RESURFACING AREA =

** = 710 & 710 1

MODEL: Default
 FILE: Mainfile.pia\uldet-cw-beadfw.com\FW\DOT\Documents\DOT Office\Director_7\Project\74858\CADD\DATA\CAD\Sheet\ID74858-sb-plan.dgn

USER NAME = Jessica.Hille	DESIGNED -	REVISED -
	DRAWN -	REVISED -
PLOT SCALE = 100,0000' / in.	CHECKED -	REVISED -
PLOT DATE = 12/22/2022	DATE -	REVISED -

**STATE OF ILLINOIS
DEPARTMENT OF TRANSPORTATION**

PLAN VIEW - OLD US 51 SOUTH BOUND MAIN STREET			
SCALE:	SHEET	OF SHEETS	STA. TO STA.

F.A.P. RTE.	SECTION	COUNTY	TOTAL SHEETS	SHEET NO.
**	D7 PATCHING 2023-6	MACON	20	8
			CONTRACT NO. 74858	
		ILLINOIS	FED. AID PROJECT	

OLD US 51 SB (STA. 253+00 TO STA. 301+50)

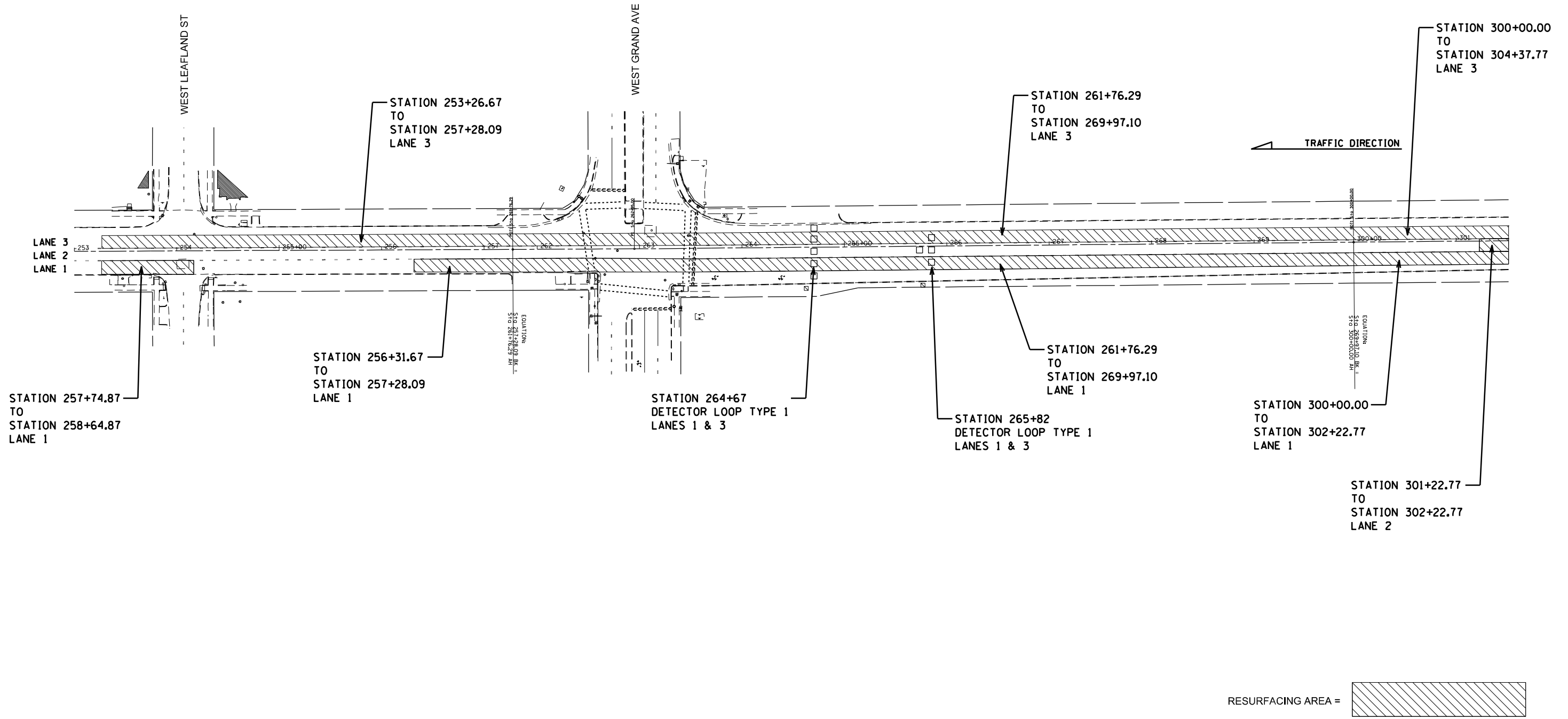
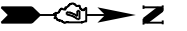

RESURFACING AREA =

MODEL: Default
 FILE: Mainfile.pia
 PROJECT: 74858\CADD\DATA\CAD\PROJECTS\74858-PLAN.dwg

USER NAME = Jessica.Hille	DESIGNED -	REVISED -
PLOT SCALE = 100,0000' / in.	DRAWN -	REVISED -
PLOT DATE = 12/22/2022	CHECKED -	REVISED -
	DATE -	REVISED -

**STATE OF ILLINOIS
DEPARTMENT OF TRANSPORTATION**

PLAN VIEW - OLD US 51 SOUTH BOUND MAIN STREET			
SCALE:	SHEET	OF SHEETS	STA. TO STA.

** = 710 & 710 1

F.A.P. RTE.	SECTION	COUNTY	TOTAL SHEETS	SHEET NO.
**	D7 PATCHING 2023-6	MACON	20	9
CONTRACT NO. 74858				
ILLINOIS FED. AID PROJECT				

OLD US 51 SB (STA. 301+50 TO STA. 315+50)

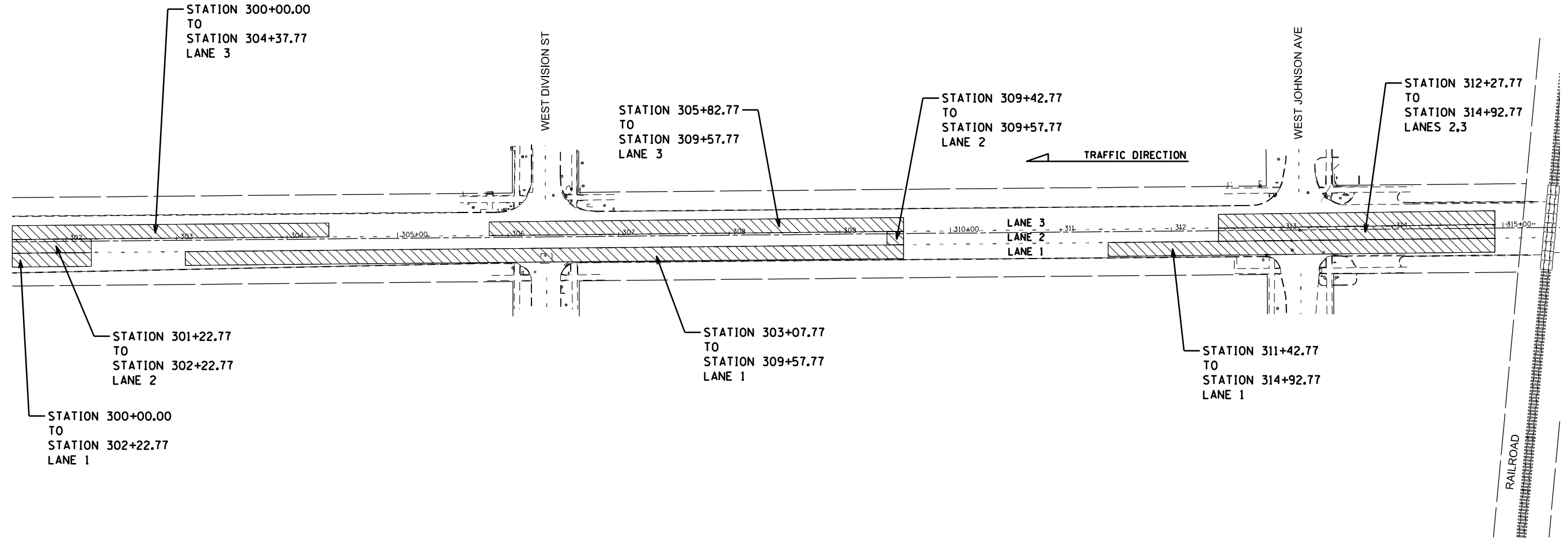
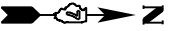

MODEL: Default
 FILE: \\maile-pw-bentley.com\P\DOT\Documents\DOT Office\District 7\Project\74B58\CADD\DATA\CAD\Sheet\74B58-sb-plan.dgn

** = 710 & 710 1

USER NAME = Jessica.Hille	DESIGNED -	REVISED -
	DRAWN -	REVISED -
PLOT SCALE = 100,0000' / in.	CHECKED -	REVISED -
PLOT DATE = 12/22/2022	DATE -	REVISED -

STATE OF ILLINOIS
DEPARTMENT OF TRANSPORTATION

PLAN VIEW - OLD US 51 SOUTH BOUND
MAIN STREET

SCALE: SHEET OF SHEETS STA. TO STA.

F.A.P. RTE.	SECTION	COUNTY	TOTAL SHEETS	SHEET NO.
**	D7 PATCHING 2023-6	MACON	20	10
CONTRACT NO. 74B58			ILLINOIS FED. AID PROJECT	

OLD US 51 SB (STA. 315+50 TO STA. 329+50)

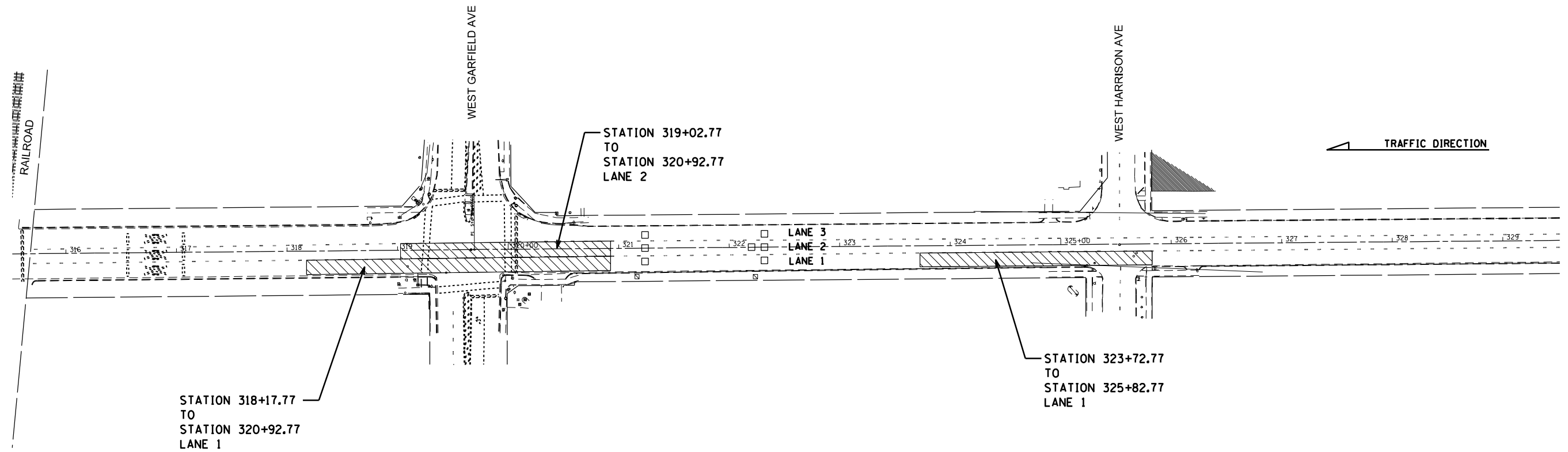
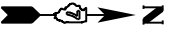

RESURFACING AREA =

** = 710 & 710 1

MODEL: Default
 FILE NAME: p:\ultra-cw-bead\p\74858\CADD\DATA\CAD\Sheet\DOT\Office\Director_7\Project\74858\CADD\DATA\CAD\Sheet\DOT\74858-sb-plan.dgn

USER NAME = Jessica.Hille	DESIGNED -	REVISED -
	DRAWN -	REVISED -
PLOT SCALE = 100,0000' / in.	CHECKED -	REVISED -
PLOT DATE = 12/22/2022	DATE -	REVISED -

**STATE OF ILLINOIS
DEPARTMENT OF TRANSPORTATION**

**PLAN VIEW - OLD US 51 SOUTH BOUND
MAIN STREET**

SCALE: SHEET OF SHEETS STA. TO STA.

F.A.P. RTE.	SECTION	COUNTY	TOTAL SHEETS	SHEET NO.
**	D7 PATCHING 2023-6	MACON	20	11
			CONTRACT NO. 74858	
		ILLINOIS	FED. AID PROJECT	

OLD US 51 SB (STA. 329+50 TO STA. 343+50)

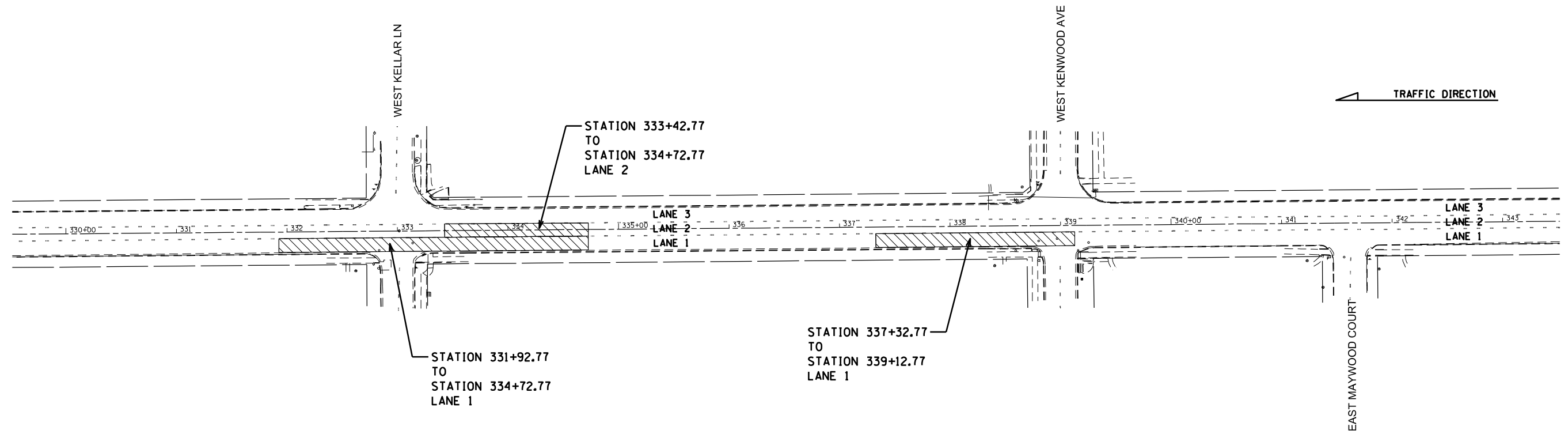
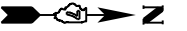

TRAFFIC DIRECTION

RESURFACING AREA =

** = 710 & 710 1

MODEL: Default
 FILE: Mainfile.pia\ultra-cw-bead-fay.com\FW\DOT\Documents\DOT Office\District 7\Project\74B58\CADD\DATA\CAD\Sheet\ID74B58-she1.dgn

USER NAME = Jessica.Hille	DESIGNED -	REVISED -
	DRAWN -	REVISED -
PLOT SCALE = 100,0000' / in.	CHECKED -	REVISED -
PLOT DATE = 12/22/2022	DATE -	REVISED -

**STATE OF ILLINOIS
DEPARTMENT OF TRANSPORTATION**

**PLAN VIEW - OLD US 51 SOUTH BOUND
MAIN STREET**

SCALE: SHEET OF SHEETS STA. TO STA.

F.A.P. RTE.	SECTION	COUNTY	TOTAL SHEETS	SHEET NO.
**	D7 PATCHING 2023-6	MACON	20	12
			CONTRACT NO. 74B58	
		ILLINOIS	FED. AID PROJECT	

OLD US 51 SB (STA. 343+50 TO STA. 357+50)

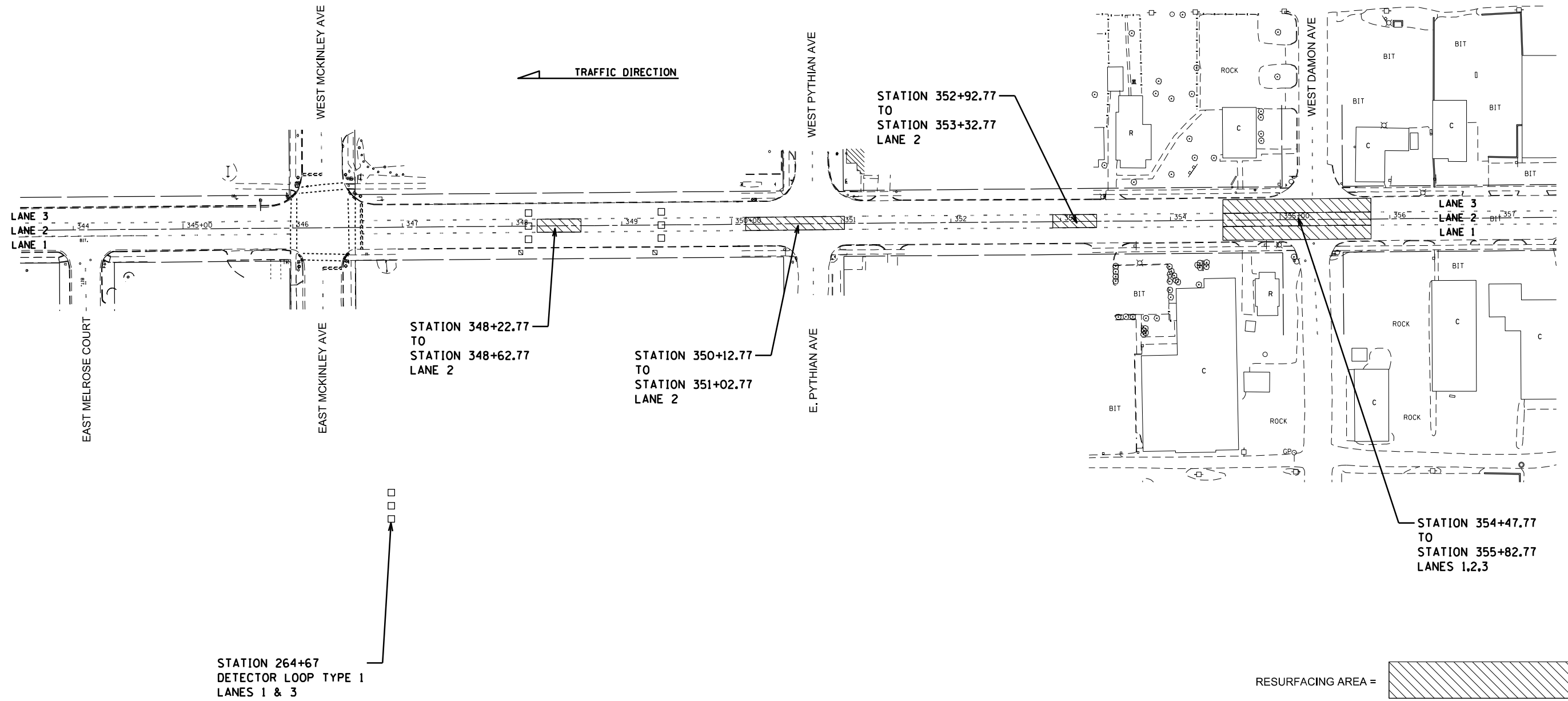
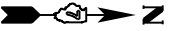

RESURFACING AREA =

MODEL: Default
 FILE: Mainfile.pxd
 PROJECT: 74858\CADD\DATA\CAD\Sheet\DOT\Office\Director_7\Project\74858\CADD\DATA\CAD\Sheet\DOT\74858-sb-plan.dgn
 PLOT DATE = 12/22/2022

USER NAME = Jessica.Hille	DESIGNED -	REVISED -
	DRAWN -	REVISED -
PLOT SCALE = 100,0000' / in.	CHECKED -	REVISED -
PLOT DATE = 12/22/2022	DATE -	REVISED -

**STATE OF ILLINOIS
DEPARTMENT OF TRANSPORTATION**

**PLAN VIEW - OLD US 51 SOUTH BOUND
MAIN STREET**

SCALE: SHEET OF SHEETS STA. TO STA.

** = 710 & 710 1

F.A.P. RTE.	SECTION	COUNTY	TOTAL SHEETS	SHEET NO.
**	D7 PATCHING 2023-6	MACON	20	13
CONTRACT NO. 74858				
ILLINOIS FED. AID PROJECT				

OLD US 51 SB (STA. 357+50 TO STA. 371+50)

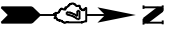

EXIST. CURVE C21
 PI STA. = 362+36.75
 $\Delta = 7^\circ 09' 12''$ (LT)
 $D = 1^\circ 29' 08''$
 $R = 3,856.64'$
 $T = 241.06'$
 $L = 481.50'$
 $E = 7.53'$
 $e = \dots$
 $T.R. = \dots$
 $S.E. RUN = \dots$
 $P.C. STA. = 359+95.69$
 $P.T. STA. = 364+77.19$

TRAFFIC DIRECTION

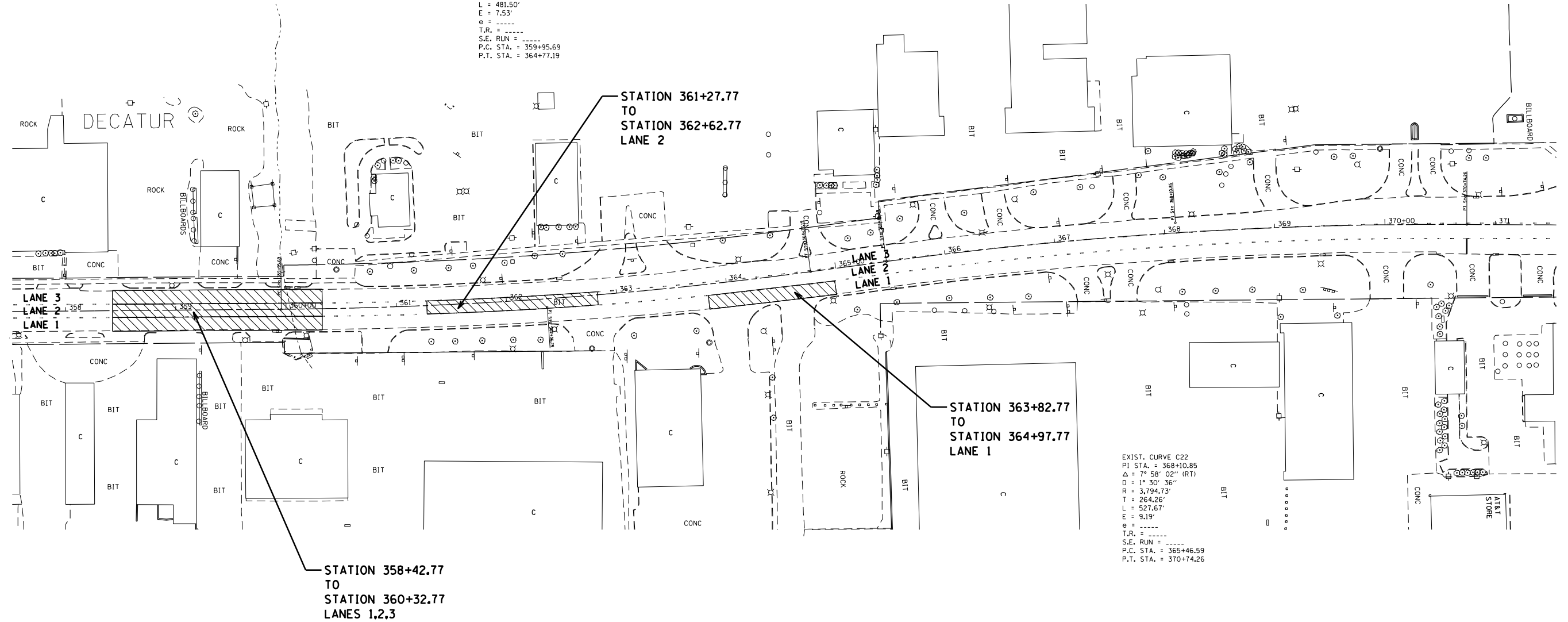

EXIST. CURVE C22
 PI STA. = 368+10.85
 $\Delta = 7^\circ 58' 02''$ (RT)
 $D = 1^\circ 30' 36''$
 $R = 3,794.73'$
 $T = 264.26'$
 $L = 527.67'$
 $E = 9.19'$
 $e = \dots$
 $T.R. = \dots$
 $S.E. RUN = \dots$
 $P.C. STA. = 365+46.59$
 $P.T. STA. = 370+74.26$

RESURFACING AREA =

** = 710 & 710 1

MODEL: Default
 FILE: \\na16c-pw\ludect-pw-beadefy.com\FW\DOT\Documents\1\DOT\Office\Dir\rdet_7\Project\74858\CADD\DATA\CAD\Sheet\74858-she-dt-0.dgn

USER NAME = Jessica.Hille	DESIGNED -	REVISED -
	DRAWN -	REVISED -
PLOT SCALE = 100,0000' / in.	CHECKED -	REVISED -
PLOT DATE = 12/22/2022	DATE -	REVISED -

STATE OF ILLINOIS
 DEPARTMENT OF TRANSPORTATION

PLAN VIEW - OLD US 51 SOUTH BOUND
 MAIN STREET

SCALE: SHEET OF SHEETS STA. TO STA.

F.A.P. RTE.	SECTION	COUNTY	TOTAL SHEETS	SHEET NO.
**	D7 PATCHING 2023-6	MACON	20	14
CONTRACT NO. 74858				
ILLINOIS FED. AID PROJECT				

OLD US 51 NB (STA. 1234+00 TO STA. 1248+15)

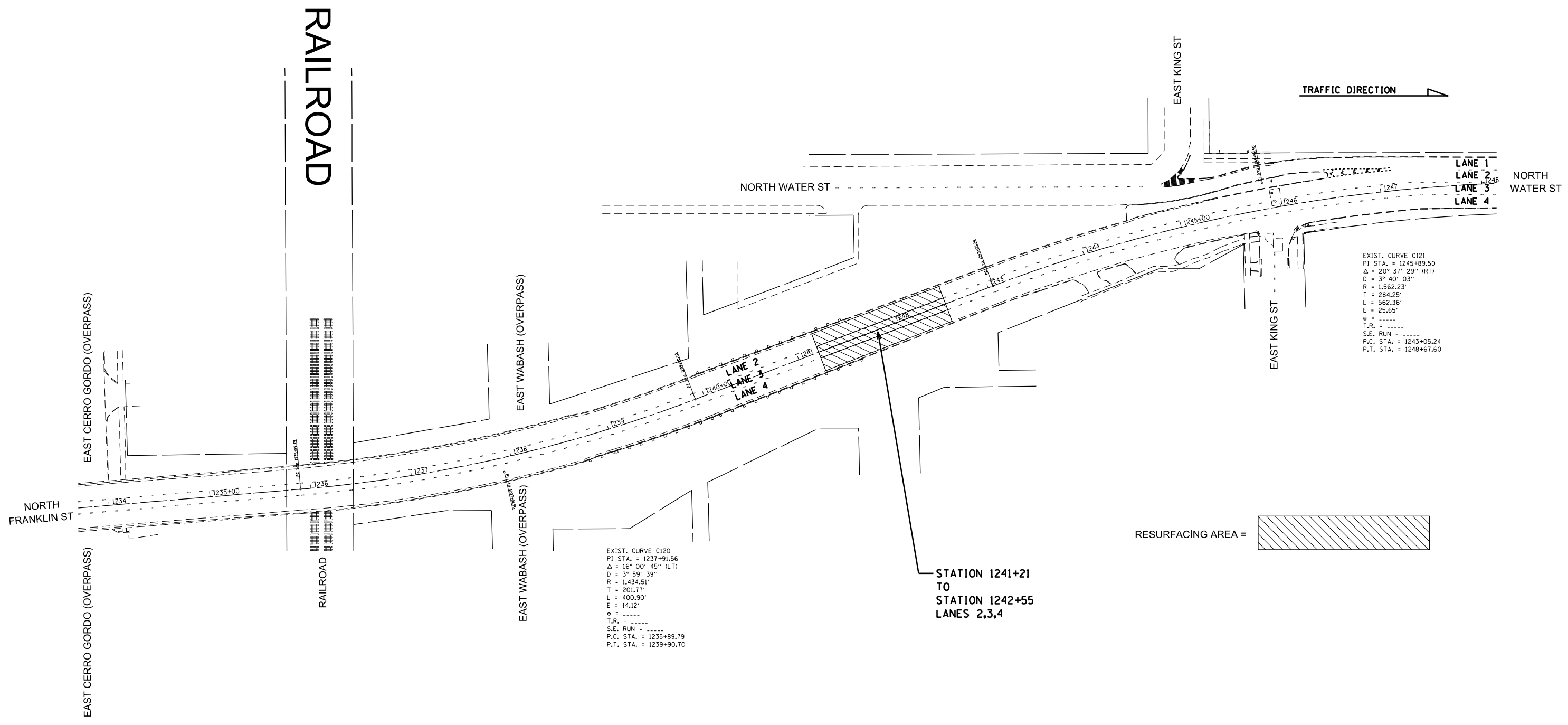
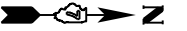

EXIST. CURVE C121
 PI STA. = 1245+89.50
 $\Delta = 20^\circ 37' 29''$ (RT)
 $D = 3^\circ 40' 03''$
 $R = 1,562.23'$
 $T = 284.25'$
 $L = 562.36'$
 $E = 25.65'$
 $\theta = \dots$
 $T.R. = \dots$
 $S.E. RUN = \dots$
 $P.C. STA. = 1243+05.24$
 $P.T. STA. = 1248+67.60$

EXIST. CURVE C120
 PI STA. = 1237+91.56
 $\Delta = 16^\circ 00' 45''$ (LT)
 $D = 3^\circ 59' 39''$
 $R = 1,434.51'$
 $T = 201.77'$
 $L = 400.90'$
 $E = 14.12'$
 $\theta = \dots$
 $T.R. = \dots$
 $S.E. RUN = \dots$
 $P.C. STA. = 1235+89.79$
 $P.T. STA. = 1239+90.70$

RESURFACING AREA =

STATION 1241+21
 TO
 STATION 1242+55
 LANES 2,3,4

MODEL: Default
 FILE NAME: p:\project\74858\CADD\DATA\CAD\sheet\74858-she1.dgn

** = 710 & 710 1

USER NAME = Jessica.Hille	DESIGNED -	REVISED -
	DRAWN -	REVISED -
PLOT SCALE = 100,0000' / in.	CHECKED -	REVISED -
PLOT DATE = 12/22/2022	DATE -	REVISED -

STATE OF ILLINOIS
 DEPARTMENT OF TRANSPORTATION

PLAN VIEW - OLD US 51 NORTH BOUND
 FRANKLIN AND WATER STREET

SCALE: SHEET OF SHEETS STA. TO STA.

F.A.P. RTE.	SECTION	COUNTY	TOTAL SHEETS	SHEET NO.
**	D7 PATCHING 2023-6	MACON	20	15
			CONTRACT NO. 74858	
		ILLINOIS	FED. AID PROJECT	

OLD US 51 NB (STA. 1248+15 TO STA. 1262+00)

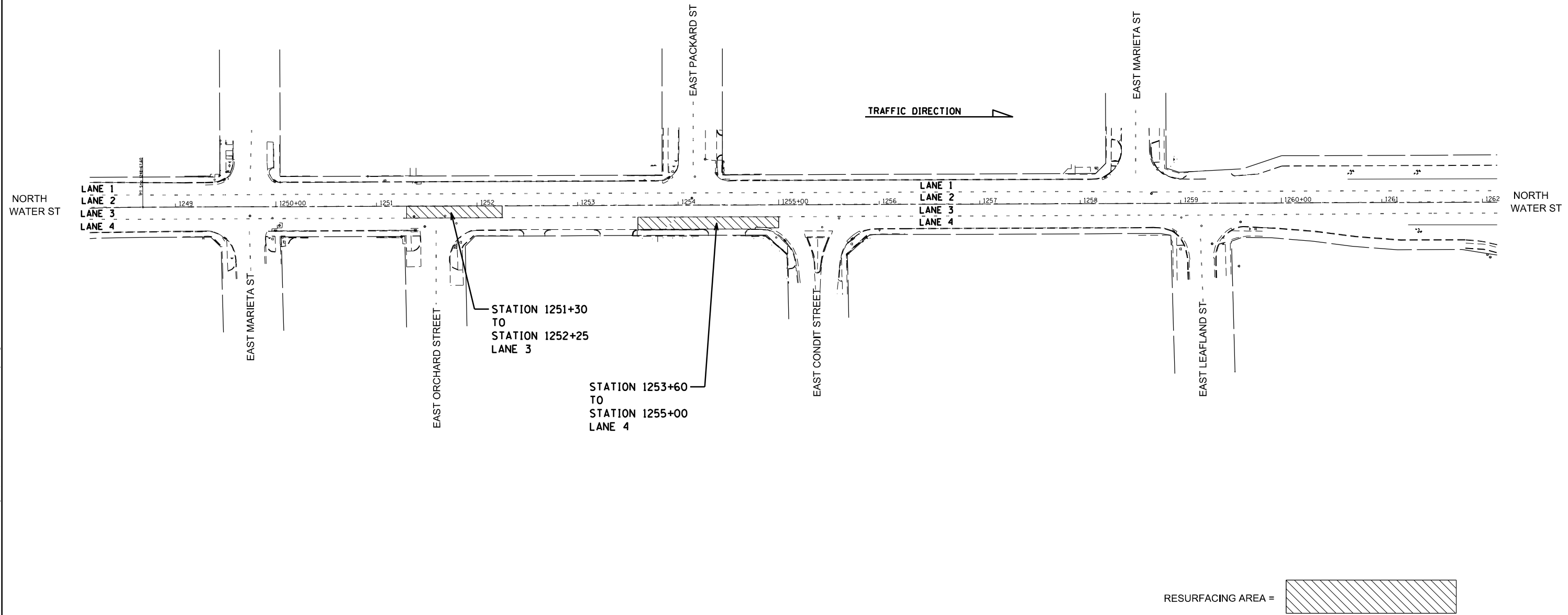
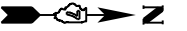

RESURFACING AREA =

MODEL: Default
 FILE: Mainfile.pia
 PROJECT: 74858\CADD\DATA\CAD\Sheet\74858-Plan.dwg
 PROJECT: 74858\CADD\DATA\CAD\Sheet\74858-Plan.dwg

USER NAME = Jessica.Hille	DESIGNED -	REVISED -
	DRAWN -	REVISED -
PLOT SCALE = 100,0000' / in.	CHECKED -	REVISED -
PLOT DATE = 12/22/2022	DATE -	REVISED -

STATE OF ILLINOIS
DEPARTMENT OF TRANSPORTATION

PLAN VIEW - OLD US 51 NORTH BOUND
WATER STREET

SCALE: SHEET OF SHEETS STA. TO STA.

** = 710 & 710 1

F.A.P. RTE.	SECTION	COUNTY	TOTAL SHEETS	SHEET NO.
**	D7 PATCHING 2023-6	MACON	20	16
			CONTRACT NO. 74858	
		ILLINOIS	FED. AID PROJECT	

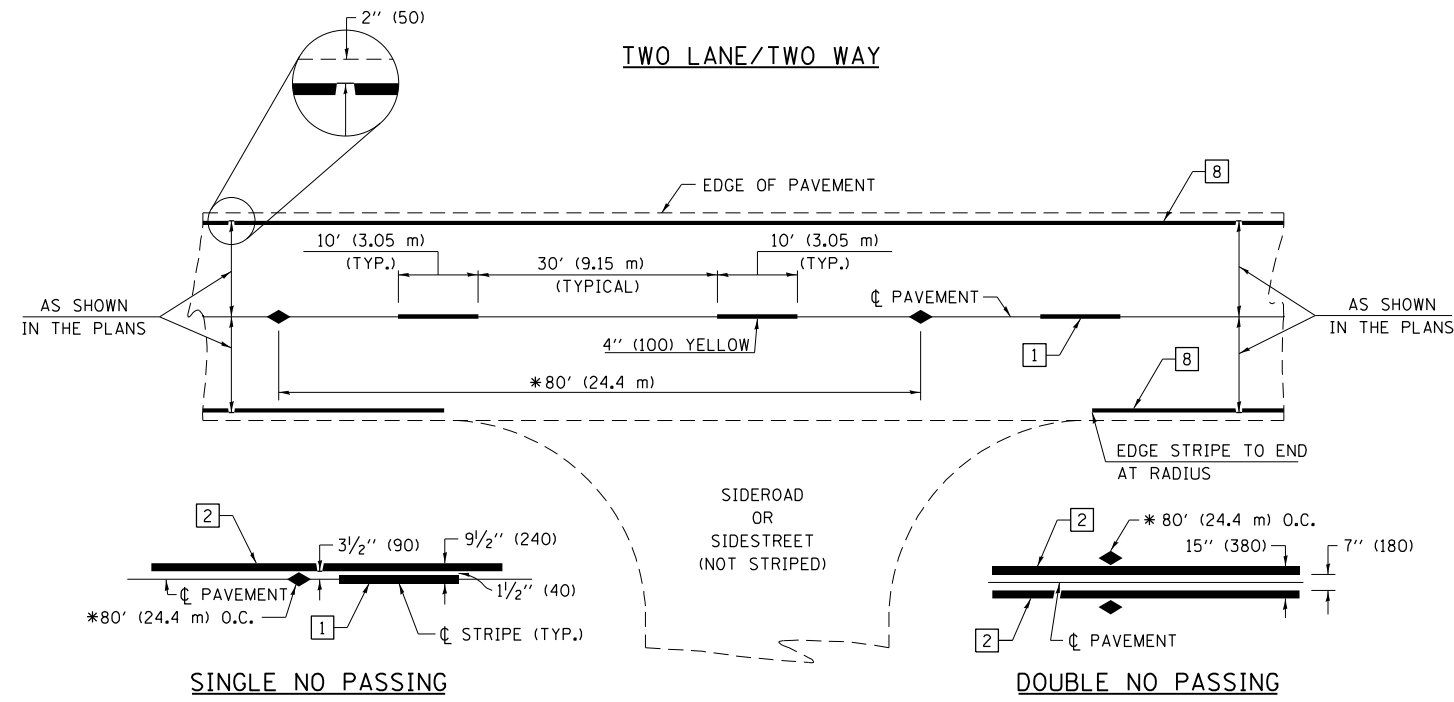

* REDUCE TO 40' (12.2 m) O.C. ON CURVES WITH POSTED OR ADVISORY SPEEDS OF 45 mph (70 km/h) OR LESS.

PAVEMENT MARKING LEGEND

- 1 4" (100) SKIP-DASH (YELLOW)
- 2 4" (100) SOLID (YELLOW)
- 3 12" (300) DIAGONAL (YELLOW)
- 4 4" (100) DOUBLE YELLOW (NARROW)
- 5 12" (300) SOLID WHITE
- 6 RESERVED
- 7 6" (150) SKIP-DASH (WHITE)
- 8 4" (100) SOLID (WHITE)
- 9 12" (300) DIAGONAL (WHITE)
- 10 6" (150) SOLID (WHITE)
- 11 24" (600) STOP BAR (WHITE)
- 12 8" (200) SOLID (WHITE)
- 13 4" (100) PARKING WHITE

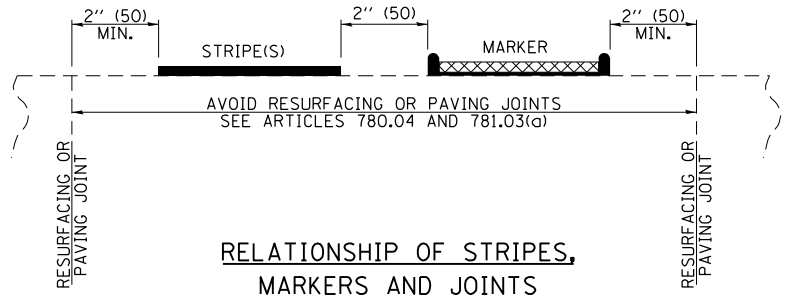

RELATIONSHIP OF STRIPES, MARKERS AND JOINTS

TYPICAL PAVEMENT MARKERS LEGEND

- ◆ TWO-WAY AMBER MARKER
- ▶ ONE-WAY AMBER MARKER
- ▷ ONE-WAY CRYSTAL MARKER

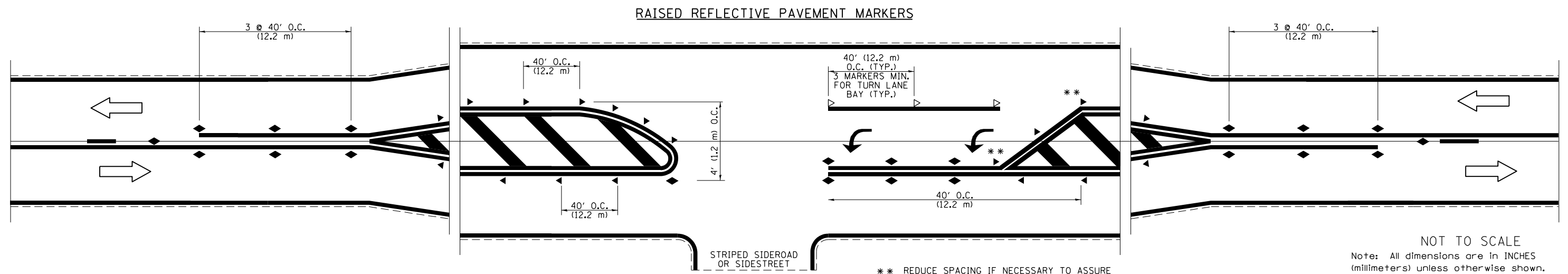

** REDUCE SPACING IF NECESSARY TO ASSURE MARKERS AT CORNER POINTS.

NOT TO SCALE
Note: All dimensions are in INCHES (millimeters) unless otherwise shown.

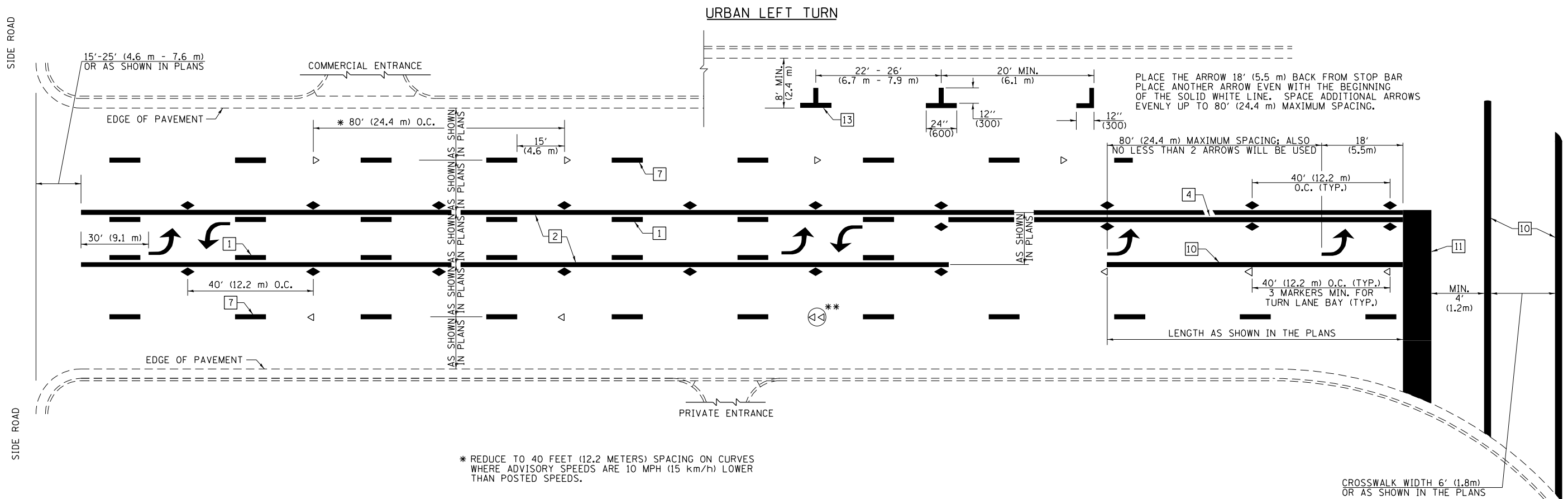

- * REDUCE TO 40 FEET (12.2 METERS) SPACING ON CURVES WHERE ADVISORY SPEEDS ARE 10 MPH (15 km/h) LOWER THAN POSTED SPEEDS.
- ** DOUBLE LANE LINE MARKERS SHALL BE SPECIFIED AND SPACED AS SHOWN IN HIGHWAY STANDARD 781001 FOR MULTI-LANE DIVIDED AND UNDIVIDED HIGHWAYS.

PAVEMENT MARKING LEGEND

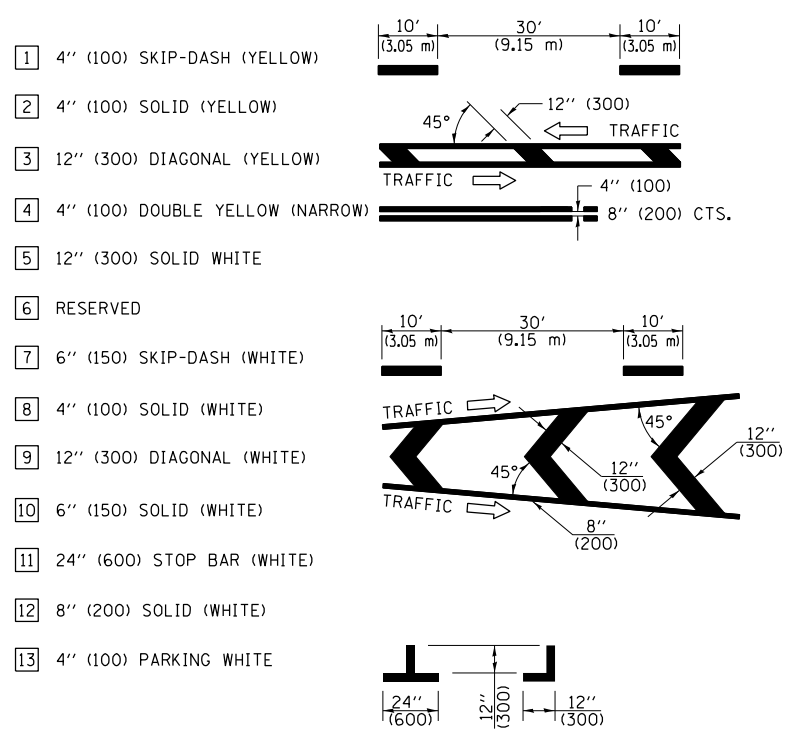

GENERAL NOTES

1. TURN ARROW PAIRS SHALL BE PLACED AT 250' (75 m) INTERVALS AND SHALL BE EVENLY SPACED BETWEEN BOTH ENDS OF THE BIDIRECTIONAL LEFT TURN LANE. USE A MINIMUM OF TWO PAIRS PER BLOCK.
2. THE SOLID YELLOW PAVEMENT MARKINGS [2] SHOULD GENERALLY START OR END NEAR THE RADIUS POINT OF EACH STREET RETURN EXCEPT WHERE ONE OR BOTH ENDS WOULD INCLUDE STOP BARS.
3. THE SKIP-DASH PAVEMENT MARKINGS [1] OR [7] SHOULD BE CENTERED BETWEEN BOTH ENDS OF EACH CITY BLOCK AND SHALL BE PLACED SO THEY LINE UP ACROSS FROM EACH OTHER.
4. USE LARGE ARROW SIZE FOR BOTH RURAL AND URBAN LOCATIONS. (SEE LAST PAGE OF SECTION 780x FOR SYMBOLS TABLE)
5. LANE LINE EXTENSIONS SHALL BE THE SAME COLOR AND WIDTH AS THE LANE LINE BEING EXTENDED.

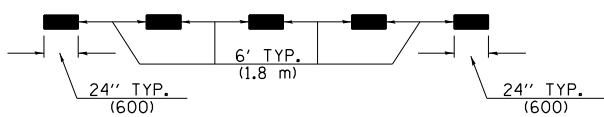

LANE LINE EXTENSIONS

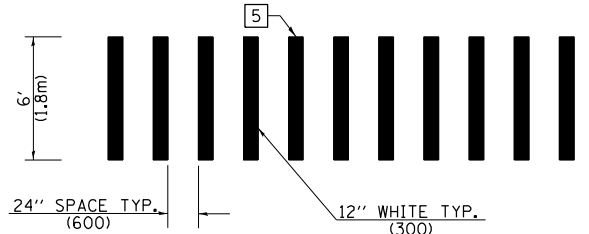

CROSSWALK DETAIL (DECATUR CITY LIMITS ONLY)

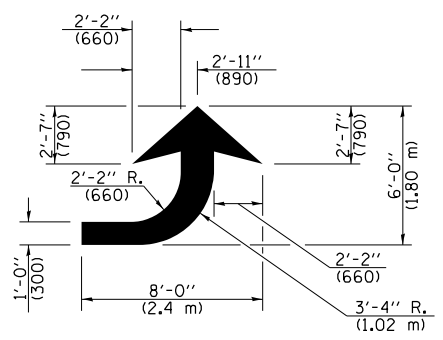

LEFT ARROW

REVERSE FOR RIGHT ARROW
AREA = 15.6 SQ. FT. (1.47 m²)
(WHITE)

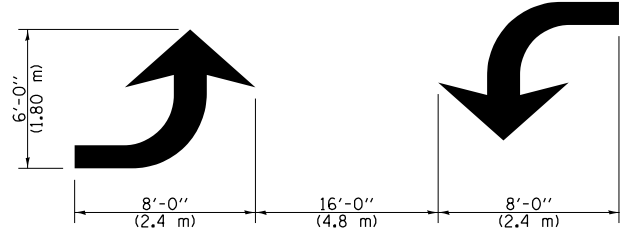

TYPICAL DOUBLE TURN ARROWS (WHITE)

NOT TO SCALE

Note: All dimensions are in INCHES (millimeters) unless otherwise shown.

** = 701 & 701 1

FILE NAME =	USER NAME = Jessica.Hille	DESIGNED -	REVISED -	STATE OF ILLINOIS DEPARTMENT OF TRANSPORTATION	PAVEMENT MARKING AND RAISED REFLECTIVE PAVEMENT MARKERS (RURAL & URBAN APPLICATIONS)	F.A.P. RTE.	SECTION	COUNTY	TOTAL SHEETS	SHEET NO.
pw:\idot-pw\bentley.com\PWIDOT\Documents\IDOT Offices\District 7\Projects\74858\CADD\Drawings\74858-shd-details.dgn	DRAWN	REVISED -	REVISED -			**	D7 PATCHING 2023-6	MACON	20	18
PLOT SCALE = 100.0000' / in.	CHECKED -	REVISED -	REVISED -			CONTRACT NO. 74B58				
PLOT DATE = 12/22/2022	DATE -	REVISED -	REVISED -			ILLINOIS FED. AID PROJECT				

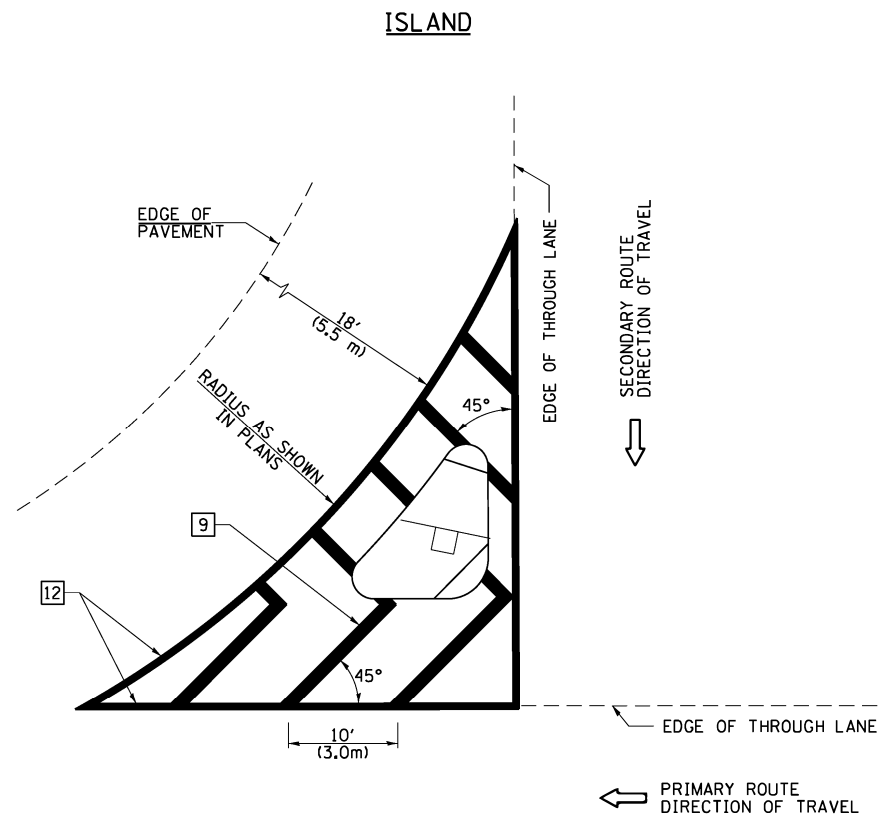

GENERAL NOTES

1. RAISED AND CORRUGATED MEDIANS SHALL BE OUTLINED WITH [2] IF PRESENT.
2. SOME OF THE INFORMATION INCLUDED WITH THIS DETAIL MAY NOT BE APPLICABLE TO THIS IMPROVEMENT.
3. PAVEMENT MARKINGS ARE TO BE EXTENDED THROUGH OMISSIONS WHEN APPLICABLE.
4. FINAL PAVEMENT MARKINGS SHALL BE IN PLACE PRIOR TO PLACING ANY RAISED REFLECTIVE PAVEMENT MARKERS.
5. THE FOLLOWING CRITERIA SHALL BE USED FOR SELECTING THE DIAGONAL PAVEMENT MARKING SPACING:

< 30 MPH (< 50 km/h)	15' (4.5 m)
30-45 MPH (50-75 km/h)	20' (6.0 m)
> 45 MPH (> 75 km/h)	30' (9.0 m)

PAVEMENT MARKING LEGEND

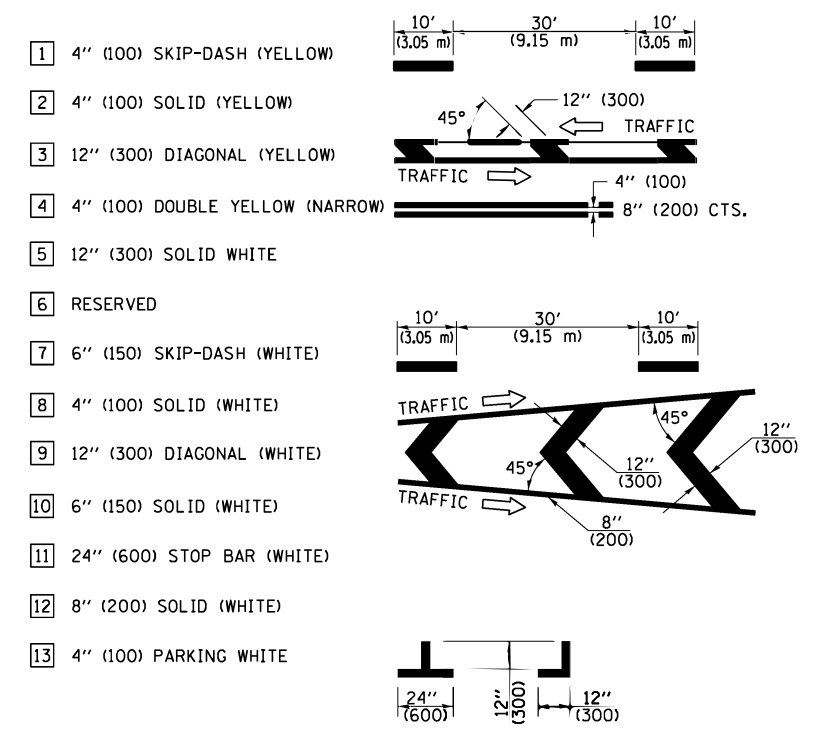

RURAL LEFT TURN STRIPING

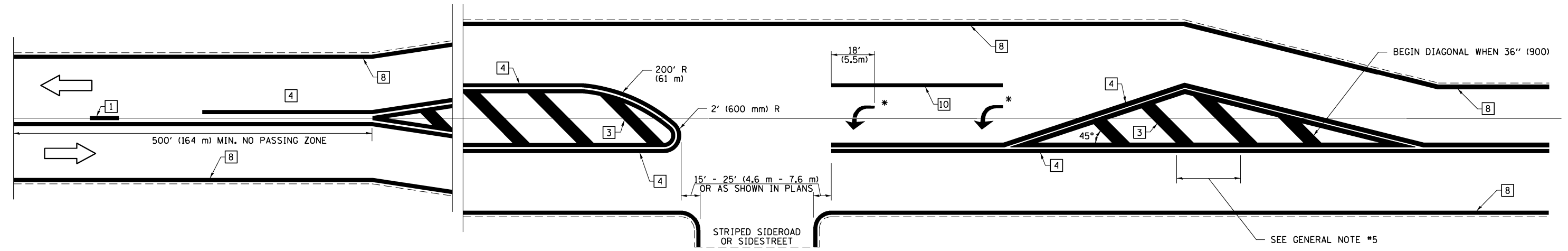

* PLACE AN ARROW 18' (5.5 m) BACK FROM STOP BAR. PLACE ANOTHER ARROW EVEN WITH THE BEGINNING OF THE SOLID WHITE LINE. SPACE ADDITIONAL ARROWS EVENLY UP TO 80' (24.4 m) MAXIMUM SPACING. USE MINIMUM OF 2 ARROWS.

NOT TO SCALE
 Note: All dimensions are in INCHES (millimeters) unless otherwise shown.

REV. - MS ** = 701 & 701 1

FILE NAME =	USER NAME = Jessica.Hille	DESIGNED -	REVISED -	STATE OF ILLINOIS DEPARTMENT OF TRANSPORTATION	PAVEMENT MARKING AND RAISED REFLECTIVE PAVEMENT MARKERS (RURAL & URBAN APPLICATIONS)	F.A.P. RTE.	SECTION	COUNTY	TOTAL SHEETS	SHEET NO.
pw:\idot-pw.bentley.com\PWIDOT\Documents\IDOT Offices\Dist\ict 7\Projects\74858\CADD\Drawings\Drawings\74858-shd-details.dgn	PROJECT = DISTRICT 7	DRAWN -	REVISED -			**	D7 PATCHING 2023-6	MACON	20	19
PLOT SCALE = 100.0000' / 1" =	CHECKED -	REVISED -	REVISED -			CONTRACT NO. 74B58				
PLOT DATE = 12/22/2022	DATE -	REVISED -	REVISED -			ILLINOIS FED. AID PROJECT				

PAVEMENT MARKINGS AT RAILROAD-HIGHWAY GRADE CROSSING

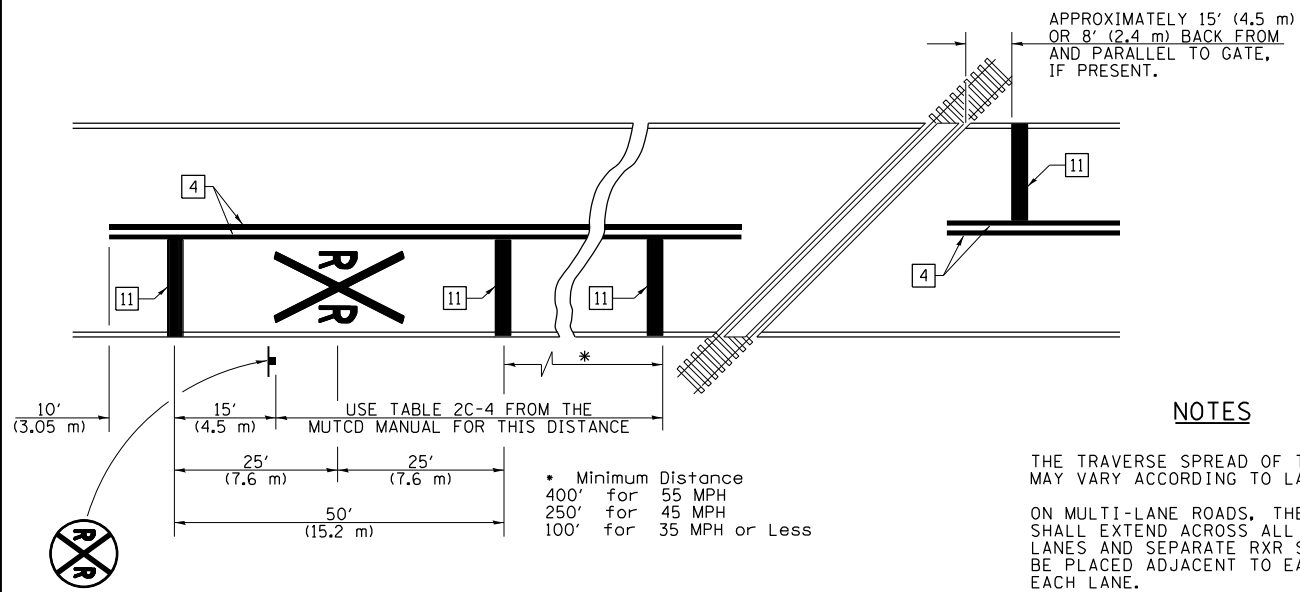

NOTES

THE TRAVERSE SPREAD OF THE "X" MAY VARY ACCORDING TO LANE WIDTH.

ON MULTI-LANE ROADS, THE STOP LINES SHALL EXTEND ACROSS ALL APPROACH LANES AND SEPARATE RXR SYMBOLS SHALL BE PLACED ADJACENT TO EACH OTHER IN EACH LANE.

WHEN THE PAVEMENT MARKING SYMBOL IS USED, A PORTION OF THE SYMBOL SHOULD BE LOCATED DIRECTLY ADJACENT TO THE ADVANCE WARNING SIGN (W10-1) AS PLACED BY TABLE II-1, CONDITION B OF THE MUTCD.

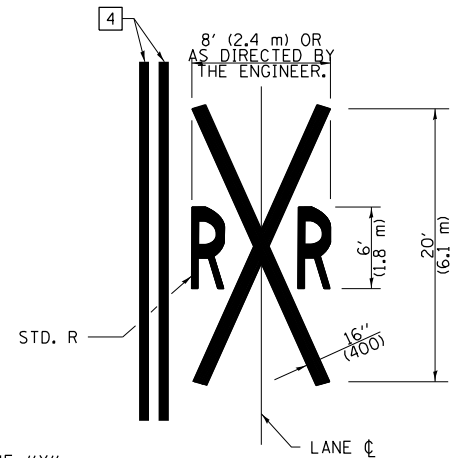

PAVEMENT MARKING LEGEND

- 1 4" (100) SKIP-DASH (YELLOW)
- 2 4" (100) SOLID (YELLOW)
- 3 12" (300) DIAGONAL (YELLOW)
- 4 4" (100) DOUBLE YELLOW (NARROW)
- 5 12" (300) SOLID WHITE
- 6 RESERVED
- 7 6" (150) SKIP-DASH (WHITE)
- 8 4" (100) SOLID (WHITE)
- 9 12" (300) DIAGONAL (WHITE)
- 10 6" (150) SOLID (WHITE)
- 11 24" (600) STOP BAR (WHITE)
- 12 8" (200) SOLID (WHITE)
- 13 4" (100) PARKING WHITE

RAILROAD CROSSING WITH INTERCONNECT ONLY

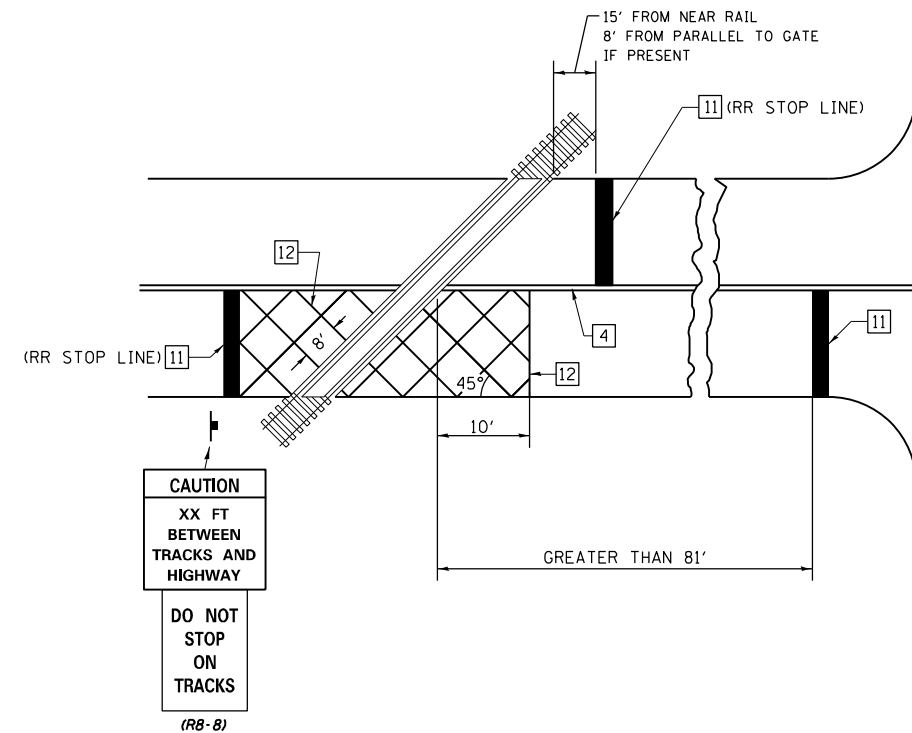

RAILROAD CROSSING WITH INTERCONNECT AND PRE-SIGNALS

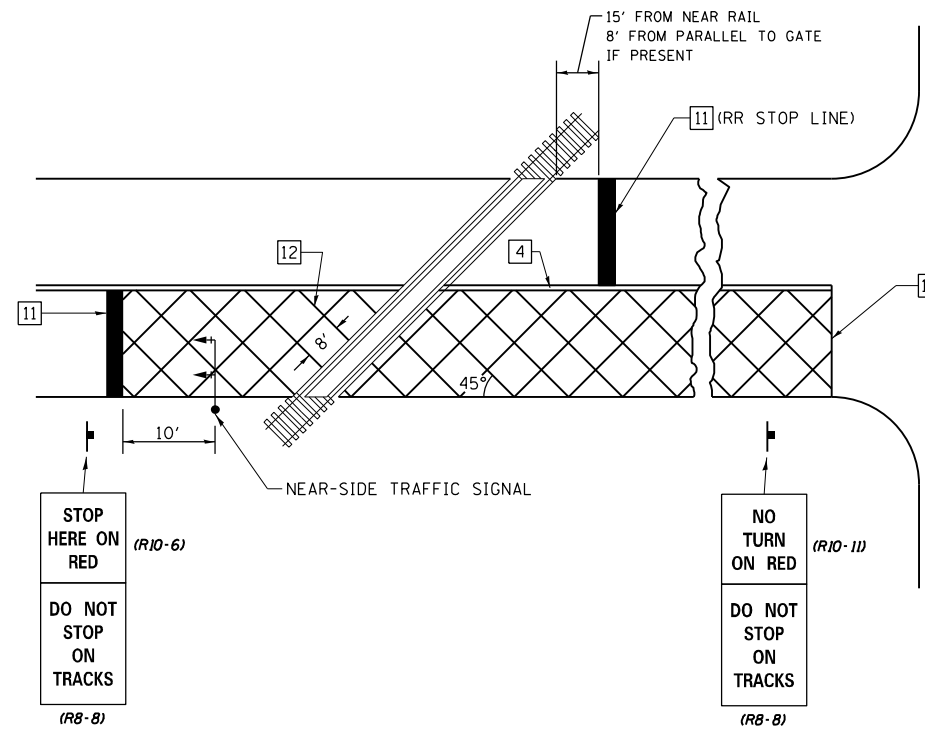

GENERAL NOTES

1. SUPPLEMENTAL PAVEMENT MARKINGS TO BE INSTALLED ONLY ON APPROACHES TO INTERSECTIONS CONTROLLED BY TRAFFIC SIGNALS WHICH ARE INTERCONNECTED WITH THE RAILROAD WARNING SIGNALS.
2. EXTEND PAVEMENT MARKINGS TO THE INTERSECTION ONLY WHERE NEAR-SIDE TRAFFIC SIGNALS ARE USED.

SUPPLEMENTAL PAVEMENT MARKING TREATMENT FOR RAILROAD-HIGHWAY GRADE CROSSING

NOT TO SCALE

Note: All dimensions are in INCHES (millimeters) unless otherwise shown.

** = 701 & 701 1

FILE NAME =	USER NAME = Jessica.Hille	DESIGNED -	REVISED -
p:\1\dot-pw.bentley.com\PIWIDOT\Documents\DOT Offices\District 7\Projects\74858\CADD\Drawings\Sheets\0774858-shd-details.dgn		CHECKED -	REVISED -
		DATE -	REVISED -

STATE OF ILLINOIS
DEPARTMENT OF TRANSPORTATION

PAVEMENT MARKING AND RAISED REFLECTIVE PAVEMENT MARKERS
(RURAL & URBAN APPLICATIONS)

SCALE: SHEET NO. 4 OF 4 SHEETS STA. TO STA.

DISTRICT 7 DETAIL NO. 78000001				
F.A.P. RTE.	SECTION	COUNTY	TOTAL SHEETS	SHEET NO.
	DT PATCHING 2023-6	MACON	20	20
CONTRACT NO. 74B58				
ILLINOIS FED. AID PROJECT				