

CONTROL POINT #95
 STA. 412+58.51, 9.04' RT.
 N 1380465.95
 E 2123279.15
 ELEV.= 695.23

EXIST. CURVE C114
 PI STA. = 413+57.75
 $\Delta = 24^\circ 07' 03''$ (LT)
 $D = 28^\circ 38' 52''$
 $R = 200.00'$
 $T = 42.73'$
 $L = 84.19'$
 $E = 4.51'$
 P.C. STA. = 413+15.02
 P.T. STA. = 413+99.21

CONTROL POINT #94
 STA. 414+91.34, 12.67' RT.
 N 1380668.39
 E 2123395.51
 ELEV.= 695.07

 SCARIFY EXISTING SURFACE

SCARIFY EXISTING SURFACE
 STA. 412+75 TO STA. 417+75, 811.7 SQ. YD.

SCARIFY EXISTING SURFACE
 STA. 500+09 TO STA. 500+75, 115.6 SQ. YD.

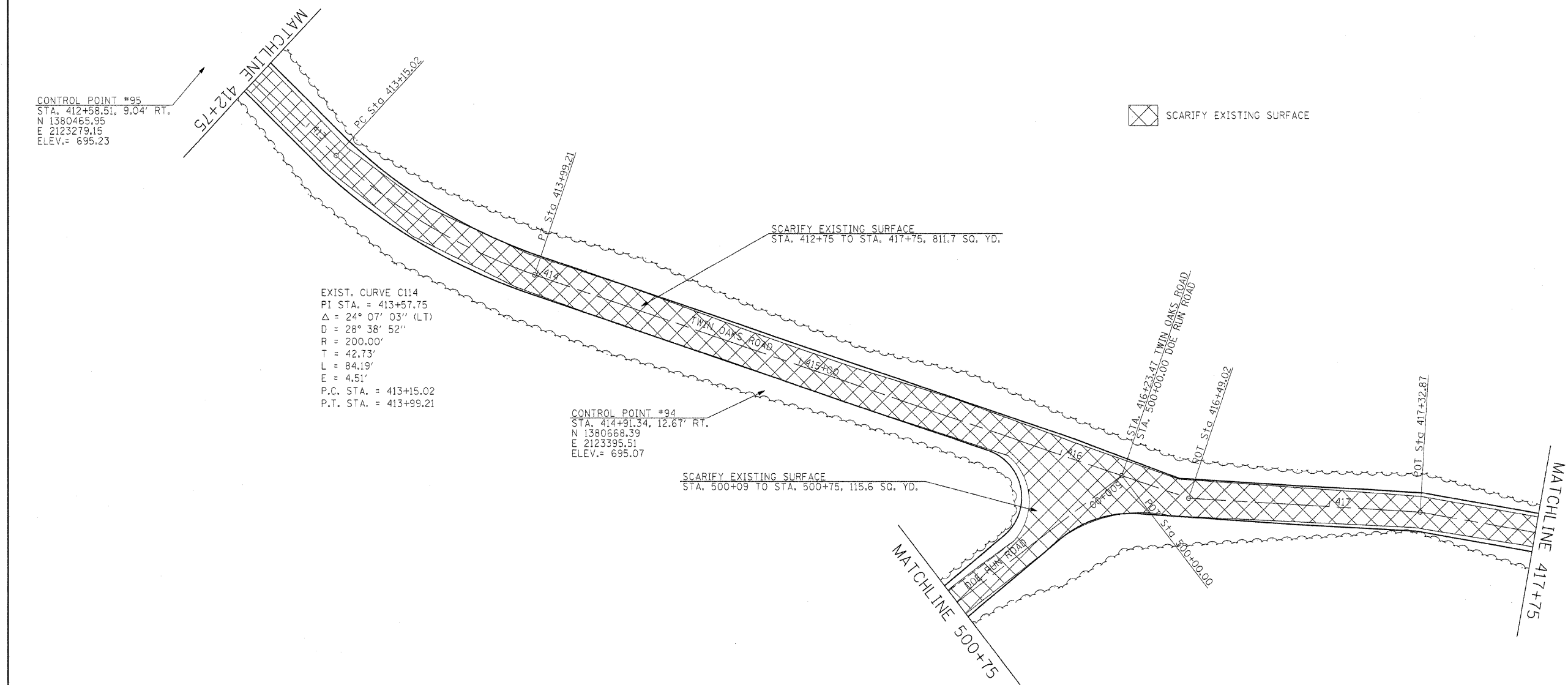

FILE NAME =	USER NAME = #USER#	DESIGNED - R.H.D.	REVISED -	STATE OF ILLINOIS DEPARTMENT OF TRANSPORTATION	ARGYLE LAKE STATE PARK SIDE ROADS			F.A. RTE.	SECTION	COUNTY	TOTAL SHEETS	SHEET NO.
#FILE#		DRAWN - J.T.T.	REVISED -		SCALE: 1" = 20'	SHEET NO. 78 OF 162 SHEETS	STA. 412+75 TO STA. 417+75	ARGYLE LAKE STATE PARK	MCDONOUGH	162	78	
		CHECKED - T.T.P.	REVISED -					CONTRACT NO. 46158				
		DATE - 12/09/10	REVISED -					FED. ROAD DIST. NO. [ILLINOIS] FED. AID PROJECT				