

STA.	OFFSET	EACH
614+09.17, LT	39'	1
615+06.48, RT	50'	1
615+39.35, LT	47'	1
615+43.90, RT	55'	1
616+82.97, LT	58'	1
617+39.72, LT	55'	1
617+44.31, RT	61'	1
617+96.68, RT	62'	1
618+07.68, LT	46'	1
618+48.93, LT	56'	1

EXIST. CURVE C130
 PI STA. = 618+26.80
 Δ = 39° 36' 46" (RT)
 D = 81° 51' 04"
 R = 70.00'
 T = 25.21'
 L = 48.40'
 E = 4.40'
 P.C. STA. = 618+01.59
 P.T. STA. = 618+49.98

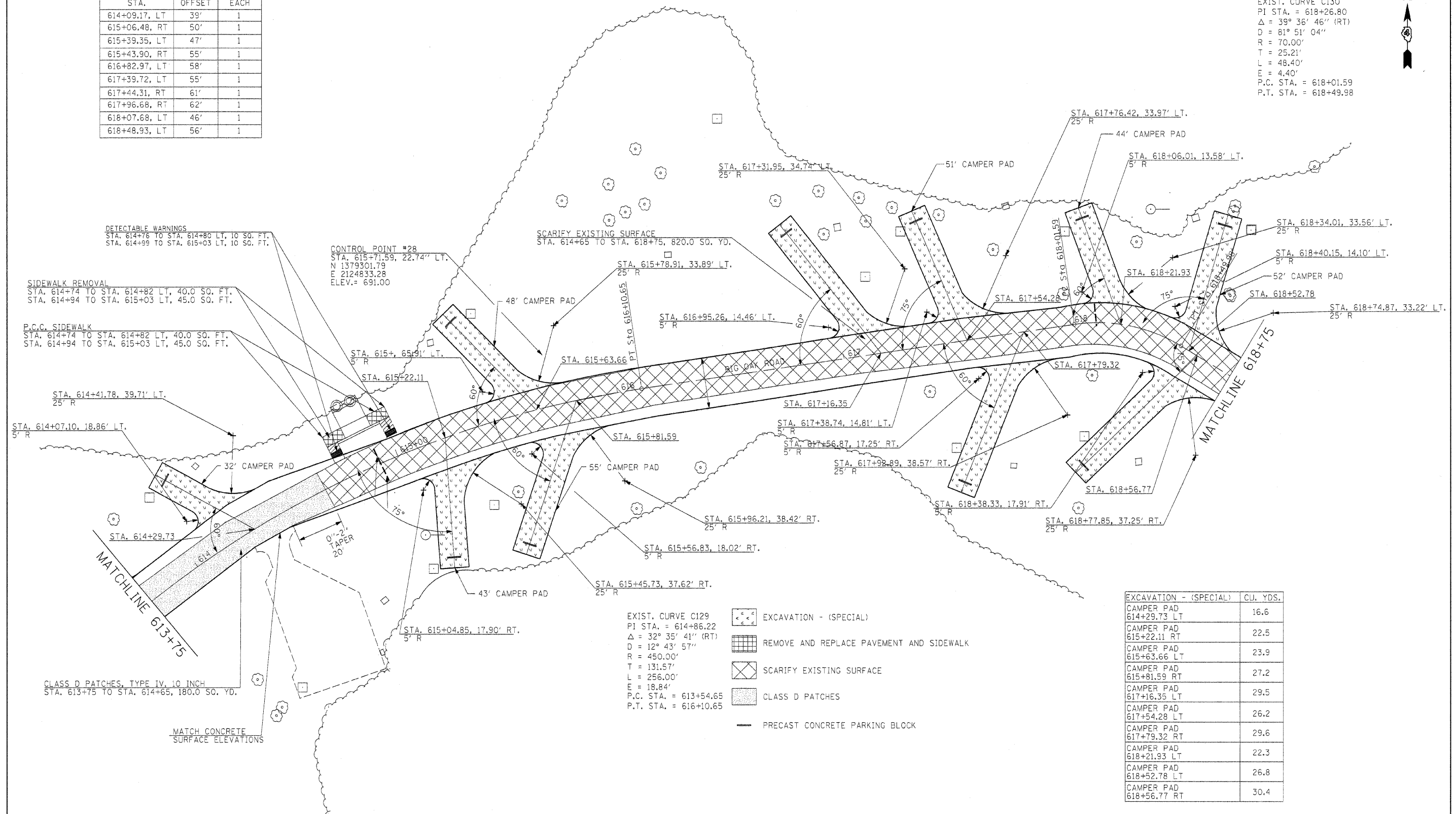

DETECTABLE WARNINGS
 STA. 614+76 TO STA. 614+80 LT, 10 SQ. FT.
 STA. 614+99 TO STA. 615+03 LT, 10 SQ. FT.

SIDEWALK REMOVAL
 STA. 614+74 TO STA. 614+82 LT, 40.0 SQ. FT.
 STA. 614+94 TO STA. 615+03 LT, 45.0 SQ. FT.

P.C.C. SIDEWALK
 STA. 614+74 TO STA. 614+82 LT, 40.0 SQ. FT.
 STA. 614+94 TO STA. 615+03 LT, 45.0 SQ. FT.

CONTROL POINT #28
 STA. 615+71.59, 22.74" LT.
 N 1379301.79
 E 2124833.28
 ELEV. = 691.00

SCARIFY EXISTING SURFACE
 STA. 614+65 TO STA. 618+75, 820.0 SQ. YD.

EXCAVATION - (SPECIAL)	CU. YDS.
CAMPER PAD 614+29.73 LT	16.6
CAMPER PAD 615+22.11 RT	22.5
CAMPER PAD 615+63.66 LT	23.9
CAMPER PAD 615+81.59 RT	27.2
CAMPER PAD 617+16.35 LT	29.5
CAMPER PAD 617+54.28 LT	26.2
CAMPER PAD 617+79.32 RT	29.6
CAMPER PAD 618+21.93 LT	22.3
CAMPER PAD 618+52.78 LT	26.8
CAMPER PAD 618+56.77 RT	30.4

EXIST. CURVE C129
 PI STA. = 614+86.22
 Δ = 32° 35' 41" (RT)
 D = 12° 43' 57"
 R = 450.00'
 T = 131.57'
 L = 256.00'
 E = 18.84'
 P.C. STA. = 613+54.65
 P.T. STA. = 616+10.65

- EXCAVATION - (SPECIAL)
- REMOVE AND REPLACE PAVEMENT AND SIDEWALK
- SCARIFY EXISTING SURFACE
- CLASS D PATCHES
- PRECAST CONCRETE PARKING BLOCK

FILE NAME =	USER NAME = #USER#	DESIGNED - R.H.D.	REVISED -	STATE OF ILLINOIS DEPARTMENT OF TRANSPORTATION	ARGYLE LAKE STATE PARK SIDE ROAD	F.A. RTE.	SECTION	COUNTY	TOTAL SHEETS	SHEET NO.
#FILE#		DRAWN - J.T.T.	REVISED -			ARGYLE LAKE STATE PARK	MCDONOUGH	162	88	
		CHECKED - T.T.P.	REVISED -			CONTRACT NO. 46158				
		DATE - 12/09/10	REVISED -			FED. ROAD DIST. NO. [ILLINOIS] FED. AID PROJECT				
				SCALE: 1" = 20'		SHEET NO. 88 OF 162 SHEETS		STA. 613+75 TO STA. 618+75		