

LEGEND

- WORK ZONE
- BARRICADE W/ STEADY BURN LIGHT
- TYPE III BARRICADE WITH FLASHING LIGHTS
- SIGN
- IMPACT ATTENUATORS
- CONCRETE BARRIER
- DOUBLE VERTICAL PANEL
- 400 W, 120V, MCIII HPS, WITH PHOTO CELL 15' MA, 50' MH ON WOOD POLE CLASS 4
- TEMPORARY TRAFFIC CONTROLLER WITH UPS AND BOTTOM PLATE MOUNTED TO WOOD POLE
- TEMPORARY VIDEO DETECTOR
- TEMPORARY LED TRAFFIC SIGNAL HEAD, NUMBER OF SECTION AND DISPLAY AS REQUIRED
- TEMPORARY RUMBLE STRIPS PER STANDARD 701901

NOTES:

BARRICADE AND PANEL SPACING SHALL BE 25' CENTERS IN TAPER SECTIONS AND 50' CENTERS IN TANGENT SECTIONS.

VERTICAL PANELS SHALL BE USED WHEN BARRICADES CANNOT BE PLACED ON THE EXISTING PAVEMENT OR PAVED SHOULDER.

ALL SIGNS, BARRICADES AND OTHER TRAFFIC CONTROL DEVICES SHOWN ON THIS SHEET SHALL BE ACCORDING TO SECTION 701 OF THE STANDARD SPECIFICATIONS AND SHALL NOT BE PAID FOR SEPARATELY, BUT SHALL BE PAID FOR AT THE CONTRACT LUMP SUM PRICE FOR "TRAFFIC CONTROL AND PROTECTION, SPECIAL."

STAGE 1

1. INSTALL TRAFFIC CONTROL AND TEMPORARY CONCRETE BARRIER IN ACCORDANCE WITH STAGE 1 MAINTENANCE OF TRAFFIC.
2. REMOVE EAST PORTION OF EXISTING SUPERSTRUCTURE, AND EXISTING APPROACH PAVEMENT.
3. INSTALL NEW BEAMS, CONCRETE DECK AND PARAPET WALLS.
4. CONSTRUCT NEW CONCRETE APPROACH SLABS AND APPROACH PAVEMENT.
5. CONSTRUCT PROPOSED ROADWAY IMPROVEMENTS ON EAST SIDE OF IL ROUTE 23.

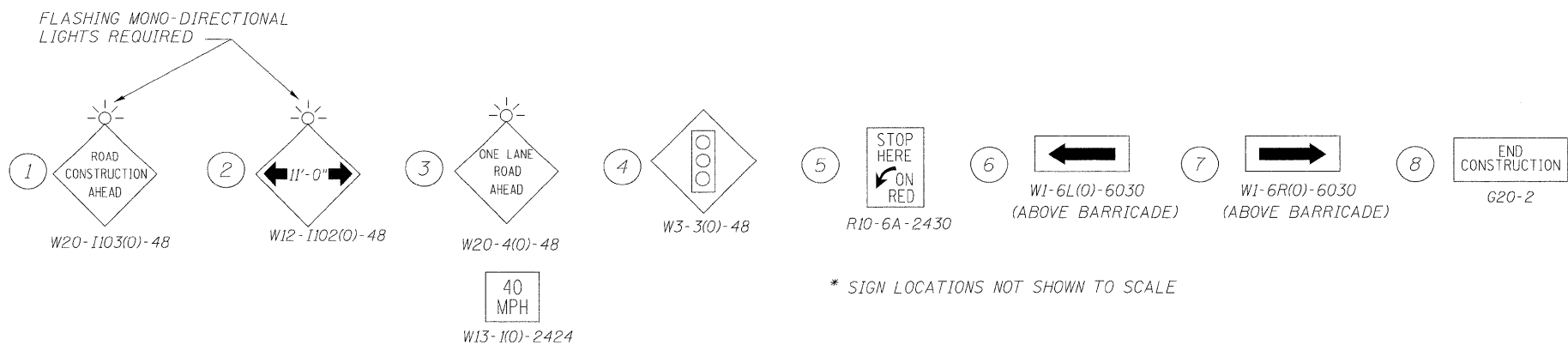

* SIGN LOCATIONS NOT SHOWN TO SCALE

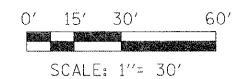

LOCO, INC.
CONSULTING ENGINEERS
1560 WALL ST, SUITE 222
NAPERVILLE, ILLINOIS 60563 PH: 630.517.9100

DESIGNED - SLV
DRAWN - SLV
CHECKED - MJY, ST
DATE - 12/30/2010

REVISED -
REVISED -
REVISED -
REVISED -

**STATE OF ILLINOIS
DEPARTMENT OF TRANSPORTATION**

**CONSTRUCTION STAGING PLAN - STAGE 1
IL ROUTE 23 OVER COON CREEK**

SCALE: 1" = 30' SHEET NO. 1 OF 2 STA. 88+00 TO STA. 92+00

F.A.P. RTE.	SECTION	COUNTY	TOTAL SHEETS	SHEET NO.
324	24 B-2	McHENRY	76	10
D-91-178-09			CONTRACT NO. 60F64	
FED. ROAD DIST. NO. ILLINOIS FED. AID PROJECT				